

## Hinkley 1536SK-LL

# Hinkley Landscape 1536SK-LL Spot Light Instruction Manual

Model: 1536SK-LL | Brand: Hinkley

## 1. INTRODUCTION

This manual provides detailed instructions for the safe and efficient installation, operation, and maintenance of your Hinkley Landscape 1536SK-LL Spot Light. This low-voltage LED fixture is designed for outdoor use, offering versatile lighting solutions for various landscaping techniques.



*Image 1: Hinkley Landscape 1536SK-LL Spot Light in Satin Black finish.*

The Hinkley 1536SK-LL is a durable aluminum spot light featuring a 4W MR16 LED bulb, suitable for wet locations and meeting UL & CSA Product Safety Standards. Its traditional design with a robust hood and clear glass lens ensures both aesthetic appeal and functional performance.

## **2. SAFETY INFORMATION**

---

- Always disconnect power at the main circuit breaker before installation or servicing.
- This fixture operates on 12V low voltage. A transformer is required to convert standard household voltage.
- Suitable for wet locations, as defined by NEC and CEC.
- Meets UL & CSA Product Safety Standards.
- Ensure all electrical connections are secure and watertight to prevent electrical hazards.
- The transformer must be plugged into a GFCI (Ground Fault Circuit Interrupter) protected outlet.
- Mount the bottom of the transformer at least 12 inches above grade and at least 10 feet from any open

water source.

- Consult a qualified electrician if you are unsure about any part of the installation process or if a GFCI outlet is not available.

**Proposition 65 Warning: This product may contain chemicals known to the State of California to cause cancer and birth defects or other reproductive harm.**

### 3. WHAT'S IN THE BOX

Your Hinkley Landscape 1536SK-LL Spot Light package includes:

- Hinkley Landscape 1536SK-LL Spot Light Fixture
- 4W MR16 LED Bulb
- Wiring Kit
- Ground Spike
- Instruction Manual

### 4. SPECIFICATIONS

Feature	Specification
Brand	Hinkley
Model Name	1536SK-LL
Color	Satin Black
Material	Aluminum
Product Dimensions (L x W x H)	2.5" x 5.75" x 3.25"
Item Weight	1 Pound
Voltage	12 Volts
Light Source Type	LED (MR16)
Wattage	4 Watts
LED Color Temperature	2700K (Warm White)
LED Lumens	340 Lumens
Dimmable	Yes (MLV on transformer primary)
Power Source	Transformer (Required)
Installation Type	Ground
Indoor/Outdoor Usage	Outdoor
Water Resistance Level	Water Resistant
Certifications	UL, CSA

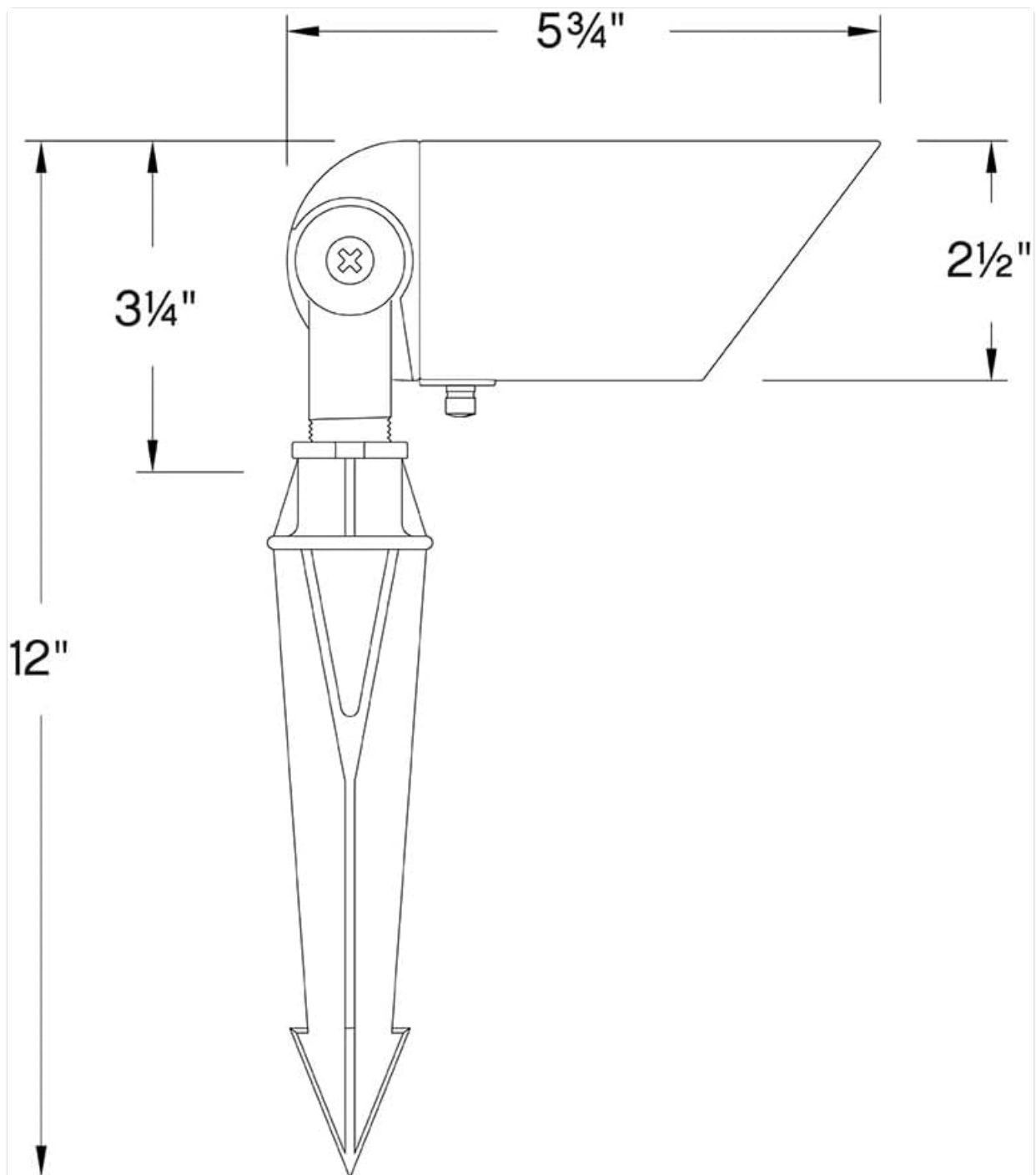

Image 2: Technical drawing showing the dimensions of the Hinkley 1536SK-LL Spot Light.

## 5. INSTALLATION

Installing your Hinkley Landscape Spot Light is a straightforward process. Follow these steps for a successful setup.

### 5.1. Planning Your Landscape Lighting

Before beginning installation, it is highly recommended to plan your lighting layout. Consider the following:

- **Areas to Light:** Identify key features, pathways, and architectural elements you wish to illuminate.
- **Lighting Techniques:** Determine if you will use silhouetting, wall washing, shadowing, uplighting, or grazing techniques.
- **Safety and Security:** Plan lighting for areas requiring enhanced visibility for safety and security.
- **Focal Points:** Highlight specific plants, statues, or architectural details to create visual interest.

- **Transformer Placement:** Locate a 120V GFCI-protected power source on your property. This will determine the optimal placement for your transformer. Ensure the transformer is mounted at least 12 inches above grade and 10 feet from any open water.

Sketching out your desired layout on paper can help visualize the final result and ensure all areas are covered effectively.



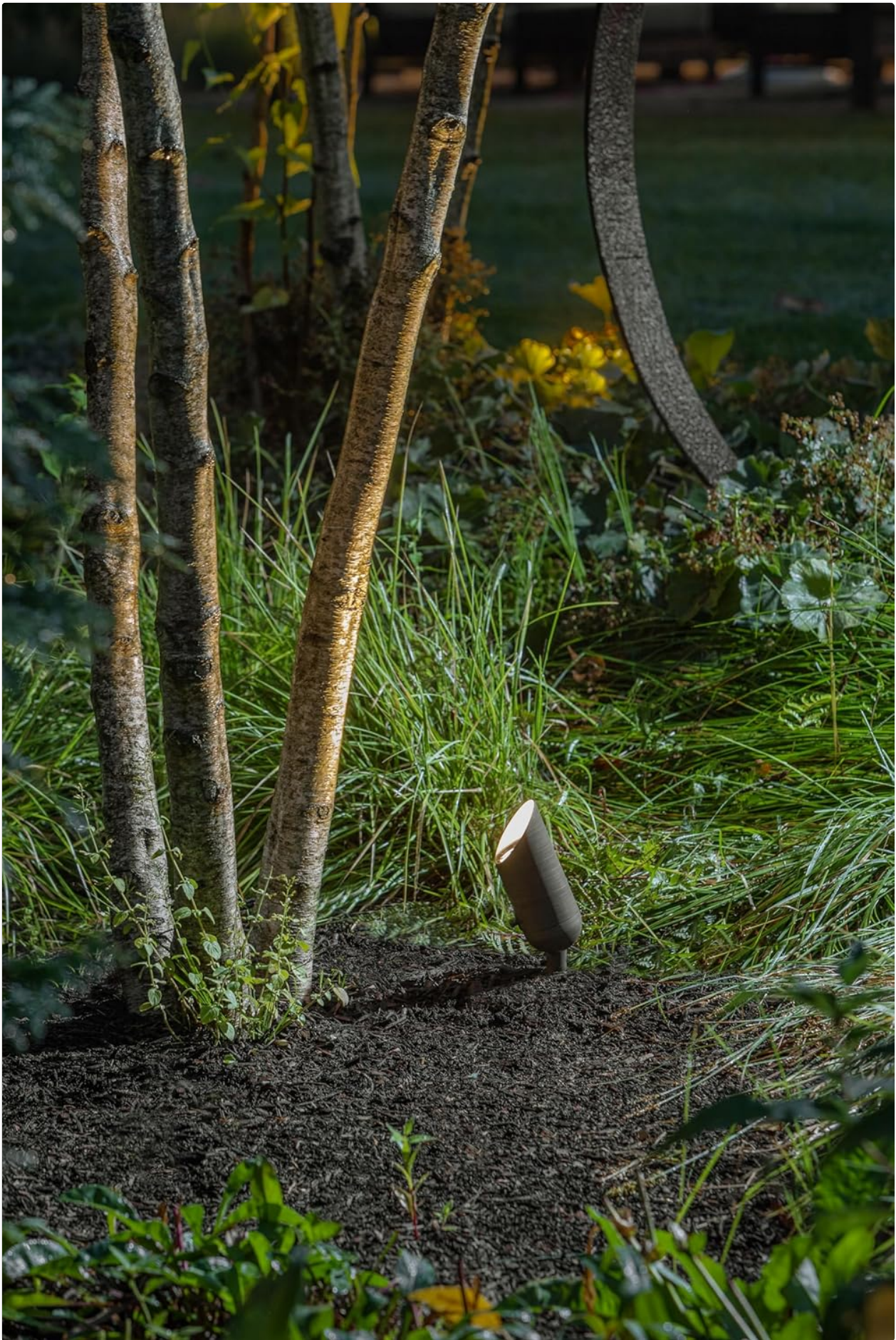

*Image 3: Hinkley spot light used for uplighting a tree in a landscaped garden.*





*Image 4: Hinkley spot light positioned to illuminate large outdoor planters near a building.*

## **5.2. Running the Wire Cable**

1. Run your low-voltage wire cable from the transformer location to each lighting fixture location. You may have multiple runs depending on your layout.
2. A minimum of 12 gauge wire is recommended to minimize voltage drop and ensure durability.
3. For areas like landscape beds and sidewalks that are edged, consider burying the cable deeper than 6 inches to prevent damage from edging or tilling.
4. Do not bury the cable until all connections are made and tested.

## **5.3. Connecting Fixtures to the Cable**

1. At each fixture location, cut the main cable and strip approximately 3/4 inch of insulation from the ends of the cable wires.
2. Connect the fixture's wires to the main cable wires. Twist the wires together tightly.
3. Secure the connection using a gel-filled wire connector to ensure a strong, watertight seal.
4. Wrap the connection with electrical tape for added protection.
5. Leave enough excess cable at each fixture to allow for repositioning as your landscape matures.

## 5.4. Connecting to the Transformer

1. Run the main cable(s) exiting your transformer through conduit for approximately 6 inches into the ground to create a neat and professional installation.
2. Strip approximately 3/4 inch of insulation from the ends of the main cable wires.
3. Connect one wire strand into the common tap and the other into the corresponding voltage tap (e.g., 12V or 15V for longer runs over 100 feet).
4. Use a flathead screwdriver to tighten each tap down securely.
5. If using multiple runs, identify each cable entering the wiring cavity using colored electrical tape and mark the cable run on the inside of the transformer door.

Your browser does not support the video tag.

*Video 1: "Landscape Lighting Made Simple" - A detailed guide on installing a low-voltage landscape lighting system, including planning, wiring, and transformer connections.*

## 5.5. Mounting the Transformer

Once the main cable run is securely attached to the transformer, you can mount the transformer to a structure or a secured post. A post is often the preferred method to position the transformer out of the line of sight. Ensure the bottom of the transformer is mounted at least 12 inches above grade and 10 feet from any open water.

## 5.6. Powering the System

After the transformer is securely mounted and all wiring connections are complete, plug the transformer into a 120V power source. This must be a GFCI (Ground Fault Circuit Interrupter) protected outlet, as required by the National Electrical Code. If you do not have a GFCI outlet, contact a qualified electrician to have one installed.

Your browser does not support the video tag.

*Video 2: "Landscape General Video" - A brief overview of Hinkley landscape lighting, highlighting safety, ease of installation, flexibility, and energy efficiency.*

## 6. OPERATING INSTRUCTIONS

---

Your Hinkley Landscape Spot Light is designed for simple operation once installed.

- **Power On/Off:** The system is controlled by the transformer. Most transformers include a timer or photocell for automatic operation. Refer to your transformer's manual for specific operating instructions.
- **Dimmable Feature:** This fixture is dimmable when connected to a compatible MLV (Magnetic Low Voltage) transformer primary. Adjust the dimming settings on your transformer as desired.
- **Adjusting Light Direction:** The spot light features an adjustable head. Loosen the adjustment screw, position the light to your desired angle, and then tighten the screw to secure it.





*Image 5: Hinkley spot light discreetly placed among foliage to illuminate a garden path.*

## **7. MAINTENANCE**

---

Regular maintenance will ensure the longevity and optimal performance of your Hinkley Landscape Spot Light.

- **Cleaning:** Periodically clean the fixture and lens with a soft, damp cloth to remove dirt, debris, and mineral deposits. Avoid abrasive cleaners.
- **Bulb Replacement:** While LED bulbs have a long lifespan, if replacement is needed, ensure the power is off. Use only 4W MR16 LED bulbs.
- **Wiring Inspection:** Annually inspect all wiring and connections for any signs of damage, fraying, or corrosion. Ensure all watertight connections remain sealed.
- **Fixture Adjustment:** As plants grow, you may need to adjust the position or angle of your spot lights to maintain desired illumination.

## 8. TROUBLESHOOTING

If you encounter issues with your spot light, refer to the following troubleshooting guide:

Problem	Possible Cause	Solution
Light does not turn on	No power to transformer, faulty bulb, loose wiring connection, tripped GFCI.	Check transformer power supply and GFCI outlet. Ensure all wiring connections are secure. Replace bulb if necessary.
Lights are dim or flickering	Voltage drop due to long wire run or insufficient wire gauge, loose connections, overloaded transformer.	Ensure minimum 12 gauge wire is used. Check all connections for tightness. Verify transformer capacity is not exceeded (do not exceed 75% capacity). Consider using the 15V tap on the transformer for longer runs.
Water inside fixture lens	Improperly sealed lens or damaged gasket.	Ensure the lens is tightly sealed. Inspect and replace the gasket if damaged.







## 9. WARRANTY

The Hinkley Landscape 1536SK-LL Spot Light comes with a**3-year limited warranty**. Please retain your proof of purchase for warranty claims. For detailed warranty terms and conditions, please refer to the official Hinkley website or contact customer support.

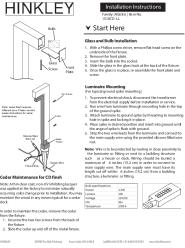
## 10. CUSTOMER SUPPORT

For further assistance, technical support, or to inquire about replacement parts, please visit the official Hinkley website or contact their customer service department. You can find more information at [www.hinkleylighting.com](http://www.hinkleylighting.com).

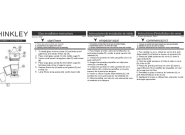

 <p><b>HINKLEY</b></p> <p>▼ Start Here</p> <p><b>Mounting and Glass Installation</b></p> <ol style="list-style-type: none"> <li>1. Remove the mounting bracket from the back of the light fixture.</li> <li>2. Insert the mounting bracket into the pre-drilled hole in the wall.</li> <li>3. Tighten the screws to secure the mounting bracket.</li> <li>4. Insert the light fixture into the mounting bracket.</li> <li>5. Tighten the screws to secure the light fixture.</li> </ol> <p><b>Wiring</b></p> <ol style="list-style-type: none"> <li>1. Turn off the power to the light fixture at the circuit breaker.</li> <li>2. Connect the wires to the terminals on the back of the light fixture.</li> <li>3. Turn the power back on at the circuit breaker.</li> </ol> <p><b>Cedar Maintenance for CD-Rails</b></p> <p>Apply Cedar Maintenance Oil to the cedar rails every 3-6 months to maintain the natural beauty of the cedar.</p>	<p><a href="#">Hinkley Atlantis 1518CD-LL Installation Instructions</a></p> <p>Detailed installation guide for the Hinkley Atlantis 1518CD-LL LED Path Light, covering glass and bulb installation, luminaire mounting, and cedar maintenance.</p>
 <p><b>HINKLEY</b></p> <p><b>Assembly and Installation</b></p> <ol style="list-style-type: none"> <li>1. Assemble the mounting bracket and glass panel.</li> <li>2. Mount the bracket to the wall.</li> <li>3. Install the glass panel.</li> <li>4. Connect the wiring.</li> </ol>	<p><a href="#">Hinkley Lighting Fixture Assembly and Installation Instructions (Models 2530-2535)</a></p> <p>Detailed assembly and installation guide for Hinkley lighting fixtures, including glass installation, hanging, and wiring instructions for models 2530, 2532, 2534, and 2535. Safety warnings and step-by-step procedures.</p>
 <p><b>HINKLEY</b></p> <p><b>Installation</b></p> <ol style="list-style-type: none"> <li>1. Mount the luminaire to the wall.</li> <li>2. Connect the wiring.</li> </ol>	<p><a href="#">Hinkley 15030 Freeport Family Luminaire Installation Instructions</a></p> <p>Detailed installation guide for the Hinkley 15030 Freeport Family luminaire. Learn how to safely mount and wire your low-voltage outdoor light fixture with these step-by-step instructions.</p>
 <p><b>HINKLEY</b></p> <p><b>Installation</b></p> <ol style="list-style-type: none"> <li>1. Prepare the mounting surface.</li> <li>2. Install the glass panel.</li> <li>3. Mount the fixture.</li> <li>4. Wire the fixture.</li> <li>5. Caulk the fixture.</li> </ol>	<p><a href="#">Hinkley Lighting Fixture Installation Guide: Glass, Mounting, Wiring, and Caulking</a></p> <p>Comprehensive installation instructions for Hinkley lighting fixtures, covering glass panel installation, mounting strap preparation and wall mounting, electrical wiring and grounding, and final caulking for a secure and weather-tight seal. Includes model numbers 23304 and 23305.</p>
 <p><b>HINKLEY</b></p> <p><b>Installation</b></p> <ol style="list-style-type: none"> <li>1. Mount the fixture to the wall.</li> <li>2. Connect the wiring.</li> <li>3. Caulk the fixture.</li> </ol>	<p><a href="#">HINKLEY Lighting Fixture Installation, Mounting, Wiring, and Caulking Instructions - Item 27097</a></p> <p>Comprehensive installation guide for HINKLEY lighting fixtures, Item No. 27097. Covers glass installation, mounting procedures for flat and pyramid surfaces, detailed wiring and grounding instructions for indoor and outdoor use, and essential caulking steps for weather sealing. Includes safety warnings and part identification.</p>
 <p><b>HINKLEY</b></p> <p><b>Installation</b></p> <ol style="list-style-type: none"> <li>1. Assemble the stem and glass shade.</li> <li>2. Mount the fixture to the wall.</li> <li>3. Connect the wiring.</li> </ol>	<p><a href="#">Hinkley SKYE Light Fixture Installation and Wiring Guide</a></p> <p>Comprehensive installation, mounting, and wiring instructions for the Hinkley SKYE light fixture (Item Nos. 30304/30306). Includes details on stem assembly, glass installation, electrical connections, grounding, and glass shade identification with model numbers.</p>