

Manuals+

[Q & A](#) | [Deep Search](#) | [Upload](#)

[manuals.plus](#) /

› [Logitech](#) /

› [Logitech Circle View Apple HomeKit- enabled Wired Doorbell with Logitech TrueView Video, Face Recognition, Color Night Vision, and Head-to-toe HD Video - Black User Manual](#)

Logitech 961-000484

Logitech Circle View Wired Doorbell User Manual

Model: 961-000484

1. PRODUCT OVERVIEW

The Logitech Circle View Wired Doorbell is an advanced smart doorbell designed to integrate seamlessly with Apple HomeKit. It provides enhanced security and convenience for your home, offering high-definition video, two-way audio, and intelligent features like Face Recognition and Color Night Vision.





Figure 1: Front view of the Logitech Circle View Wired Doorbell.

Key Features:

- **Apple HomeKit Integration:** Exclusively designed to work with Apple HomeKit for secure and private video monitoring.
- **Logitech TrueView Video:** Offers head-to-toe HD video with a 160° field of view, HDR, and color night vision up to 6 feet.
- **Face Recognition:** Identifies familiar faces and provides rich notifications across your Apple devices.
- **Two-Way Audio:** Communicate with visitors directly through the doorbell.
- **Weather-Resistant Design:** IP65 rated for outdoor use, ensuring durability in various weather conditions.
- **Slim Silhouette:** Modern design with a seamless glass face that complements any home exterior.

LOGITECH TRUEVIEW VIDEO

HEAD-TO-TOE
PORTRAIT VIEW
TRUE HDR
COLOR NIGHT VISION

DIGITAL MEMS
MICROPHONE
W/ ECHO
CANCELLATION

SEAMLESS
GLASS FRONT



IP 65
WEATHER-
PROOF

4000K LED
NIGHT LIGHT

INTEGRATED
BACKLIT
BUTTON

Figure 2: Key features and components of the doorbell.

2. SETUP AND INSTALLATION

The Logitech Circle View Doorbell is designed to replace your existing wired doorbell. Professional installation is recommended due to the involvement of electrical wiring. Ensure your existing doorbell system is compatible before proceeding.

2.1 Compatibility Check

Before purchasing or installing, verify your home's electrical system compatibility. The doorbell requires a wired doorbell system (8-24V AC 10 VA or higher). Visit the official Logitech website for a detailed compatibility checker.

2.2 Included Components

- Logitech Circle View Doorbell
- Chime Kit
- Installation Accessories (mounting options, wiring)
- Quick Start Guide

2.3 Installation Steps (Overview)

1. **Power Off:** Turn off power to your existing doorbell at the circuit breaker.
2. **Remove Old Doorbell:** Carefully disconnect and remove your old doorbell unit.
3. **Install Chime Kit:** Install the included Chime Kit inside your home, typically near your existing chime unit,

following the specific instructions provided in the Quick Start Guide.

4. **Mount Doorbell:** Secure the Logitech Circle View Doorbell to your wall using the provided mounting options and hardware.
5. **Wire Connection:** Connect the doorbell to your existing doorbell wiring. This step involves dealing with electrical cabling and may require electrical testing equipment.
6. **Power On:** Restore power at the circuit breaker.
7. **HomeKit Setup:** Open the Apple Home app on your iOS device and follow the on-screen instructions to add the Logitech Circle View Doorbell to your HomeKit setup.



Figure 3: The doorbell integrates with existing wired systems and features a slim design.

VERSATILE MOUNTING OPTIONS FOR ANY ENTRANCE*



*EXTENDED EXPOSURE TO DIRECT
SUNLIGHT OR UNSUPPORTED AMBIENT
TEMPS MAY TEMPORARILY DISABLE
VIDEO FUNCTIONALITY.

Figure 4: The doorbell offers versatile mounting options for various entrances.

3. OPERATING THE DOORBELL

Once installed and configured with Apple HomeKit, the Logitech Circle View Doorbell operates seamlessly within your smart home ecosystem.

3.1 Apple HomeKit Secure Video

The doorbell supports Apple HomeKit Secure Video, providing end-to-end encryption for your video recordings and in-home video analysis. This feature requires an iCloud+ plan and a Home Hub device (e.g., Apple TV, HomePod, or iPad set up as a Home Hub).

- **Live View:** Access a live feed from your doorbell camera at any time through the Apple Home app.
- **Two-Way Communication:** Use the built-in microphone and speaker to talk to visitors from your Apple device.
- **Motion-Based Recording:** The doorbell automatically records video clips when motion is detected.
- **Face Recognition:** Receive notifications with identified faces of people known to your HomeKit system.

- **Package Detection:** Get alerts when packages are detected at your doorstep (requires iOS 15 or later).
- **Custom Activity Zones:** Define specific areas within the camera's view for motion detection, reducing unwanted alerts.
- **Rich Notifications:** Receive detailed notifications on your Apple devices, including thumbnails of detected activity.

SUPPORTS APPLE HOMEKIT SECURE VIDEO

(REQUIRES SUPPORTED iOS DEVICE, iCloud PLAN & HOME HUB)



**FACE
RECOGNITION**



**MOTION-BASED
RECORDING**



**END-TO-END
ENCRYPTION**



**CUSTOMIZABLE
ACTIVITY ZONES**



**LIVE VIEW WITH
2-WAY VIDEO**



**RICH
NOTIFICATIONS**

Figure 5: The doorbell's integration with Apple HomeKit Secure Video.

FACE RECOGNITION HEAD-TO-TOE PORTRAIT VIEW NOTIFICATIONS ACROSS ALL APPLE DEVICES

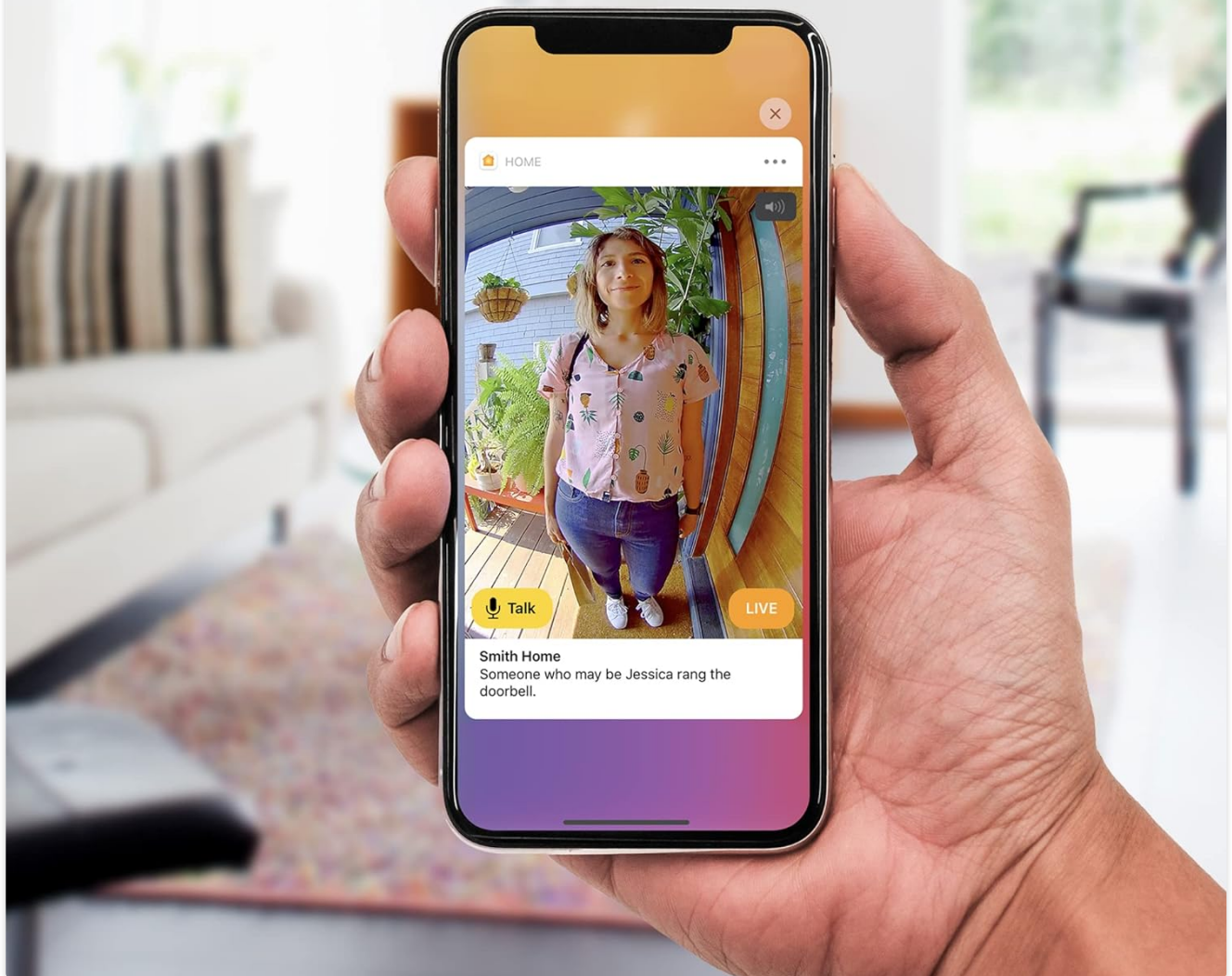

Figure 6: Head-to-toe portrait view and notifications on an Apple device.

3.2 Night Vision

The doorbell features Color Night Vision, allowing you to see clear, full-color video even in low-light conditions or total darkness up to 6 feet away.

4. MAINTENANCE

To ensure optimal performance and longevity of your Logitech Circle View Doorbell, follow these maintenance guidelines:

- **Cleaning:** Gently wipe the glass face and body of the doorbell with a soft, damp cloth. Avoid using harsh chemicals or abrasive cleaners, which can damage the finish or lens.
- **Firmware Updates:** Keep your doorbell's firmware updated through the Apple Home app. Updates often include performance improvements, bug fixes, and new features.
- **Lens Care:** Ensure the camera lens remains clean and free of dust, dirt, or smudges to maintain clear video quality.

- **Environmental Considerations:** While IP65 weather-resistant, extreme temperatures or prolonged direct sunlight may temporarily affect video functionality. Ensure proper placement to minimize such exposure.

5. TROUBLESHOOTING

If you encounter issues with your Logitech Circle View Doorbell, refer to the following common troubleshooting steps:

Problem	Possible Cause	Solution
Doorbell not responding/offline	No power; Wi-Fi connectivity issue; Home Hub offline.	Check circuit breaker. Verify Wi-Fi signal strength. Ensure your Apple Home Hub is online and functioning. Restart your router.
Poor video quality/blurry image	Dirty lens; poor lighting; network congestion.	Clean the camera lens. Ensure adequate lighting. Check your Wi-Fi network for congestion or interference.
No notifications	Notification settings disabled; HomeKit Secure Video not configured.	Check notification settings in the Apple Home app. Ensure HomeKit Secure Video is enabled and you have an iCloud+ plan and Home Hub.
Chime not working	Chime Kit not installed correctly; incompatible chime.	Review Chime Kit installation instructions. Ensure your existing chime is compatible.

For more complex issues or persistent problems, please contact Logitech Customer Support.

6. SPECIFICATIONS

Feature	Detail
Model Name	Circle View Doorbell
Model Number	961-000484
UPC	097855165060
Connectivity Protocol	Wi-Fi
Controller Type	Apple HomeKit
Power Source	Wired (8-24V AC 10 VA or higher)
Voltage	24 Volts
Video Capture Resolution	HD (720p)
Field of View	160 Degrees
Night Vision	Color Night Vision (up to 6 feet)

Feature	Detail
Dimensions (L x W x H)	4.68 x 1.65 x 1.1 inches (118.8 x 41.8 x 27.9 mm)
Weight	5.3 ounces (151 Grams)
Material	Glass
Weather Resistance	IP65 Weather-Proof
Color	Graphite

7. WARRANTY AND SUPPORT





7.1 Warranty Information



Manufacturer's warranty information can be requested directly from Logitech customer service. Please retain your proof of purchase for warranty claims.

7.2 Customer Support

For technical assistance, troubleshooting, or product inquiries, please visit the official Logitech support website or contact their customer service. You may also find additional resources, including a detailed PDF user manual, at the following link: [Logitech Circle View Doorbell User Manual \(PDF\)](#)

Related Documents - 961-000484

	Logitech Circle View Doorbell: Electrical Compatibility and Getting Started Information on the electrical compatibility and installation requirements for the Logitech Circle View Doorbell, including system voltage, Wi-Fi, and Apple HomeKit Secure Video.
	Logitech Circle View Wired Doorbell Installation and Reset Guide Comprehensive guide for installing and performing a hardware reset on the Logitech Circle View Wired Doorbell, including setup instructions for Apple HomeKit.
	Logitech Circle View Wired Doorbell Installation and Safety Guide Comprehensive guide for installing and safely using the Logitech Circle View Wired Doorbell, including setup options, hardware reset instructions, and important safety information.
	Logitech Circle View Wired Doorbell Installation and Reset Guide A concise guide to installing and performing a hardware reset on the Logitech Circle View Wired Doorbell, including setup instructions and Apple HomeKit compatibility.

	<p>Logitech Circle View Wired Doorbell: Installation and Hardware Reset Guide</p> <p>Comprehensive guide for installing and performing a hardware reset on the Logitech Circle View Wired Doorbell. Includes setup instructions, Apple HomeKit compatibility, and troubleshooting steps.</p>
	<p>Logitech Circle View Camera: Setup, Mounting, and Safety Guide</p> <p>A concise guide to setting up, mounting, and safely operating your Logitech Circle View Camera, including essential safety, compliance, and warranty information.</p>

Documents - Logitech – 961-000484

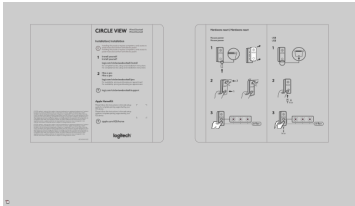

[Logitech Circle View Wired Doorbell Installation and Reset Guide](#)

Comprehensive guide for installing and performing a hardware reset on the Logitech Circle View Wired Doorbell, including setup instructions for Apple HomeKit.

lang:en score:41 filesize: 69 K page_count: 1 document date: 2022-06-19