

AZDOME JYX02

AZDOME JYX02 3-Lead ACC Hardwire Kit Instruction Manual

Model: JYX02

1. INTRODUCTION

This manual provides detailed instructions for the installation and operation of the AZDOME JYX02 3-Lead ACC Hardwire Kit. This kit is designed to provide a continuous power supply to your dash camera, enabling features such as 24-hour parking monitoring and protecting your vehicle's battery from discharge.

2. SAFETY INFORMATION

- Ensure the vehicle's ignition is off before beginning installation.
- Incorrect wiring can damage your vehicle's electrical system or the hardwire kit. If you are unsure about any step, consult a qualified automotive technician.
- Do not modify the hardwire kit components.
- Keep the product away from water and extreme temperatures.

Important: This hardwire kit includes multiple protection features such as over-current, short-circuit, reverse connection, battery drain, and overheat protection to safeguard your device and vehicle.



BLACK wire (GND)

RED wire (BAT+)

YELLOW wire (ACC)

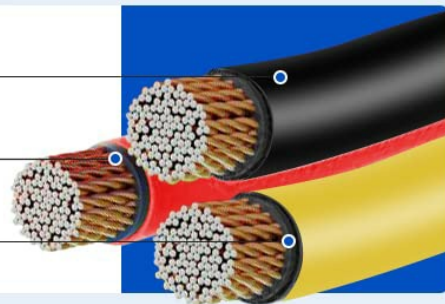

Image: Protection features and wire identification.

3. PACKAGE CONTENTS

Verify that all items are present in your package:

- AZDOME 3-Lead ACC Hardwire Kit (Main Unit with Mini-USB cable)
- Fuse Tap Cables (various types)
- Assorted Fuses
- Fuse Puller Tool
- Owner's Manual (this document)

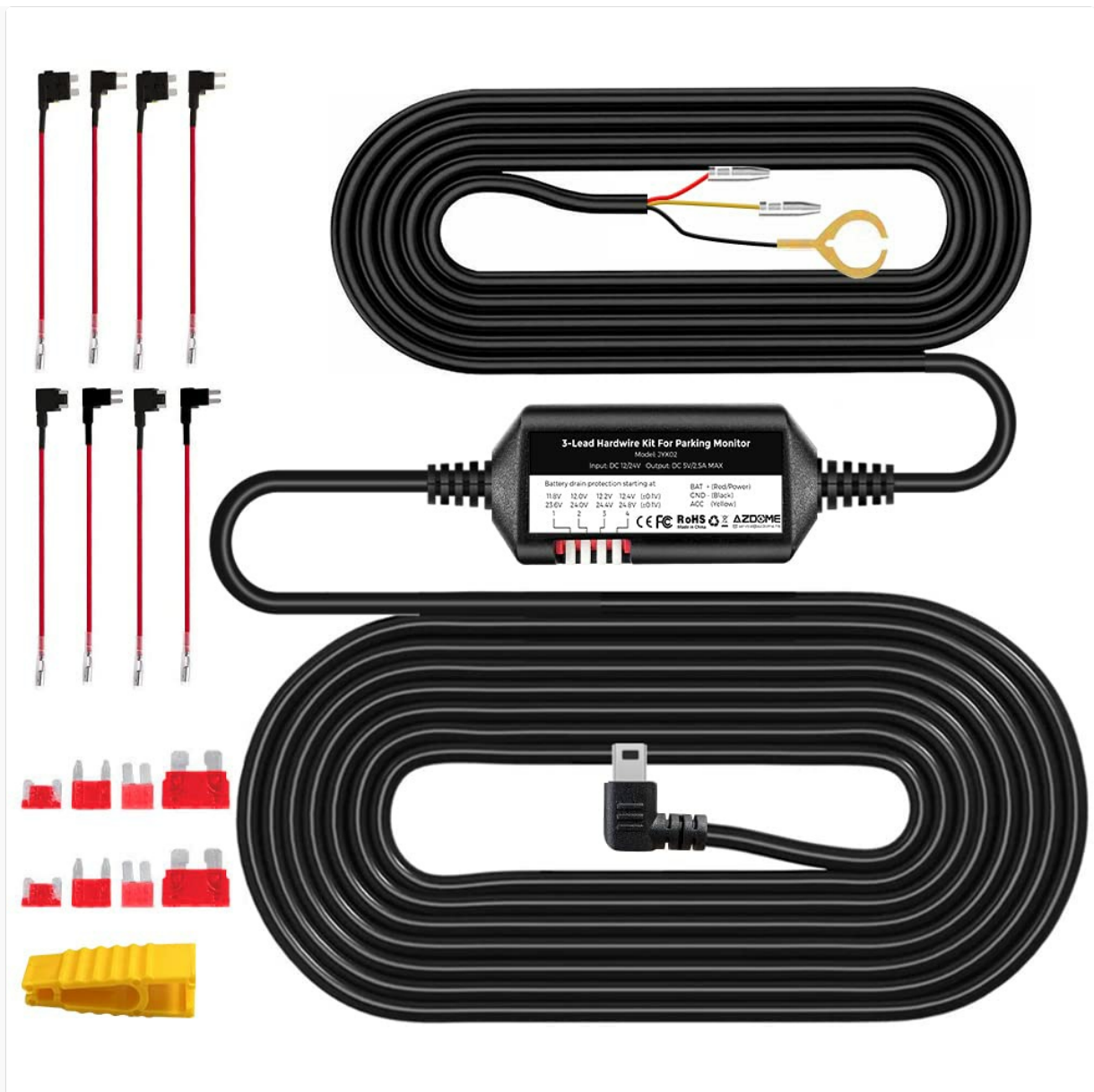

Image: Complete package contents of the hardwire kit.

4. PRODUCT OVERVIEW

The AZDOME JYX02 Hardwire Kit converts 12V-24V vehicle power to 5V/2.5A output via a Mini-USB port, suitable for compatible dash cameras and other devices. It features a 3-lead design for comprehensive power management.

4.1. Universal Compatibility (Mini USB)

This hardwire kit is designed for devices that utilize a Mini-USB power input. It is compatible with various dashcams, mirror dashcams, radar detectors, and GPS navigation units that require a Mini-USB connection.

Universal compatibility



Image: Universal compatibility with Mini USB devices.

5. SETUP AND INSTALLATION

5.1. Before Installation

- Locate your vehicle's fuse box. This is typically found under the dashboard, in the glove compartment, or under the hood.
- Identify an 'ACC' (Accessory) fuse that is only powered when the ignition is on, and a 'BAT+' (Constant Power) fuse that is always powered, even when the ignition is off.
- Determine the correct type and size of fuse taps required for your vehicle's fuse box.

Note on Compatibility: This kit may not be compatible with certain Ford trucks and vehicles, including specific models like Ford F150 2021, Ford F150 Lariat 2011, Ford F350, Ford Edge 2011, Ford Explorer 2013, and Ford Ranger 2021. Please verify your vehicle's fuse type and system before installation.

5.2. Identifying Fuse Types

The kit includes various dual-slot fuse holders to accommodate different fuse types. You will need two fuse taps for installation (one for ACC, one for BAT+).

Type	Description
ACZ	Micro2 Fuse
ACS	Mini Fuse
ACN	LP-Mini Fuse
ACU	ATO Fuse

4 Types Dual-Slot Fuse Holder (2 Sets)

Length:17cm/0.558ft

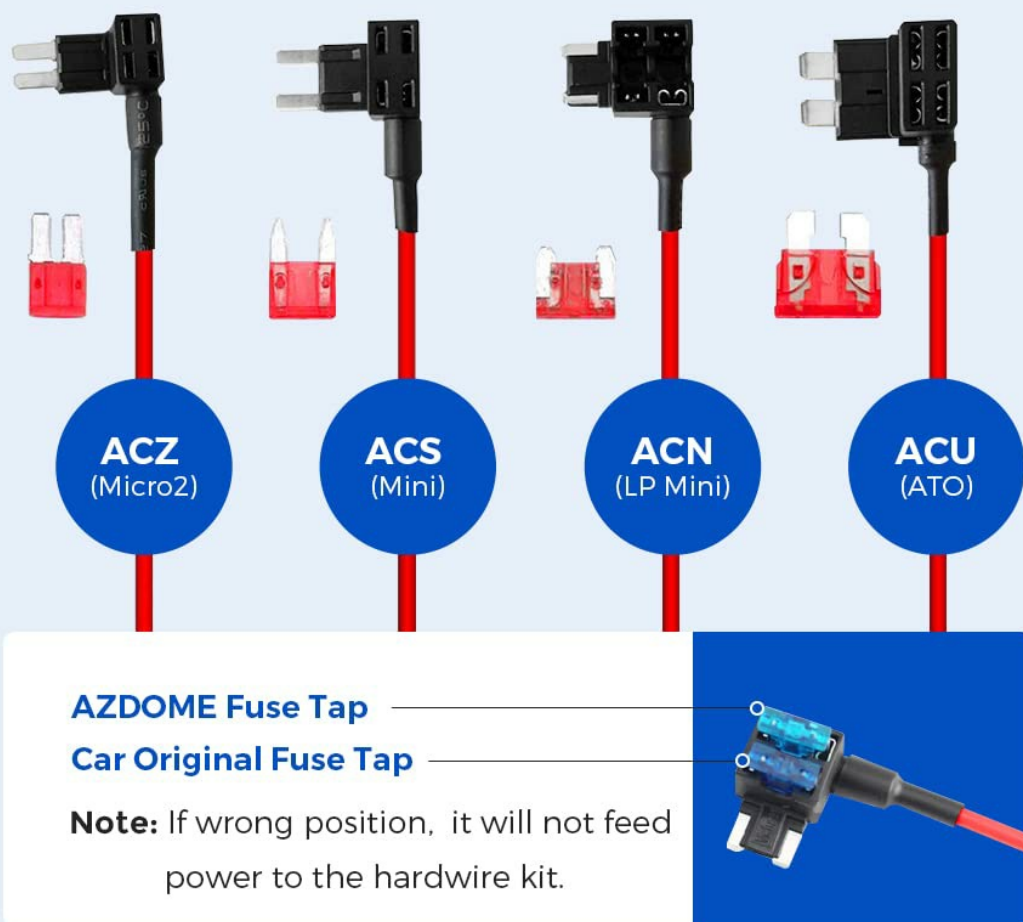

Image: Different types of dual-slot fuse holders.

5.3. Wiring Connections

The hardwire kit features three distinct wires for connection:

- **Red Wire (ACC):** Connect to an ACC (Accessory) fuse in your vehicle's fuse box. This fuse should only provide power when the vehicle's ignition is on.
- **Yellow Wire (BAT+):** Connect to a constant power fuse (BAT+) in your vehicle's fuse box. This fuse should provide power continuously, even when the ignition is off, to enable parking monitoring.
- **Black Wire (GND):** Connect to a metal bolt or screw on the vehicle's chassis to establish a ground connection.



Low Voltage Protection

AZDOME Hardwire Kit will monitor your voltage status. When minimum voltage cut-off is 11.6V DC for a 12V DC battery and 23.6V DC for a 24V DC battery, hardwire kit will cut off the power.

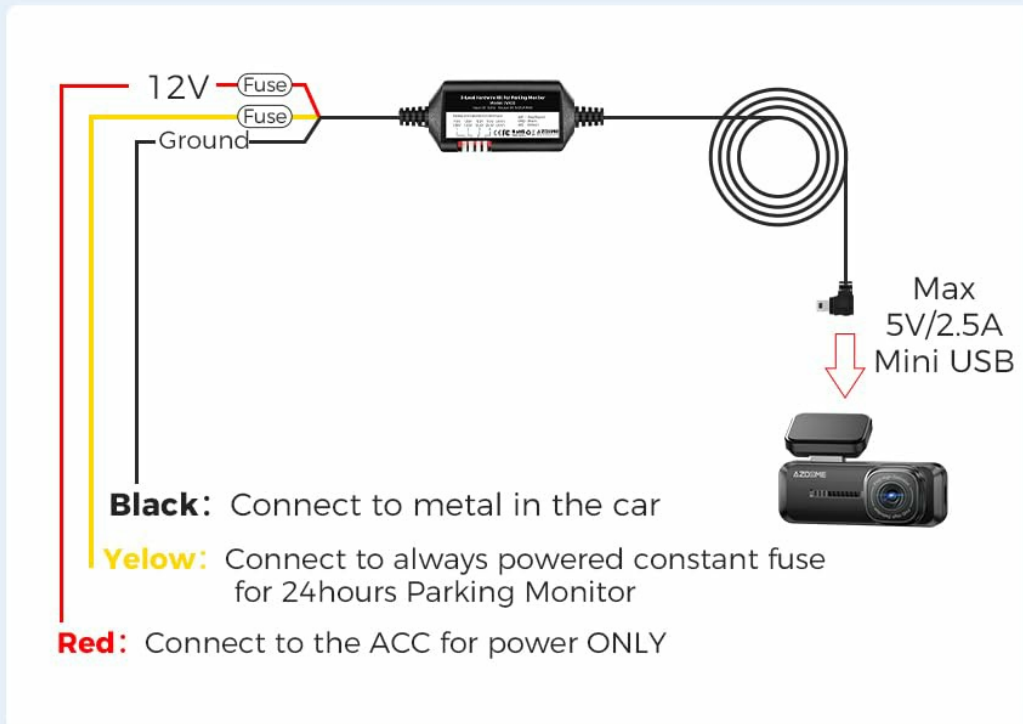

Image: Detailed wiring diagram for the hardwire kit.

5.4. Step-by-Step Installation Guide

1. **Locate Fuse Box:** Identify the fuse box in your vehicle.
2. **Identify Fuses:** Using a circuit pen or multimeter, find a suitable ACC fuse and a constant BAT+ fuse.
3. **Select Fuse Taps:** Choose the correct type of dual-slot fuse taps (ACZ, ACS, ACN, or ACU) that match your vehicle's fuses. Crimp the red wire of the hardwire kit onto one fuse tap and the yellow wire onto another. Insert the original fuse into the lower slot of the fuse tap and a new fuse (of the same rating) for the hardwire kit into the upper slot.
4. **Connect Wires:** Insert the fuse tap with the red wire into the identified ACC fuse slot. Insert the fuse tap with the yellow wire into the identified BAT+ fuse slot.
5. **Ground Connection:** Connect the black wire (GND) to a metal bolt or screw on the vehicle's chassis for a secure ground.
6. **Route Cables:** Carefully route the Mini-USB cable from the hardwire unit to your dash camera, tucking it along the A-pillar and headliner for a clean installation.
7. **Test Connection:** Connect the Mini-USB to your dash camera and turn on the vehicle's ignition to test if the dash cam powers on. Turn off the ignition and check if the parking monitor mode activates (if enabled on your dash cam).

Easy Installation



Locate fuse box



Find the correct fuse slot of ACC / BAT(+) with circuit pen



Identify the correct type of fuse for car

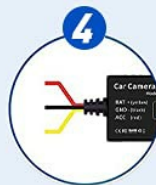

Connect to Red, Yellow, Black cables



The black wire connect the metal (Negative Electrode)



Test dashcam and routing cables if works

Image: Easy installation visual guide.

Crimp the red wire of your hardwire kit onto the Add-A-Fuse

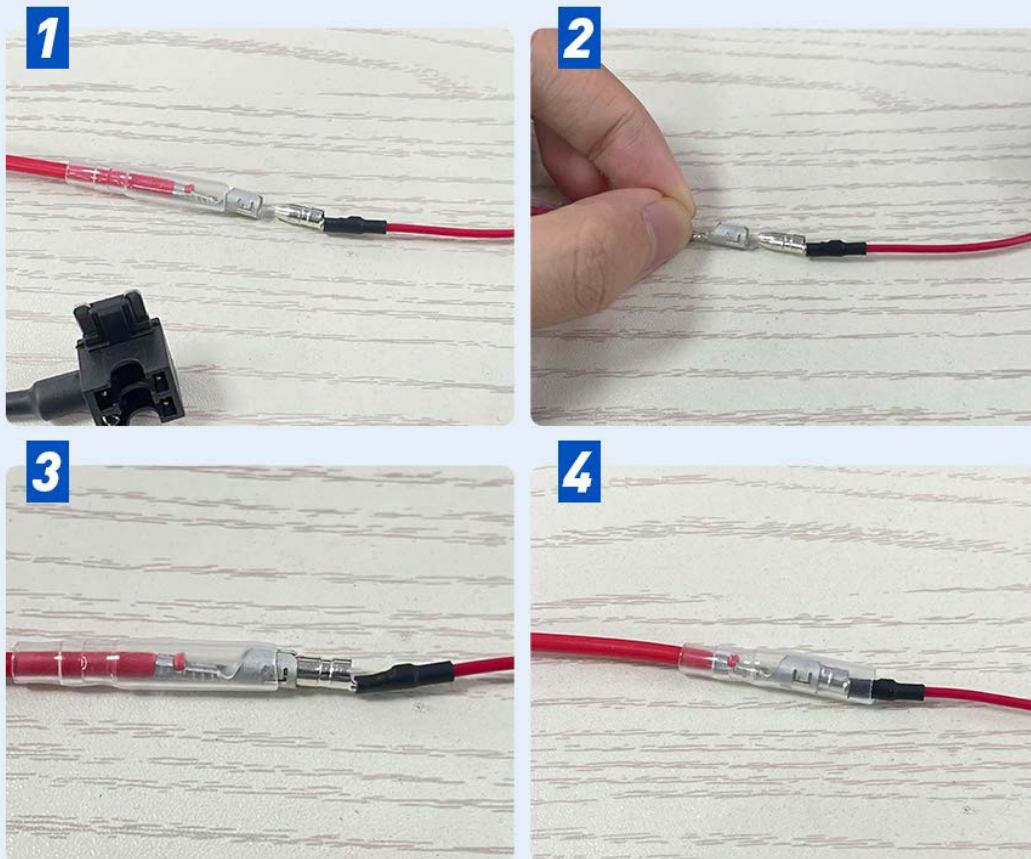

Image: Crimping the red wire onto an Add-A-Fuse.

5.5. Low Voltage Protection Setting

The hardwire kit includes an integrated low voltage protection feature to prevent your vehicle's battery from draining completely. If the vehicle battery voltage drops below a preset threshold, the hardwire kit will automatically cut off power to the dash cam, ensuring enough power remains to start your car.

The main unit of the hardwire kit features DIP switches (small switches) that allow you to select the desired voltage cut-off level. The default cut-off voltages are 11.8V for a 12V DC battery system and 23.6V for a 24V DC battery system. Refer to the markings on the hardwire unit for specific switch configurations to adjust these settings. It is recommended to start with a higher voltage setting and adjust downwards if necessary, to find the optimal balance for your vehicle and usage patterns.

6. OPERATING INSTRUCTIONS

Once correctly installed, the AZDOME JYX02 Hardwire Kit operates automatically:

- **Automatic Power On/Off:** When the vehicle's ignition is turned on, the dash cam connected via the hardwire kit will automatically power on and begin recording. When the ignition is turned off, the dash cam will transition to parking monitor mode (if enabled).
- **24-Hour Parking Monitor Mode:** If your dash cam supports parking monitoring and this feature is enabled, the hardwire kit will provide continuous power from the constant BAT+ connection. This

allows the dash cam to record in time-lapse mode or continuous recording mode when the vehicle is parked, providing surveillance against incidents.

7. MAINTENANCE

- Periodically check all connections (fuse taps, ground wire, Mini-USB) to ensure they are secure.
- Keep the hardwire unit free from dust and moisture.
- No user-serviceable parts are inside the hardwire unit. Do not attempt to open or repair it.

8. TROUBLESHOOTING

8.1. Dash Cam Not Powering On

- Check all fuse connections. Ensure the fuse taps are correctly inserted and the fuses are not blown.
- Verify the ground connection is secure to a bare metal point on the chassis.
- Confirm the Mini-USB cable is securely connected to both the hardwire unit and the dash cam.
- Ensure the vehicle's ignition is on if testing the ACC power.

8.2. Car Battery Drains

- Review the low voltage protection settings on the hardwire unit. Adjust the DIP switches to a higher cut-off voltage if your battery is draining too quickly.
- Ensure the yellow wire (BAT+) is connected to a constant power source, and the red wire (ACC) to an ignition-switched source. Incorrect connection can lead to continuous power draw.
- Consider the duration of parking mode recording and your vehicle's battery health. Frequent short drives may not fully recharge the battery.

8.3. Parking Mode Not Activating

- Verify that the yellow wire (BAT+) is connected to a constant power source.
- Ensure parking monitor mode is enabled in your dash cam's settings.
- Check the low voltage protection settings; if the battery voltage is already below the set threshold, the hardwire kit will cut power.

9. SPECIFICATIONS

Feature	Specification
Model	JYX02
Input Voltage	DC 12V-24V
Output Voltage/Current	DC 5V / 2.5A Max
Connector Type	Mini-USB
Cable Length	Approximately 12 ft (3.6 meters)
Low Voltage Protection	Adjustable (Default: 11.8V for 12V system, 23.6V for 24V system)

Feature	Specification
Product Dimensions	16.1 x 8.89 x 5.41 cm
Item Weight	240 g
Special Features	Over-current, Short-circuit, Reverse Connection, Battery Drain, Overheat Protection

10. WARRANTY AND CUSTOMER SUPPORT





AZDOME provides a **1-YEAR WARRANTY** for this product, covering manufacturing defects from the date of purchase.



For any questions, technical assistance, or warranty claims, please contact AZDOME customer service. Our team is available **24/7 online** to provide support.

Please retain your proof of purchase for warranty validation.

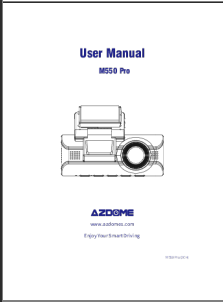
© 2024 AZDOME. All rights reserved.

Related Documents - JYX02

	<p>AZDOME JYX02 Hardwire Kit Owner's Manual for Dashcam Parking Monitor</p> <p>Learn how to install and troubleshoot the AZDOME JYX02 3-Lead Hardwire Kit, enabling 24HR parking monitoring for your dashcam with low voltage protection for 12V and 24V vehicle batteries.</p>
	<p>AZDOME JYX05 Hardwire Kit Owner's Manual and Installation Guide</p> <p>Comprehensive guide to the AZDOME JYX05 Hardwire Kit, covering features, low voltage protection, installation steps, and troubleshooting for safe and efficient dashcam power management.</p>
	<p>AZDOME M550 Pro 4K Dash Cam User Manual and Installation Guide</p> <p>Comprehensive user manual for the AZDOME M550 Pro 4K Dash Cam, covering installation, operation, specifications, and troubleshooting. Learn how to use your M550 Pro dashcam for smart driving.</p>
	<p>AZDOME JYX05 Hardwire Kit Owner's Manual</p> <p>This manual provides instructions for installing and using the AZDOME JYX05 Hardwire Kit, a 3-lead power management device for dashcams. It details low voltage protection settings, fuse tap types, installation steps, and troubleshooting.</p>

<div data-bbox="150 118 272 331"><p>User Manual</p><p>M550 Pro</p><p>AZDOME</p><p>www.azdome.com</p><p>Enjoy Your Smart Driving</p></div>	<p>AZDOME M550 Pro User Manual - 3-Channel Dash Cam Installation & Operation Guide</p> <p>Comprehensive user manual for the AZDOME M550 Pro 3-channel dash cam, covering installation, operation, specifications, and troubleshooting. Learn how to set up and use your M550 Pro dashcam for optimal driving safety and recording.</p>
<div data-bbox="150 416 272 629"><p>User Manual</p><p>M550</p><p>AZDOME</p><p>www.azdome.com</p><p>Enjoy Your Smart Driving</p><p>ENGLISH</p></div>	<p>AZDOME M550 Dash Cam User Manual</p> <p>Comprehensive user manual for the AZDOME M550 Dash Cam, covering installation, operation, video playback, settings, troubleshooting, and specifications for optimal smart driving experience.</p>