

NEWACALOX SN4AB-B

NEWACALOX Magnetic Magnifying Lamp with Helping Hands

Model: SN4AB-B | Brand: NEWACALOX

1. INTRODUCTION

Thank you for choosing the NEWACALOX Magnetic Magnifying Lamp. This device is designed to provide enhanced visibility and illumination for detailed tasks such as soldering, crafting, reading, and various hobby projects. Featuring a 5X magnifying glass, adjustable LED lighting with 5 color modes, and a flexible gooseneck, this lamp offers precision and convenience. Please read this manual thoroughly before use to ensure proper operation and maintenance.

2. SAFETY INFORMATION

- Do not look directly into the LED light source for extended periods to avoid eye strain.
- Keep the magnifying glass away from direct sunlight to prevent fire hazards.
- Ensure the magnetic base is securely attached to a ferromagnetic surface at least 5mm thick to prevent accidental detachment.
- Keep the device away from water or other liquids.
- Use only the provided USB power cable and a compatible power adapter (5V USB).
- Do not attempt to disassemble or modify the lamp. Contact support for assistance.

3. PACKAGE CONTENTS

- 1 x Magnifying Lamp Unit with Flexible Gooseneck
- 1 x Clamp Mount
- 1 x USB Power Cable
- 1 x Wall Power Adapter (USB compatible)

4. SETUP

1. **Attach the Clamp Mount:** Secure the clamp mount to a stable workbench or desk edge. Ensure the surface thickness is suitable for the clamp. Tighten the screw on the clamp until it is firmly in place.
2. **Insert the Lamp Unit:** Insert the base of the magnifying lamp's gooseneck into the designated hole on the clamp mount. Tighten the securing screw on the clamp to hold the lamp firmly.
3. **Connect Power:** Connect the USB power cable to the lamp unit and then to the wall power adapter. Plug the adapter into a standard electrical outlet. Alternatively, the lamp can be powered via any compatible 5V USB power source, such as a power bank.

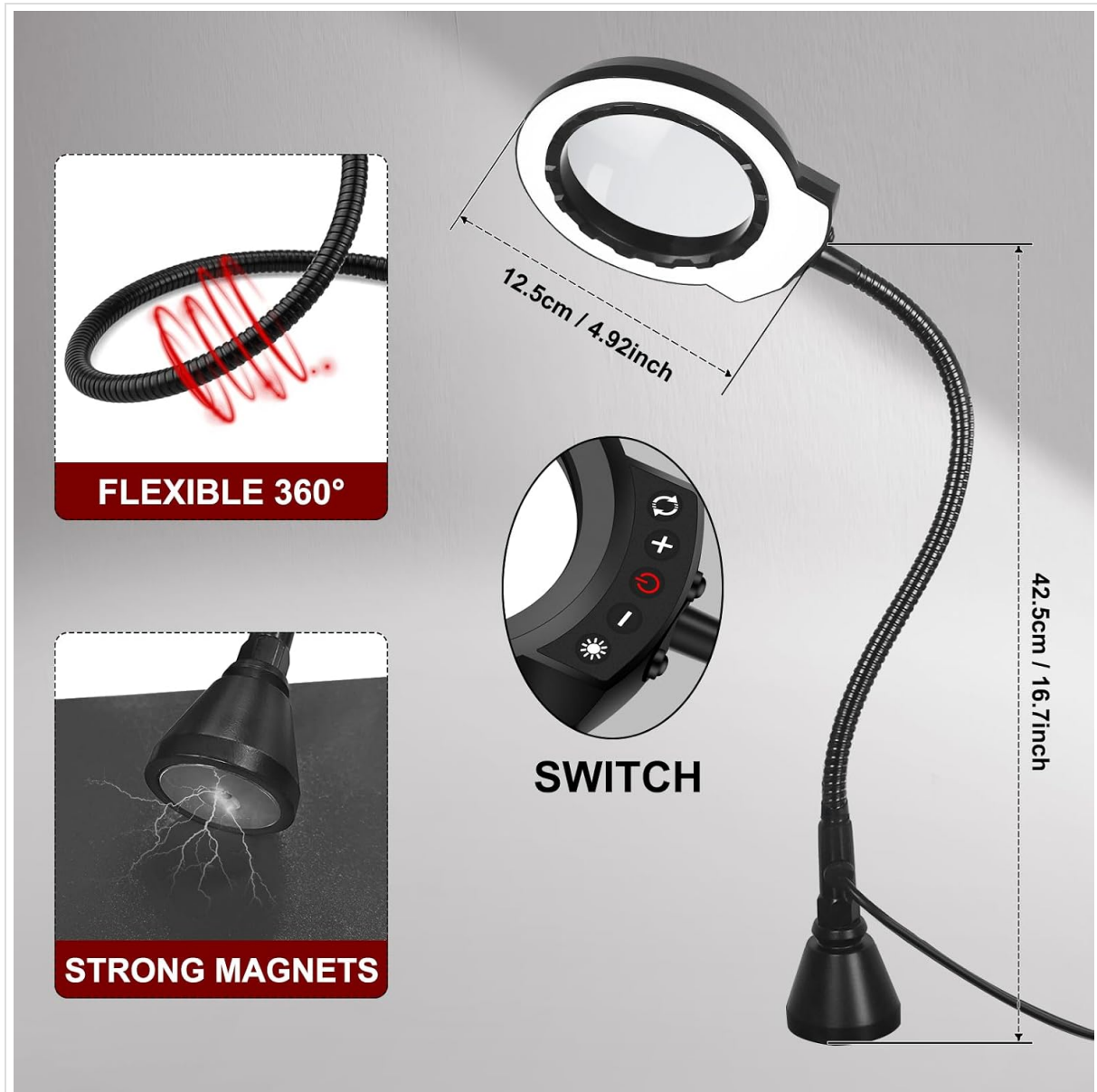

Figure 1: Flexible gooseneck and magnetic base for versatile mounting.

Your browser does not support the video tag.

Video 1: Demonstrates the assembly and magnetic base functionality of the NEWACALOX helping hands station.

5. OPERATING INSTRUCTIONS

1. **Power On/Off:** Press the power button (U) located on the lamp head to turn the light on or off.
2. **Adjust Brightness:** Use the '+' and '-' buttons to increase or decrease the brightness level. The lamp offers 10 levels of stepless dimming.
3. **Change Color Mode:** Press the 'M' button to cycle through the 5 available color modes (e.g., warm white, cool white, natural light).

4. **Positioning the Lamp:** Adjust the flexible gooseneck to position the magnifying glass and light precisely over your work area. The gooseneck allows for 360-degree rotation and stable positioning.



Figure 2: Controls for 5 color modes and 10 brightness levels.

INTUITIVE CONTROLS & PRECISION PLACEMENT

- ✓ Head-Mounted Controls
- ✓ Light Memory Function
- ✓ One-Tap Max Brightness



Figure 3: Intuitive controls located on the lamp head for easy access.

6. APPLICATIONS

The NEWACALOX Magnetic Magnifying Lamp is ideal for a wide range of tasks requiring detailed work and enhanced visibility:

- **Soldering:** Provides a clear, magnified view of circuit boards and small components, making soldering easier and more precise.
- **Crafting & Hobbies:** Perfect for intricate crafts, model building, jewelry making, embroidery, and other detailed hobbies.
- **Reading:** Offers comfortable magnification and adjustable lighting for reading small print or detailed texts.
- **Inspection:** Useful for inspecting small parts, electronics, or documents.



Figure 4: Versatile applications of the magnifying lamp.

Your browser does not support the video tag.

Video 2: Demonstrates the NEWACALOX welding helping hands in action, showing its utility for soldering tasks.

7. MAINTENANCE

- **Cleaning:** Use a soft, dry cloth to clean the lens and lamp body. For stubborn smudges on the lens, use a lens cleaning solution and a microfiber cloth. Do not use abrasive cleaners.
- **Storage:** When not in use, fold the gooseneck to a compact position and store the lamp in a dry, dust-free environment.
- **Cable Care:** Avoid bending or twisting the power cable excessively to prevent damage.

8. TROUBLESHOOTING

Problem	Possible Cause	Solution
Lamp does not turn on.	No power, loose connection, faulty adapter.	Check USB cable connection. Ensure power adapter is plugged in and functional. Try a different USB port or adapter.

Problem	Possible Cause	Solution
Light flickers or is dim.	Insufficient power, faulty cable.	Ensure power source provides adequate 5V output. Replace USB cable if damaged.
Magnifying glass is blurry.	Dirty lens, incorrect focal distance.	Clean the lens with a soft cloth. Adjust the lamp's height and position until the image is clear.
Lamp is unstable.	Clamp not tightened, unsuitable mounting surface.	Ensure the clamp is securely tightened. Verify the mounting surface is stable and thick enough for the clamp.

9. SPECIFICATIONS

Feature	Specification
Model Number	SN4AB-B
Magnification	5X (with 3.14-inch lens diameter)
Light Modes	5 Color Modes (3000K-6000K)
Brightness Levels	10 (10%-100% stepless dimming)
Gooseneck Length	15.7 inches (approx. 40 cm)
Power Source	USB 5V
Item Weight	1.31 Kilograms
Color	Black

10. WARRANTY AND SUPPORT

NEWACALOX products are manufactured to high-quality standards. This product comes with a standard manufacturer's warranty against defects in materials and workmanship. For warranty claims, technical support, or any questions regarding your product, please contact NEWACALOX customer service through the retailer where you purchased the item or visit the official NEWACALOX store online.

Please retain your proof of purchase for warranty purposes.