



Manuals.plus /

- › **Assistive Technology Services** /
- › Xtreme Technologies Xlink BT2 Bluetooth Gateway User Manual

Assistive Technology Services BT2

Xtreme Technologies Xlink BT2 Bluetooth Gateway

Model: BT2

Brand: Assistive Technology Services

1. INTRODUCTION

The Xtreme Technologies Xlink BT2 Bluetooth Gateway allows you to integrate your cellular phone service with your existing home telephone system. This device enables you to make and receive calls on your mobile phone using any standard corded or cordless home telephone, eliminating the need for a traditional landline service. It provides the convenience of using your familiar home phones while leveraging your mobile plan.

2. SAFETY INFORMATION

- Read all instructions carefully before using the device.
- Keep the device away from water, moisture, and extreme temperatures.
- Do not attempt to open, modify, or repair the device yourself. Refer all servicing to qualified personnel.
- Use only the provided USB power cable and a compatible 5V USB power adapter (not included).
- Place the device in a well-ventilated area to prevent overheating.
- Avoid placing the device near strong electromagnetic fields.

3. PACKAGE CONTENTS

Please check the box for the following items:

- Xlink BT2 Bluetooth Gateway
- USB Power Cable
- Telephone Line Cord
- User Manual (This document)

4. PRODUCT OVERVIEW

4.1. Key Features

- Connects cell phones to home telephones via Bluetooth.
- Allows making and receiving cell phone calls on any connected home phone.
- Compatible with most Bluetooth-enabled cell phones.
- Supports multiple home telephones (corded or cordless systems).
- Ideal for replacing traditional landline service.
- Can be used to connect landline devices like medical alert systems to a cell phone.
- No monthly fees for the Xlink BT2 device itself.

4.2. Device Layout

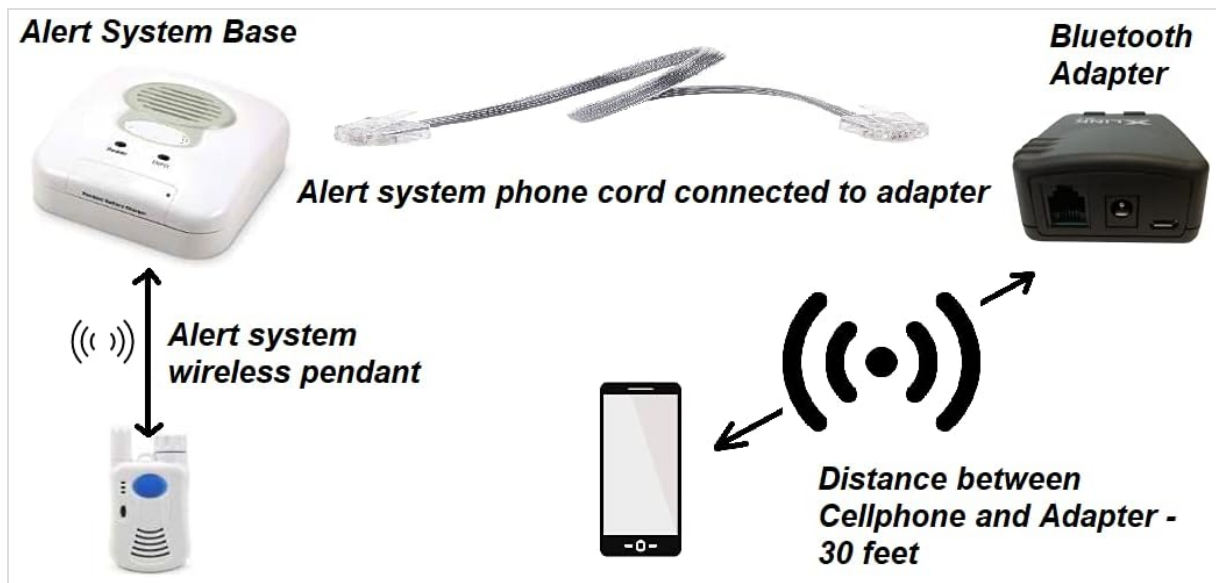

The Xlink BT2 Bluetooth Gateway, a compact device designed to bridge your mobile and home phone systems.



Rear view of the Xlink BT2, showing the phone line input, power input, and USB charging port.

- **Phone Port (RJ11):** Connects to your home telephone system.

- **5V In (Micro USB):** Power input for the device.
- **5V Out (USB-A):** Optional port for charging a cell phone (power output).
- **Bluetooth Indicator LED:** Shows Bluetooth connection status.
- **Ring Indicator LED:** Illuminates when an incoming call is detected.
- **Pairing Button:** Initiates Bluetooth pairing mode.
- **Test Ring Button:** Triggers a test ring on connected home phones.

5. SETUP

Follow these steps to set up your Xlink BT2 Bluetooth Gateway:

1. **Power Connection:** Connect the provided USB power cable to the "5V In" port on the Xlink BT2. Plug the other end into a 5V USB power adapter (not included) and then into a wall outlet. The Bluetooth indicator LED will light up, indicating the device is powered on.
2. **Telephone Connection:** Connect one end of the telephone line cord to the "Phone" port on the Xlink BT2. Connect the other end to your home telephone wall jack or directly to your cordless phone base unit. Ensure all home phones are properly connected to your home telephone system.
3. **Bluetooth Pairing:**
 - Ensure your cell phone's Bluetooth is enabled and discoverable.
 - Press and hold the "Pairing" button on the Xlink BT2 until the Bluetooth indicator LED flashes rapidly.
 - On your cell phone, search for new Bluetooth devices and select "Xlink BT2" from the list.
 - Once successfully paired, the Bluetooth indicator LED on the Xlink BT2 will glow steadily.
 - *Note:* The Xlink BT2 can typically pair with up to two cell phones. If pairing a second phone, repeat the process.



Illustration of the Xlink BT2 connecting to a standard wall outlet, a cordless phone base, and multiple cordless handsets.

An official video demonstrating the core functionality of the Xlink BT2, highlighting how it enables landline phones to operate without a traditional landline service by connecting to a cell phone.

6. OPERATING INSTRUCTIONS

6.1. Making a Call

1. Pick up any connected home telephone. You should hear a dial tone.
2. Dial the desired phone number. The call will be routed through your paired cell phone.

6.2. Receiving a Call

1. When your paired cell phone receives an incoming call, all connected home telephones will ring.
2. Pick up any connected home telephone to answer the call.

6.3. Using with Medical Alert Systems

The Xlink BT2 can be used to connect landline-based medical alert systems to your cell phone service:

1. Connect the medical alert system's phone line to the Xlink BT2's "Phone" port.
2. Ensure the Xlink BT2 is powered on and reliably paired with a cell phone that has active cellular service.
3. Test the medical alert system according to its own instructions to confirm it can make calls through the Xlink BT2.

7. TROUBLESHOOTING

If you encounter issues with your Xlink BT2, please refer to the following common problems and solutions:

- **No Dial Tone:**
 - Check if the Xlink BT2 is powered on (Bluetooth LED should be lit).
 - Ensure the telephone line cord is securely connected to both the Xlink BT2 and your home phone system.
 - Verify your cell phone is paired and within Bluetooth range of the Xlink BT2.
- **Cannot Make/Receive Calls:**
 - Confirm your cell phone has cellular service and is not in airplane mode.
 - Check the Bluetooth connection status on both the Xlink BT2 and your cell phone. Re-pair if necessary.
 - Ensure the Xlink BT2 is not too far from your cell phone (typical Bluetooth range is about 30 feet/10 meters).
- **Poor Audio Quality:**
 - Move your cell phone closer to the Xlink BT2.
 - Ensure there are no physical obstructions or sources of electromagnetic interference between the devices.
 - Check your cell phone's signal strength in its current location.
- **Home Phones Not Ringing:**
 - Verify the Xlink BT2 is powered on and successfully paired with your cell phone.
 - Ensure your home phone system is functioning correctly.
 - Press the "Test Ring" button on the Xlink BT2 to confirm it can send a ring signal to your home phones.

8. SPECIFICATIONS

Model	BT2
Connectivity	Bluetooth Wireless Technology
Power Input	5V DC (via Micro USB)
Power Output	5V DC (via USB-A, for charging)
Weight	10.5 ounces (297.67 grams)
Compatible Devices	Bluetooth-enabled Smartphones
Special Feature	No Monthly Fees

9. WARRANTY AND SUPPORT

For warranty information, technical assistance, or customer support, please refer to the manufacturer's official website or contact Assistive Technology Services directly. Please retain your purchase receipt as proof of purchase for any warranty claims.