

Hiseeu 8PK-10V-4HB905-3T

Hiseeu 5MP POE Wired Security Camera System

MODEL: 8PK-10V-4HB905-3T - INSTRUCTION MANUAL

1. INTRODUCTION

Thank you for choosing the Hiseeu 5MP POE Wired Security Camera System. This manual provides detailed instructions for the proper installation, operation, and maintenance of your new security system. Please read this manual thoroughly before use and retain it for future reference. This system is designed for both indoor and outdoor use, offering high-resolution surveillance with advanced features for enhanced security.

2. PACKAGE CONTENTS

The Hiseeu 5MP POE Wired Security Camera System includes the following components:

- 1 x 5MP POE NVR (with 3TB HDD pre-installed)
- 4 x 5MP POE Cameras
- 1 x 48V Power Adapter
- 4 x LAN Cables for Cameras (2x 20m, 2x 30m)
- 1 x LAN Cable (1m, for system online)
- 1 x HDMI Cable
- 1 x USB Mouse
- 1 x Japanese Instruction Manual
- 1 x Warning Sticker
- Mounting Screws and Anchors



Figure 2.1: All components included in the Hiseeu 5MP POE Security Camera System package.

3. PRODUCT OVERVIEW

The Hiseeu 5MP POE Wired Security Camera System is designed for reliable and high-quality surveillance. Key features include:

- **5MP High-Resolution Cameras:** Capture clear and detailed images with 5-megapixel resolution.
- **POE (Power over Ethernet) Connectivity:** Cameras receive power and transmit data through a single LAN cable, simplifying installation.
- **10-inch Monitor NVR:** The Network Video Recorder features an integrated 10-inch monitor for convenient live viewing and playback.
- **3TB Hard Disk Drive (HDD):** Provides ample storage for up to 90 days of continuous recording from 4 cameras.
- **H.265+ Compression Technology:** Efficiently compresses video files to save storage space without compromising video quality.

- **IP66 Waterproof Rating:** Cameras are built to withstand harsh weather conditions, suitable for both indoor and outdoor environments.
- **Human Motion Detection:** Advanced sensors detect human movement, triggering alerts and recording.
- **Two-Way Audio:** Communicate with visitors or deter intruders using the built-in microphone and speaker.
- **Smart Night Vision:** Features strong LED lights and infrared LEDs for clear night vision, automatically switching modes when human motion is detected.
- **Remote Viewing:** Access live feeds and recordings from your smartphone or PC via a dedicated app.



発光威嚇

NVR本体でスマートモードに設置すれば、移動する物体が検知された途端、自動的に発光威嚇します。

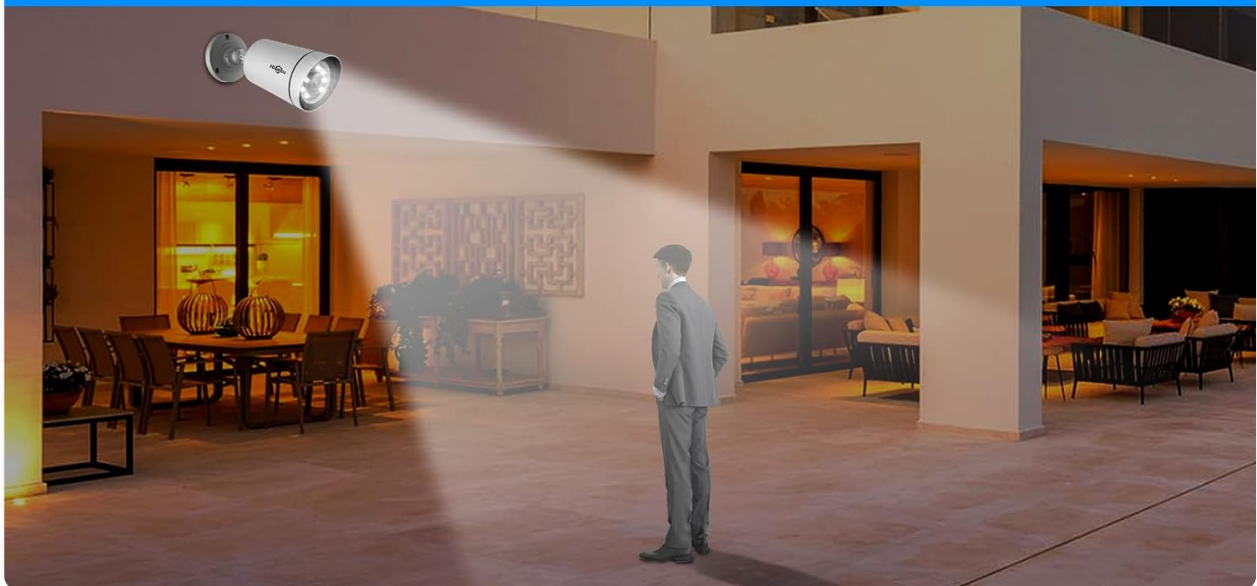

Figure 3.1: Overview of the Hiseeu 5MP POE Security Camera features, including high resolution and POE connectivity.



Figure 3.2: The camera's IP66 waterproof and dustproof design ensures reliable operation in temperatures from -25°C to 50°C, suitable for all weather conditions.

簡単設定



増設可能



Figure 3.3: Comparison showing the superior clarity of 5MP resolution compared to 2MP, providing sharper and more detailed images.



500万超高解像度



200万画素



Figure 3.4: H.265+ video compression technology reduces file sizes by 50% compared to H.264, allowing for longer recording times on the 3TB HDD.

4. SETUP GUIDE

4.1 Simple Connection

The Hiseeu POE system offers a straightforward setup process. Connect the cameras to the NVR using LAN cables. The NVR provides power to the cameras, eliminating the need for separate power adapters for each camera.



Figure 4.1: Simple setup with POE cameras connected directly to the NVR via LAN cables for both power and data transmission.

4.2 NVR and Monitor Connection

The NVR has an integrated 10-inch monitor. For larger displays, connect an external monitor via the HDMI port for higher resolution viewing.



Figure 4.2: The NVR can be connected to an external monitor via HDMI for a larger display, showing multiple camera feeds simultaneously.

4.3 Network Setup for Remote Access

To enable remote viewing via smartphone or PC, connect the NVR to your router using a LAN cable. This allows the system to access the internet.

Your browser does not support the video tag.

Video 4.1: This video demonstrates the network setup process for the HiSeeu security camera system, including connecting the NVR to a router for internet access.

5. OPERATING INSTRUCTIONS

5.1 Remote Monitoring via App

Once the NVR is connected to the internet, you can download the dedicated HiSeeu app on your smartphone or PC to view live feeds and recordings from anywhere.

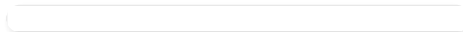

Figure 5.1: The HiSeeu app allows for remote viewing of camera feeds on smartphones and computers, providing real-time surveillance and playback.

Your browser does not support the video tag.

Video 5.1: This video provides a detailed explanation of smartphone remote operation, demonstrating easy connection for beginners.

5.2 Human Motion Detection and Alerts

The system features advanced human motion detection. When human movement is detected, the camera can automatically activate strong LED lights to deter intruders and send instant notifications to your smartphone app. You can also set the NVR to sound a buzzer.

H.265+圧縮技術・映像保存



3TB HDD内蔵、4台
同時に90日以上録画可能

H.265+

H.264

3TB(H.265+)容量=6TB(H.265)容量

50%

100%

同じ映像データで占める容量

動体検知



Figure 5.2: The system detects human motion, triggers strong LED lights for deterrence, and sends app notifications. The NVR can also sound a buzzer.

Your browser does not support the video tag.

Video 5.2: This video provides a product explanation, highlighting features like motion detection and alerts.

5.3 Two-Way Audio

The cameras are equipped with a built-in microphone and speaker, enabling two-way audio communication through the app. This allows you to speak to individuals near the camera or listen to audio from the surveillance area.



Figure 5.3: The two-way audio feature allows for clear communication through the camera's built-in microphone and speaker, enabling interaction with people at the monitored location.

5.4 Recording and Storage

The NVR comes with a 3TB HDD, allowing for continuous recording from 4 cameras for up to 90 days. The system supports various recording modes, including continuous recording and motion-triggered recording. H.265+ compression ensures efficient storage utilization.



Figure 5.4: The 3TB HDD, combined with H.265+ compression, allows for extended recording periods, storing up to 90 days of footage from 4 cameras.

6. ADVANCED FEATURES

6.1 Smart Night Vision Modes

The cameras offer multiple night vision modes: Smart Mode, Infrared Night Vision, and Full-Color Night Vision. In Smart Mode, the camera automatically activates strong LED lights when human motion is detected at night, providing a clear, full-color image and acting as a deterrent.



Figure 6.1: The system offers Smart Mode, Infrared Night Vision, and Full-Color Night Vision for optimal surveillance in low-light conditions.

7. SPECIFICATIONS

Feature	Specification
---------	---------------

Feature	Specification
Brand	Hiseeu
Model Number	8PK-10V-4HB905-3T
Product Dimensions	11 x 9 x 4.3 cm
Item Weight	6.9 Kilograms
Color	POE Set
Power Source	Corded Electric
Special Features	Waterproof, Motion Detection
Connectivity Technology	Wired
Video Capture Resolution	1920p (5MP)
Number of Channels	8 (supports up to 8 cameras)

8. TROUBLESHOOTING

If you encounter any issues with your Hiseeu security camera system, please refer to the following common troubleshooting steps:

- **No Image on Monitor:** Ensure all cables (power, HDMI/VGA, LAN) are securely connected. Check if the NVR and monitor are powered on.
- **No Remote Access:** Verify the NVR is connected to your router via LAN cable and has internet access. Check your network settings and ensure the app is correctly configured.
- **Poor Image Quality:** Ensure camera lenses are clean. Check the resolution settings in the NVR or app. For night vision, ensure the area is within the camera's effective range.
- **Motion Detection Not Working:** Verify motion detection is enabled in the settings. Adjust sensitivity levels and detection zones to prevent false alarms.
- **No Recording:** Check the 3TB HDD status in the NVR settings. Ensure recording schedules are correctly configured.

9. WARRANTY AND SUPPORT

In the unlikely event that your camera arrives damaged or has a defect, please contact us via email. Free repair or exchange may be available. Our support team is available from 9:30 AM to 7:00 PM (Japan Standard Time).

For further assistance, please visit the official website of your local government for information on crime prevention subsidy programs, as these may help with the cost of security equipment.

