

Manuals+

[Q & A](#) | [Deep Search](#) | [Upload](#)

[manuals.plus](#) /

› [Yaheetech](#) /

› [Yaheetech Bathroom Floor Cabinet Instruction Manual](#)

Yaheetech YT-0010446908

Yaheetech Bathroom Floor Cabinet Instruction Manual

Model: YT-0010446908

Brand: Yaheetech

PRODUCT OVERVIEW

The Yaheetech Bathroom Floor Cabinet is a freestanding storage organizer designed for various spaces, including bathrooms and kitchens. This unit features four drawers and a cupboard with an adjustable shelf, providing versatile storage solutions for cosmetics, toiletries, towels, toilet paper, and other household items. Its sleek rectangular design with beadboard panels allows it to blend seamlessly with diverse home décors, from traditional to modern.



Figure 1: Front view of the Yaheetech Bathroom Floor Cabinet in grey.

SAFETY INFORMATION

For your safety and to prevent tipping, it is crucial to always secure the cabinet to the wall using the provided wall mounting hardware. Exercise caution when opening and closing drawers to avoid potential injuries from sudden movement. Ensure all components are correctly assembled and tightened before use.



Figure 2: Illustration of the wall mounting hardware for enhanced stability.

COMPONENTS AND PARTS LIST

Before beginning assembly, verify that all parts and hardware are present and undamaged. Refer to the included instruction manual for a detailed list and identification of each component. Key components include:

- Cabinet panels (top, bottom, sides, back)
- Four drawer units with cutout handles
- One cupboard door with silver knob
- Adjustable shelf and shelf pins

- Magnetic door catch
- Metal hinges for the cupboard door
- Wall mounting hardware (anti-tip kit)
- Assembly screws, dowels, and plastic stoppers for drawers



Figure 3: Detailed view of the magnetic door, metal hinges, and silver knob.

SETUP AND ASSEMBLY INSTRUCTIONS

Assembly of the Yaheetech Bathroom Floor Cabinet typically takes 1 to 2 hours with a hand screwdriver. Follow the step-by-step pictorial instructions provided in the included manual. Ensure all pre-drilled holes align correctly. It is recommended to use wood glue on dowels for added stability, although not strictly required. The back panels are designed to slot into place, providing a secure fit.

1. Unpack all components and lay them out on a clean, soft surface to prevent scratches.
2. Identify each part using the labels and the parts list in the manual.

3. Assemble the main frame of the cabinet according to the diagrams.
4. Install the adjustable shelf at your desired height (16 cm/6.3", 22.5 cm/8.9", or 28.8 cm/11.3").
5. Assemble the four drawers, ensuring the plastic stoppers are correctly installed to prevent them from pulling out completely.
6. Attach the cupboard door using the metal hinges and install the silver knob.
7. Secure the cabinet to the wall using the provided wall mounting hardware for safety.



Figure 4: Cabinet dimensions and adjustable shelf height options.

OPERATING INSTRUCTIONS

This cabinet is designed for ease of use and efficient storage.

- **Drawers:** The four drawers slide smoothly on wooden runners. They are equipped with plastic stoppers to prevent accidental removal, ensuring contents remain secure. Each drawer is spacious enough to hold standard 8.5 x 11 inch paper with room to spare.
- **Cupboard:** The cupboard door is secured with a magnetic catch, allowing for quiet and secure closure. The

internal shelf can be adjusted to three different heights to accommodate items of varying sizes.



Figure 5: Close-up of the adjustable shelf mechanism.

MAINTENANCE

To ensure the longevity and appearance of your Yaheetech Bathroom Floor Cabinet, follow these maintenance guidelines:

- **Cleaning:** Wipe surfaces with a soft, damp cloth. Avoid abrasive cleaners or harsh chemicals that may damage the painted finish.
- **Spills:** Promptly wipe up any spills, especially in wet environments like bathrooms, to prevent water damage. The cabinet is made from P2-compliant material, which offers some resistance to moisture.
- **Hardware:** Periodically check all screws and fittings to ensure they remain tight. Re-tighten if necessary.
- **Drawer Runners:** Keep wooden drawer runners free of debris to maintain smooth operation.

GREEN P2-COMPLIANT MATERIAL

Waterproof, Easy to Clean, Green



Formaldehyde Emission:

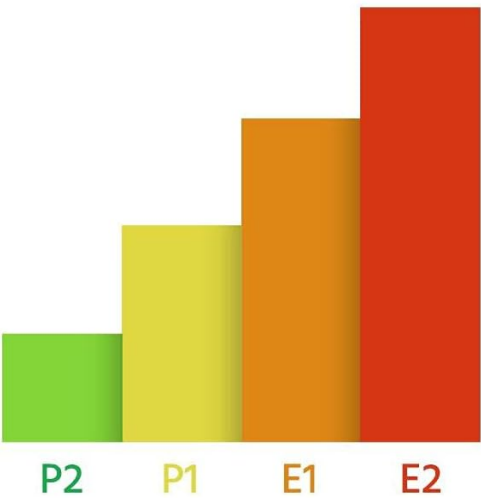

Figure 6: The cabinet is constructed from P2-compliant material for durability and environmental considerations.

TROUBLESHOOTING

Problem	Possible Cause	Solution
Cabinet feels wobbly or unstable.	Not properly secured to the wall; loose fittings.	Ensure wall mounting hardware is correctly installed and tightened. Check and tighten all assembly screws.
Drawers do not slide smoothly.	Debris on runners; misaligned drawer.	Clean wooden runners. Check drawer assembly for correct alignment.
Cupboard door does not close properly.	Misaligned hinges; magnetic catch not engaging.	Adjust hinges. Ensure magnetic catch components are aligned and securely fastened.

SPECIFICATIONS

Brand:	Yaheetech
Model Number:	YT-0010446908
Color:	Grey
Product Dimensions (L x W x H):	22 x 12 x 32.5 inches (55.9 x 30.5 x 82.6 cm)
Material:	Engineered Wood (P2-compliant MDF Board)
Weight Limit:	88.2 lbs (40 kg)
Number of Drawers:	4
Adjustable Shelves:	1 (3 height options: 6.3", 8.9", 11.3")
Assembly Required:	Yes

WARRANTY AND SUPPORT

For any questions, concerns, or assistance with your Yaheetech Bathroom Floor Cabinet, please contact Yaheetech customer support. Refer to the contact information provided in your product packaging or visit the official Yaheetech website for support details.

While specific warranty details are not provided here, most Yaheetech products come with a standard manufacturer's warranty covering defects in materials and workmanship. Please retain your proof of purchase for warranty claims.

© 2025 Yaheetech. All rights reserved.

Related Documents - YT-0010446908

<div><div>Yaheetech</div><div>612501</div><div></div><div><p>1. Check that the floor is level and clean before assembly.</p><p>2. Lay out all parts and hardware to ensure you have everything you need.</p><p>3. Follow the steps in the order shown in the diagram to assemble the cabinet.</p><p>4. Use the provided hardware to secure the cabinet to the wall.</p></div></div>	<div><div>Yaheetech 612501 Assembly Instructions: Wooden Storage Cabinet</div><div>Step-by-step assembly instructions for the Yaheetech 612501 wooden storage cabinet. Includes parts list, hardware details, assembly steps, and wall anchoring guide for home organization.</div></div>
--	---



611798

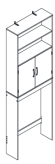

- 09 - Please read the instruction manual carefully before attempting to install.
08 - Bitte lesen Sie diese Bedienungsanleitung vor der Montage gründlich durch.
03 - Per favore leggere attentamente il manuale di istruzioni prima di tentare l'installazione.
06 - Lirea atentamente este manual antes de comenzar la montaje.
07 - Si prega di consultare l'libretto delle istruzioni prima del montaggio.

Comprehensive installation guide for the Yaheetech Over The Toilet Storage Cabinet, including multilingual instructions, parts list, and wall anchoring procedures.



- © 2000 The Authors
Journal compilation © 2000 Blackwell Science Ltd

Comprehensive assembly instructions and safety information for the Yaheetech 5-Tier Home Organization Furniture Unit, a versatile shelving solution for home organization.



- [illegible]

This document provides detailed assembly instructions for the Yaheetech Over The Toilet Storage Cabinet (Model #610824). It guides users through the setup of this tall bathroom organizer, featuring adjustable shelves and double doors, to efficiently utilize bathroom space.



- 64 – Wie lesen Sie diese Endverwendungserklärung vor der Montage gründlich durch.

Comprehensive guide for assembling the Yaheetech 613812 storage cabinet. Includes a detailed parts list, step-by-step assembly instructions, and essential wall anchoring safety information.



- 88 • Bitte lesen Sie diese Bedienungsanleitung vor der Montage gründlich durch.

Comprehensive assembly instructions for the Yaheetech 613761 storage cabinet, detailing parts, step-by-step assembly, and wall anchoring guidance.