

[Manuals.plus](#) /

> [maylit](#) /

> maylit 8 PCS RGB Under Cabinet Lighting Kit Instruction Manual

maylit RGB Under Cabinet Lights 13FT

maylit 8 PCS RGB Under Cabinet Lighting Kit Instruction Manual

Model: RGB Under Cabinet Lights 13FT

1. PRODUCT OVERVIEW

The maylit 8 PCS RGB Under Cabinet Lighting Kit provides customizable, multi-color LED lighting for various indoor applications. This kit includes eight pre-cut light strips, connectors, and a certified power adapter, offering flexible installation and control via a remote or a smartphone application. Features include music synchronization, color changing capabilities, and a timer function.



Image: Overview of the maylit RGB Under Cabinet Lighting Kit, showing the individual light strips, power adapter, remote control, and a smartphone displaying the app interface. Also shown are examples of the lights installed under kitchen cabinets and shelves, illuminating the spaces with vibrant colors.

2. PACKAGE CONTENTS

Verify that all components are present in your package:

- 8 x 20-inch RGB LED Light Strips (total 13ft)
- 8 x 4.7-inch Connectors
- 1 x ETL Listed Power Adapter
- 1 x 40-Key IR Remote Control
- Fixed Clips for reinforcement
- User Manual

Size & Installation

1 8 PCS Light Strips



2 8 PCS Connectors, they can be combined freely to cross different gaps.



3 ETL Listed Power Adapter



1. Keep the surface clean

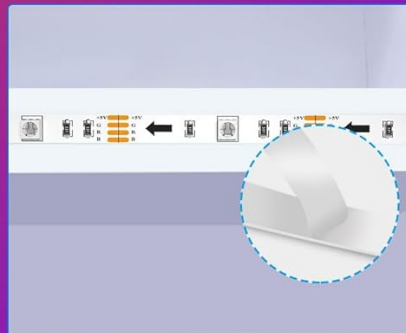

2. Stick the light strip



3. Use fixed clips to reinforce

Image: A diagram illustrating the components of the lighting kit, including eight 20-inch light strips, eight 5.9-inch connectors, and a 3-foot ETL listed power adapter. The diagram also shows the dimensions of the light strips (0.39 inches wide) and connectors.

3. SPECIFICATIONS

Brand	maylit
Model Number	RGB Under Cabinet Lights 13FT
Light Source Type	LED
Light Color	Multicolor (RGB)
Power Source	AC/DC
Voltage	12 Volts (DC)
Wattage	5 watts

Number of Light Sources	240
Control Method	App, Remote Control
Special Features	App Controlled, Remote Control, Music Sync, Color Changing, Adjustable, Timer, Dimmable
Indoor/Outdoor Usage	Indoor use only
Water Resistance Level	Not Water Resistant
Material	PCB+LED
Item Weight	6.4 ounces
Package Dimensions	9.13 x 5.39 x 0.87 inches

4. SAFETY INFORMATION

Please read and understand all safety instructions before installation and use. Failure to follow these instructions may result in electric shock, fire, or other hazards.

- **Indoor Use Only:** This product is designed for indoor use. Do not expose to water or moisture.
- **Power Source:** Use only the provided ETL Listed power adapter. Using an incompatible power adapter may damage the product and void the warranty.
- **Installation Surface:** Ensure the installation surface is clean, dry, and smooth to ensure proper adhesion of the light strips.
- **Cable Management:** Route cables safely to prevent tripping hazards or damage.
- **Ventilation:** Ensure adequate ventilation around the power adapter to prevent overheating.
- **Children and Pets:** Keep the product and its components out of reach of children and pets.



Image: A close-up of the ETL Listed power adapter, highlighting its safety certifications. This adapter is essential for safe and proper operation of the lighting kit.

5. SETUP AND INSTALLATION

Follow these steps for proper installation of your maylit RGB Under Cabinet Lighting Kit:

1. **Prepare the Surface:** Ensure the surface where the light strips will be installed is clean, dry, and free of dust or grease. Wipe the area thoroughly.
2. **Plan Layout:** Determine the desired layout for your light strips. The 8 included connectors allow for flexible arrangements to cross gaps or navigate corners.
3. **Attach Light Strips:** Peel off the protective backing from the adhesive on the back of each light strip. Carefully press the strip onto the prepared surface, ensuring firm contact.
4. **Use Fixed Clips:** For enhanced durability and adhesion, use the provided fixed clips to reinforce the light strips, especially at corners or where extra support is needed.
5. **Connect Components:** Connect the light strips to each other using the provided connectors. Ensure all connections are secure.

6. **Connect Power Adapter:** Plug the power adapter into the main control unit (if separate) or directly into the first light strip, then plug the adapter into a standard wall outlet.

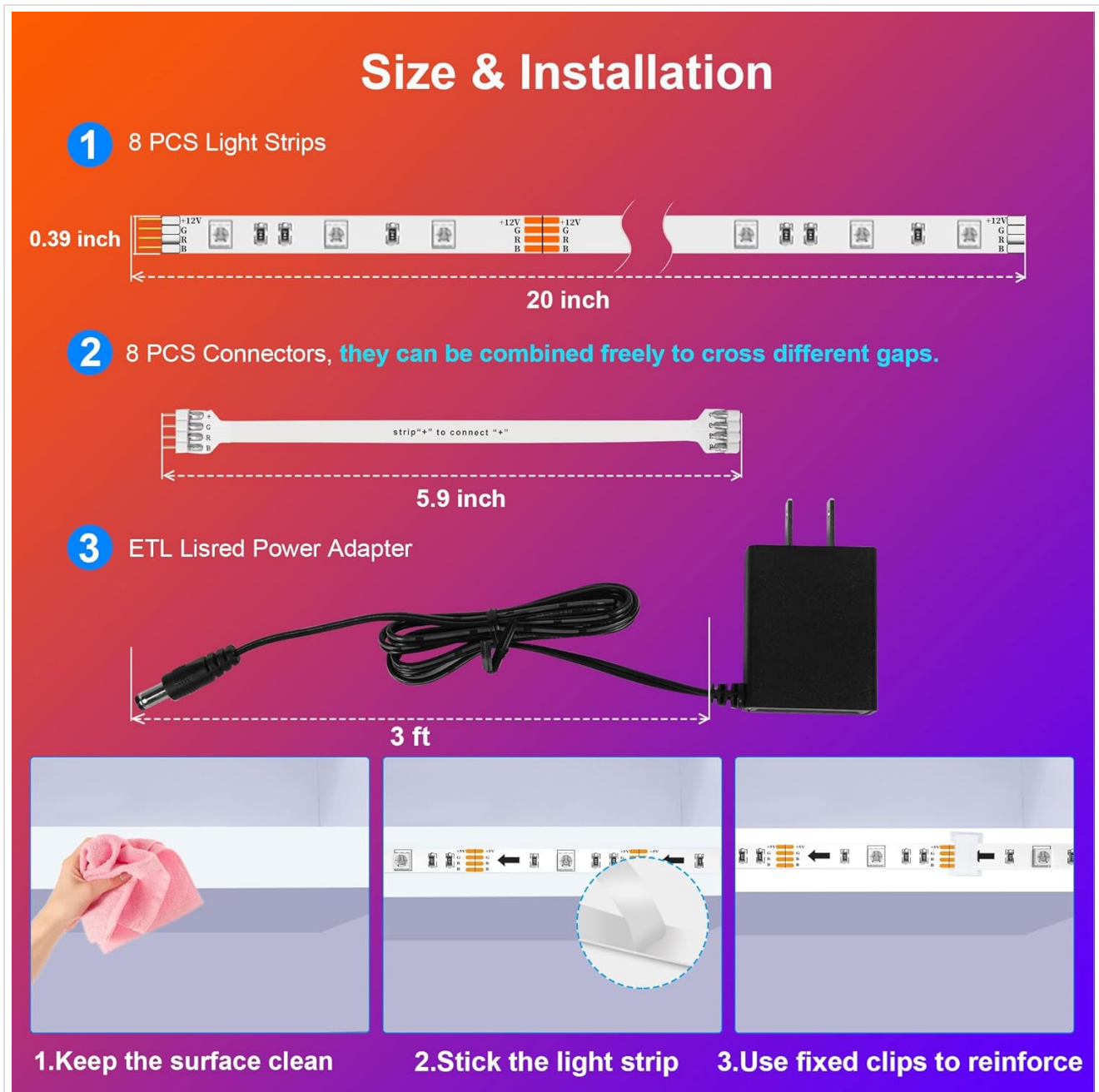

Image: A visual guide demonstrating the installation process: 1. Keep the surface clean. 2. Stick the light strip using its self-adhesive backing. 3. Use fixed clips to reinforce the light strip for better stability.

6. OPERATING INSTRUCTIONS

Your maylit RGB Under Cabinet Lighting Kit can be controlled using the included IR remote or a smartphone application.

6.1 Remote Control Operation

The 40-key IR remote allows for basic control of the lighting kit:

- **Power On/Off:** Press the ON/OFF buttons.
- **Color Selection:** Choose from 16 million colors using the color buttons.
- **Brightness Adjustment:** Use the up/down arrows to increase or decrease brightness.
- **Dynamic Modes:** Select various pre-programmed dynamic lighting effects.

- **Timing Function:** Set a timer for the lights to turn on or off.
- **Memory Function:** The lights will remember the last setting used.

6.2 Smartphone App Control

For advanced features, download the compatible smartphone application (refer to the product packaging or included manual for app name and QR code). The app offers:

- **Full Color Spectrum:** Access to 16 million colors.
- **Brightness and Saturation Control:** Fine-tune light intensity and color vibrancy.
- **Music Sync Mode:** The lights will change color and rhythm with music played through your phone's microphone.
- **Mic Mode:** Lights react to ambient sounds detected by your phone's microphone.
- **Custom Dynamic Modes:** Create and save personalized lighting effects.
- **Advanced Timer Function:** Schedule specific on/off times.

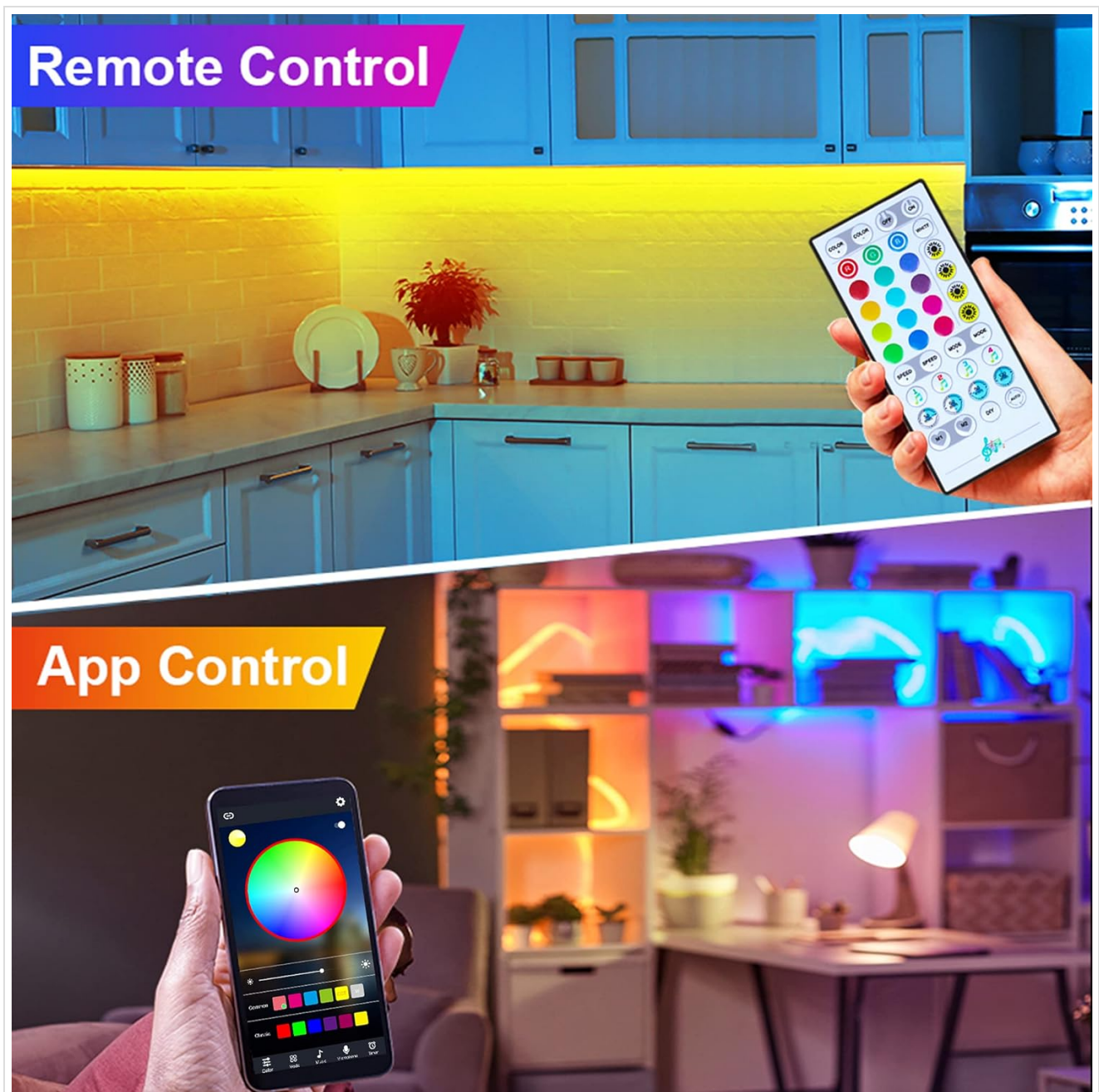
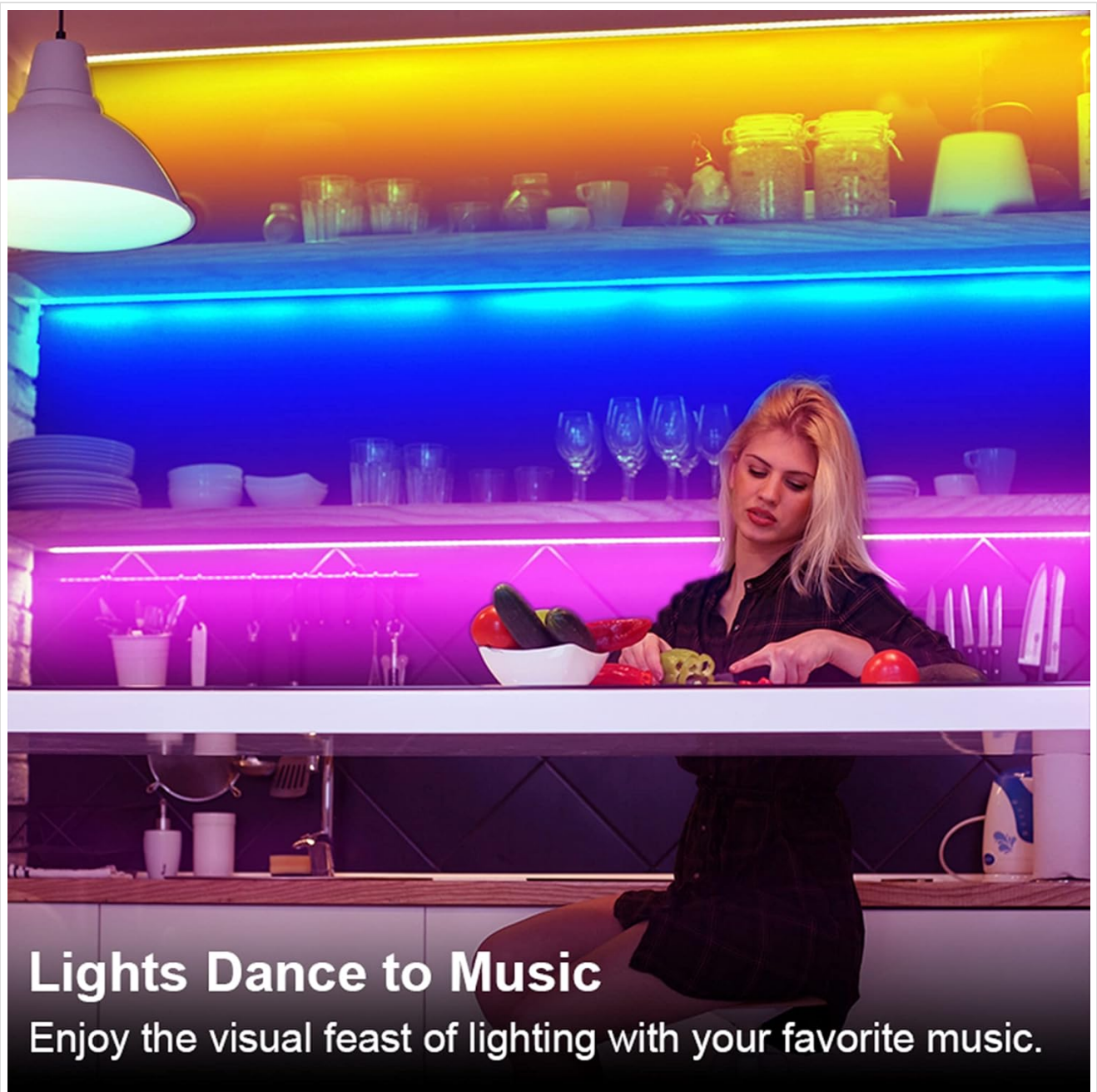

Image: A split image showing the dual control options: a hand holding the physical remote control with various color and function buttons, and a smartphone displaying the app interface with a color wheel and control options. Both are shown controlling under-

cabinet lighting.



Lights Dance to Music

Enjoy the visual feast of lighting with your favorite music.

Image: A woman in a kitchen setting with under-cabinet lights changing colors in sync with music, demonstrating the 'Music Sync' feature. The text overlay reads 'Lights Dance to Music'.

Timer Setting

Set a time to turn on/off your lights.



Image: A bedroom illuminated with colorful LED strip lights along the ceiling and under furniture, with a text overlay indicating 'Timer Setting: Set a time to turn on/off your lights'. This illustrates the timer functionality.

7. MAINTENANCE

To ensure the longevity and optimal performance of your lighting kit, follow these maintenance guidelines:

- **Cleaning:** Gently wipe the light strips and power adapter with a dry, soft cloth. Do not use liquid cleaners or abrasive materials.
- **Connection Check:** Periodically check all connections to ensure they are secure and free from damage.
- **Avoid Bending:** Do not excessively bend or twist the light strips, as this can damage the internal wiring.
- **Storage:** If storing the lights, ensure they are kept in a dry, cool place, away from direct sunlight.

8. TROUBLESHOOTING

If you encounter issues with your maylit RGB Under Cabinet Lighting Kit, refer to the following common problems and solutions:

Problem	Possible Cause	Solution
Lights do not turn on.	<ul style="list-style-type: none"> • Power adapter not plugged in. • Loose connection. • Remote control battery depleted. 	<ul style="list-style-type: none"> • Ensure power adapter is securely plugged into an outlet and the light strips. • Check all strip and connector connections. • Replace the remote control battery.
Remote control not working.	<ul style="list-style-type: none"> • Remote battery depleted. • Obstruction between remote and receiver. • Remote not pointed at receiver. 	<ul style="list-style-type: none"> • Replace the remote control battery. • Ensure a clear line of sight to the IR receiver. • Point the remote directly at the IR receiver.
Certain colors or sections are not lighting up.	<ul style="list-style-type: none"> • Damaged light strip or connection. • Incorrect wiring. 	<ul style="list-style-type: none"> • Inspect the affected light strip and its connections for any visible damage or loose contacts. Handle strips carefully during installation to prevent damage. • Ensure connectors are properly aligned and fully inserted.
Lights are dim or flickering.	<ul style="list-style-type: none"> • Insufficient power. • Loose connection. 	<ul style="list-style-type: none"> • Ensure the power adapter is correctly connected and providing stable power. • Check all connections for tightness.

If the problem persists after attempting these solutions, please contact customer support.

9. WARRANTY AND SUPPORT

maylit products are designed for reliability and performance. For warranty information or technical support, please refer to the contact details provided on the product packaging or visit the official maylit website. Keep your purchase receipt as proof of purchase for warranty claims.