



[Manuals.plus](#) /

> [VSDISPLAY](#) /

> VSDISPLAY 10.4 Inch 800x600 Portable LCD Monitor VS104ZJ01 Instruction Manual

VSDISPLAY VS104ZJ01

VSDISPLAY 10.4 Inch 800x600 Portable LCD Monitor

Model: VS104ZJ01

INTRODUCTION

This manual provides comprehensive instructions for the VSDISPLAY 10.4 Inch 800x600 Portable LCD Monitor, model VS104ZJ01. It covers essential information for safe and efficient use, including product features, setup procedures, operational guidelines, maintenance tips, and troubleshooting solutions. Please read this manual thoroughly before using the monitor and retain it for future reference.

PRODUCT OVERVIEW

The VSDISPLAY VS104ZJ01 is a portable 10.4-inch LCD monitor designed for various applications, including use as an extra display for PCs/laptops, game cabinets, home security systems, or industrial monitoring. It features an 800x600 resolution, DVI, VGA, and HDMI video inputs, and built-in dual speakers.

Key Features:

- **Portable Design:** Compact 10.4-inch display for easy transport and integration.
- **Multiple Interfaces:** Supports DVI, VGA, and HDMI video inputs for broad compatibility.
- **Integrated Audio:** Built-in dual speakers for audio output.
- **Flexible Mounting:** Includes brackets for wall-mounted installations, suitable for small spaces.
- **Versatile Applications:** Ideal for DIY projects, security monitoring, gaming, and industrial use.

Package Contents:

Upon unpacking, verify that all items listed below are present and in good condition:

- 1x VSDISPLAY 10.4 Inch 800x600 LCD Monitor (VS104ZJ01)
- 1x Bracket Set
- 1x 12V 2A Power Adapter

SETUP INSTRUCTIONS

1. Physical Dimensions and Layout:

Understand the physical dimensions and layout of the monitor for proper placement and installation.

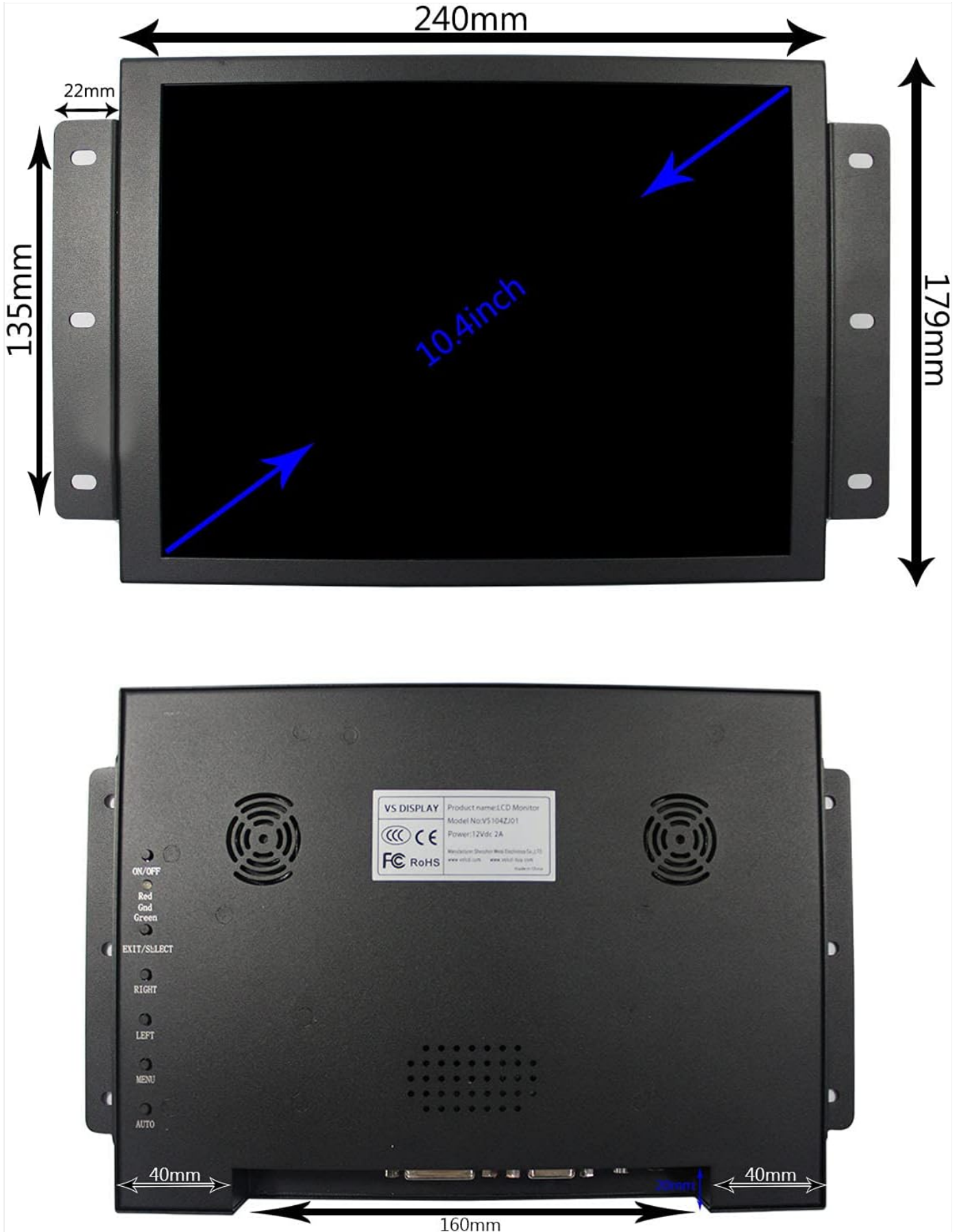

Image: Front view of the VSDISPLAY 10.4 Inch Monitor, illustrating its dimensions (240mm width, 179mm height) and the 10.4-inch display area.

2. Rear Panel Controls and Connections:

Familiarize yourself with the rear panel, which houses the control buttons and various input/output ports.

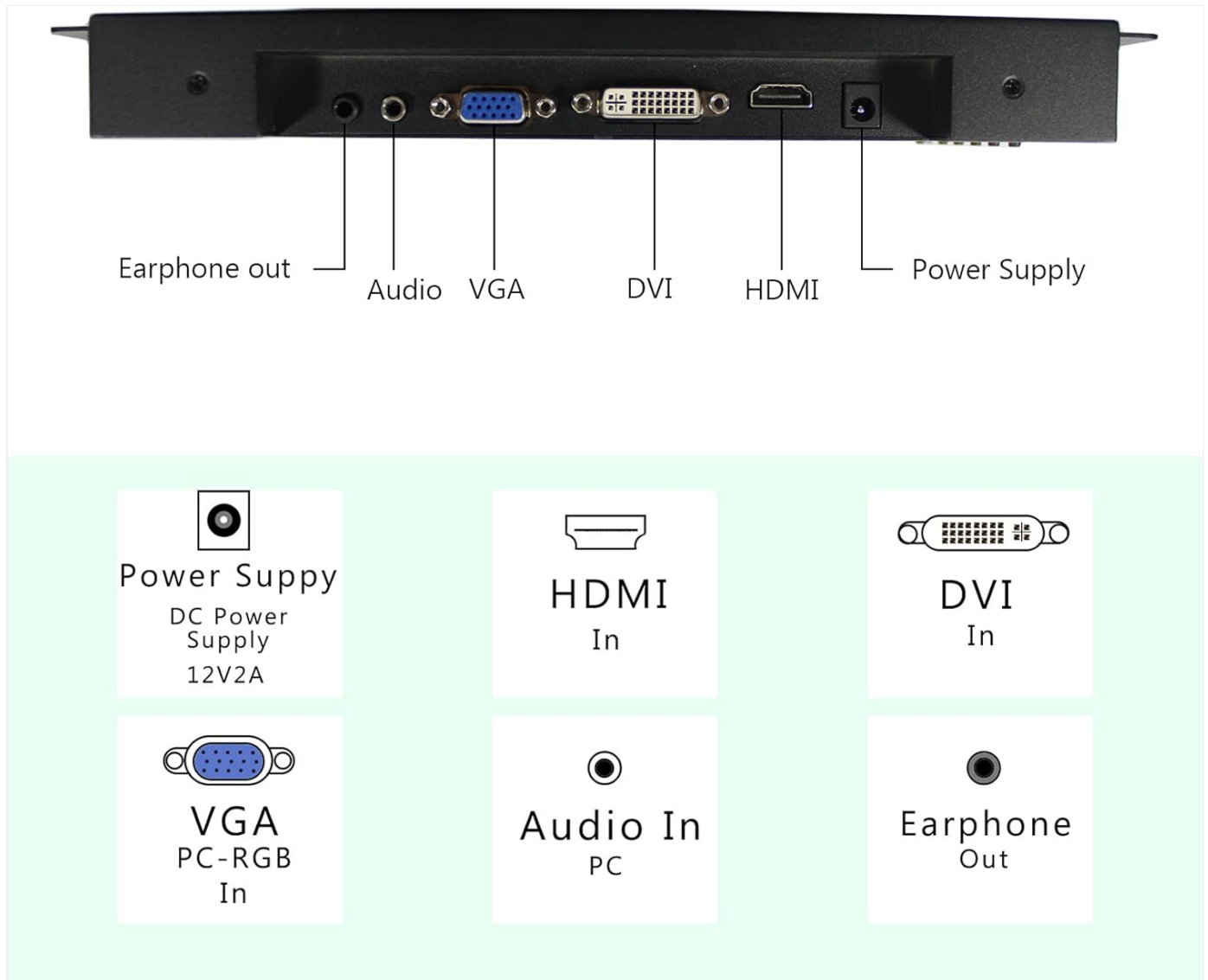

Image: Rear view of the VSDISPLAY 10.4 Inch Monitor, detailing the control buttons (ON/OFF, Red, Green, Exit/Select, Right, Left, Menu, Auto) and the product information label.

3. Side Panel Connections:

The side panel provides additional connectivity options for video and audio.



Image: Side view of the VSDISPLAY 10.4 Inch Monitor, highlighting the DVI, VGA, Audio, and Power input ports.

4. Detailed Port Diagram:

A clear diagram of all available input and output ports.

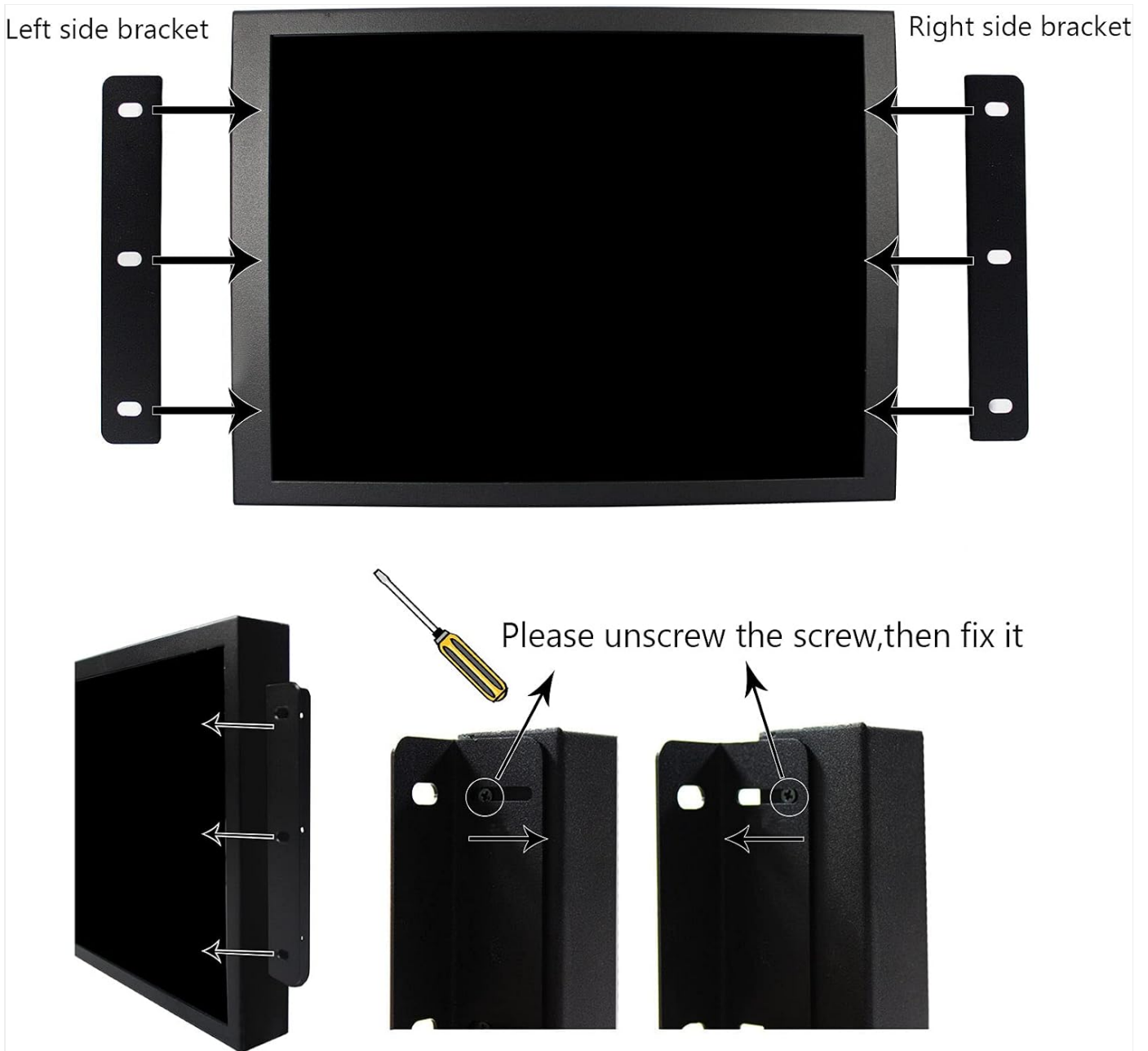

Image: Detailed diagram of the VSDISPLAY 10.4 Inch Monitor's connectivity ports, including Earphone out, Audio in, VGA in, DVI in, HDMI in, and Power Supply in.

5. Bracket Installation:

The monitor comes with brackets for flexible mounting options. Follow these steps to install them:

1. Identify the left and right side brackets.
2. Align the brackets with the screw holes on the sides of the monitor.
3. Unscrew the existing screws from the monitor's side.
4. Position the brackets and secure them using the provided screws.

Packing box



Packing box



12V 2A Power adapter



Bracket



Image: Illustration demonstrating the installation of the mounting brackets onto the VSDISPLAY 10.4 Inch Monitor, showing the process of unscrewing and re-fixing the brackets.

6. Power Connection:

- Connect the provided 12V 2A power adapter to the "Power Supply" port on the monitor.
- Plug the power adapter into a suitable electrical outlet.

7. Video Input Connection:

- Connect your source device (PC, laptop, game console, etc.) to the monitor using either a DVI, VGA, or HDMI cable.
- Ensure the cable is securely connected to both the source device and the monitor's corresponding input port.

8. Audio Connection (Optional):

- If using the monitor's built-in speakers, ensure your video source is transmitting audio through the DVI/HDMI connection, or connect an audio cable to the "Audio In" port.
- For external audio, connect headphones or external speakers to the "Earphone out" port.

OPERATING INSTRUCTIONS

Powering On/Off:

- Press the **ON/OFF** button located on the rear panel to power on the monitor.
- Press the **ON/OFF** button again to power off the monitor.

Using the OSD Menu:

The On-Screen Display (OSD) menu allows you to adjust various monitor settings.

1. Press the **MENU** button to open the OSD menu.
2. Use the **RIGHT** and **LEFT** buttons to navigate through menu options.
3. Press the **EXIT/SELECT** button to select an option or confirm a setting.
4. Use the **RIGHT** and **LEFT** buttons to adjust values within a selected option.
5. Press the **MENU** button again or the **EXIT/SELECT** button to exit the OSD menu.

Input Source Selection:

To switch between DVI, VGA, or HDMI inputs:

- Press the **EXIT/SELECT** button (or a dedicated input button if available) to cycle through available input sources.
- Alternatively, access the OSD menu and navigate to the "Input" or "Source" option to manually select the desired input.

Automatic Adjustment (VGA only):

When using the VGA input, the monitor can automatically adjust image settings for optimal display.

- Press the **AUTO** button on the rear panel to initiate automatic image adjustment.

MAINTENANCE

- **Cleaning the Screen:** Gently wipe the screen with a soft, lint-free cloth. For stubborn marks, slightly dampen the cloth with water or a non-abrasive screen cleaner. Avoid using harsh chemicals or abrasive materials.
- **Cleaning the Casing:** Use a soft, dry cloth to clean the monitor's casing.
- **Power Off When Not in Use:** To conserve energy and prolong the monitor's lifespan, power it off when not in use for extended periods.
- **Avoid Extreme Conditions:** Do not expose the monitor to extreme temperatures, high humidity, or direct sunlight.
- **Ventilation:** Ensure adequate ventilation around the monitor to prevent overheating. Do not block the ventilation openings.

TROUBLESHOOTING

Problem	Possible Cause	Solution
---------	----------------	----------

Problem	Possible Cause	Solution
No image on screen	<ul style="list-style-type: none"> Power cable not connected. Video cable not connected or loose. Incorrect input source selected. Source device not powered on or outputting signal. 	<ul style="list-style-type: none"> Ensure power adapter is securely connected and plugged in. Check video cable connections (DVI, VGA, HDMI). Select the correct input source using the OSD menu or input button. Verify the source device is powered on and configured to output video.
Image is distorted or blurry (VGA only)	<ul style="list-style-type: none"> Timing issues with VGA signal. 	<ul style="list-style-type: none"> Press the AUTO button for automatic adjustment. Adjust phase and clock settings in the OSD menu manually.
No sound from speakers	<ul style="list-style-type: none"> Volume too low or muted. Audio cable not connected (if using VGA). Source device not outputting audio. 	<ul style="list-style-type: none"> Increase volume via OSD menu or source device. Ensure audio cable is connected from source to "Audio In" port (for VGA). Verify audio output settings on the source device.
Monitor powers off unexpectedly	<ul style="list-style-type: none"> Overheating. Faulty power connection. 	<ul style="list-style-type: none"> Ensure proper ventilation around the monitor. Check power cable and adapter for damage or loose connections.

SPECIFICATIONS

Feature	Detail
Brand	VSDISPLAY
Model Number	VS104ZJ01
Screen Size	10.4 Inches
Resolution	800x600 (SVGA)
Aspect Ratio	4:3
Display Area	211.2 x 158.4 mm (HxV)
Brightness	350 cd/m ²
Contrast Ratio	500:1
Viewing Angle	80/80/60/80 (Typ.)(CR≥10) [Left / Right / Up / Down]
Response Time	5 Milliseconds
Video Input	DVI, VGA, HDMI
Audio	Built-in Dual Speakers, Earphone Out, Audio In

Feature	Detail
Power Supply	12 Volts (12V 2A DC Adapter)
Power Consumption	5.52 Watts (Standby: <0.3W)
Operating Temperature	-10°C to 60°C
Storage Temperature	-30°C to 70°C
Product Dimensions (D x W x H)	3.1D x 24W x 17.9H Centimetres (240x179x31 mm)
Weight	1.48 kg
Mounting Type	Wall Mount (with included brackets)

WARRANTY AND SUPPORT

VSDISPLAY products are tested before packaging and shipment. For any product-related issues or inquiries, please feel free to contact VSDISPLAY customer support. Refer to your purchase documentation for specific warranty terms and contact information.

For support, you may visit the official VSDISPLAY store on Amazon: [VSDISPLAY Store](#).

