

M LTMIRROR 24 Inch LED Round Bathroom Mirror

M LTMIRROR 24-Inch LED Round Bathroom Mirror Instruction Manual

Model: 24 Inch LED Round Bathroom Mirror

1. INTRODUCTION

Thank you for choosing the M LTMIRROR 24-Inch LED Round Bathroom Mirror. This mirror is designed to enhance your bathroom experience with its integrated LED lighting, anti-fog function, and smart touch controls. It features a fully enclosed structure for durability and safety, and offers three light color settings with dimmable brightness. This manual provides essential information for safe installation, operation, and maintenance of your new mirror.



M LTMIRROR 24-inch LED Round Bathroom Mirror installed above a vanity.

2. SAFETY INFORMATION

Please read all instructions carefully before installation and use. Keep this manual for future reference.

- Ensure the power supply is disconnected before installation or maintenance.
- Installation should be performed by a qualified electrician if hardwiring is chosen.
- Do not attempt to disassemble or modify the mirror.
- Keep the mirror away from excessive moisture or direct water spray.
- Handle the mirror with care to prevent damage to the glass or electrical components.

3. SETUP AND INSTALLATION

The M LTMIRROR LED Round Bathroom Mirror can be installed via plug-in or hardwired connection.

3.1 Mounting the Mirror

The mirror is designed for wall mounting. Ensure the wall can support the mirror's weight (approximately 10.8 pounds for the 24-inch model). Use appropriate wall anchors and screws for secure installation.

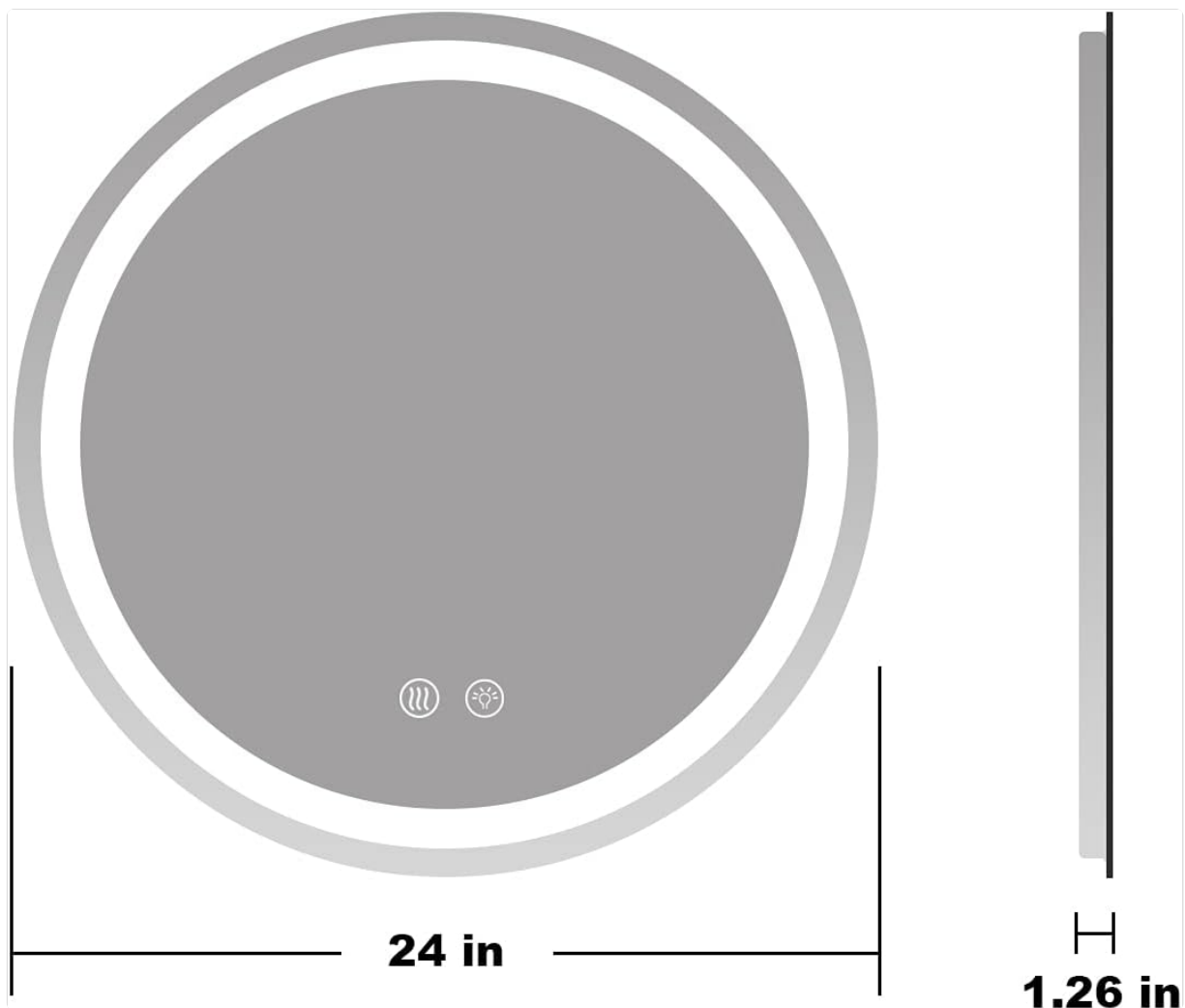

Technical drawing of the 24-inch round mirror, indicating its diameter and a thickness of 1.26 inches.

3.2 Electrical Connection

The mirror supports both plug-in and hardwire options. For hardwiring, consult a qualified electrician to ensure proper and safe connection to your home's electrical system.

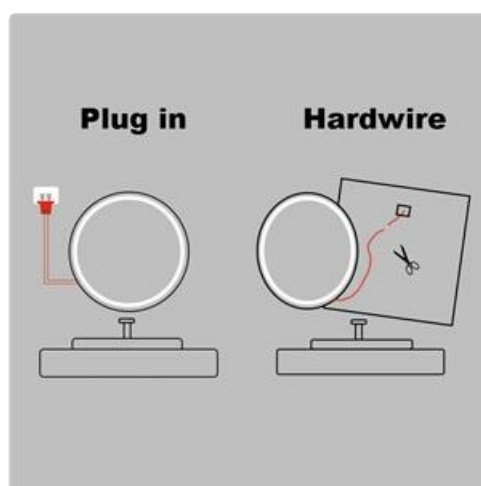

Diagram showing two installation options: plug-in with a visible cord and hardwire installation where the cord is connected directly to electrical wiring.

3.3 Wall Switch Control

The mirror can be controlled directly by a wall switch. When connected to a wall switch, the mirror will remember its last state (light and defogger settings) when turned on/off via the wall switch.

Support Wall Switch Control

Using wall button
to turn on/off the
light and defogger
of mirror



Parts Certification



Illustration showing the mirror's compatibility with a wall switch for power control, with a UL certification logo.

This video demonstrates turning the mirror's light on and off using a wall switch, and also shows the fully enclosed structure and uniform front illumination.

4. OPERATING INSTRUCTIONS

The mirror features intuitive touch buttons for controlling its functions.

4.1 Power On/Off and Color Temperature Adjustment

Locate the touch button on the mirror surface. A short press will cycle through the three available light color temperatures: Warm (3000K), Natural, and White (6000K). Pressing the button again after White will turn the light off.

Three Color Temperature Switching



Warm Color



Natural Color



White Color



Short press to switch color

3000K



6000K



Diagram illustrating the three color temperature settings (Warm, Natural, White) available on the mirror, ranging from 3000K to 6000K.

4.2 Brightness Dimming

To adjust the brightness, long press the touch button. The brightness will cycle between 10% and 100%. Release the button when the desired brightness level is reached.

Dimmer: 10%-100%



20%



60%



100%



Long press to adjust brightness



10%



100%



Diagram demonstrating the dimming functionality of the mirror, allowing brightness adjustment from 10% to 100% via a long press on the touch button.

4.3 Anti-Fog Function

Activate the anti-fog function by pressing the dedicated defogger touch button on the mirror surface. This feature prevents steam buildup, ensuring a clear reflection after hot showers. Press the button again to turn off the defogger.

No more fogging after hot shower



Before



After



Press to turn on/off defogger

Before and after comparison of the mirror surface, showing effective anti-fogging after a hot shower, activated by a touch button.

This video demonstrates the mirror's touch button controls for adjusting light color and brightness, and activating the anti-fog function.

5. MAINTENANCE

To ensure the longevity and optimal performance of your M LTMIRROR LED Round Bathroom Mirror, follow these maintenance guidelines:

- **Cleaning the Mirror Surface:** Use a soft, lint-free cloth and a non-abrasive glass cleaner. Spray the cleaner onto the cloth, not directly onto the mirror, to avoid liquid seeping into the electrical components.
- **Cleaning the Frame:** Wipe the frame with a soft, damp cloth. Avoid harsh chemicals or abrasive materials that could damage the finish.
- **Electrical Components:** Do not attempt to clean or service any internal electrical components. If you suspect an issue, contact customer support.
- **Regular Inspection:** Periodically check the mounting hardware to ensure the mirror remains securely attached to the wall.

6. TROUBLESHOOTING

If you encounter any issues with your mirror, please refer to the following troubleshooting steps:

Problem	Possible Cause	Solution
Mirror lights do not turn on.	No power supply; loose connection; faulty wall switch.	Check if the power outlet is working or if the wall switch is on. Verify electrical connections are secure. If hardwired, consult an electrician.
Lights turn off randomly or change colors by themselves.	Electrical interference; internal component issue.	Ensure stable power supply. If the issue persists, contact customer support.
Mirror does not remember last settings when using a wall switch.	Power interruption; specific wiring configuration.	Ensure consistent power supply. Some wall switch types may interfere with memory function. If hardwired, consult an electrician to verify wiring.
Anti-fog function is not working.	Defogger not activated; internal fault.	Ensure the defogger touch button has been pressed. If activated and still not working, contact customer support.

7. SPECIFICATIONS

Feature	Detail
Brand	M LTMIRROR
Model	24 Inch LED Round Bathroom Mirror
Shape	Round
Product Dimensions	24"L x 24"W
Thickness	1.26 inches
Frame Material	Acrylonitrile Butadiene Styrene (ABS)
Mounting Type	Wall Mount
Special Features	3 color setting and dimmable, Moisture Resistant, Touch Sensor, Fully Enclosed Structure, Wall Switch Control, Anti-Fog
Material	Glass
Item Weight	10.8 Pounds
UPC	792871734725

