

Revol RE001

Revol RE001 Electronic Keypad Deadbolt User Manual

Model: RE001 | Brand: Revol

INTRODUCTION

The Revol RE001 Electronic Keypad Deadbolt offers advanced security and convenience for your home. This keyless entry system provides multiple access options, including keypad codes and traditional keys, ensuring flexible and secure entry. Its robust design and smart features make it an ideal solution for modern households.

Key features include:

- **Keyless Entry:** Supports up to 20 access codes for family members and temporary codes for guests.
- **Auto-Locking:** Customizable auto-lock delay (10-99 seconds) or one-touch locking for enhanced security.
- **Anti-Peeking Password:** Allows entry of random digits before or after your code to prevent code exposure.
- **Durable Construction:** Made from sturdy zinc alloy with an IP65 weather-resistant rating.



Figure 1: Revolo RE001 Electronic Keypad Deadbolt and Handle Set.

SETUP AND INSTALLATION

The Revolo RE001 is designed for easy installation with minimal tools. A Phillips head screwdriver is typically all that is required. Ensure your door meets the standard preparation requirements before beginning installation.

Pre-Installation Checks

- Verify door thickness (1-3/8" to 2" / 35mm to 50mm).
- Confirm door hole diameter (2-1/8" / 54mm).
- Check backset (2-3/8" or 2-3/4" / 60mm or 70mm).

Handlesets Installation Instructions

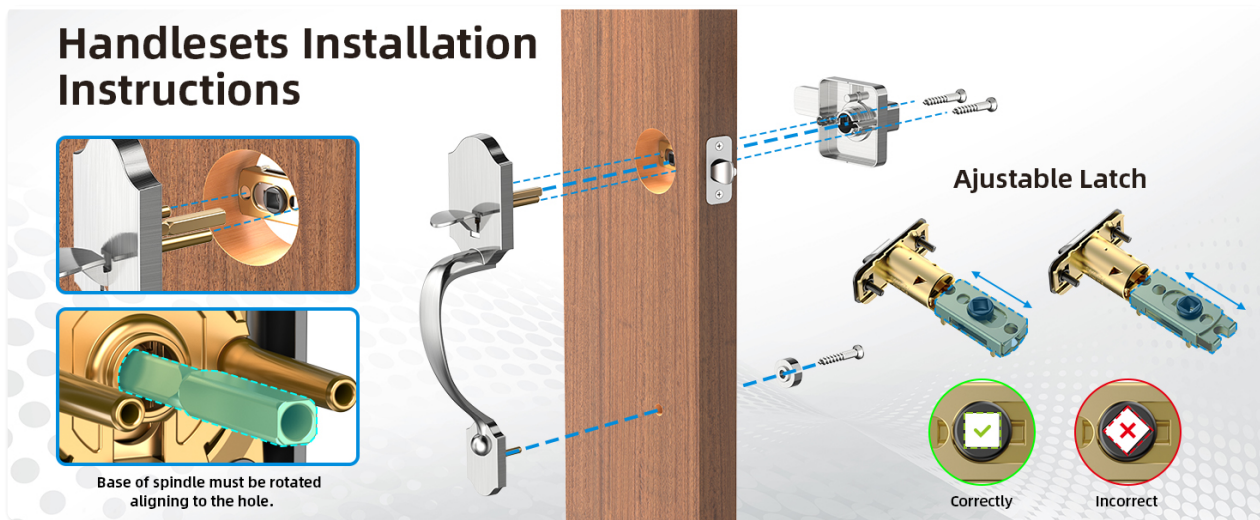

Figure 2: Door dimensions and lock component measurements for compatibility.

Installation Steps

1. Adjust the latch length if necessary to fit your door's backset.
2. Install the latch into the door edge, ensuring the correct orientation for your door's swing.
3. Install the exterior keypad assembly, ensuring the lock cylinder is correctly aligned with the latch.
4. Install the mounting plate on the interior side, aligning its screw with the latch screw.
5. Connect the IC wire from the exterior assembly to the interior assembly.
6. Mount the interior assembly and secure it with screws.
7. Insert 4 AA batteries into the interior assembly.
8. Attach the battery cover.

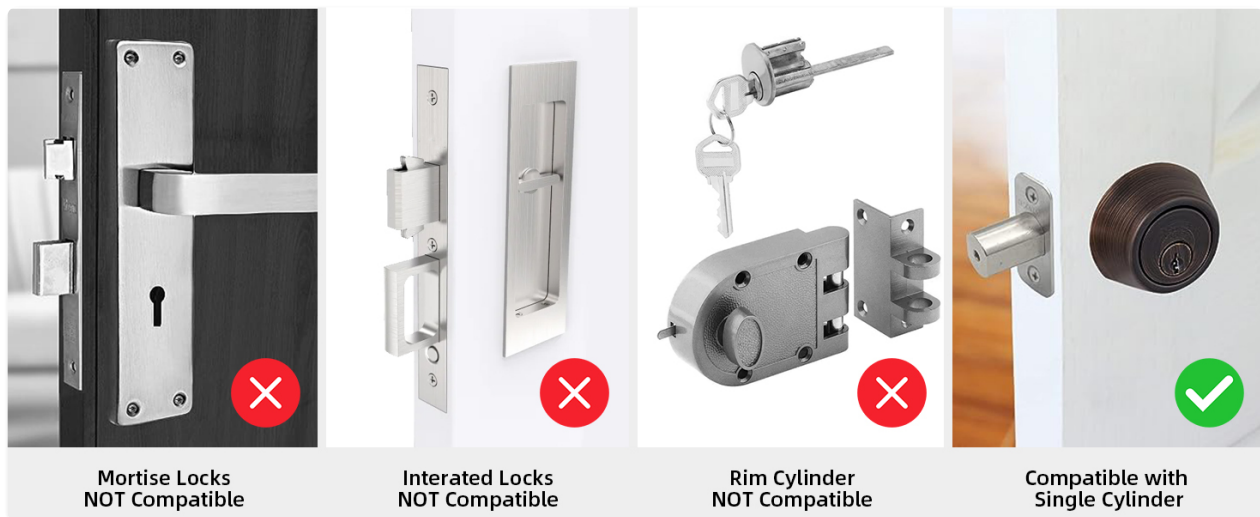

Figure 3: Handleset installation overview.

For a detailed visual guide, refer to the official installation manual PDF provided with your product or the installation video below.

Video 1: Revolo Deadbolt Door Lock Installation Guide. This video provides a comprehensive overview of the installation process for the Revolo keypad deadbolt.

OPERATING INSTRUCTIONS

The Revolo RE001 offers various modes and programming options for personalized security.

Programming Master and User Codes

The lock comes with a default master code. It is highly recommended to change this immediately after installation.

Video 2: RE001 Programming Instruction. This video demonstrates how to change the master code, add user codes, delete user codes, enable vacation mode, and adjust auto-lock settings.

Changing Master Code

Follow the steps in Video 2 (0:03-0:24) to change the default master code to a new, secure code.

Adding User Codes

You can add up to 20 unique user codes for family members or frequent visitors. Refer to Video 2 (0:25-0:46) for instructions.

Up to 20 Codes

Allow different family members to customize their own unlock method



Family



Friends



Roommate



Courier



Relatives



Repairman



Figure 4: User code assignment for family, friends, and service providers.

Deleting User Codes

To remove an existing user code, follow the procedure shown in Video 2 (0:47-1:02).

One-Time Codes

Generate temporary codes that automatically delete after a single use, ideal for one-time guests or deliveries. See Video 2 (1:56-2:15) for details.

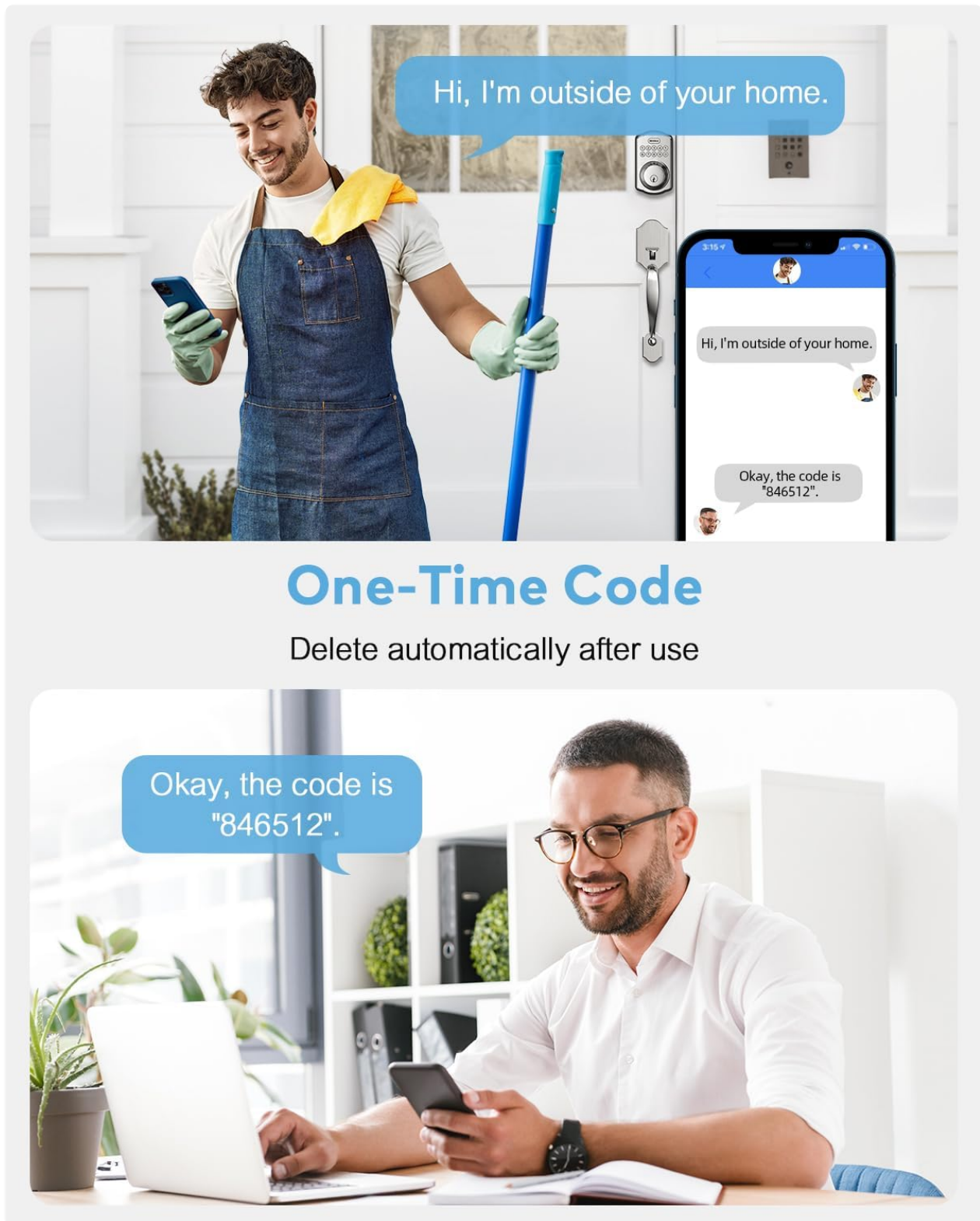

Figure 5: One-time code functionality for temporary access.

Locking Features

Auto-Lock Function

The lock can be set to automatically lock after a specified delay (10-99 seconds). This feature ensures your door is always secured. Enable/disable and set delay using Video 2 (1:15-1:41) and (1:42-1:55).

Auto Lock & One Touch Locking

You can set auto lock time delay from 10-99s



Auto Lock



One Touch Lock



Figure 6: Auto-lock and one-touch locking for convenience and security.

Silent Mode

Enable silent mode to disable keypad beeps for quiet operation. This is useful for not disturbing others. See Video 2 (2:16-2:45) for instructions.

Vacation Mode

Activate vacation mode to temporarily disable all user codes, providing enhanced security when you are away for extended periods. Refer to Video 2 (1:03-1:14) for activation.



Figure 7: Vacation mode for temporary disabling of user codes.

FEATURES AND DESIGN

The Revolo RE001 combines aesthetic appeal with robust functionality.

Weather Resistance

With an IP65 rating, the deadbolt is designed to withstand various weather conditions, protecting your home in rain or shine.



Figure 8: IP65 waterproof and temperature resistance features.

Anti-Peeking Password

Enhance your security by entering random digits before or after your actual code. This feature prevents others from guessing your code by observing your finger movements.



Figure 9: Anti-peeking password for enhanced security.

Wrong Code Entry Limit

For added security, the lock will shut down for 3 minutes after 10 invalid entry codes are attempted.



Figure 10: Wrong code entry limit for preventing unauthorized access.

MAINTENANCE

To ensure the longevity and optimal performance of your Revolo RE001 Electronic Keypad Deadbolt, regular

maintenance is recommended.

- **Battery Replacement:** The lock uses 4 AA batteries. Replace them promptly when the low battery alert is indicated to avoid loss of function.
- **Cleaning:** Wipe the keypad and handle surfaces with a soft, damp cloth. Avoid abrasive cleaners or solvents that could damage the finish or electronic components.
- **Lubrication:** Periodically apply a silicone-based lubricant to the deadbolt mechanism to ensure smooth operation. Do not use oil-based lubricants.
- **Firmware Updates:** Check the Revolo website or app (if applicable) for any available firmware updates to ensure your lock has the latest features and security enhancements.

TROUBLESHOOTING

If you encounter issues with your Revolo RE001, refer to the common troubleshooting tips below. For more complex problems, consult the official Troubleshooting Guide PDF.

Common Issues and Solutions

- **Lock not responding to keypad:** Check battery levels and replace if necessary. Ensure the master code is correctly entered.
- **Deadbolt not extending/retracting fully:** Verify proper alignment of the lock cylinder and latch during installation. Ensure no obstructions in the door frame.
- **Keypad lights not illuminating:** This may indicate low battery. Replace batteries.
- **Lock cycles back and forth but doesn't change direction:**This could be a hardware issue related to the bolt mechanism. Refer to the troubleshooting guide for detailed steps on resetting the lock direction.

For a comprehensive list of troubleshooting steps and solutions, please download the official [Troubleshooting Guide \(PDF\)](#).

SPECIFICATIONS

Feature	Detail
Brand	Revolo
Model Name	RE001 keypad door lock with handle
Lock Type	Keypad
Material	Metal (Zinc Alloy)
Color	Stain Nickel
Item Dimensions (L x W x H)	12.6 x 8.27 x 3.54 inches
Item Weight	4.87 Pounds
Power Source	4 AA Batteries (not included)
Special Features	Keyless Entry, Keypad Lock with Handle, Auto-Lock, One-time PIN Code
Weather Resistance	IP65 Rated

WARRANTY AND SUPPORT

Revolvo is committed to providing high-quality products and excellent customer service.

Product Warranty

The Revolvo RE001 Electronic Keypad Deadbolt comes with a **lifetime mechanical warranty** and a **12-month electronics warranty**.

Customer Support

For any questions, technical assistance, or warranty claims, please contact Revolvo customer service:



- **Phone Support:** Monday to Friday, 9 AM to 5 PM PST
- **Email Support:** 24/7 after-sales email service



Additional resources, including the full user manual and installation guide, are available for download:

- [User Manual \(PDF\)](#)
- [Installation Manual \(PDF\)](#)

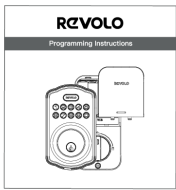
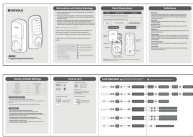
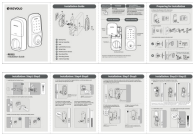
© 2024 Revolvo. All rights reserved.

Related Documents - RE001

	<p>Revolvo Electronic Keypad Deadbolt Programming Instructions</p> <p>Comprehensive programming instructions for the Revolvo Electronic Keypad Deadbolt, covering master code setup, user code management, auto-lock features, vacation mode, and troubleshooting.</p>
	<p>Revolvo RE002 Programming Instructions and User Guide</p> <p>Comprehensive guide for the Revolvo RE002 keyless entry door lock, covering programming, operation, safety warnings, and troubleshooting.</p>
	<p>Revolvo RE002 Keyless Entry Door Lock Installation Guide</p> <p>Step-by-step instructions for installing the Revolvo RE002 keyless entry door lock, including preparation, assembly, and final setup.</p>
	<p>Revolvo Wifi Smart Lock WFP01 FAQ: Troubleshooting and User Guide</p> <p>Find answers to common questions about the Revolvo Wifi Smart Lock WFP01, including setup, connectivity, user management, battery, and advanced features. This FAQ provides troubleshooting tips and usage guidance.</p>

 The image shows the cover of a 'Quick Start Guide' for the REVOLO WiFi Smart Video Lock. It features a black and white photograph of the lock device, which has a circular camera lens and a speaker grille. The text 'REVOLO' and 'WiFi Smart Video Lock' are at the top, and 'Quick Start Guide' is at the bottom.	<p>REVOLO WiFi Smart Video Lock Quick Start Guide - Installation and Setup</p> <p>Comprehensive quick start guide for the REVOLO WiFi Smart Video Lock, covering installation, setup via the Revolo app, product overview, and important safety information.</p>
 The image shows the cover of an 'Installation Manual' for the REVOLO Wi-Fi Smart Fingerprint Lock. It features a black and white photograph of the lock device, which has a numeric keypad and a fingerprint sensor. The text 'REVOLO' and 'Wi-Fi Smart Fingerprint Lock' are at the top, and 'Installation Manual' is at the bottom.	<p>REVOLO Wi-Fi Smart Fingerprint Lock Installation Manual</p> <p>This installation manual provides comprehensive instructions for setting up and using the REVOLO Wi-Fi Smart Fingerprint Lock. It covers product overview, preparation, step-by-step installation, app pairing, door sensor installation, and regulatory information.</p>