

## G-Shock GWF-A1000C-1AJF

# Casio G-Shock GWF-A1000C-1AJF FROGMAN Bluetooth Solar Radio Watch Instruction Manual

Model: GWF-A1000C-1AJF | Brand: G-Shock

- [Features](#)
- [Setup](#)
- [Operation](#)
- [Maintenance](#)
- [Introduction](#)
- [Key](#)
- [Troubleshooting](#)
- [Specifications](#)
- [Warranty & Support](#)

### 1. INTRODUCTION

Welcome to the instruction manual for your Casio G-Shock GWF-A1000C-1AJF FROGMAN watch. This robust timepiece is engineered for extreme conditions, offering advanced features such as Bluetooth connectivity, solar power, multi-band 6 radio reception for accurate timekeeping, and ISO 200M diver's water resistance. This manual will guide you through the setup, operation, and maintenance of your new watch.



Figure 1: Front view of the Casio G-Shock GWF-A1000C-1AJF FROGMAN watch, showcasing its digital display and robust design.

## 2. KEY FEATURES

- **Bluetooth Connectivity:** Connects to your smartphone for automatic time adjustment and other functions.
- **Tough Solar Power:** Charges the watch battery using sunlight or artificial light.
- **Multi-Band 6 Atomic Timekeeping:** Receives calibration signals from six transmission stations worldwide for accurate time.
- **ISO 200M Diver's Water Resistance:** Certified for professional diving.
- **Shock Resistance:** G-Shock's signature durability protects against impacts and vibrations.
- **Tide Graph & Moon Phase Data:** Essential information for marine activities.
- **Dive Log Data:** Stores records of your dives.
- **Composite Band with Extension Mechanism:** Provides comfort and adjustability, especially over wetsuits.
- **Mineral Glass:** Durable and scratch-resistant watch face.



Figure 2: The GWF-A1000C-1AJF FROGMAN watch worn on a wrist, highlighting its large yet comfortable fit and clear digital display.

### 3. SETUP

### 3.1 Initial Time and Date Adjustment

Your watch is equipped with Multi-Band 6 radio reception and Bluetooth connectivity for automatic time adjustment. For initial setup or manual adjustment:

1. In Timekeeping Mode, press and hold the **ADJUST** button (top-left) until the city code starts to flash.
2. Use the **FORWARD** (bottom-right) and **REVERSE** (top-right) buttons to select your Home City code.
3. Press the **MODE** button (bottom-left) to cycle through other settings like DST (Daylight Saving Time), 12/24-hour format, seconds, hour, minute, year, month, and day.
4. Use the **FORWARD** and **REVERSE** buttons to adjust each setting.
5. Once all settings are configured, press the **ADJUST** button to exit the setting mode.

### 3.2 Bluetooth Connectivity

To connect your watch to your smartphone via Bluetooth:

1. Download the official G-SHOCK Connected app from your smartphone's app store.
2. Enable Bluetooth on your smartphone.
3. On the watch, enter the Connection Mode (refer to the full manual for specific button operations).
4. Follow the instructions in the G-SHOCK Connected app to pair your watch.

### 3.3 Solar Charging

Your watch is powered by Tough Solar. Ensure it receives regular exposure to light to maintain a full charge. Avoid prolonged storage in dark places.

## 4. OPERATING MODES

The **MODE** button (bottom-left) is used to navigate between the different operating modes of your watch.

### 4.1 Timekeeping Mode

Displays the current time, date, and day of the week. This is the default mode.

### 4.2 Diver's Mode (ISO 200M)

The FROGMAN series is designed for professional diving. This mode provides essential dive-related data. Refer to the full manual for detailed instructions on using this mode safely for diving.

### 4.3 Tide Graph & Moon Phase

Access these features to view tidal information and moon phase data, useful for marine activities. Ensure your home city and location data are correctly set for accurate readings.

### 4.4 Dive Log Data

The watch can store up to 10 records of your dives, including dive time and other relevant metrics. Access this mode to review your past dive data.

### 4.5 Stopwatch

Measures elapsed time, split times, and 1st-2nd place times. Use the **START/STOP** button (bottom-right) to start/stop and the **SPLIT/RESET** button (top-right) for split/reset functions.

### 4.6 Timer

A countdown timer function. Set your desired countdown time, and the watch will alert you when it reaches zero.

### 4.7 Alarm

Set daily alarms to alert you at specific times. Multiple alarms can be configured.

### 4.8 Backlight

Press the **LIGHT** button (top-right) to illuminate the display for easy reading in low-light conditions. The backlight duration can be adjusted in settings.

## 5. MAINTENANCE

### 5.1 Cleaning

Wipe the watch regularly with a soft, dry cloth. After exposure to saltwater, rinse the watch with fresh water and dry thoroughly. Do not use chemical cleaners.

### 5.2 Battery (Solar)

To ensure optimal battery performance, expose the watch to light regularly. The watch has a power-saving function that turns off the display when in darkness for an extended period. This helps conserve battery life.

### 5.3 Water Resistance Care

The watch is ISO 200M water resistant. Do not operate buttons underwater unless specified for a particular mode. Ensure the crown (if applicable) is fully pushed in before exposing to water. Avoid extreme temperature changes while the watch is wet.

## 6. TROUBLESHOOTING

- **Time is incorrect:** Ensure your Home City setting is correct. Allow the watch to receive a time calibration signal overnight or connect via Bluetooth to your smartphone for automatic adjustment.
- **Display is blank:** The watch might be in power-saving mode due to lack of light exposure. Expose it to bright light to reactivate the display and charge the battery.
- **Bluetooth connection issues:** Ensure Bluetooth is enabled on your smartphone and the watch is in connection mode. Check the G-SHOCK Connected app for troubleshooting steps.
- **Buttons are unresponsive:** If the watch has been exposed to water, ensure it is completely dry. If the issue persists, contact customer support.

## 7. SPECIFICATIONS

Feature	Detail
---------	--------

Feature	Detail
Model Number	GWF-A1000C-1AJF
Brand	G-Shock (CASIO)
Water Resistance	ISO 200M Diver's
Power Source	Tough Solar (Solar Powered)
Timekeeping	Multi-Band 6 Atomic Timekeeping, Bluetooth Connectivity
Case Material	Full Steel Case, Resin
Band Material	Resin with Composite Band Extension
Glass Type	Mineral Glass
Clasp Type	Tang Buckle
Dimensions (Approx.)	58.3mm (largest part, from video)
Battery Type	1 Lithium Metal battery (included)



# フルアナログFROGMANに、 コンポジットバンドモデルが登場。

MASTER OF Gシリーズの中でISO規格200m潜水用防水機能を備えた  
“FROGMAN”のアナログモデルです。

コンポジットバンドを採用し、  
ウェットスーツの上から着けやすいよう  
中留にエクステンション機構を搭載。

平常時は折りたたむことで、快適な長さでお使いいただけます。

中ゴマにファインレジンパーツを使用し強度と軽さを両立。

日常生活とダイビングシーンを  
シームレスに切り替えられるフロッグマンです。

## G-SHOCK MASTER OF G FROGMAN GWF-A1000C



サイズ、機能など詳細は、ページ下部で確認頂けます

Figure 3: Detailed view of the composite band and its extension mechanism, designed for comfort and versatility, including wear over wetsuits.



# エクステンション機構を搭載した コンポジットバンド

2段階に調整できるエクステンション機構により、ウェットスーツ着用時でも、街中でもジャストサイズにバンドの長さを調整できます。



ステンレスのインサートパーツのあるHコマと、ファインレジン製の中ゴマを連結し強化しています。

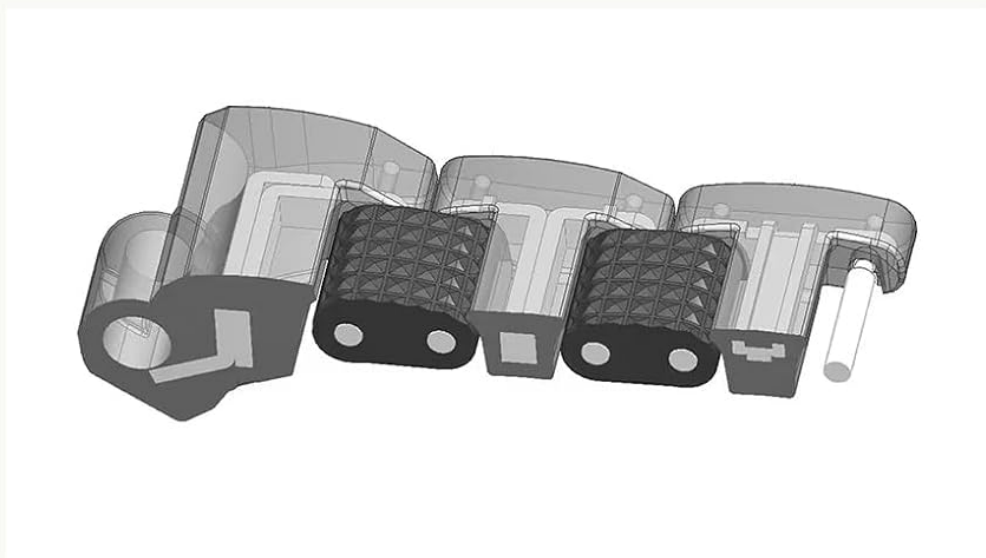

Figure 4: Exploded view of the extension mechanism components, showing the stainless steel and fine resin parts that enhance durability and adjustability.

Your Casio G-Shock GWF-A1000C-1AJF FROGMAN watch comes with a manufacturer's warranty. Please refer to the warranty card included in your product packaging for specific terms and conditions. For technical support, service, or further inquiries, please visit the official Casio G-Shock website or contact their authorized service centers.

Online resources and detailed user manuals for specific module numbers are often available on the official Casio support website. Please check your watch's module number (typically found on the back of the watch) to access the most accurate and comprehensive information.