

iMaihom BDD100-3

iMaihom 100W 9000LM LED Outdoor Flood Light User Manual

Model: BDD100-3

1. INTRODUCTION

Thank you for choosing the iMaihom 100W 9000LM LED Outdoor Flood Light. This product is designed to provide ultra-bright and efficient illumination for various outdoor spaces such as yards, garages, courts, and more. Featuring three adjustable heads and an IP65 waterproof rating, it offers reliable performance in diverse weather conditions. Please read this manual thoroughly before installation and operation to ensure proper use and safety.



Figure 1: Front view of the iMaihom 100W LED flood light with three adjustable heads.

2. SAFETY INFORMATION

WARNING: Risk of electric shock. Disconnect power at the fuse or circuit breaker before installation or servicing.

- This product must be installed in accordance with the applicable installation code by a person familiar with the construction and operation of the product and the hazards involved.
- Ensure the supply voltage is correct (120V AC) before connecting the fixture.
- Do not attempt to modify the fixture. Any modifications may void the warranty and create safety hazards.
- Keep flammable materials away from the light fixture.
- Do not look directly into the LED light source when the fixture is illuminated.

3. PACKAGE CONTENTS

Verify that all components are present and undamaged before beginning installation:

- 1x iMaihom 100W LED Flood Light
- 1x Mounting Bracket
- 1x EVA Gasket
- 1x Silicone Gasket
- 3x Expansion Rubber Plugs
- 3x Wire Nuts
- Various Machine Screws (Short, Long, Standard)



Figure 2: Included installation hardware and components.

4. PRODUCT FEATURES

- **Ultra Bright Illumination:** Equipped with 154 high-quality LED chips, delivering 100W and 9000 lumens of cool white (6500K) light.
- **Adjustable Lighting:** Features 3 adjustable heads, allowing for a wide lighting angle of up to 270 degrees and covering an area of approximately 1977 sq ft.
- **Durable & Weatherproof:** Constructed with a full metal (die-cast aluminum) design for efficient heat dissipation and an IP65 waterproof rating, ensuring resilience against rain, sleet, and snow.
- **Energy Efficient:** Provides brightness equivalent to a 500W halogen bulb while saving over 80% on electricity costs.

- **Note:** This model is **switch-controlled** and does **not** include a motion sensor or dusk-to-dawn functionality.



IP65 Waterproof

(Using temperature range: -25°C ~ 45°C)



Figure 3: Adjustable heads for customized lighting direction.



Figure 4: IP65 waterproof design for all-weather performance.

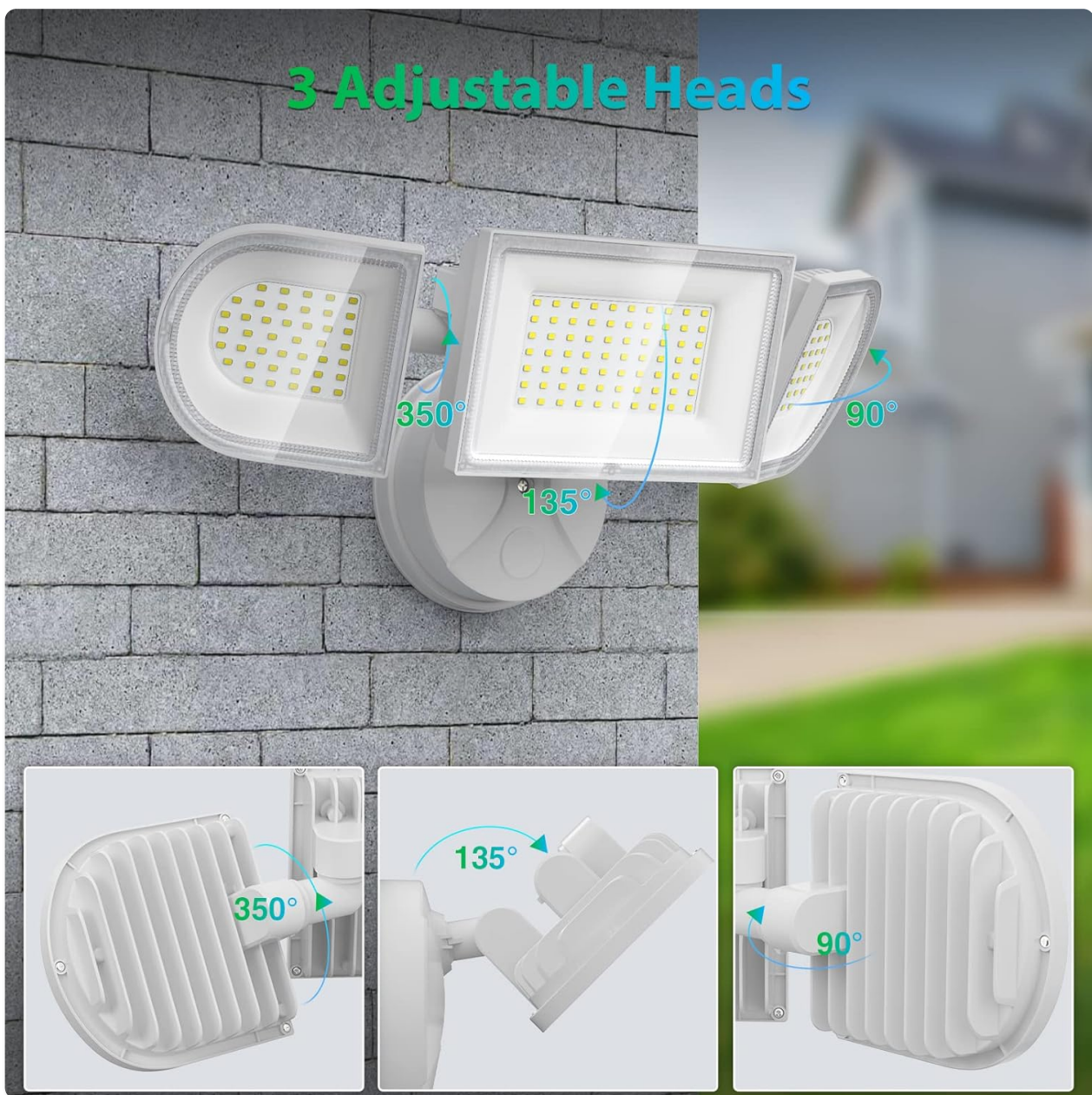

Figure 5: Full metal design for durability and efficient cooling.

5. INSTALLATION

This flood light is designed for hardwired installation to a junction box. Professional installation is recommended.

5.1 Pre-Installation

1. **Turn off Power:** Locate the circuit breaker or fuse box and turn off the power to the area where you will install the light.
2. **Prepare Mounting Surface:** Ensure the junction box is securely mounted and the surface is clean and dry.
3. **Review Components:** Familiarize yourself with all parts listed in Section 3.

5.2 Wiring the Light

1. Carefully pull the existing wires from the junction box.
2. Connect the flood light's wires to your power supply wires using the provided wire nuts:
 - **Black wire (Live)** to the house's black wire.
 - **White wire (Neutral)** to the house's white wire.
 - **Green/Yellow wire (Ground)** to the house's ground wire.
3. Ensure all connections are secure.

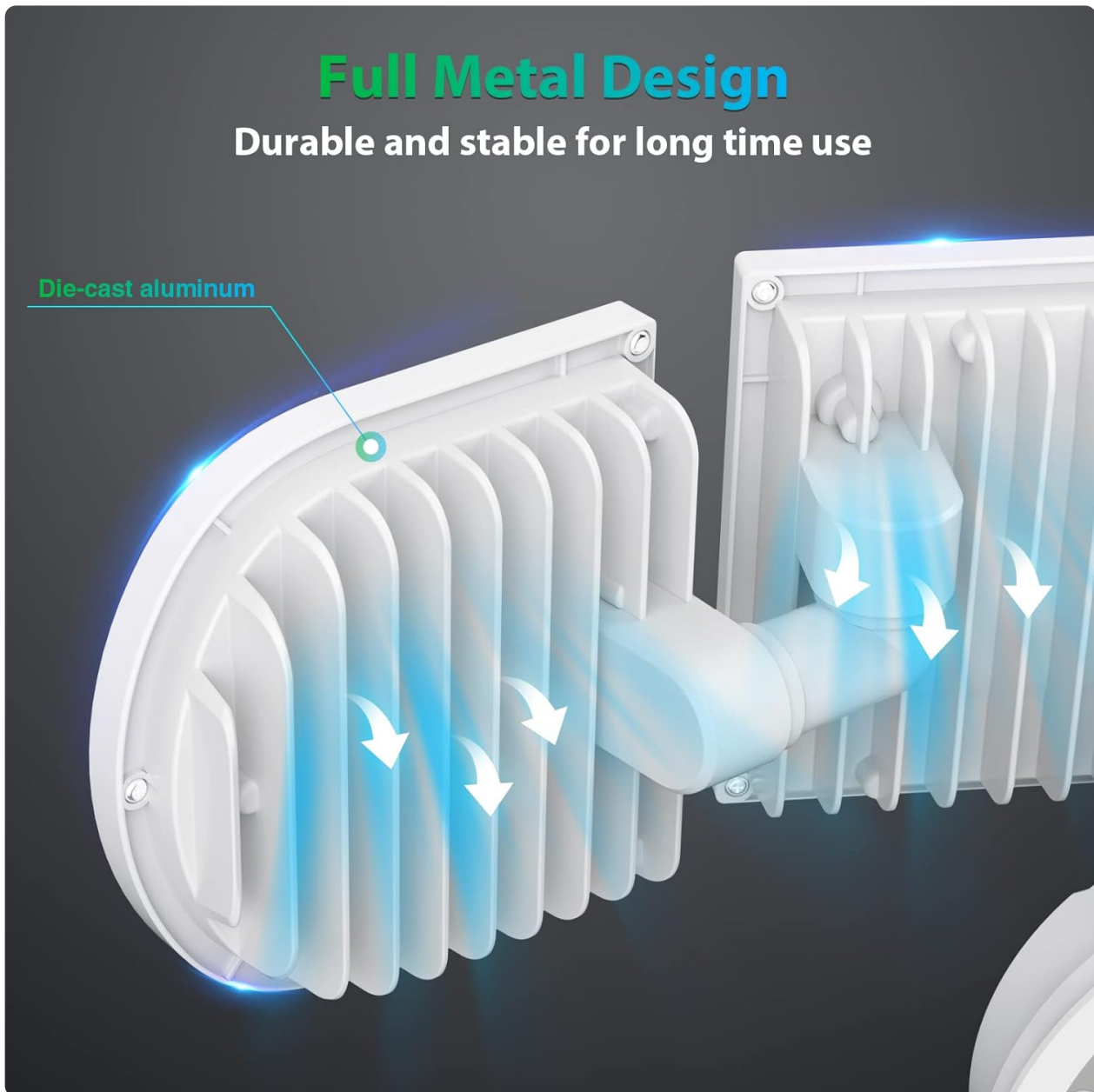

Figure 6: Wiring connections for installation.

5.3 Mounting the Light

1. Attach the mounting bracket to the junction box using the appropriate screws.
2. Align the flood light fixture with the mounting bracket and secure it with the center screw.
3. Adjust the three light heads to your desired angles for optimal coverage.



Figure 7: Example of wall-mounted installation.



Figure 8: Example of soffit-mounted installation.

5.4 Sealing for Waterproof

After mounting, ensure the junction box is properly sealed to prevent water ingress. Use the provided EVA gasket and silicone gasket to create a watertight seal between the fixture and the mounting surface.

5.5 Testing the Light

1. Once installation is complete, restore power at the circuit breaker or fuse box.
2. Turn on the wall switch connected to the flood light to verify it illuminates.

6. OPERATING INSTRUCTIONS

The iMaihom 100W LED Flood Light is designed for simple operation via a standard wall switch. This model does not feature a motion sensor or dusk-to-dawn sensor, providing consistent illumination when activated.

- **Turning On/Off:** Use the connected wall switch to turn the flood light on or off.
- **Adjusting Light Heads:** Manually adjust the angle of each of the three light heads to direct illumination precisely where needed.

100W 9000LM Ultra Brightness

Up to 1977ft² Lighting Area



Figure 9: The flood light provides wide coverage and is switch-controlled without motion or dusk-to-dawn sensors.

7. MAINTENANCE

Regular maintenance helps ensure the longevity and optimal performance of your flood light.

- **Cleaning:** Periodically clean the light fixture with a soft, damp cloth. Do not use abrasive cleaners or solvents, as they may damage the finish or LED components.
- **Inspection:** Annually inspect the fixture for any signs of damage, loose wiring, or wear. Ensure all mounting screws are tight.
- **Power Disconnection:** Always disconnect power to the fixture before performing any cleaning or maintenance.

8. TROUBLESHOOTING

If you encounter issues with your iMaihom flood light, refer to the following common problems and solutions:

Problem	Possible Cause	Solution
Light does not turn on.	No power supply.	Check circuit breaker/fuse. Ensure wall switch is ON.
	Loose wiring connection.	Turn off power, then check and secure all wire connections.
Light flickers.	Unstable power supply.	Consult an electrician to check your home's electrical system.
	Loose wiring.	Turn off power, then check and secure all wire connections.
Water inside fixture.	Improper sealing during installation.	Turn off power immediately. Disassemble, dry thoroughly, and re-seal with gaskets. If damage occurred, replace the unit.

9. SPECIFICATIONS

Feature	Detail
Brand	iMaihom
Model Number	BDD100-3
Wattage	100 Watts
Brightness	9000 Lumens
Color Temperature	6500 Kelvin (Cool White)
Voltage	120 Volts (AC)
Material	Aluminum
Water Resistance Level	IP65
Product Dimensions	15.78"L x 6.18"W x 4.64"H
Item Weight	2.4 Pounds
Control Method	Wall Mount Switch
Special Features	3 Adjustable Heads, Full Metal Design
Bulb Features	Not Dimmable

Durable and Reliable

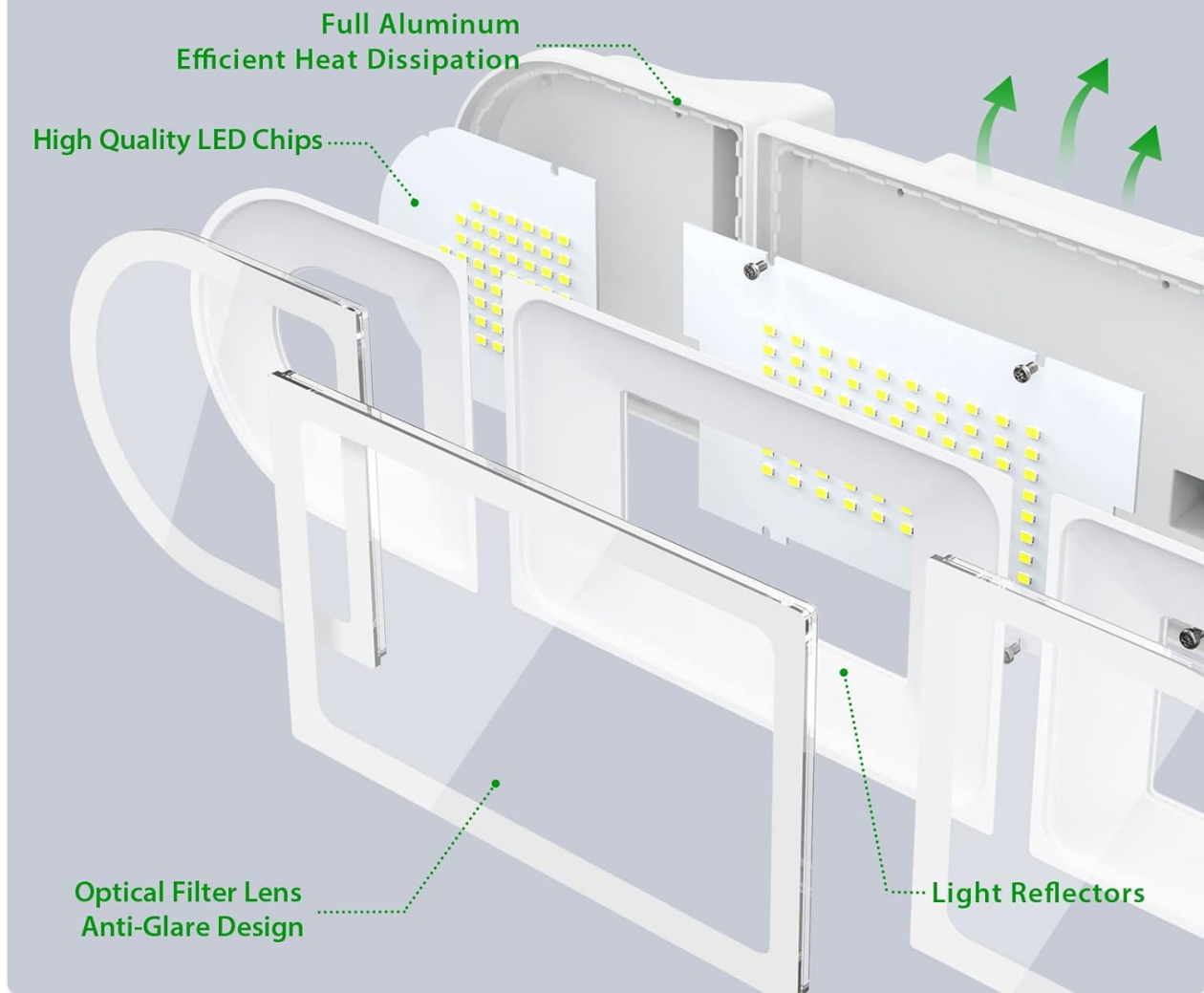

Figure 10: Product dimensions.



Figure 11: High-quality LED chips for bright illumination.

10. WARRANTY & SUPPORT







The iMaihom 100W LED Outdoor Flood Light comes with a **2-year warranty** from the date of purchase, covering defects in materials and workmanship.

For warranty claims, technical support, or any questions regarding your product, please contact iMaihom

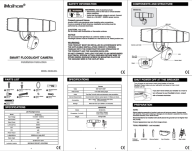
customer service through the retailer's platform or the official iMaihom website. Please have your purchase receipt and model number (BDD100-3) ready when contacting support.

© 2025 iMaihom. All rights reserved.

Related Documents - BDD100-3

	<p>iMaihom Smart Floodlight Camera Installation Instructions</p> <p>Comprehensive installation guide for the iMaihom Smart Floodlight Camera (Model: IM-55A-5CL), covering safety information, parts list, specifications, installation steps, and troubleshooting.</p>
	<p>iMaihom Smart Wireless Floodlight Camera BDBS55SX-5 Installation Guide</p> <p>Comprehensive installation guide and technical specifications for the iMaihom Smart Wireless Floodlight Camera (Model: BDBS55SX-5). Learn about setup, safety precautions, wiring, Wi-Fi connection, and product features.</p>
	<p>Solar Motion Sensor Light Manual - TG-TY07301</p> <p>Comprehensive manual for the TG-TY07301 Solar Motion Sensor Light, detailing specifications, installation, features, light modes, and troubleshooting for optimal outdoor lighting. Features 218 LEDs, 3 modes, IP65 waterproof rating, and adjustable wide angle.</p>
	<p>Solar Powered Security Light User Manual</p> <p>This document provides instructions and information for the solar-powered security light, including installation, mode selection, care, and warranty details.</p>
	<p>ONFORU LED Wall Lamp Product Manual - Installation and Specifications</p> <p>Comprehensive product manual for ONFORU LED Wall Lamps, including model specifications, parts list, preparation guidelines, safety warnings, and step-by-step installation instructions for wet locations.</p>
	<p>MEIKEE Motion Sensor Lights with 3 Adjustable Heads Installation and Specifications</p> <p>Comprehensive guide for MEIKEE Motion Sensor Lights with 3 Adjustable Heads, covering installation, component diagrams, sensor settings, and technical specifications. Learn how to properly install and adjust your motion sensor lights for optimal performance.</p>