

## NexiGo N960E

# NexiGo N960E Webcam User Manual

Model: N960E | Brand: NexiGo

## 1. INTRODUCTION

This manual provides comprehensive instructions for the setup, operation, maintenance, and troubleshooting of your NexiGo N960E 1080P 60FPS Webcam. Please read this manual thoroughly before using the product to ensure optimal performance and longevity.

### Product Overview

The NexiGo N960E is a high-definition webcam designed for various communication and streaming needs. It features 1080p resolution at 60 frames per second, fast autofocus, an adjustable ring fill light, a built-in privacy cover, and dual stereo microphones with noise-canceling technology. It is compatible with major operating systems and video conferencing platforms.

### What's in the Box

- NexiGo N960E Webcam
- USB Cable
- Privacy Cover (built-in)
- User Manual (this document)



Figure 1: NexiGo N960E Webcam. This image shows the webcam with its integrated ring light and the adjustable clip stand.

## 2. SETUP AND INSTALLATION

## 2.1 Physical Installation

### 1. Mounting the Webcam:

The NexiGo N960E webcam features a versatile mounting clip. You can place it securely on top of your computer monitor, laptop screen, or a flat surface. The clip is designed to provide a stable base.

Alternatively, the webcam includes a standard 1/4-inch tripod screw hole on the bottom of the clip, allowing it to be mounted on a tripod or other compatible stand for more flexible positioning.

### 2. Connecting to Your Computer:

Connect the provided USB cable to the USB-A port on the webcam and then plug the other end into an available USB port on your computer. The webcam is plug-and-play, meaning no additional drivers are typically required for basic functionality.

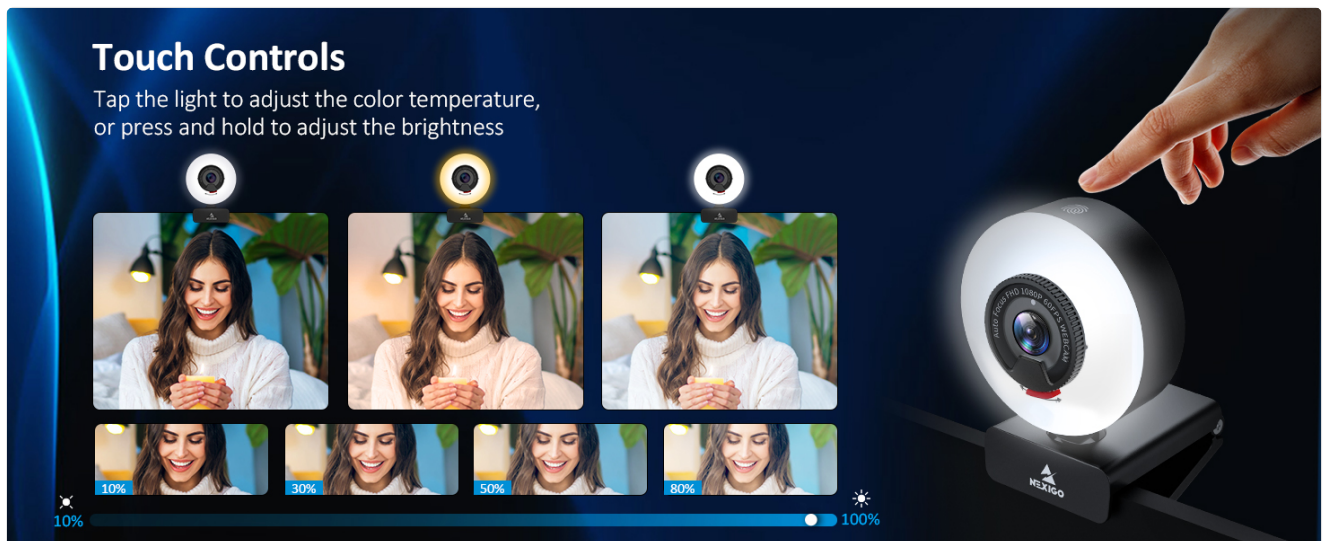

Figure 2: Webcam in use on a laptop. This image illustrates the webcam mounted on a laptop, actively participating in a video conference.

## 2.2 Software Installation (Optional)

For advanced settings and customization, it is recommended to download and install the NexiGo Webcam Settings application from the official NexiGo website. This software allows you to fine-tune image parameters such as brightness, contrast, saturation, and more.

- **Compatibility:** The NexiGo N960E is compatible with Windows XP/7/8/10/11, Mac OS 10.6 or higher, Linux 2.6.24 or higher, Chrome OS 29.0.1547 or higher, and Ubuntu Version 10.04 or higher.
- **Supported Applications:** The webcam works seamlessly with popular video conferencing and streaming applications such as Zoom, Skype, Microsoft Teams, Twitch, and more.

## 3. OPERATING INSTRUCTIONS

### 3.1 Ring Fill Light

The built-in ring light provides illumination for improved video quality, especially in low-light conditions. It offers three light modes and stepless adjustable brightness.

- **Adjusting Light Modes:** Lightly touch the designated area on the webcam to cycle through the three different light modes (e.g., warm, cool, natural).

- **Adjusting Brightness:** Touch and hold the designated area to continuously adjust the brightness level. Release when the desired brightness is achieved.



Figure 3: Ring Light Controls. This image illustrates how to adjust the ring light's color temperature and brightness using touch controls.

### 3.2 Autofocus Technology

The NexiGo N960E features enhanced autofocus to ensure you remain sharp and clear in your video feed. The camera automatically adjusts its focus to keep the subject in focus, even with slight movements.



Figure 4: Autofocus in action. This image demonstrates the webcam's autofocus capability, keeping the subject sharp and clear.

### 3.3 Built-in Privacy Shutter

For enhanced privacy and security, the webcam includes a built-in physical privacy cover. When not in use, simply slide the cover over the lens to prevent unauthorized access to your camera feed and ensure peace of mind.





Figure 5: Privacy Shutter. This image shows the webcam with its privacy shutter open and closed, highlighting the security feature.

### 3.4 Dual Stereo Microphone with Noise-Canceling

The integrated dual stereo microphones utilize noise-canceling technology to reduce ambient background noise, ensuring your voice is captured clearly and distinctly during calls or recordings, even in noisy environments.

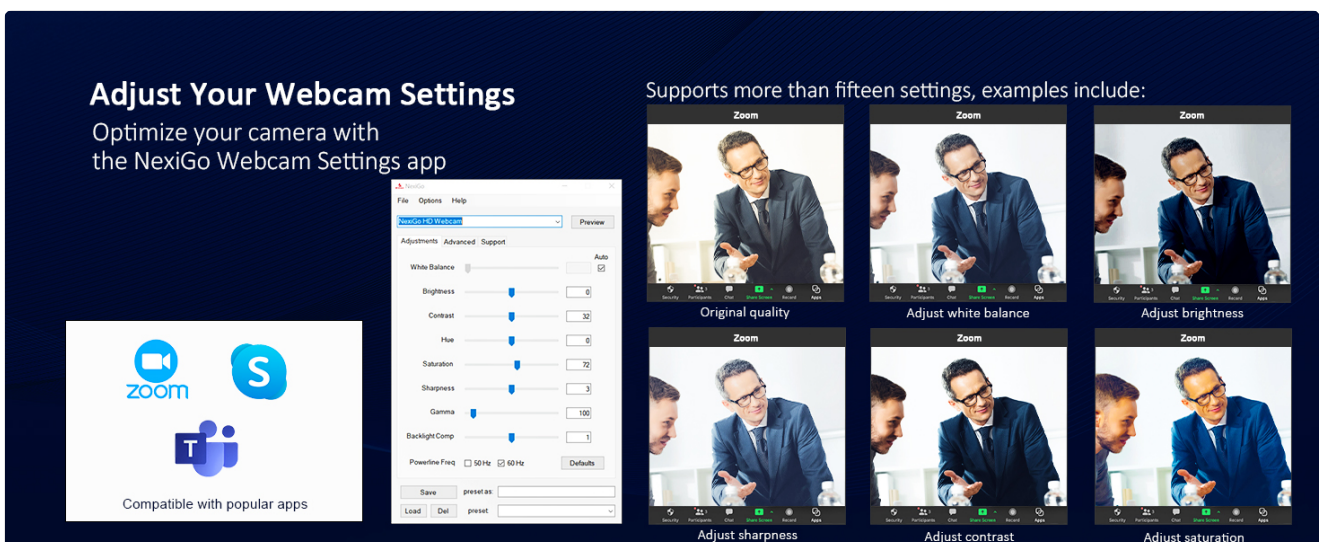

Figure 6: Noise-Canceling Microphone. This image illustrates the webcam's microphone capturing clear audio by reducing background noise.

### 3.5 Adjusting Webcam Settings (NexiGo Webcam Settings App)

For advanced control over your webcam's image and audio settings, use the NexiGo Webcam Settings application. This software allows you to adjust various parameters to optimize your video output.

- **Available Settings:** Adjustments include White Balance, Brightness, Contrast, Hue, Saturation, Sharpness, Gamma, and Backlight Compensation.
- **Saving Presets:** The application allows you to save and load custom settings presets for different lighting conditions or usage scenarios.

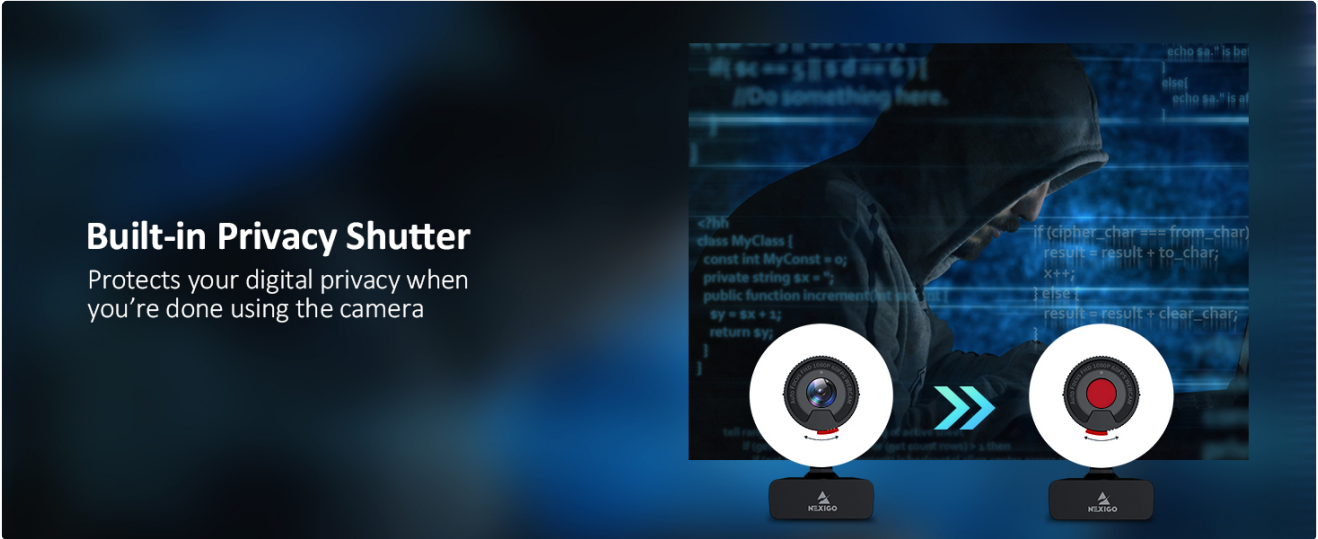

Figure 7: NexiGo Webcam Settings App. This screenshot displays the user interface of the NexiGo Webcam Settings application, showing various adjustable parameters.

### 3.6 Product Videos

Your browser does not support the video tag.

Video 1: NexiGo N960E Product Overview. This video provides a general overview of the NexiGo N960E webcam's features and benefits.

## 4. MAINTENANCE

Proper maintenance ensures the longevity and optimal performance of your webcam.

- **Cleaning the Lens:** Use a soft, lint-free cloth specifically designed for optics to gently wipe the webcam lens. Avoid using abrasive materials or harsh cleaning chemicals, which can scratch or damage the lens coating.
- **Cleaning the Body:** Wipe the body of the webcam with a soft, damp cloth. Do not immerse the webcam in water or any other liquid.
- **Storage:** When not in use for extended periods, store the webcam in a cool, dry place, away from direct sunlight and extreme temperatures. Ensure the privacy cover is closed to protect the lens.

## 5. TROUBLESHOOTING

If you encounter issues with your NexiGo N960E webcam, please refer to the following common problems and solutions:

Problem	Possible Cause	Solution
---------	----------------	----------

Problem	Possible Cause	Solution
<b>No Image/Video Output</b>	USB cable not properly connected. Webcam not selected in application settings. Privacy cover is closed. Driver issue (rare for plug-and-play).	Ensure USB cable is securely plugged into both the webcam and the computer. Try a different USB port. In your video conferencing/streaming software, check camera settings and select "NexiGo N960E". Slide the privacy cover open. Restart your computer. If issues persist, check device manager for webcam status or reinstall the NexiGo Webcam Settings app.
<b>Poor Video Quality (Blurry, Dark, Grainy)</b>	Insufficient lighting. Lens is dirty. Incorrect software settings. Autofocus interference.	Activate and adjust the ring fill light. Ensure adequate ambient lighting. Gently clean the webcam lens with a soft, lint-free cloth. Open the NexiGo Webcam Settings app and adjust brightness, contrast, and sharpness. Ensure there are no obstructions in front of the lens that might interfere with autofocus.
<b>Microphone Not Working or Poor Audio</b>	Microphone not selected in application settings. System audio input settings incorrect. Excessive background noise.	In your application's audio settings, select "NexiGo N960E Microphone" as the input device. Check your computer's sound settings to ensure the webcam microphone is enabled and set as the default input device. While the microphone has noise-canceling, try to minimize loud background noises for optimal clarity.

## 6. SPECIFICATIONS

Feature	Detail
<b>Model Number</b>	N960E
<b>Product Dimensions</b>	2.36 x 1.78 x 3.43 inches
<b>Item Weight</b>	8.1 ounces
<b>Video Capture Resolution</b>	1080p (Full HD)
<b>Frame Rate</b>	Up to 60 frames per second (fps)
<b>Photo Sensor Technology</b>	CMOS
<b>Maximum Aperture</b>	2.8 Millimeters
<b>Video Capture Format</b>	YUY2/MJPG
<b>Supported Audio Format</b>	MP3, WAV, AAC

Feature	Detail
Connectivity Technology	USB
Color	Black
Manufacturer	NexiGo

## 7. WARRANTY AND SUPPORT

### Customer Support

NexiGo is committed to providing excellent customer service. For any inquiries, technical assistance, or support needs, please contact our dedicated support team.

- **Response Time:** Expect quick responses, typically within 24 hours.
- **Technical Support:** Lifetime technical support is provided for your NexiGo product.
- **Returns:** Products can typically be returned within 30 days for an exchange or refund.

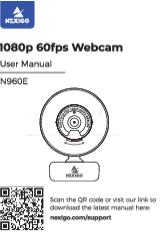







Figure 8: NexiGo Customer Support. This image depicts a customer support representative, symbolizing NexiGo's commitment to user assistance.

### Official Resources

- **Official User Manual (PDF):** [Download PDF Manual](#)
- **NexiGo Brand Store:** [Visit NexiGo Store on Amazon](#)



 <p><b>1080p 60fps Webcam</b> User Manual N960E</p> <p>Scan the QR code or visit our link to download the latest manual here: <a href="https://nexigo.com/support">nexigo.com/support</a></p>	<p><a href="#">NexiGo N960E 1080p 60fps Webcam User Manual</a></p> <p>Explore the NexiGo N960E 1080p 60fps webcam with this comprehensive user manual. Learn about setup, features, specifications, safety, and software for optimal performance. Download the latest version from <a href="https://nexigo.com/support">nexigo.com/support</a>.</p>
 <p><b>1080P FHD Webcam</b> N60 User Manual</p> <p>Scan the QR code or visit our link to download the latest manual here: <a href="https://nexigo.com/manuals">nexigo.com/manuals</a></p>	<p><a href="#">NexiGo N60 1080P FHD Webcam User Manual</a></p> <p>Official user manual for the NexiGo N60 1080P FHD Webcam. Get detailed setup guides, technical specifications, software information, and FAQs for optimal video conferencing and streaming.</p>
	<p><a href="#">NexiGo 1080P FHD Autofocus Webcam User Manual</a></p> <p>User manual for the NexiGo 1080P FHD Autofocus Webcam, covering product overview, specifications, setup, and troubleshooting.</p>
 <p><b>1080P FHD AutoFocus Webcam</b> N930AF User Manual</p> <p>Scan the QR code or visit our link to download the latest manual here: <a href="https://nexigo.com/manuals">nexigo.com/manuals</a></p>	<p><a href="#">NexiGo N930AF 1080P FHD Autofocus Webcam User Manual</a></p> <p>User manual for the NexiGo N930AF 1080P FHD Autofocus Webcam, detailing setup, features, specifications, software, and troubleshooting for clear video calls and streaming.</p>
 <p><b>1080P FHD AutoFocus Webcam</b> N660P User Manual</p> <p>Scan the QR code or visit our link to download the latest manual here: <a href="https://nexigo.com/manuals">nexigo.com/manuals</a></p>	<p><a href="#">NexiGo N660P 1080P FHD Autofocus Webcam User Manual</a></p> <p>User manual for the NexiGo N660P 1080P FHD Autofocus Webcam. Provides setup instructions, specifications, software details, and troubleshooting FAQs for optimal video communication and streaming.</p>
 <p><b>1080P FHD Webcam</b> N60 User Manual</p> <p>Scan the QR code or visit our link to download the latest manual here: <a href="https://nexigo.com/manuals">nexigo.com/manuals</a></p>	<p><a href="#">NexiGo N60 1080P FHD Webcam User Manual</a></p> <p>Comprehensive user manual for the NexiGo N60 1080P FHD Webcam. Learn about setup, specifications, software features, and troubleshooting for enhanced video calls and streaming.</p>