

[Manuals.plus](#) /

> [lindero](#) /

> lindero True Wireless Earbuds Active Noise Cancelling Headphones Bluetooth 5.2 Waterproof Wireless Earphones Touch Control with Charging Case, Type-C Quick Charge, 40Hrs for Running Gym Work Black User Manual

lindero H26-BK

lindero True Wireless Earbuds User Manual

Model: H26-BK

INTRODUCTION

Thank you for choosing lindero True Wireless Earbuds. This manual provides essential information on how to set up, operate, maintain, and troubleshoot your new earbuds. Please read this manual thoroughly before use to ensure optimal performance and longevity of your device.

WHAT'S IN THE BOX

Carefully unpack your lindero True Wireless Earbuds and ensure all items are present:

- lindero True Wireless Earbuds (Left and Right)
- Charging Case
- USB Type-C Charging Cable
- Ear Tips (S, M, L sizes)
- User Manual

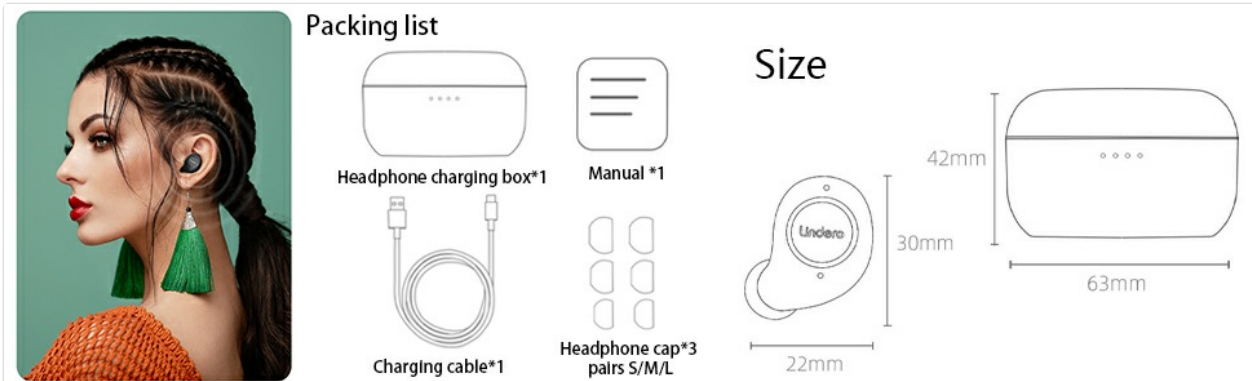

Image: Contents of the product packaging, showing the earbuds, charging case, USB-C cable, and multiple sizes of ear tips.

PRODUCT OVERVIEW

The lindero True Wireless Earbuds are designed for comfort and high-quality audio. Familiarize yourself with the main components:

- **Earbuds:** Left and Right earbuds with touch control surfaces.
- **Charging Case:** Stores and charges the earbuds, with LED indicators for battery status.
- **USB Type-C Port:** For charging the case.
- **Microphones:** Integrated for calls and noise cancellation.



Image: The lindero True Wireless Earbuds placed inside their open charging case, illustrating their compact design.

SETUP

1. Charging the Earbuds and Case

Before first use, fully charge the earbuds and the charging case.

1. Place the earbuds into the charging case. Ensure they are correctly seated; the earbuds will automatically begin charging.

2. Connect the USB Type-C cable to the charging port on the case and the other end to a USB power adapter (not included) or a computer's USB port.
3. The LED indicators on the charging case will show the charging status. A full charge typically takes less than 2 hours.

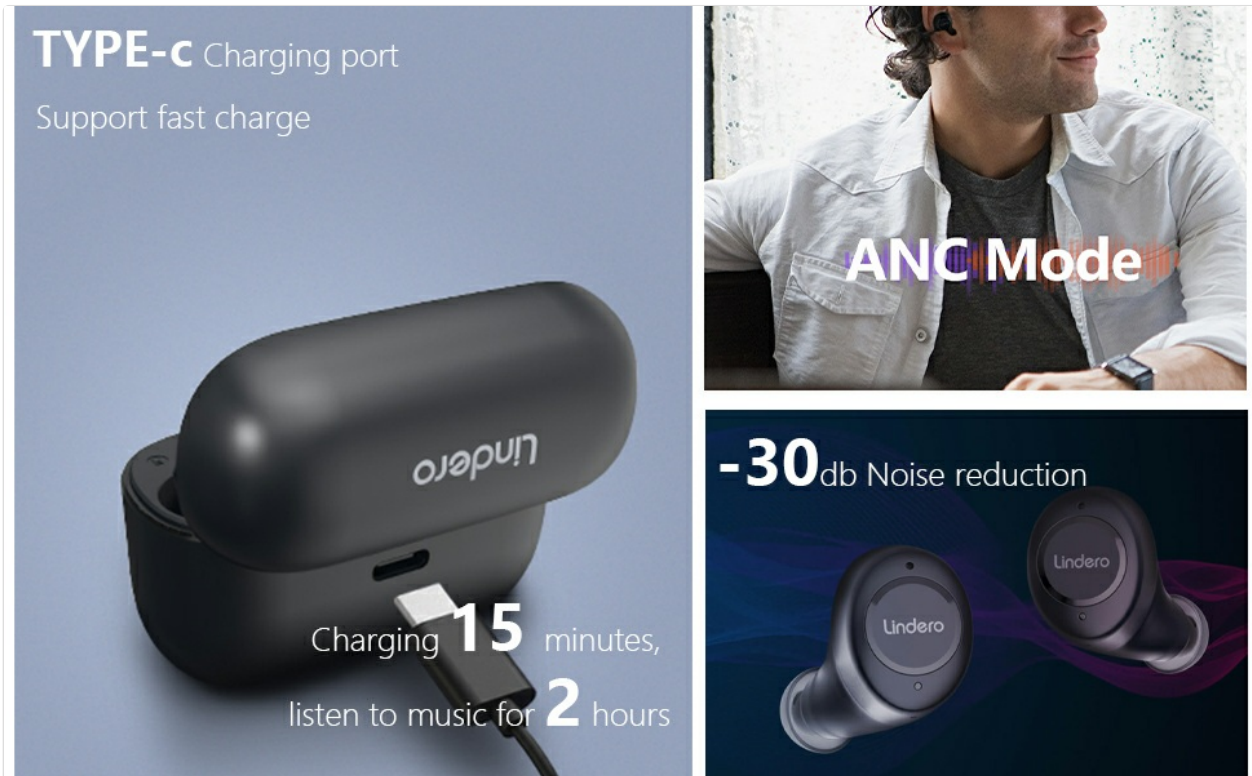

Image: A close-up of the charging case with a USB Type-C cable inserted into its charging port, indicating fast charging capability.

2. Pairing with Your Device

The earbuds use Bluetooth 5.2 for a stable connection.

1. Open the charging case. The earbuds will automatically enter pairing mode (indicated by flashing LED lights on the earbuds).
2. On your device (smartphone, tablet, computer), enable Bluetooth.
3. Search for new devices and select "lindero Earbuds" from the list.
4. Once connected, the earbud LEDs will stop flashing, and you will hear a confirmation tone.

3. Wearing the Earbuds

For optimal sound quality and comfort, choose the correct ear tip size and ensure a secure fit.

1. Select the ear tips (S, M, L) that best fit your ear canals. A good seal is crucial for noise cancellation and bass performance.
2. Gently insert each earbud into your ear canal and twist slightly to secure it. The earbuds should feel snug but comfortable.



Image: A diagram illustrating the proper fit of the earbuds in the ear, along with representations of small, medium, and large ear tips for selection.

OPERATING THE EARBUDS

The Lindero earbuds feature intuitive touch controls on each earbud.

1. Basic Controls

- **Play/Pause:** Double-press either earbud.
- **Volume Up:** Press and hold the right earbud.
- **Volume Down:** Press and hold the left earbud.
- **Next Track:** Triple-press the right earbud.
- **Previous Track:** Triple-press the left earbud.

2. Call Management

- **Answer/End Call:** Double-press either earbud.
- **Reject Call:** Press and hold either earbud for 2 seconds.

3. Noise Control Modes

The earbuds support Active Noise Cancellation (ANC) and Transparency Mode.

- **Switch Modes (ANC On/Transparency/ANC Off):** Press and hold the left earbud for 2 seconds to cycle through modes.

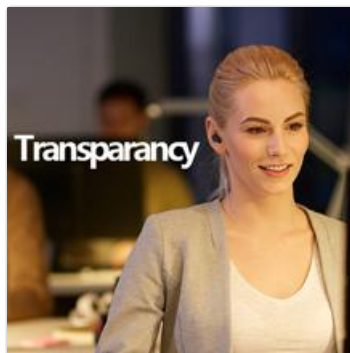

Image: A woman wearing the earbuds, illustrating the use of Transparency Mode which allows ambient sounds to be heard.

4. Voice Assistant

- **Activate Voice Assistant (Siri/Google Assistant):** Press and hold the right earbud for 2 seconds.

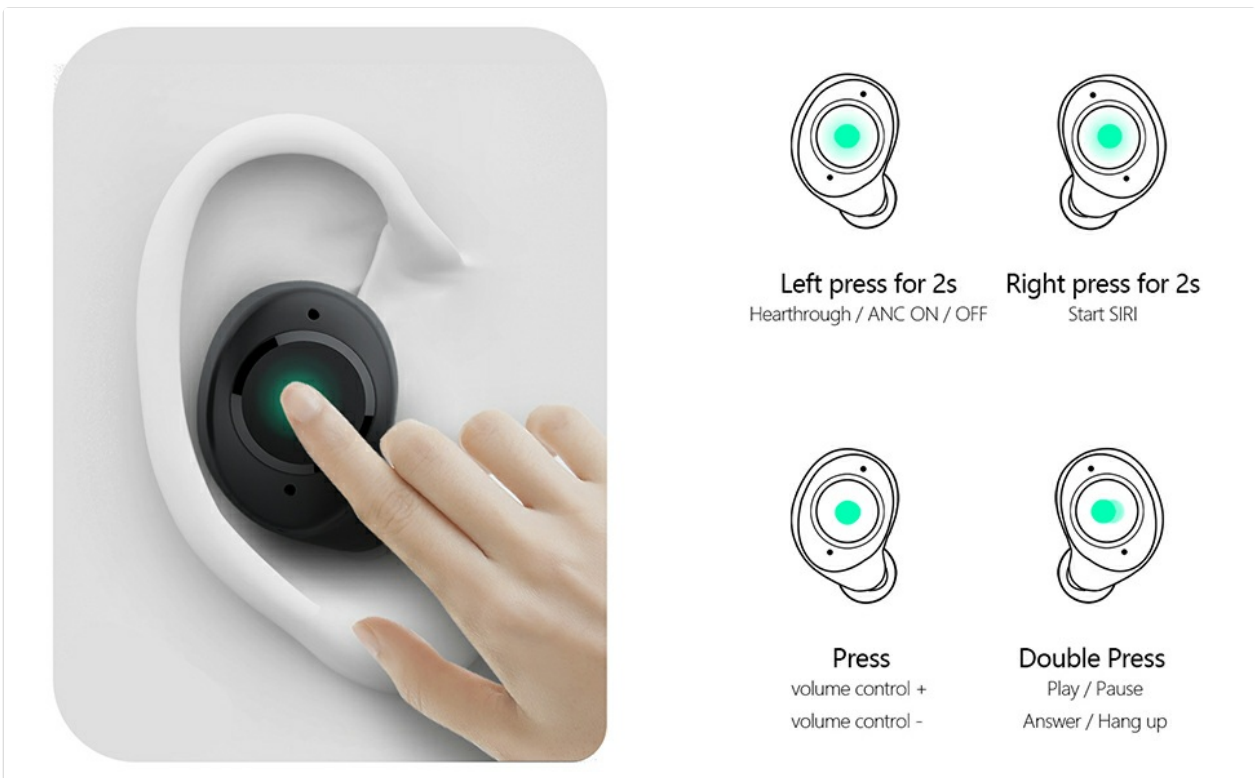

Image: A detailed diagram showing the touch control functions for both the left and right earbuds, including actions for play/pause, volume, ANC, and voice assistant activation.

MAINTENANCE

1. Cleaning

Regular cleaning helps maintain sound quality and hygiene.

- Use a soft, dry, lint-free cloth to wipe the earbuds and charging case.
- For ear tips, remove them from the earbuds and clean with a damp cloth and mild soap if necessary. Rinse thoroughly and dry completely before reattaching.
- Do not use abrasive cleaners or immerse the earbuds or case in water.

2. Storage

When not in use, store the earbuds in their charging case to protect them and keep them charged.

- Store in a cool, dry place, away from extreme temperatures and direct sunlight.



IPX4 level Life waterproof

Water Splash Proof & Sweating Proof

Image: A close-up of an earbud with water droplets on its surface, demonstrating its IPX4 water resistance for protection against splashes and sweat.

TROUBLESHOOTING

If you encounter issues with your earbuds, try the following solutions:

Problem	Possible Solution
Earbuds not pairing	<ul style="list-style-type: none">Ensure earbuds are charged.Turn off and on Bluetooth on your device.Forget the device in your Bluetooth settings and re-pair.Place earbuds back in the case, close, then reopen to reset pairing mode.

Problem	Possible Solution
Only one earbud working	<p>Ensure both earbuds are charged.</p> <p>Place both earbuds back in the case, close, then reopen.</p> <p>Reset the earbuds (refer to manufacturer's specific reset instructions if available, otherwise try forgetting device and re-pairing).</p>
Low volume or poor sound quality	<p>Adjust volume on both earbuds and your connected device.</p> <p>Ensure ear tips provide a good seal in your ear canal. Try different sizes.</p> <p>Clean any debris from the earbud nozzles and ear tips.</p>
Charging case not charging	<p>Check the USB Type-C cable and power adapter. Try a different cable or adapter.</p> <p>Ensure the charging port is clean and free of debris.</p>

SPECIFICATIONS

Feature	Detail
Model Name	True (Manufacturer Reference: H26-BK)
Connectivity	Bluetooth 5.2
Audio Codec	Qualcomm aptX
Driver Size	6mm Dynamic Drivers
Noise Control	Active Noise Cancellation (ANC), Transparency Mode, CVC 8.0 Noise Reduction for calls
Playtime (Earbuds)	Up to 8 hours
Total Playtime (with Case)	Up to 40 hours
Charging Port	USB Type-C (Fast Charge Supported)
Water Resistance	IPX4 (Splash and Sweat Proof)
Ear Placement	In-Ear
Dimensions (Product)	5.08 x 30.48 x 3.81 cm
Weight (Product)	20 g

WARRANTY AND SUPPORT

lindero products are designed and manufactured to the highest quality standards. For warranty information and technical support, please refer to the warranty card included with your product or visit the official lindero website. Please retain your proof of purchase for any warranty claims.

For further assistance, you may contact lindero customer support through the contact information provided on our official website or through your retailer.