

NAHANCO VR8324U1

NAHANCO Rowenta Professional Compact Steam Pro Iron

Model: VR8324U1 - User Manual

INTRODUCTION

The NAHANCO Rowenta Professional Compact Steam Pro Iron, model VR8324U1, is a high-performance steam generator designed for efficient garment care. This appliance delivers professional results with enhanced steam output, making ironing tasks quicker and more effective. Its compact design and high-capacity removable water tank ensure convenience and extended ironing sessions without frequent refills. This manual provides essential information for the safe and effective use, setup, operation, maintenance, and troubleshooting of your steam iron.

IMPORTANT SAFETY INSTRUCTIONS

Please read all instructions carefully before using the appliance and retain them for future reference. Failure to follow these instructions may result in electric shock, fire, or serious injury.

- Always ensure the voltage indicated on the appliance corresponds to your main voltage before connecting.
- Do not leave the iron unattended while it is connected to the power supply or while it is hot.
- Keep the iron and its cord out of reach of children and persons with reduced physical, sensory, or mental capabilities.
- Do not immerse the iron, power cord, or plug in water or any other liquid.
- Unplug the iron from the electrical outlet before filling the water tank, emptying the water tank, or when not in use.
- Use the iron only for its intended purpose, which is ironing garments.
- Do not operate any appliance with a damaged cord or plug, or after the appliance malfunctions or has

been dropped or damaged in any manner.

- Place the iron on a stable, heat-resistant surface when resting.
- Never direct steam towards people or animals.

PRODUCT OVERVIEW AND FEATURES

The NAHANCO Rowenta Professional Compact Steam Pro Iron is engineered for superior performance and ease of use. Key features include:

- **High-Performance Steam Generator:** Delivers professional results with significantly more steam output than traditional steam irons.
- **High-Capacity Removable Water Tank:** Allows for extended ironing sessions without the need for frequent refills.
- **Powerful Steam Output:** Features 6.5 bar pump pressure and a 350g/minute steam boost for efficient and quick wrinkle removal.
- **Durable Stainless-Steel Soleplate:** Provides maximum coverage glide for smooth movement across fabrics.
- **400 Micro Holes:** Ensures perfect steam diffusion for optimal ironing results.



Figure 1: Main view of the NAHANCO Rowenta Professional Compact Steam Pro Iron, showcasing its compact design and integrated water tank.



Figure 2: Side view of the steam iron, highlighting the ergonomic handle and steam generator base.



Figure 3: Rear view of the steam iron base, showing the control panel and power cord storage area.

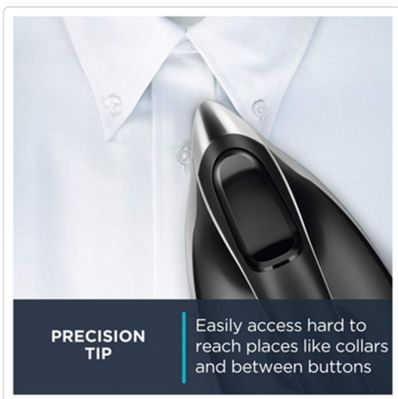

PRECISION TIP

Easily access hard to reach places like collars and between buttons

Figure 4: Close-up of the iron's precision tip, designed to easily access hard-to-reach places like collars and between buttons.

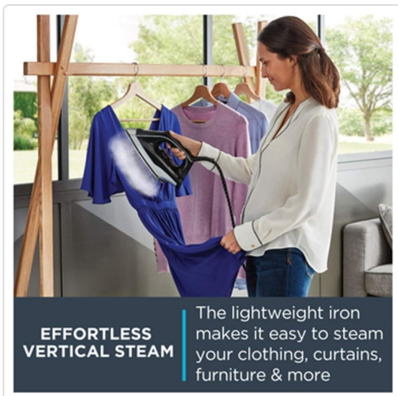

EFFORTLESS VERTICAL STEAM

The lightweight iron makes it easy to steam your clothing, curtains, furniture & more

Figure 5: Demonstration of effortless vertical steam, showing the iron being used to steam a hanging garment. This feature is also suitable for curtains and furniture.



Figure 6: Detail of the durable stainless steel soleplate, featuring 400 HD micro holes for maximum steam diffusion and optimal ironing results.

SETUP

Follow these steps to prepare your steam iron for first use:

1. **Unpack the Iron:** Carefully remove all packaging materials and ensure all components are present. Keep packaging for potential future transport or returns.
2. **Position the Iron:** Place the steam generator base on a stable, flat, and heat-resistant surface, such as an ironing board or a sturdy table.
3. **Fill the Water Tank:** Remove the water tank from the base. Fill it with clean tap water up to the 'MAX' indicator line. Do not overfill. Reinsert the water tank securely into the base.
4. **Connect to Power:** Unwind the power cord and plug the iron into a grounded electrical outlet.
5. **Initial Heating:** The iron will begin to heat up. The indicator light on the base will illuminate and may flash during heating. Wait for the light to become steady, indicating the iron is ready for use.

OPERATING INSTRUCTIONS

Once set up, follow these instructions for effective ironing:

1. **Select Fabric Setting:** If your model has a temperature dial, adjust it according to the fabric type you are ironing. For models with automatic temperature, proceed to the next step.
2. **Steam Activation:** Press the steam trigger located under the handle to release continuous steam. For an extra burst of steam, press the steam boost button (if available).
3. **Horizontal Ironing:** Move the iron smoothly over the garment. The stainless-steel soleplate ensures even heat and steam distribution.
4. **Vertical Steaming:** For hanging garments, curtains, or delicate fabrics, hold the iron vertically a few inches away from the fabric and press the steam trigger. Move the iron up and down to remove wrinkles.
5. **Refilling Water During Use:** If the water tank runs low, the iron may stop producing steam. Unplug the iron, remove the water tank, refill it, and reinsert. Plug the iron back in and wait for it to reheat.
6. **Finishing Ironing:** When finished, release the steam trigger. Place the iron back on its base.
7. **Power Off:** Unplug the iron from the electrical outlet. Allow the iron to cool completely before storing.

MAINTENANCE

Regular maintenance ensures the longevity and optimal performance of your steam iron.

- **Cleaning the Soleplate:** After the iron has cooled, wipe the soleplate with a damp cloth. For stubborn stains, use a specialized soleplate cleaning stick or a mixture of baking soda and water, applied with a soft cloth. Never use abrasive cleaners or metallic scouring pads.
- **Emptying the Water Tank:** After each use, or before storing for an extended period, empty any remaining water from the tank. This prevents mineral buildup.
- **Descaling:** Depending on water hardness and frequency of use, descaling may be required. Refer to the manufacturer's specific descaling instructions, usually involving a descaling solution or a self-clean function. Regular descaling prevents mineral deposits from clogging steam vents.
- **Storage:** Once the iron is completely cool, wrap the power cord neatly around the base (if a cord storage feature is present). Store the iron in an upright position in a dry, safe place, away from children.

TROUBLESHOOTING

If you encounter issues with your NAHANCO Rowenta Professional Compact Steam Pro Iron, consult the following table:

Problem	Possible Cause	Solution
No steam is produced.	Water tank is empty; iron not hot enough; steam button not pressed.	Refill water tank; wait for indicator light to stabilize; press steam trigger.
Water leaks from the soleplate.	Temperature too low for steam; water tank overfilled; iron not fully heated.	Increase temperature setting; do not overfill tank; wait for iron to reach full temperature.
Iron does not heat up.	Not plugged in; power outlet issue; appliance malfunction.	Check power connection; test outlet with another appliance; contact customer support if issue persists.
Poor ironing results.	Incorrect temperature setting; insufficient steam; soleplate is dirty.	Adjust temperature for fabric; ensure water tank is full and steam is active; clean the soleplate.

SPECIFICATIONS

- **Model Number:** VR8324U1
- **Brand:** NAHANCO
- **Model Name:** COMPACT STEAM STATION
- **Wattage:** 1800 watts
- **Base Material:** Stainless Steel
- **Package Dimensions:** 15.1 x 11.5 x 9.2 inches

- **Item Weight:** 8.85 Pounds
- **Color:** Black
- **Special Features:** Travel-ready

WARRANTY AND SUPPORT

For warranty information or technical support regarding your NAHANCO Rowenta Professional Compact Steam Pro Iron, please contact NAHANCO customer service. Keep your purchase receipt as proof of purchase for any warranty claims.

Manufacturer: NAHANCO

Please refer to the official NAHANCO website or your product packaging for the most current contact information and detailed warranty terms.