

[Manuals.plus](#) /

> [Maxcio](#) /

> Maxcio Mini WiFi Smart Switch (Model: QS-WIFI-S06-16A) User Manual

## Maxcio QS-WIFI-S06-16A

# Maxcio Mini WiFi Smart Switch User Manual

Model: QS-WIFI-S06-16A

## 1. INTRODUCTION

---

The Maxcio Mini WiFi Smart Switch (Model: QS-WIFI-S06-16A) is a compact device designed to convert traditional electrical appliances and lighting into smart, app-controlled, and voice-activated systems. This module allows for remote control, scheduling, and integration with smart home platforms like Amazon Alexa and Google Home.



Image 1.1: Maxcio Mini WiFi Smart Switch with its mobile application interface. The switch is shown with its wiring terminals and compact design, alongside a smartphone displaying the 'Switch 1' control screen.

## 2. SAFETY INFORMATION

**Please read all safety warnings and instructions carefully before installation and use. Failure to follow these instructions may result in electric shock, fire, or serious injury.**

- Installation must be performed by a qualified electrician in accordance with local regulations.
- Keep the device out of reach of children.
- Keep the device away from water, humid environments, or high temperatures.
- Install the device away from strong signal sources, such as microwave ovens, which can cause signal interruption and abnormal operation.
- Obstruction by concrete walls or metallic materials can reduce the effective operating range of the device and should be avoided.
- DO NOT attempt to disassemble, repair, or modify the device.
- A neutral line is required for the installation of this device.

## 3. PRODUCT FEATURES

The Maxcio Mini WiFi Smart Switch offers a range of features to enhance your smart home experience:

- **Super Mini Size:** Compact design (4.0 x 4.0 x 2.0 cm) allows for easy installation behind wall switches, in junction boxes, or within light fixtures.
- **DIY Smart Home:** Convert traditional lights (up to 300W) and appliances (up to 3680W) into smart devices.
- **Remote Control:** Control your devices from anywhere using the free Maxcio app on your smartphone or tablet via a 2.4GHz WiFi network.
- **Voice Control:** Compatible with Amazon Alexa and Google Home for hands-free operation.
- **Timer & Schedule:** Set custom schedules and countdown timers for automated control of your devices.
- **Family Sharing:** Share control of the smart switch with family members through the app.
- **Group Control:** Create groups to control multiple smart switches simultaneously.



Image 3.1: An overview of the Maxcio Mini WiFi Smart Switch's key features, including Voice Control, Maxcio APP, Device Sharing, Group Control, Timer/Schedule, and its Super Mini size, displayed around the physical switch module.

## 4. SETUP

### 4.1. App Installation

1. Download the free **Maxcio** application from the Google Play Store or Apple App Store. Alternatively, scan the QR code provided in the product packaging or manual.
2. Register for a new account or log in if you already have one.

## 4.2. Wiring Diagram and Installation

Before proceeding, ensure the main power supply is turned OFF at the circuit breaker to prevent electric shock.



Image 4.1: Examples of how the Maxcio Mini WiFi Smart Switch can be integrated into existing electrical systems, including behind a wall switch, within a wall plug, and connected to a light switch for various applications.

The Maxcio Mini WiFi Smart Switch requires a neutral line for operation. The terminals are labeled as follows:

- **L-Out:** Live output to the load (e.g., light, appliance).
- **L-in:** Live input from the power supply.
- **N-in:** Neutral input from the power supply.
- **N-Out:** Neutral output to the load.
- **S1, S2:** Terminals for connecting a traditional wall switch (optional, for manual control).

Follow the wiring diagram provided in the product packaging or consult a qualified electrician for proper installation.

### 4.3. Device Pairing

1. Ensure your smartphone is connected to a 2.4GHz WiFi network. The device does not support 5GHz networks.
2. Power on the Maxcio Mini WiFi Smart Switch. The indicator light should blink rapidly, indicating it is in pairing mode. If not, refer to the product packaging for instructions on how to reset the device to pairing mode.
3. Open the Maxcio app, tap the "+" icon to add a new device.
4. Select the appropriate device type (e.g., "Switch Module").
5. Follow the on-screen instructions to connect the switch to your WiFi network. This typically involves confirming the indicator light is blinking and entering your WiFi password.
6. Once successfully paired, you can rename the switch for easier identification.

## 5. OPERATING INSTRUCTIONS

---

### 5.1. App Control

After successful pairing, you can control your Maxcio Mini WiFi Smart Switch directly from the Maxcio app:

- Tap on the device name to access its control interface.
- Toggle the switch icon to turn the connected appliance/light ON or OFF.
- Access settings for advanced options like timers, schedules, and device information.

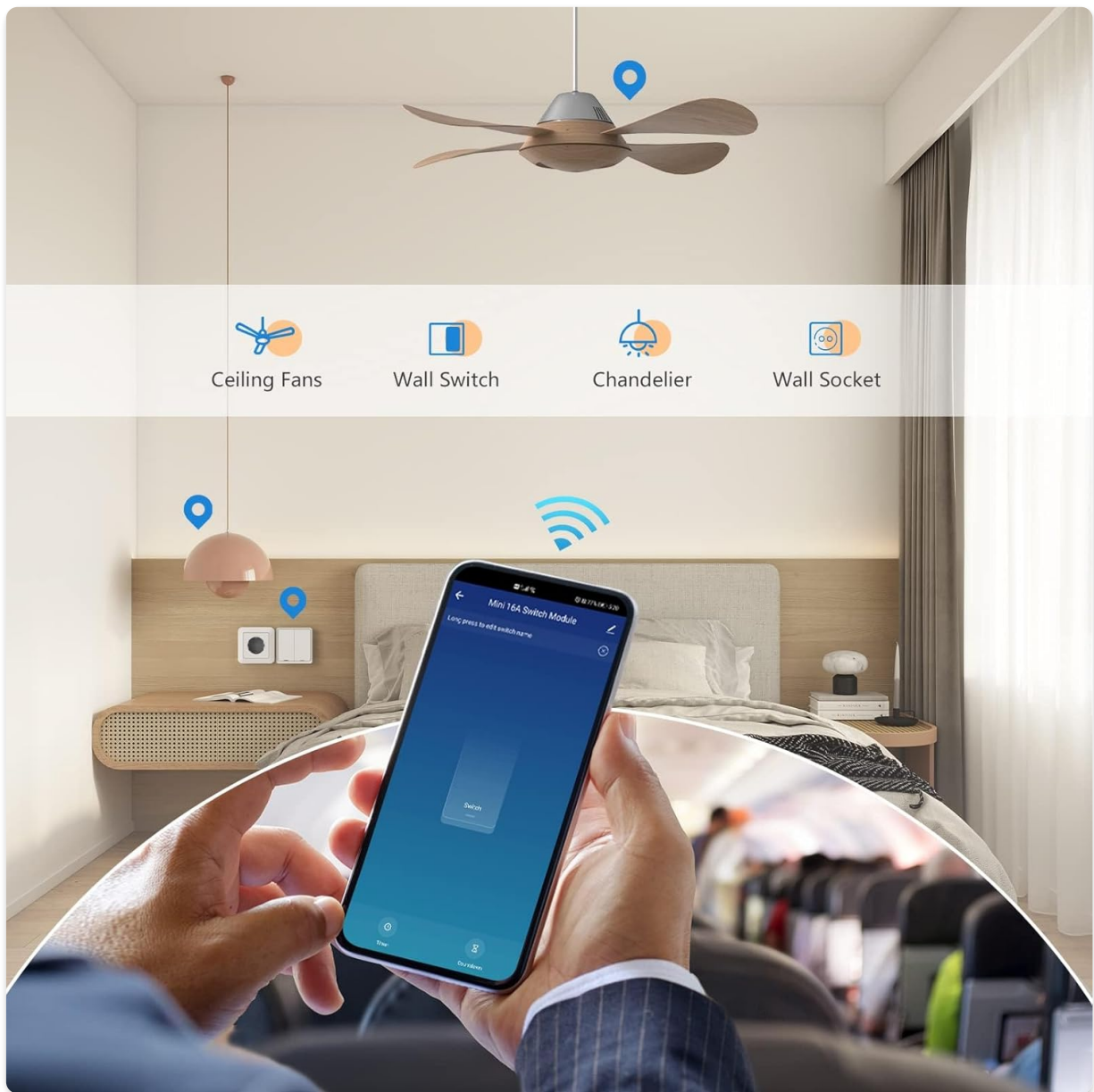

Image 5.1: A user controlling a ceiling fan and other lights in a bedroom using the Maxcio app on a smartphone, demonstrating remote control capabilities.

## 5.2. Voice Control (Alexa & Google Home)

To enable voice control, you need to link your Maxcio account with Amazon Alexa or Google Home:

1. Open the Amazon Alexa app or Google Home app.
2. Navigate to the "Skills & Games" (Alexa) or "Works with Google" (Google Home) section.
3. Search for the "Maxcio" skill/service and enable it.
4. Link your Maxcio account by entering your Maxcio app credentials.
5. Discover devices. Once discovered, you can use voice commands such as:
  - "Alexa, turn on [Device Name]."
  - "Hey Google, turn off [Device Name]."

# Hands-free Voice Control

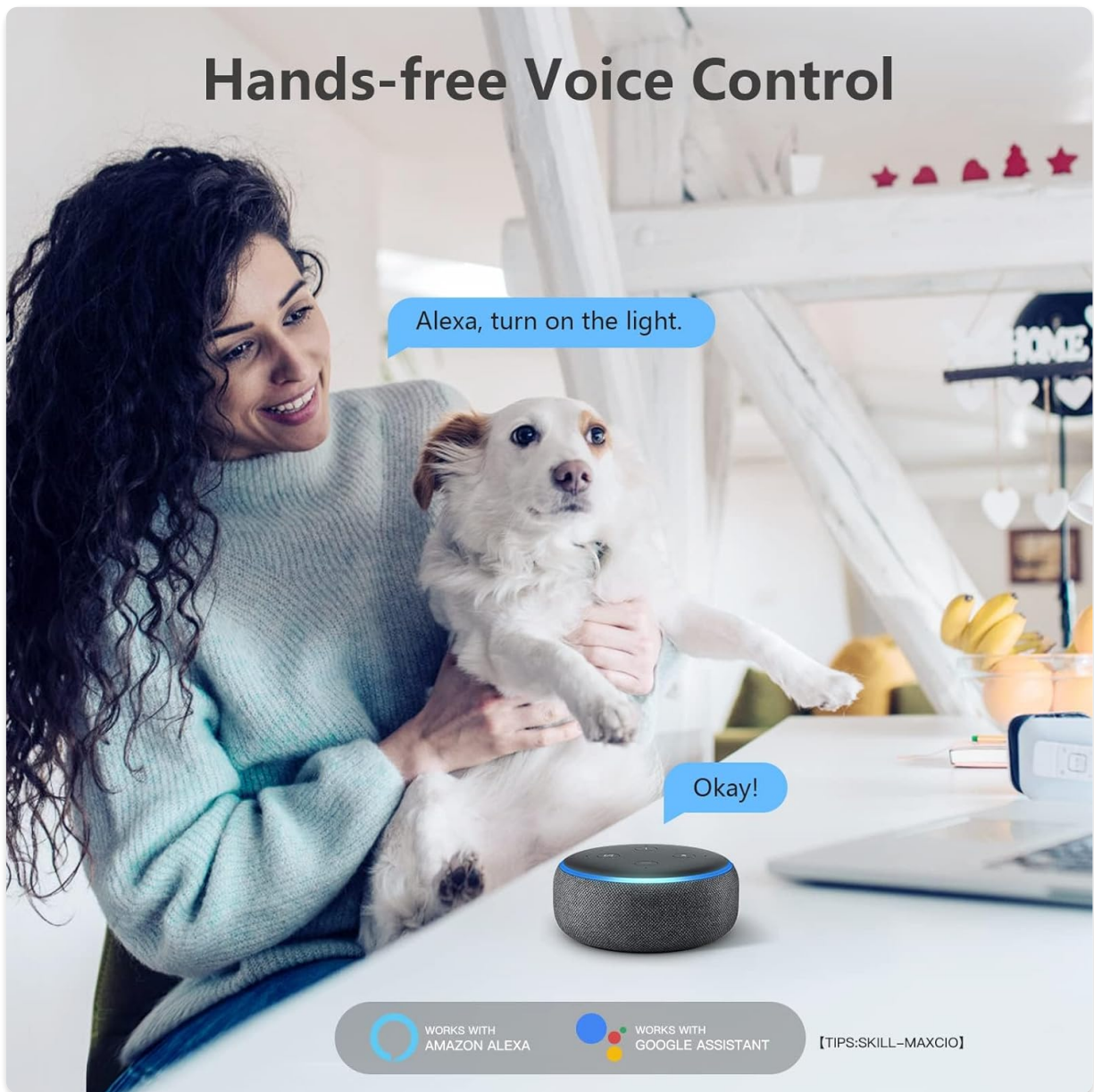

Image 5.2: A woman interacting with an Amazon Echo device, demonstrating hands-free voice control to turn on a light, enabled by the Maxcio Smart Switch.

## 5.3. Timer and Schedule

Automate your devices by setting up timers and schedules:

1. In the Maxcio app, select your smart switch.
2. Go to the "Timer" or "Schedule" section.
3. Set specific times for the device to turn ON or OFF, or create a countdown timer.
4. You can also set recurring schedules for daily or weekly automation.

## Timer & Schedule



Image 5.3: Visual representation of the timer and schedule functions, showing a light scheduled to turn on at 19:00 and a countdown timer set for 10 minutes to turn off, illustrating automated control for convenience.

### 5.4. Group Control

Control multiple Maxcio smart switches simultaneously by creating groups:

1. In the Maxcio app, go to the main device list.
2. Look for an option to create a "Group" or "Scene."
3. Select the smart switches you wish to include in the group.
4. Name your group (e.g., "Living Room Lights").
5. Now you can control all devices in that group with a single tap or voice command.

# Group Control



Image 5.4: An overhead view of a smart home layout, illustrating how multiple Maxcio Smart Switches can be grouped and controlled together via the app, with icons indicating various smart appliances in different rooms.

## 5.5. Device Sharing

Share control of your smart switch with family members:

1. In the Maxcio app, select the smart switch you want to share.
2. Go to the device settings (usually represented by a gear icon).
3. Look for a "Share Device" or "Add Member" option.
4. Enter the Maxcio account details (e.g., email address) of the person you wish to share with.
5. The invited user will receive a notification and can accept to gain control.

## 6. MAINTENANCE

The Maxcio Mini WiFi Smart Switch requires minimal maintenance:

- Keep the device clean and free from dust. Use a dry, soft cloth for cleaning.
- Ensure the device is not exposed to excessive moisture or extreme temperatures.

- Regularly check for firmware updates within the Maxcio app to ensure optimal performance and security.

## 7. TROUBLESHOOTING

If you encounter issues with your Maxcio Mini WiFi Smart Switch, refer to the following common solutions:

Problem	Possible Cause	Solution
Device cannot connect to WiFi / App cannot find device.	Incorrect WiFi band (5GHz), weak WiFi signal, incorrect pairing mode.	<ul style="list-style-type: none"> <li>◦ Ensure your router is broadcasting a 2.4GHz WiFi signal and your phone is connected to it.</li> <li>◦ Move the device closer to the WiFi router.</li> <li>◦ Reset the device to pairing mode (indicator light blinking rapidly) and try pairing again.</li> <li>◦ Check your WiFi password for accuracy.</li> </ul>
Voice control not working.	Maxcio skill not enabled, device not discovered, incorrect device name.	<ul style="list-style-type: none"> <li>◦ Ensure the "Maxcio" skill is enabled and linked in your Alexa/Google Home app.</li> <li>◦ Ask Alexa/Google to "Discover devices."</li> <li>◦ Use the exact device name configured in the Maxcio app.</li> </ul>
Device loses connection frequently.	Weak WiFi signal, interference.	<ul style="list-style-type: none"> <li>◦ Improve WiFi signal strength by moving the router or using a WiFi extender.</li> <li>◦ Ensure the device is not installed near strong signal interference sources (e.g., microwaves, large metal objects).</li> </ul>
Switch does not respond to app or manual control.	No power, incorrect wiring, device malfunction.	<ul style="list-style-type: none"> <li>◦ Check if the main power supply is ON.</li> <li>◦ Verify wiring according to the diagram (consult a qualified electrician if unsure).</li> <li>◦ If the issue persists, contact customer support.</li> </ul>

## 8. SPECIFICATIONS

Specification	Value
Model Number	QS-WIFI-S06-16A
Dimensions (L x W x H)	40 x 20 x 40 mm (4 x 2 x 4 cm)
Weight	40 grams

Specification	Value
Operating Voltage	240 Volts
Current	16A
Maximum Load	3680W
WiFi Standard	IEEE 802.11 b/g/n 2.4GHz (5GHz not supported)
Material	Acrylonitrile Butadiene Styrene
Operating Mode	ON-NONE-OFF
Contact Type	Normally Open
Connector Type	Screw Terminal
Circuit Type	2-way



## Maxcio **VS** Other

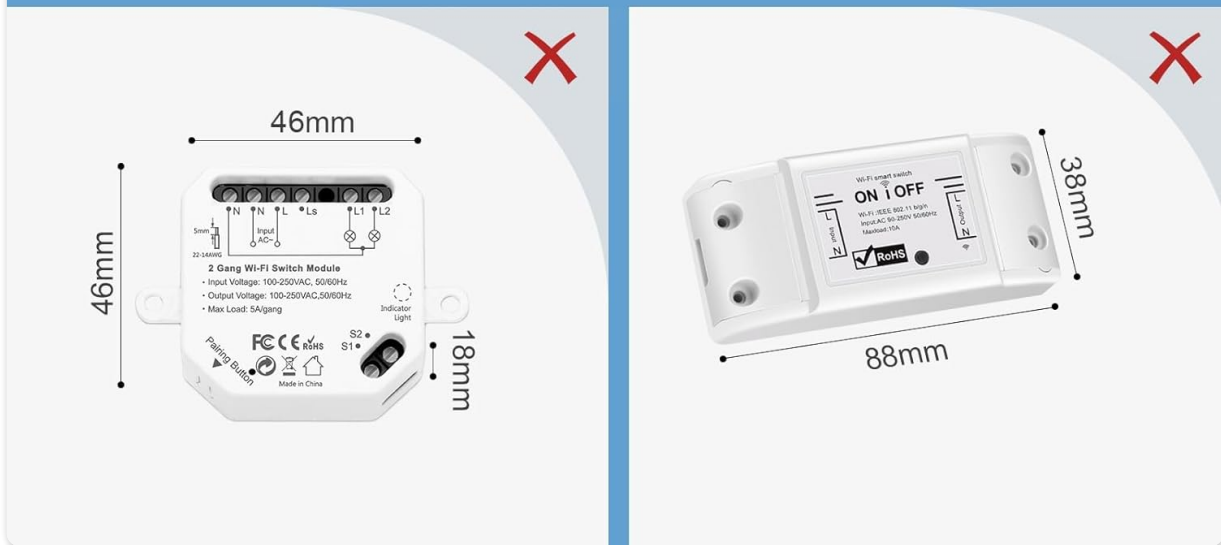

Image 8.1: A size comparison illustrating the compact dimensions of the Maxcio Mini WiFi Smart Switch (40x40x20mm) against other larger smart switch modules, highlighting its 'Super Mini' feature.

## 9. WARRANTY AND SUPPORT

---

Maxcio products are designed for reliability and performance. For warranty information, please refer to the documentation included with your product packaging or the official Maxcio website.

If you encounter any problems or require assistance, please do not hesitate to contact Maxcio customer support. The email address for customer service can typically be found on the product packaging. We are committed to providing prompt assistance and will endeavor to respond as quickly as possible.