

## Essebagno 9017619

# Essebagno Indus Black Shower Faucet

Model: 9017619

Brand: Essebagno

## 1. INTRODUCTION

This manual provides essential instructions for the safe installation, operation, and maintenance of your Essebagno Indus Black Shower Faucet, Model 9017619. Please read this manual thoroughly before installation and retain it for future reference.

## 2. SAFETY INFORMATION

- Always turn off the main water supply before attempting any installation or maintenance.
- Ensure all connections are secure to prevent leaks.
- If you are unsure about any part of the installation process, consult a qualified plumber.
- Avoid using excessive force when tightening components to prevent damage.
- Do not use abrasive cleaners or scouring pads, as these can damage the finish.

## 3. PACKAGE CONTENTS

Verify that all components are present before beginning installation:

- Essebagno Indus Black Shower Faucet Body
- Rosettes (2 included)
- Mounting hardware
- Instruction Manual (this document)



Figure 3.1: Essebagno Indus Black Shower Faucet, showing the main body and control knob.

#### 4. SPECIFICATIONS

Feature	Detail
Model Number	9017619
Dimensions	26.9 x 6.8 x 5.9 cm
Weight	1.2 kg
Material	Brass (body)
Finish	Painted (Black)
Installation Method	Wall-mounted, Single Hole (for mixing unit)
Number of Holes (for connections)	2
Number of Handles	1
Special Features	Water-saving system
Boiler Compatibility	Suitable for all types of boilers



Figure 4.1: Technical drawing with key dimensions for installation. Note the 150mm center-to-center distance for water inlets.

## 5. INSTALLATION INSTRUCTIONS

### 5.1. Pre-Installation

- **Flush Pipes:** Before assembly, thoroughly flush the hot and cold water supply pipes. This prevents dirt and debris from entering and affecting the faucet's operation.
- **Turn Off Water Supply:** Locate and turn off the main water supply to your bathroom.
- **Remove Old Faucet:** Carefully dismantle and remove any existing shower faucet.
- **Clean Threads:** Clean the threads of the main water supply pipes where the new faucet will connect.

### 5.2. Installation Steps

1. Ensure the wall connections are spaced 150mm apart (standard for shower faucets). Refer to Figure 4.1 for precise measurements.
2. Apply plumber's tape to the threaded ends of the eccentric connectors (not explicitly listed but standard for wall mounts) and screw them into the wall water outlets. Adjust them until they are level and the correct distance apart.
3. Place the rosettes over the eccentric connectors, flush against the wall.
4. Attach the shower faucet body to the eccentric connectors. Hand-tighten first, then use a wrench to secure, being careful not to overtighten.
5. Ensure the faucet is level and firmly mounted.
6. Turn the main water supply back on and check for any leaks.

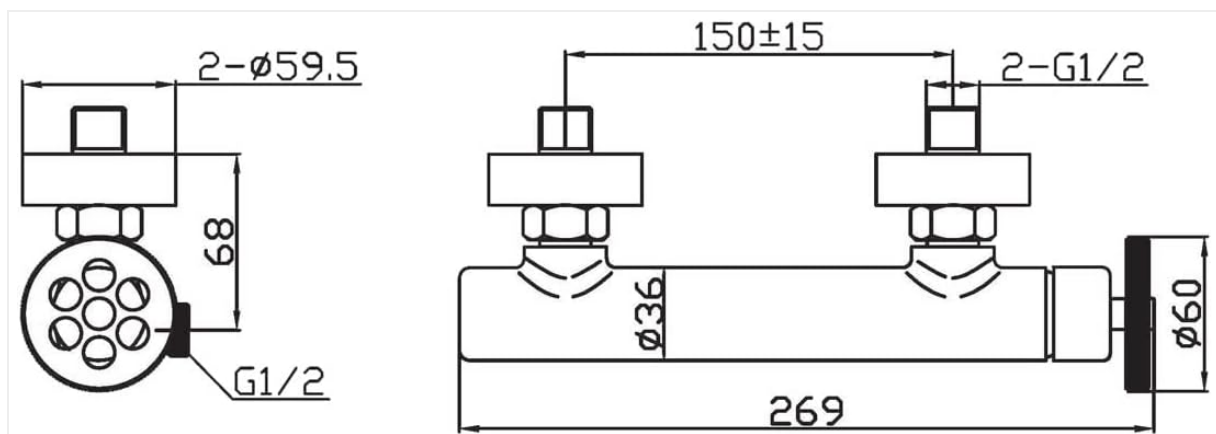

Figure 5.1: Essebagno Indus Black Shower Faucet after successful installation, shown with a compatible shower hose and head (sold separately).

## 6. OPERATING INSTRUCTIONS

The Essebagno Indus Black Shower Faucet features a single handle for controlling both water flow and temperature:

- **Water Flow:** Lift the handle upwards to increase water flow. Push it downwards to decrease or stop the flow.
- **Temperature Control:** Rotate the handle to the left for hot water and to the right for cold water. Adjust gradually to achieve your desired temperature.

## 7. MAINTENANCE

Proper maintenance will ensure the longevity and appearance of your Essebagno shower faucet:

- **Regular Cleaning:** To keep the faucet clean and shiny, wipe it immediately after each use with a soft microfiber cloth. This helps prevent water spots and soap scum buildup.
- **Limescale Prevention:** For areas with hard water, use a mild descaler specifically designed for bathroom fixtures. Apply it with a microfiber cloth and rinse thoroughly.
- **Avoid Abrasives:** Do not use abrasive cleaners, scouring pads, or harsh chemicals (e.g., ammonia-based cleaners, bleach) as these can damage the black finish and internal components.
- **Check for Leaks:** Periodically inspect connections for any signs of leaks and tighten if necessary.

## 8. TROUBLESHOOTING

If you encounter issues with your Essebagno shower faucet, refer to the following common problems and solutions:





Problem	Possible Cause	Solution
Low Water Flow	Clogged aerator or debris in pipes.	Clean the aerator. Ensure pipes were flushed during installation. Check main water pressure.
Water Leaks from Connections	Loose connections or worn seals.	Turn off water supply, tighten connections. Replace seals if necessary.
Difficulty Adjusting Temperature	Cartridge issue or water heater setting.	Consult a plumber to inspect or replace the cartridge. Check your water heater settings.

If the problem persists after attempting these solutions, please contact customer support.

## 9. WARRANTY AND SUPPORT

Essebagno products are manufactured to high-quality standards. For information regarding warranty coverage and to access customer support, please refer to the warranty card included with your purchase or visit the official Essebagno website. When contacting support, please have your model number (9017619) and purchase date available.

## Related Documents - 9017619

	<p><a href="#">EsseBagno ESSEGUN THERMO Shower System Installation Guide</a></p> <p>Detailed installation guide for the EsseBagno ESSEGUN THERMO thermostatic shower system, including component identification and mounting instructions.</p>
	<p><a href="#">EsseBagno Shower Panel Installation Guide - Model H353</a></p> <p>Comprehensive installation guide for the EsseBagno H353 shower panel. Learn how to mount, connect, and use your new bathroom fixture with clear instructions and component lists.</p>
	<p><a href="#">EsseBagno Deco Gun Metal Washbasin Mixer Tap Technical Specifications</a></p> <p>Technical specifications and dimensions for the EsseBagno Deco Gun Metal washbasin mixer tap, featuring key measurements like base diameter, spout reach, and overall height.</p>
	<p><a href="#">Colonnes de Douche Thermostatique NEW ONEO COL THERMO NOIRE - EsseBagno</a></p> <p>Découvrez la colonne de douche thermostatique NEW ONEO COL THERMO NOIRE d'EsseBagno (Code 3661109013710). Caractéristiques : tube extensible, pommeau 25cm inox, douchette 3 jets, mitigeur thermostatique avec sécurité 38°C. Idéal pour votre salle de bain.</p>
	<p><a href="#">EsseBagno ESSEGUN THERMO Shower System Installation Guide</a></p> <p>Detailed installation guide for the EsseBagno ESSEGUN THERMO thermostatic shower system, including component identification and mounting instructions.</p>
	<p><a href="#">EsseBagno Shower Panel Installation Guide - Model H353</a></p> <p>Comprehensive installation guide for the EsseBagno H353 shower panel. Learn how to mount, connect, and use your new bathroom fixture with clear instructions and component lists.</p>