

[Manuals.plus](#) /

> [Yaheetech](#) /

> Yaheetech Foldable Pet Pool 160 x 30cm Instruction Manual

Yaheetech 592776

Yaheetech Foldable Pet Pool Instruction Manual

Model: 592776 | Brand: Yaheetech

1. INTRODUCTION

Thank you for choosing the Yaheetech Foldable Pet Pool. This portable and durable pool is designed to provide a fun and refreshing experience for your pets. Its foldable design allows for easy setup, storage, and transport. This manual provides essential information for the safe and effective use of your pet pool.



The Yaheetech foldable pet pool, 160cm diameter and 30cm height, in grey, ready for use.

2. SAFETY INFORMATION

- Always use the product on a smooth, flat surface to ensure stability.
- Before use, trim your pet's nails to prevent damage to the pool material.
- Never leave pets unattended in or near the pool.
- Ensure the pool is filled to at least 60% capacity to maintain structural integrity and prevent collapse.

3. PRODUCT COMPONENTS AND FEATURES

The Yaheetech Foldable Pet Pool is constructed with durable materials and designed for pet safety and

convenience.

- **Material:** Thick polyester fabric with reinforced PVC lining.
- **Frame:** 5 mm thick PP (Polypropylene) panels for enhanced stability.
- **Bottom:** Anti-slip texture to prevent pets from sliding.
- **Drainage:** Spiral drainage button for quick and efficient water emptying.
- **Portability:** Foldable design for easy storage and transport.
- **Included:** Pet pool, repair patches.



Detailed view of the pool's robust, multi-layered material construction.

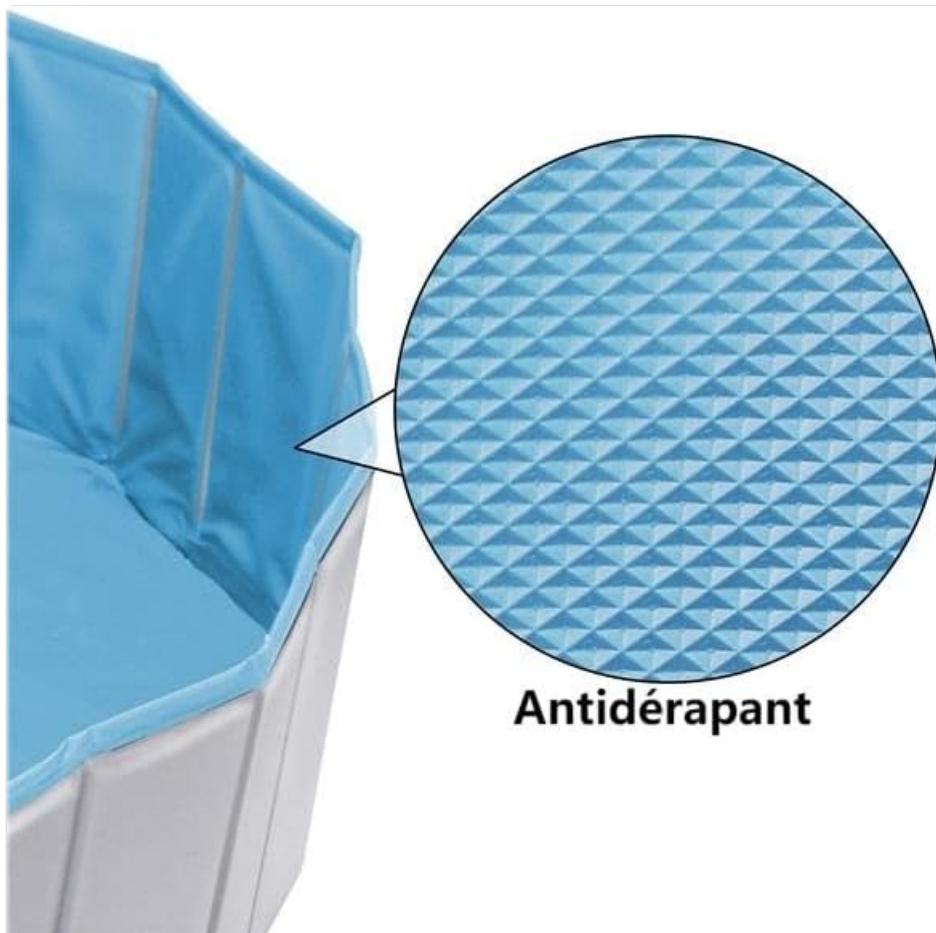

The anti-slip texture on the pool's bottom ensures pet safety.

4. SETUP INSTRUCTIONS

1. **Choose a Location:** Select a smooth, flat, and stable surface for the pool. Ensure there are no sharp objects underneath that could puncture the material.
2. **Unfold the Pool:** Carefully unfold the pool from its compact state. The rigid PP panels will form the circular shape.
3. **Fill with Water:** Begin filling the pool with water. It is recommended to fill the pool to at least 60% and up to 80% of its capacity to provide sufficient tension for stability and prevent the sides from collapsing.
4. **Supervise:** Always supervise your pets while they are using the pool.



Two dogs enjoying the pool in a backyard setting.

Note:

Il est recommandé d'avoir au moins 60 % d'eau pleine de la piscine pour fournir une tension suffisante pour soutenir la piscine.



Recommended water fill levels for optimal pool stability.

5. OPERATING INSTRUCTIONS

- Ensure your pet's nails are trimmed to prevent accidental damage to the pool liner.
- Introduce your pet to the pool gradually.
- Always supervise your pet during playtime in the pool.
- The pool can also be used as a sandbox or ball pit for versatile play.



The versatile pet pool can be used for water play, as a sandbox, or a ball pit.

6. MAINTENANCE

1. **Draining:** To drain the water, simply open the spiral drainage button located on the side of the pool.
2. **Cleaning:** After each use, empty the pool and clean it thoroughly with mild soap and water. Rinse completely and allow to dry.
3. **Repairs:** In case of minor punctures, use the provided repair patches according to their instructions.

7. STORAGE

Proper storage ensures the longevity of your pet pool.

1. **Dry Completely:** Ensure the pool is completely dry before folding to prevent mold or mildew.
2. **Fold:** The pool can be folded in two main ways for compact storage. Refer to the diagrams below.
3. **Store:** Store the folded pool in a cool, dry place away from direct sunlight and extreme temperatures.

Rangement Pliant

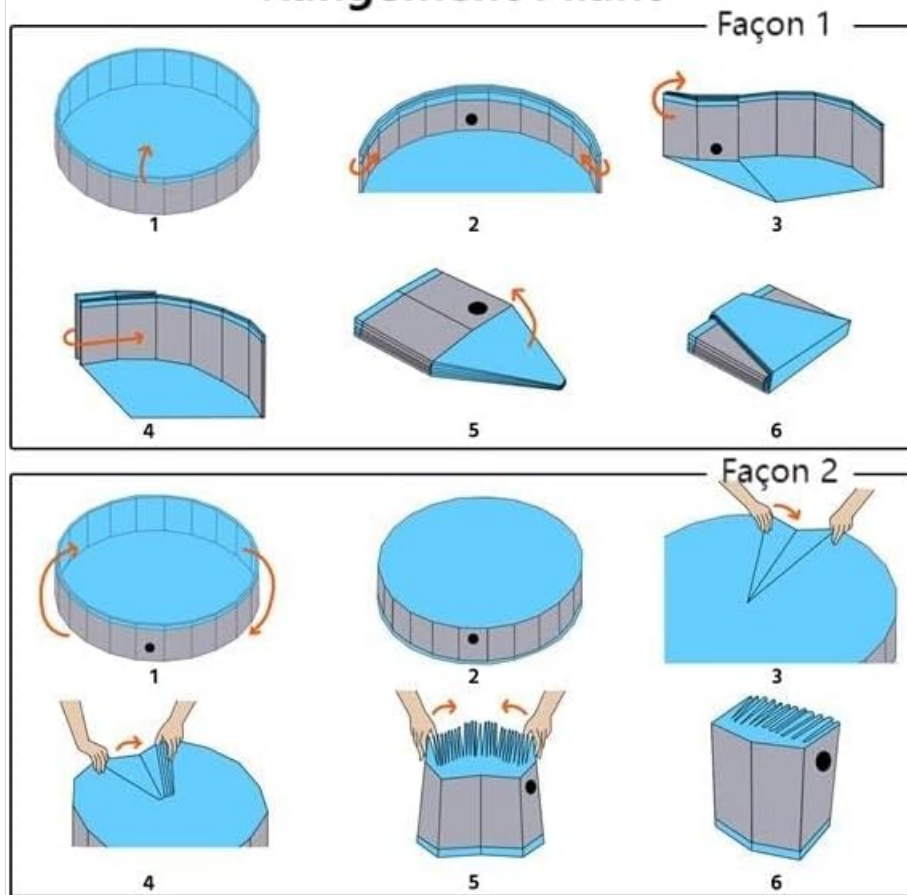

Two methods for folding the pet pool for efficient storage.

8. TROUBLESHOOTING

- **Pool sides collapsing:** Ensure the pool is placed on a perfectly flat and smooth surface. Verify that the pool is filled to at least 60% of its capacity. Insufficient water can lead to instability.
- **Water leakage:** Check the drainage plug to ensure it is securely sealed. Inspect the pool liner for any punctures and use the provided repair patches if necessary.

9. SPECIFICATIONS

Feature	Detail
Brand	Yaheetech
Model Number	592776
Color	Gris (Grey)
Shape	Ronde (Round)
Material	Polychlorure de vinyle (PVC), Polypropylène (PP)
Special Features	Antidérapante (Anti-slip), Pliable (Foldable)
Assembly Time	2 Minutes
Target Audience	Chiens (Dogs)

Item Weight

7.3 Kilograms

Amélioration de la stabilité



Anti-effondrement et dommages

Dimensions of the 160 x 30 cm pet pool.



Size guide for different pet pool models and suitable dog sizes.

10. WARRANTY

This product comes with a 2-year manufacturer's warranty.

11. SUPPORT

For further assistance, product information, or to explore other Yaheetech products, please visit the official Yaheetech store.

[Visit the Yaheetech Store](#)