

[Manuals.plus](#) /

> [Hibbent](#) /

> Hibbent Large 3-Inch Toilet Flapper Replacement for TOTO G-Max, THU138S, THU175S, THU331S - Instruction Manual

## Hibbent 1P-TOflapper3in-2hole-Red

# Hibbent Large 3-Inch Toilet Flapper Replacement for TOTO G-Max, THU138S, THU175S, THU331S - Instruction Manual

## PRODUCT OVERVIEW

The Hibbent Large 3-Inch Toilet Flapper is designed as a replacement for specific TOTO toilet models. It features an oversized sealing surface to ensure compatibility with large 3-inch TOTO flush valves. Constructed from high-quality TPR material, this flapper offers a tight seal, long-lasting durability, and resistance to chlorine, city water treatment, hard water, and well water. The package includes the 3-inch flapper and a stainless steel chain with a clip hook for easy installation.

## COMPATIBILITY

This Hibbent toilet flapper is compatible with the following TOTO Flapper Models and Toilet Models:

- TOTO Flapper Models: G-Max, THU499S, THU175S, THU331S, THU138S, 2021BP.
- TOTO Toilet Models: ST743S, ST744S, ST754SF, ST764S, ST774S, ST784SF, ST94SF, ST814S, CST756204SF, SCT853S, CST845S, CST874S.

**Note: This toilet flapper is not compatible with TOTO models ST743E, ST744E, ST754E, ST784E, ST794E, CST853, CST853E, CST854, and CST854E.**



Image: TOTO 3-inch toilet flapper replacement showing compatibility with various TOTO models.

## KEY FEATURES

- **3-Inch Flush Valve Fit:** Designed for TOTO 3-inch oversized flush valves, ensuring a proper fit.
- **High-Quality Material:** Made from flexible siliconized red rubber for a tight, long-lasting seal.
- **Durable & Resistant:** Resists chlorine, city water treatment, hard water, and well water, extending product life.

- **Easy Installation:** No special tools are required for replacement.
- **Complete Kit:** Includes the 3-inch flapper and a stainless steel chain with a clip hook.



Image: A collage highlighting the premium quality, stainless steel chain, corrosion-resistant material, best sealing, and long-lasting rubber of the Hibbent toilet flapper.

## INSTALLATION INSTRUCTIONS

Follow these steps to replace your toilet flapper:

1. **Turn off Water Supply:** Locate the water supply valve behind or near your toilet and turn it clockwise to shut off the water.
2. **Flush Toilet:** Flush the toilet to drain the water from the tank. Hold the flush lever down until the tank is empty.
3. **Remove Old Flapper:** Disconnect the old flapper's chain from the flush lever. Unhook the flapper from the overflow tube's pegs.
4. **Install New Flapper:** Hook the new Hibbent flapper onto the pegs of the overflow tube. Ensure it is securely seated.
5. **Connect Flapper Chain:** Attach the stainless steel chain to the flush lever. Adjust the chain length to

have minimal slack when the flapper is closed. Too much slack can cause a weak flush, while too little can prevent a proper seal.

6. **Turn on Water Supply:** Turn the water supply valve counter-clockwise to restore water to the toilet tank.
7. **Test Flush:** Allow the tank to fill completely, then flush the toilet to ensure the new flapper seals correctly and the toilet flushes efficiently.

## Easy to Install

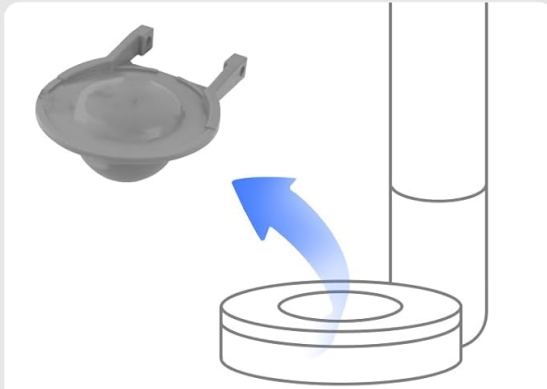

Remove the old one



Replace the new flapper



Connect the flapper chain

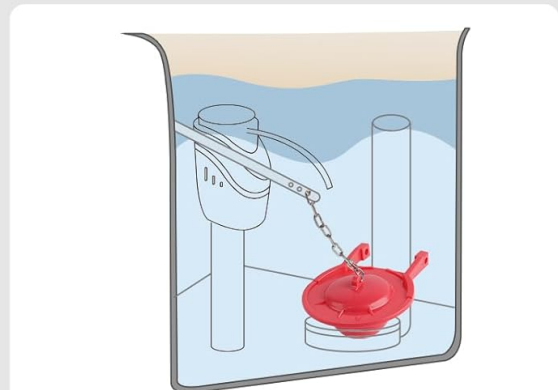

Turn on the valve and check it

Image: A visual guide demonstrating the four steps of flapper installation: removing the old flapper, replacing with the new, connecting the chain, and checking the valve.

Your browser does not support the video tag.

Video: A step-by-step guide on how to easily install the toilet flapper, demonstrating the process inside a clear toilet tank.

Your browser does not support the video tag.

Video: Installation instructions for a toilet flapper compatible with TOTO THU138S, THU175S, and THU331S models, showing the process in detail.

## MEASURING GUIDE

To ensure you have the correct flapper size, measure your toilet's flush valve:

- **Method 1:** Measure the middle part of your existing flapper. It must be  $\geq 2.8$  inches.
- **Method 2:** Measure the diameter of the toilet flush valve's opening. This flapper is designed for 3-inch diameter openings.

## Measure the size

### Method 1 :

Measure the middle part  
(must  $\geq 2.8$ " )



### Method 2 :

Measure the diameter of the  
toilet flush valve's opening



Image: Illustration showing two methods to measure the toilet flapper and flush valve opening to ensure correct sizing.

Note: It fits toilet flush valve of 3-inch in diameter



Image: A diagram illustrating that the flapper fits a toilet flush valve of 3-inch diameter.

## TROUBLESHOOTING

If your toilet is leaking, hissing, constantly running, or experiencing a double flush, it often indicates a worn or improperly seated toilet flapper. Replacing the flapper with a new Hibbent unit can resolve these common issues.

- **Continuous Running Water:** Check if the flapper is sealing completely. Ensure no debris is preventing it from closing. Adjust the chain to ensure it has minimal slack but is not too tight.
- **Weak Flush:** The chain might be too long, causing the flapper to close too quickly. Shorten the chain slightly.
- **Double Flush:** The chain might be too short, causing the flapper to reopen after initial closure. Lengthen the chain slightly.

# Fix the Leaking Toilet

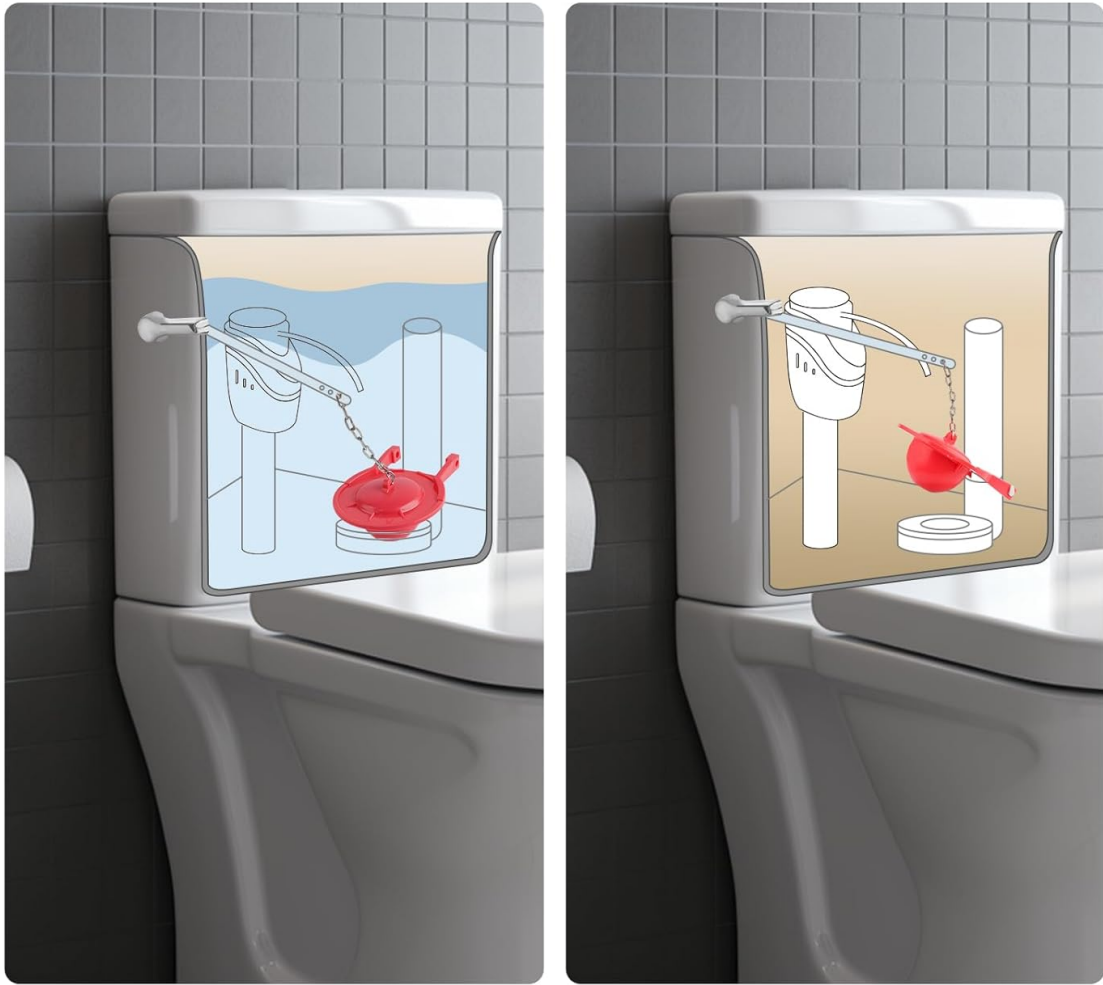

Image: A diagram showing the before and after of a toilet tank, illustrating how a new flapper fixes a leaking toilet by ensuring a proper seal.

## SPECIFICATIONS

Attribute	Detail
Manufacturer	Hibbent
Part Number	1P-TOflapper3in-2hole-Red
Product Dimensions	2.54 x 5.08 x 7.62 cm
Item Weight	110 g
Colour	Red
Included Components	Toilet Flapper
Country of Origin	China

## WARRANTY AND SUPPORT

For further assistance with your Hibbent toilet flapper installation or any product-related inquiries, please contact our support team. While specific warranty details are not provided in this manual, Hibbent is committed to providing quality products and support.

For assistance, please refer to the contact information provided by the seller or on the product packaging.