

Manuals+

[Q & A](#) | [Deep Search](#) | [Upload](#)

manuals.plus /

› [S.M.S.L](#) /

› [SMSL PL150 CD Player Instruction Manual](#)

S.M.S.L PL150

SMSL PL150 CD Player Instruction Manual

Model: PL150

INTRODUCTION

The SMSL PL150 is a high-performance CD player designed to deliver exceptional audio quality from your CD collection. Featuring a CS43198 decoding chip, versatile output options, and a robust anti-shock design, it supports both standard and mini CDs. This manual provides detailed instructions for the setup, operation, and maintenance of your PL150 CD player.

SAFETY INFORMATION

- Read all instructions carefully before operating the device.
- Do not expose the unit to water, moisture, or excessive humidity.
- Do not attempt to disassemble, repair, or modify the unit. Refer all servicing to qualified personnel.
- Use only a 5V/2A power supply with the provided USB to DC power cable. Incorrect power supplies may damage the unit.
- This product contains a Class 1 laser. Do not open the enclosure or attempt to defeat safety interlocks.
- Ensure proper ventilation around the unit to prevent overheating.

PACKAGE CONTENTS

Verify that all items are present in the package:

- SMSL PL150 CD Player
- Instruction Manual
- USB to DC Power Cable
- Remote Control (2x AA batteries not included)

What's in the Box?



PL150 CD player



Manual



USB to DC power cable



Remote Control

Image: The S.M.S.L PL150 CD Player, its manual, a USB to DC power cable, and the remote control, laid out as they would appear in the product box.

PRODUCT OVERVIEW

Front Panel

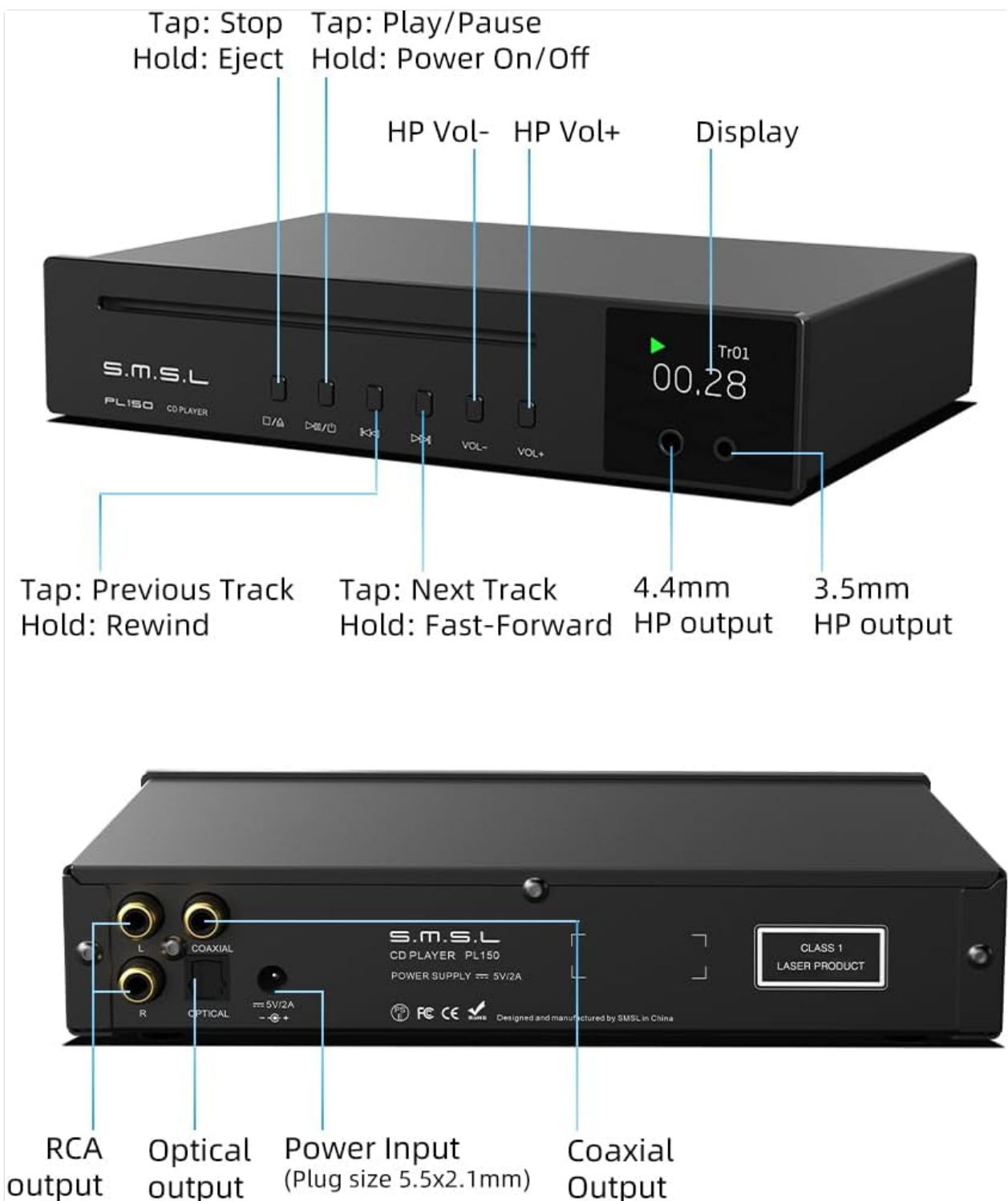

Image: A detailed diagram illustrating the front panel of the S.M.S.L PL150 CD Player, highlighting the CD slot, IPS display, control buttons (Eject/Stop, Play/Pause, Track Navigation, Volume), and dual headphone outputs (3.5mm and 4.4mm).

- **CD Slot:** For inserting standard (12cm) and mini (8cm) CDs.
- **Display:** Full-Lamination IPS display showing track information, time, and volume level.
- **Control Buttons:**
 - **Eject/Stop:** Tap to stop playback, hold to eject the CD.
 - **Play/Pause:** Tap to play or pause, hold to power on/off.
 - **Previous Track/Rewind:** Tap for previous track, hold to rewind.
 - **Next Track/Fast-Forward:** Tap for next track, hold to fast-forward.
 - **VOL-/VOL+:** Adjust headphone output volume.
- **Headphone Outputs:** 3.5mm single-ended and 4.4mm balanced headphone jacks.

Rear Panel

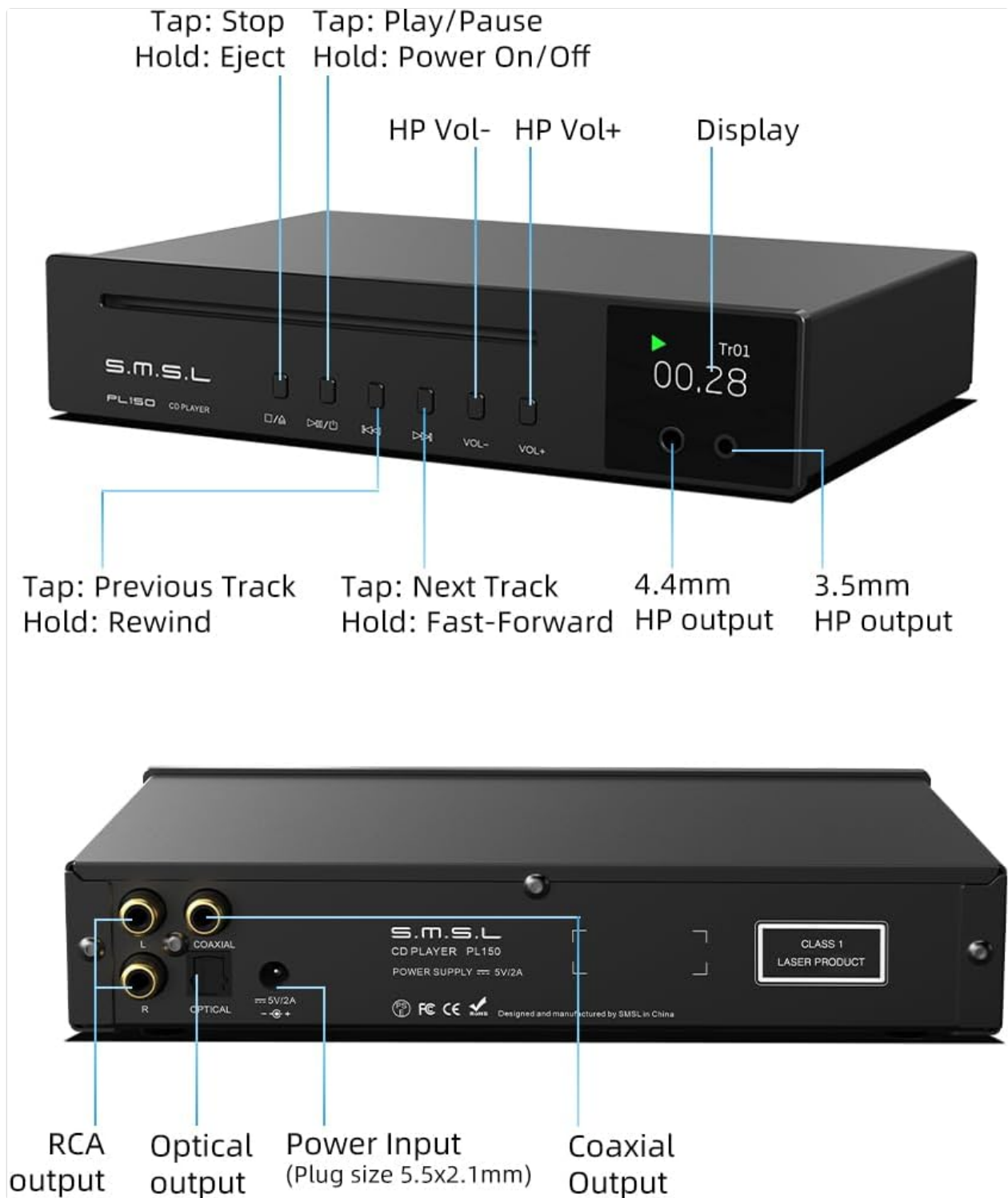

Image: A detailed diagram illustrating the rear panel of the S.M.S.L PL150 CD Player, highlighting the RCA analog outputs, Optical digital output, Coaxial digital output, and the 5V/2A power input port.

- **RCA Output (L/R):** Analog audio output for connecting to an amplifier or receiver.
- **Optical Output:** Digital audio output for connecting to an external DAC or amplifier.
- **Coaxial Output:** Digital audio output for connecting to an external DAC or amplifier.
- **Power Input (5V/2A):** Connect the provided USB to DC power cable to a compatible 5V/2A power source.

SETUP

1. Power Connection

1. Connect the provided USB to DC power cable to the **Power Input (5V/2A)** port on the rear of the PL150.
2. Connect the other end of the USB cable to a compatible 5V/2A USB power adapter (not included).

2. Audio Connections

Choose one of the following methods to connect the PL150 to your audio system:

- **RCA Analog Output:** Use RCA cables to connect the **RCA Output (L/R)** ports on the PL150 to the analog input ports of your amplifier or receiver.
- **Optical Digital Output:** Use an optical cable to connect the **Optical Output** port on the PL150 to the optical input of an external DAC or integrated amplifier.
- **Coaxial Digital Output:** Use a coaxial cable to connect the **Coaxial Output** port on the PL150 to the coaxial input of an external DAC or integrated amplifier.
- **Headphone Output:** Plug your headphones into either the **3.5mm** or **4.4mm** headphone jacks on the front panel.



Image: A visual representation of the SMSL PL150's rear panel connections, illustrating how to connect analog RCA outputs to a pure amplifier or headphone amplifier, and digital optical/coaxial outputs to an audio DAC or integrated amplifier.

3. Placement

Place the PL150 on a stable, flat surface. Ensure there is adequate space around the unit for ventilation. Avoid placing it near heat sources, direct sunlight, or in areas with high humidity.

OPERATING INSTRUCTIONS

1. Power On/Off

- To power on the unit, press and hold the **Play/Pause** button on the front panel or the **Power** button on the remote control.
- To power off the unit, press and hold the **Play/Pause** button on the front panel or the **Power** button on the remote control.

2. Loading a CD

- Gently insert a standard (12cm) or mini (8cm) CD into the CD slot on the front panel. The player will automatically draw the CD in.
- Ensure the CD is clean and free of scratches or debris.



Image: The S.M. PL150 CD Player with a CD being inserted into its slot, demonstrating compatibility with both standard 12cm and mini 8cm CDs.

3. Playback Controls

- **Play/Pause:** Tap the **Play/Pause** button on the front panel or remote to start or pause playback.
- **Stop/Eject:** Tap the **Eject/Stop** button on the front panel or remote to stop playback. Hold the button to eject the CD.
- **Next/Previous Track:** Tap the **Next** or **Previous** buttons on the front panel or remote to skip tracks.
- **Fast Forward/Rewind:** Hold the **Next** or **Previous** buttons on the front panel or remote to fast forward or rewind within a track.
- **Volume Control:** Use the **VOL-** or **VOL+** buttons on the front panel or remote to adjust the headphone output volume.

4. Remote Control Functions

The included remote control provides comprehensive control over the PL150. Ensure 2x AA batteries are installed (not included).



Image: The SMSL PL150 CD Player alongside its remote control, with detailed labels for each button's function, covering power, volume adjustment, track navigation, play/pause, stop/eject, and additional settings like sequence and shuffle.

- **Power:** Turns the unit on or off.
- **HP Vol +/-:** Adjusts headphone volume.
- **Play/Pause:** Starts or pauses playback.
- **Prev/RW:** Skips to previous track or rewinds when held.
- **Next/FF:** Skips to next track or fast-forwards when held.
- **Stop:** Stops playback.
- **Load/Eject:** Ejects the CD.
- **Menu:** Accesses menu options (if available).
- **Disp:** Changes display mode.
- **Number Pad (0-9):** Direct track selection.
- **Sequence:** Toggles playback sequence mode.
- **Shuffle:** Toggles shuffle playback mode.

MAINTENANCE

1. Cleaning the Unit

- Wipe the exterior of the PL150 with a soft, dry cloth.
- Do not use liquid cleaners, aerosols, or abrasive materials, as they may damage the finish.

2. CD Care

- Handle CDs by their edges to avoid fingerprints and scratches.
- Clean CDs with a soft, lint-free cloth, wiping from the center outwards.
- Store CDs in their cases to protect them from dust and damage.

TROUBLESHOOTING

Problem	Possible Cause	Solution
---------	----------------	----------

Problem	Possible Cause	Solution
No power	Power cable not connected; incorrect power supply.	Ensure the USB to DC power cable is securely connected. Verify the power adapter is 5V/2A.
No sound output	Incorrect audio connection; wrong input selected on amplifier/DAC; volume too low.	Check all audio cable connections. Select the correct input source on your connected amplifier or DAC. Increase volume on the PL150 and your audio system.
CD read errors or "BLOCK" message	Dirty or damaged CD; unstable power supply; internal error.	Clean the CD or try a different CD. Ensure the power supply is stable and meets 5V/2A specifications. Power cycle the unit (unplug and replug).
Remote control not working	Dead batteries; obstructed line of sight.	Replace batteries (2x AA). Ensure there is a clear line of sight between the remote and the PL150's IR receiver.
Skipping or stuttering during playback	Dirty or scratched CD; unit not on a stable surface.	Clean the CD. Place the PL150 on a stable, vibration-free surface.

SPECIFICATIONS

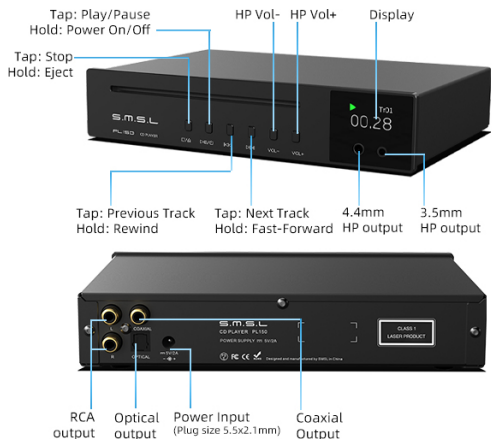

Labels for front panel: Tap: Play/Pause, Hold: Power On/Off, Tap: Stop, Hold: Eject, HP Vol-, HP Vol+, Display, Tap: Previous Track, Hold: Rewind, Tap: Next Track, Hold: Fast-Forward, 4.4mm HP output, 3.5mm HP output.

Labels for rear panel: RCA output, Optical output, Power Input (Plug size 5.5x2.1mm), Coaxial Output.

Technical Specifications: Data-Driven Truth

From **S.M.S.L**: 13 Years of Professional Audio Craftsmanship

Input.....CD
Output.....RCA/3.5mm or 4.4mm headphone/Optical/Coaxial
CD TYPE.....CD/CD-R/CD-RW/MP3 CD
CD SIZE.....8cm/12cm
Headphone output power.....60mW x2 @32Ω
THD+N.....0.001%
SNR.....110dB
Power consumption.....4W
Standby power.....<0.1W
Size.....205x42.8x144.7mm(WxHxD)
Weight.....1.145kg/2.52lbs

Image: A table detailing the technical specifications of the S.M.S.L PL150 CD Player, including its input/output types, supported CD formats, headphone output power, distortion levels, signal-to-noise ratio, power consumption, dimensions, and weight.

Feature	Specification
Input	CD
Output	RCA / 3.5mm or 4.4mm headphone / Optical / Coaxial
CD Type	CD / CD-R / CD-RW / MP3 CD

Feature	Specification
CD Size	8cm / 12cm
Headphone Output Power	60mW x 2 @ 32Ω
THD+N	0.001%
SNR	110dB
Power Consumption	4W
Standby Power	<0.1W
Size (WxHxD)	205 x 42.8 x 144.7 mm
Weight	1.145 kg / 2.52 lbs

WARRANTY AND SUPPORT

The SMSL PL150 CD Player comes with a standard manufacturer's warranty. Please refer to the warranty card included in your package for specific terms and conditions, including warranty period and coverage details.

For technical support, troubleshooting assistance, or warranty claims, please contact S.M.S.L customer service through their official website:

<https://smsl-audio.com/>

When contacting support, please have your product model (PL150) and purchase information readily available.