

## homeasy LK860

# Homeasy 6-in-1 Electric Rechargeable Beard Trimmer

Model: LK860 | Brand: Homeasy

## INTRODUCTION

---

Thank you for choosing the Homeasy 6-in-1 Electric Rechargeable Beard Trimmer. This versatile grooming kit is designed for precision and convenience, offering multiple attachments for various grooming needs. Please read this manual thoroughly before first use to ensure safe and optimal performance of your device.

## SAFETY INSTRUCTIONS

---

Always follow recommended safety procedures when using this product. Failure to do so may result in injury or damage to the device.

- Keep the device away from water. Although the trimmer is waterproof, ensure the charging port is dry before connecting the charger.
- Ensure the device is fully charged before initial use for optimal battery life.
- Do not attempt to disassemble or repair the device yourself. Contact customer support for assistance.
- Keep out of reach of children.
- Do not use the device if it is damaged or malfunctioning.
- Use only the provided charging cable and adapter.

## PRODUCT COMPONENTS

---

Your Homeasy grooming kit includes the main trimmer unit and various interchangeable heads and guide combs to meet diverse grooming requirements.

# ALL-IN-ONE

# MULTI Grooming Kit



Image: Overview of the Homeasy 6-in-1 Multi Grooming Kit, displaying the main trimmer unit and its six interchangeable heads: Hair Clippers, Micro Shaver, Carving Head, Beard Trimmer, Nose Trimmer, and Body Hair Trimmer.

The kit typically includes:

- Main Trimmer Unit
- Hair Clipper Head
- Micro Shaver Head
- Carving Head
- Beard Trimmer Head
- Nose Trimmer Head
- Body Hair Trimmer Head
- Guide Combs (3mm, 6mm, 9mm, 12mm for full-size trimmer; 3mm for precision trimmer)
- USB Charging Cable
- Cleaning Brush
- Storage Stand



Image: The Homeasy trimmer unit placed in its storage and charging stand, surrounded by its various interchangeable heads and guide combs.

## SETUP

---

### Initial Charging

Before first use, fully charge the trimmer. Connect the USB charging cable to the trimmer and a suitable USB power source. The LED display will indicate charging status. A full charge provides up to 99 minutes of cordless operation and typically takes about 1 hour.

# USB DESIGN-PERFECT TRAVEL COMPANION



Image: The Homeasy trimmer being charged via a USB cable connected to a laptop, illustrating its portable charging capability.

## Attaching and Detaching Cutter Heads

To change the cutter head:

1. **To Remove:** Push the head upwards to un-clip it from the main body. The head will detach.
2. **To Install:** Align the brass axle of the desired head with the groove on the trimmer body. Push the head down until you hear a 'click' sound, indicating it is securely attached.

## Installing Guide Combs

To attach a guide comb:

1. Ensure the desired cutter head is installed.
2. Align the guide comb with the teeth of the cutter head.
3. Push the comb firmly onto the head until it clicks into place.

# EASY TO OPERATE

## How to remove / install the cutter head?



Push Head to Un-clip



Head Detaches From Body



Detached

## How to install the guide combs?



Align Brass Axle to  
Groove of Head



Push to Hear a Crack



Attached

Image: Step-by-step visual guide demonstrating how to correctly remove and install the various cutter heads and guide combs on the Homeeasy trimmer unit.

## OPERATING INSTRUCTIONS

### Power On/Off and Travel Lock

- **To Power On/Off:** Press the power button once.
- **To Activate/Deactivate Travel Lock:** Press and hold the power button for 3 seconds. The lock icon on the LED display will indicate the status.

### Adjusting Cutting Length

The trimmer features an adjustable comb system. For the full-size trimmer, use the 3mm, 6mm, 9mm, or 12mm guide combs. For the precision trimmer, a 3mm adjustable comb is provided. Select the desired comb and attach it securely to the trimmer head.

# MULTIPLE HAIRCUT LENGTHS MEET VARIOUS NEEDS

## FULL-SIZE TRIMMER (T-Blade)

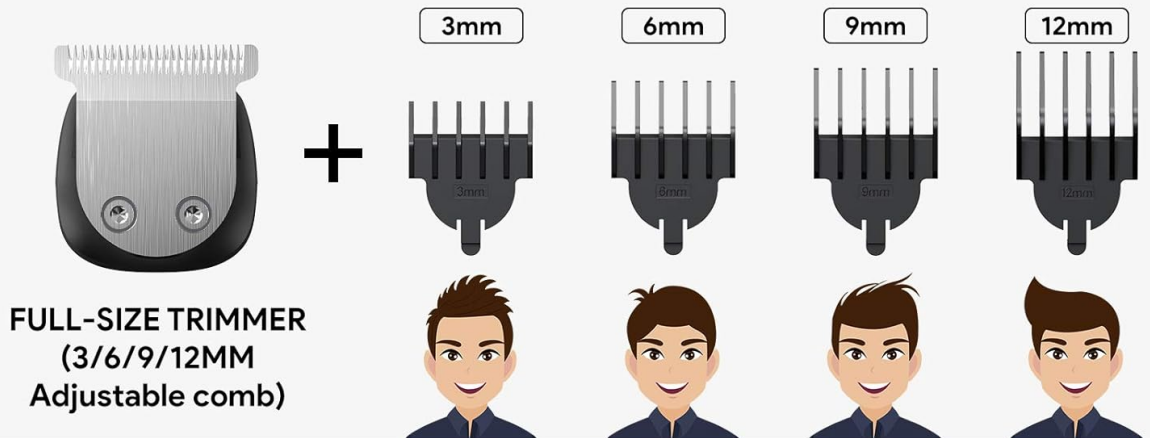

## PRECISION TRIMMER (U-Blade)

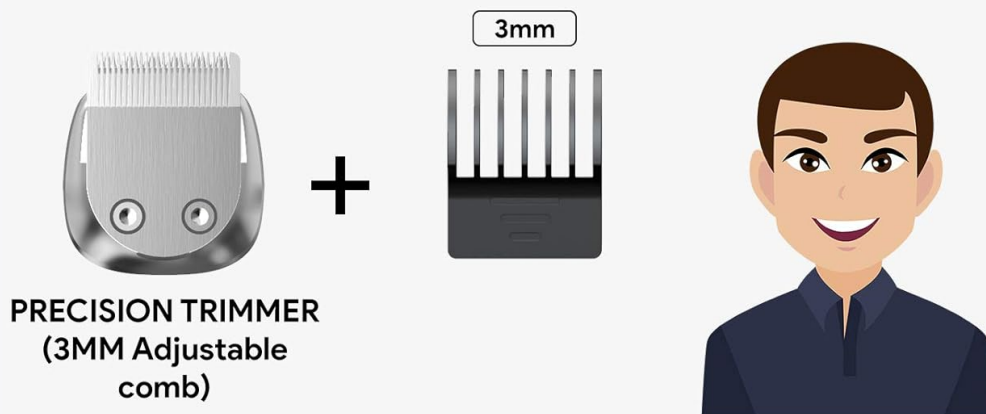

Image: A diagram illustrating the various haircut lengths achievable with the full-size (T-Blade) and precision (U-Blade) trimmers, along with their corresponding guide combs (3mm, 6mm, 9mm, 12mm).

## Using the LED Display

The large, high-definition LED display provides important information:

- **Power Display:** Shows the remaining battery percentage.
- **Charging Prompt:** A red plug icon indicates the device needs charging.
- **Lock Indicator:** A lock icon indicates the travel lock is active.
- **Refueling Tips:** An oil can icon may appear, suggesting the blades need lubrication.

# LCD DISPLAY

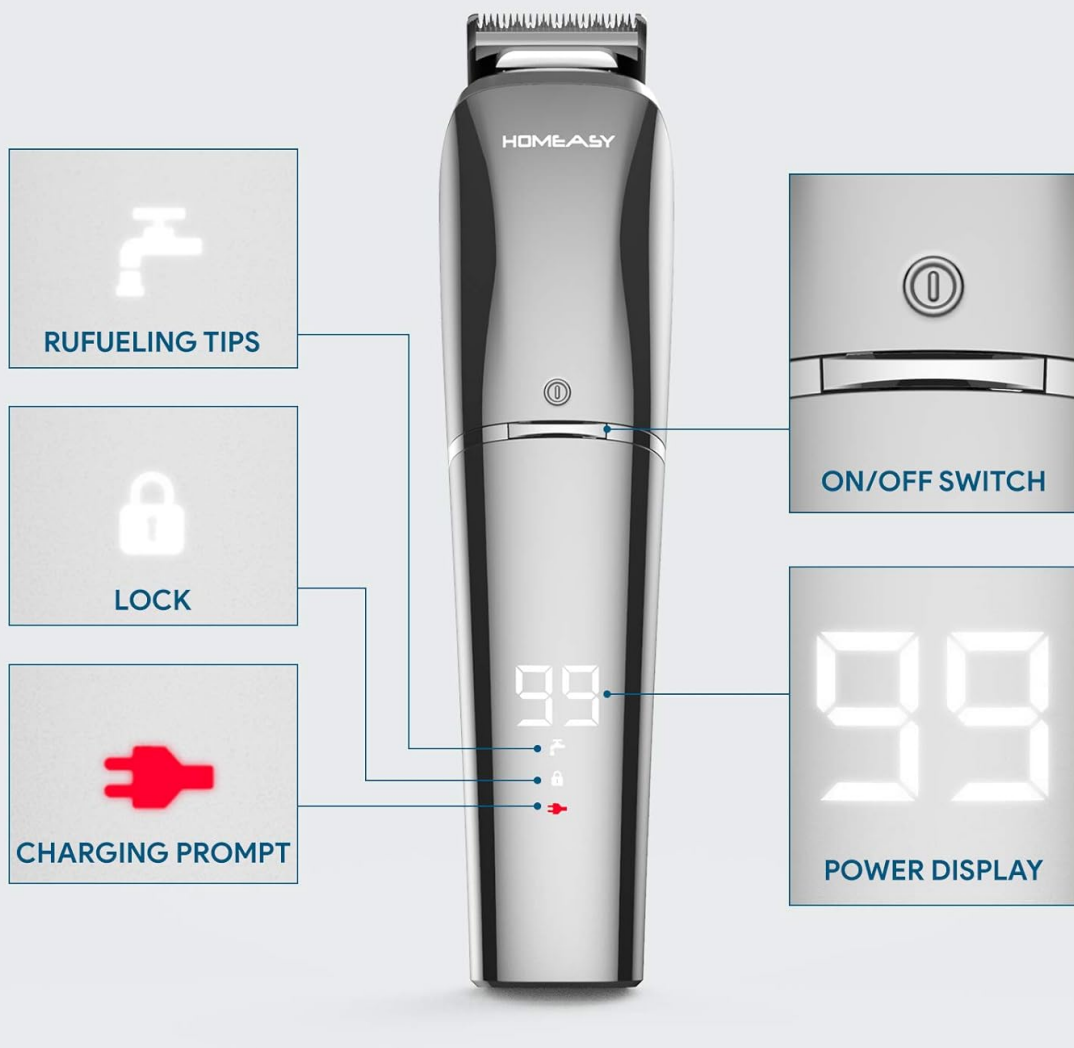

Image: A detailed view of the Homeasy trimmer's LCD display, highlighting the power percentage, charging prompt, lock indicator, and refueling tips icons.

## MAINTENANCE AND CLEANING

Regular cleaning and maintenance will ensure the longevity and optimal performance of your trimmer.

### Waterproof Design (IPX7)

The trimmer is IPX7 waterproof, meaning it can be rinsed under running water for easy cleaning. Ensure the charging port is completely dry before charging.

# 100% WATERPROOF

## Whole Body Washable



Image: A hand holding the Homeasy trimmer under running water, illustrating its IPX7 waterproof rating and ease of cleaning.

### Cleaning the Blades

- After each use, remove the cutter head and rinse it under running water.
- Use the provided cleaning brush to remove any trapped hairs from the blades and inside the trimmer unit.
- Allow all parts to air dry completely before reassembling or storing.

### Blade Lubrication

The self-sharpening stainless steel blades maintain their sharpness over time. However, for optimal performance and to reduce friction, it is recommended to apply a small drop of lubricating oil (not included, but standard clipper oil can be used) to the blades after every few uses, especially if the 'Refueling Tips' icon appears on the display.

### TROUBLESHOOTING

---

If you encounter any issues with your Homeasy trimmer, refer to the following common problems and solutions:

Problem	Possible Cause	Solution
Trimmer does not turn on.	Low battery; Travel lock active.	Charge the trimmer; Press and hold the power button for 3 seconds to deactivate travel lock.
Poor cutting performance.	Blades are dull or clogged with hair; Insufficient lubrication.	Clean the blades thoroughly; Apply lubricating oil to the blades.
Battery life is shorter than expected.	Battery not fully charged; Old battery.	Ensure the trimmer is fully charged before use; If the operating time is consistently below 10 minutes, the battery may need replacement (contact support).
Device makes unusual noise.	Blades are dry or misaligned; Foreign object.	Clean and lubricate blades; Check for any obstructions.

If the problem persists after trying these solutions, please contact Homeasy customer support.

## SPECIFICATIONS

---

- **Model Number:** LK860
- **Brand:** Homeasy
- **Power Source:** Battery Powered (Lithium-ion)
- **Material:** Stainless Steel (Blades)
- **Waterproof Rating:** IPX7 (Whole Body Washable)
- **Max Cutting Length:** 12 mm
- **Work Time:** Up to 99 minutes (after full charge)
- **Charge Time:** Approximately 1 hour
- **Special Features:** USB Fast Charging, Smart LED Display System, Self-sharpening blades, Secure-Fit Guide Combs, Travel Lock
- **Target Audience:** Men

## WARRANTY AND SUPPORT

---

For warranty information, product support, or to purchase replacement parts, please refer to the warranty card included with your product or visit the official Homeasy website. You may also contact Homeasy customer service directly for assistance with any issues not covered in this manual.