

Gaoducash S-M

Gaoducash Wireless Smart Motion Sensor S-M Instruction Manual

Model: S-M | Brand: Gaoducash

1. INTRODUCTION

This manual provides detailed instructions for the installation, operation, and maintenance of your Gaoducash Wireless Smart Motion Sensor (Model S-M). This device is designed to enhance your home security and smart automation by detecting motion and sending alerts via the Tuya Smart or Smart Life application. Please read this manual thoroughly before using the product to ensure proper function and safety.

2. PRODUCT OVERVIEW

The Gaoducash S-M is a PIR (Passive Infrared) motion detector that operates wirelessly via 2.4G Wi-Fi. It features a 110° detection angle and a range of up to 40 feet (12 meters). Key features include:

- **Wireless Connectivity:** Connects directly to 2.4G Wi-Fi networks without a separate hub.
- **Real-time Alerts:** Sends notifications to your smartphone via the Tuya Smart or Smart Life app upon motion detection or low battery.
- **Advanced Detection:** Utilizes dual-element infrared technology to minimize false alarms from small pets (under 25KG) and effectively detect crawling motion.
- **Light Intensity Compensation:** Maintains accurate detection even in strong sunlight (up to 6500 Lux anti-white light).
- **Smart Home Integration:** Compatible with other Tuya/Smart Life devices for creating automated scenarios (e.g., turning on lights when motion is detected).
- **Battery Powered:** Operates on 2 AAA batteries (not included) with an estimated battery life of up to 6 months.

2.1. Components

Enjoy your life

Linked other smart home device

Start your smart home travel,
make your home smarter!



Figure 1: Front and back view of the motion sensor with key components labeled. These include the LED indicator, forward-looking infrared light channel, downward-looking infrared light channel, battery compartment, and installing slot.

- **LED Indicator:** Provides status feedback (e.g., pairing mode, motion detection).
- **Infrared Light Channels:** Detects changes in infrared radiation caused by movement.
- **Battery Compartment:** Houses 2 AAA batteries.
- **Installing Slot:** Used for mounting the sensor to a wall or surface.
- **Connection Key:** Button inside the battery compartment for pairing.

3. SETUP INSTRUCTIONS

3.1. Battery Installation

1. Open the battery compartment cover on the back of the sensor.
2. Insert two (2) AAA batteries, ensuring correct polarity (+/-).
3. Close the battery compartment cover securely.

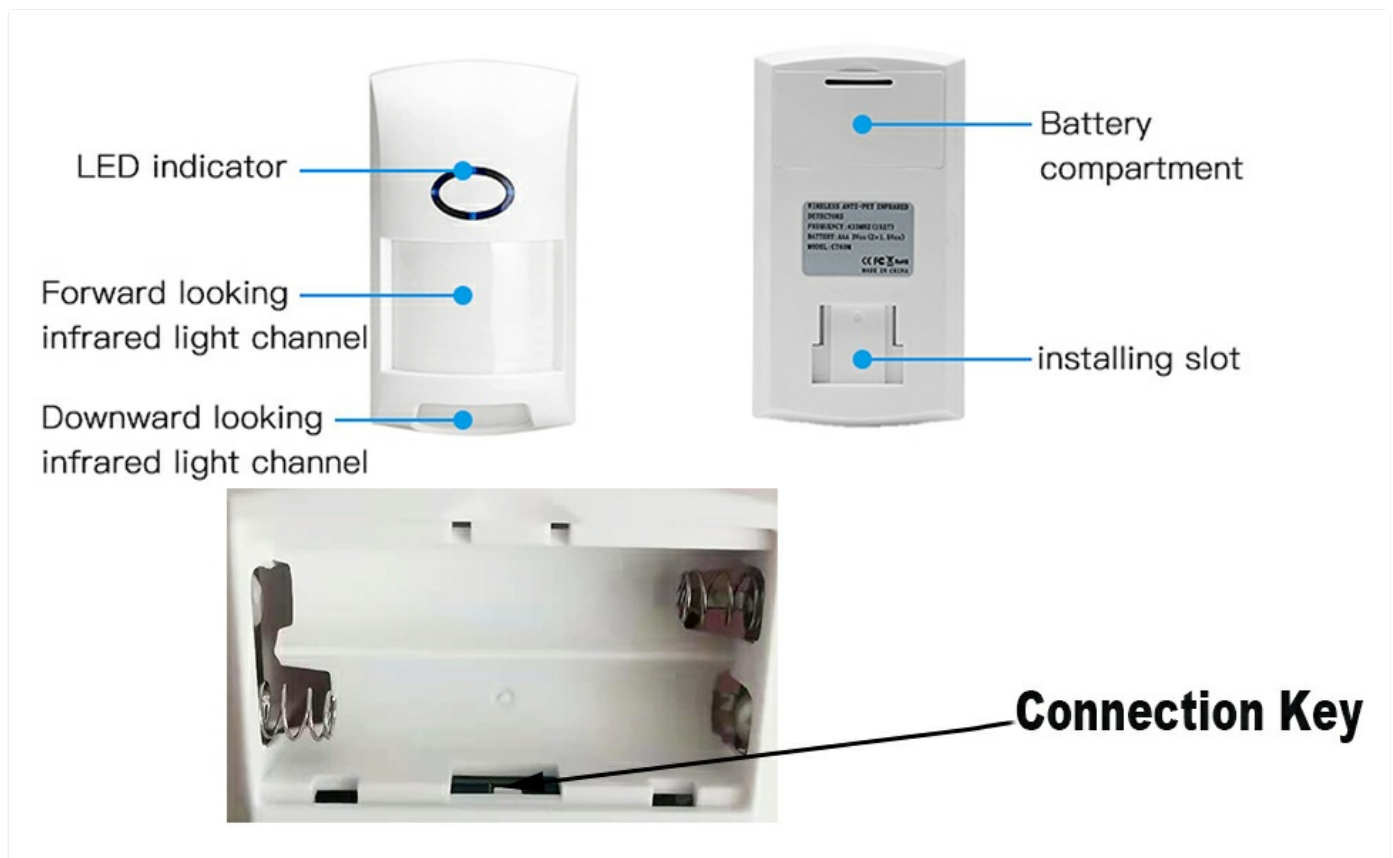

Figure 2: Illustration of battery insertion and the wall mounting process for the motion sensor.

3.2. App Installation and Device Pairing

1. Download the **Tuya Smart** or **Smart Life** app from your smartphone's app store (available on iOS and Android).
2. Register or log in to your account.
3. Ensure your smartphone is connected to a **2.4GHz Wi-Fi network**. The sensor does not support 5GHz Wi-Fi. If you have a dual-band router, ensure the 2.4GHz channel is separate or temporarily disable the 5GHz channel during pairing.
4. In the app, tap "Add Device" or the "+" icon.
5. Select "Security & Video Surveillance" then "Motion Sensor (Wi-Fi)".
6. Follow the on-screen instructions to put the sensor into pairing mode. This usually involves pressing and holding the "Connection Key" inside the battery compartment until the LED indicator blinks rapidly.
7. Confirm the LED indicator is blinking rapidly in the app and proceed with network configuration.
8. Once successfully paired, the device will appear in your app.

3.3. Mounting the Sensor

The sensor can be mounted on a wall using the provided screws. Choose a location that provides optimal detection coverage for the area you wish to monitor.

- Mount the sensor at a height of approximately 2 meters (6.5 feet) for optimal performance.
 - Avoid placing the sensor directly facing heat sources, air conditioning vents, or direct sunlight, as these can cause false alarms.
 - Ensure the detection area is clear of obstructions.
1. Fix the mounting bracket to the desired wall location using screws.
 2. Align the sensor with the bracket's installing slot and slide it down to secure it in place.

4. OPERATING INSTRUCTIONS

4.1. Motion Detection

The sensor uses passive infrared technology to detect movement by sensing changes in heat. When motion is detected within its 110° field of view and up to 40 feet range, it will trigger an alert.



Figure 3: The sensor offers a 110-degree wide detection angle, covering a significant area up to 12 meters (40 feet) in front of it.



Figure 4: The infrared anti-pet detector feature helps prevent false alarms caused by pets weighing less than 25KG.

Crawling through detection alarm

Reflecting mirror detection technology: effectively overcome the traditional shortcomings of detectors sneaking and crawling without warning



Figure 5: Advanced detection technology allows the sensor to identify crawling movements, overcoming traditional blind spots.

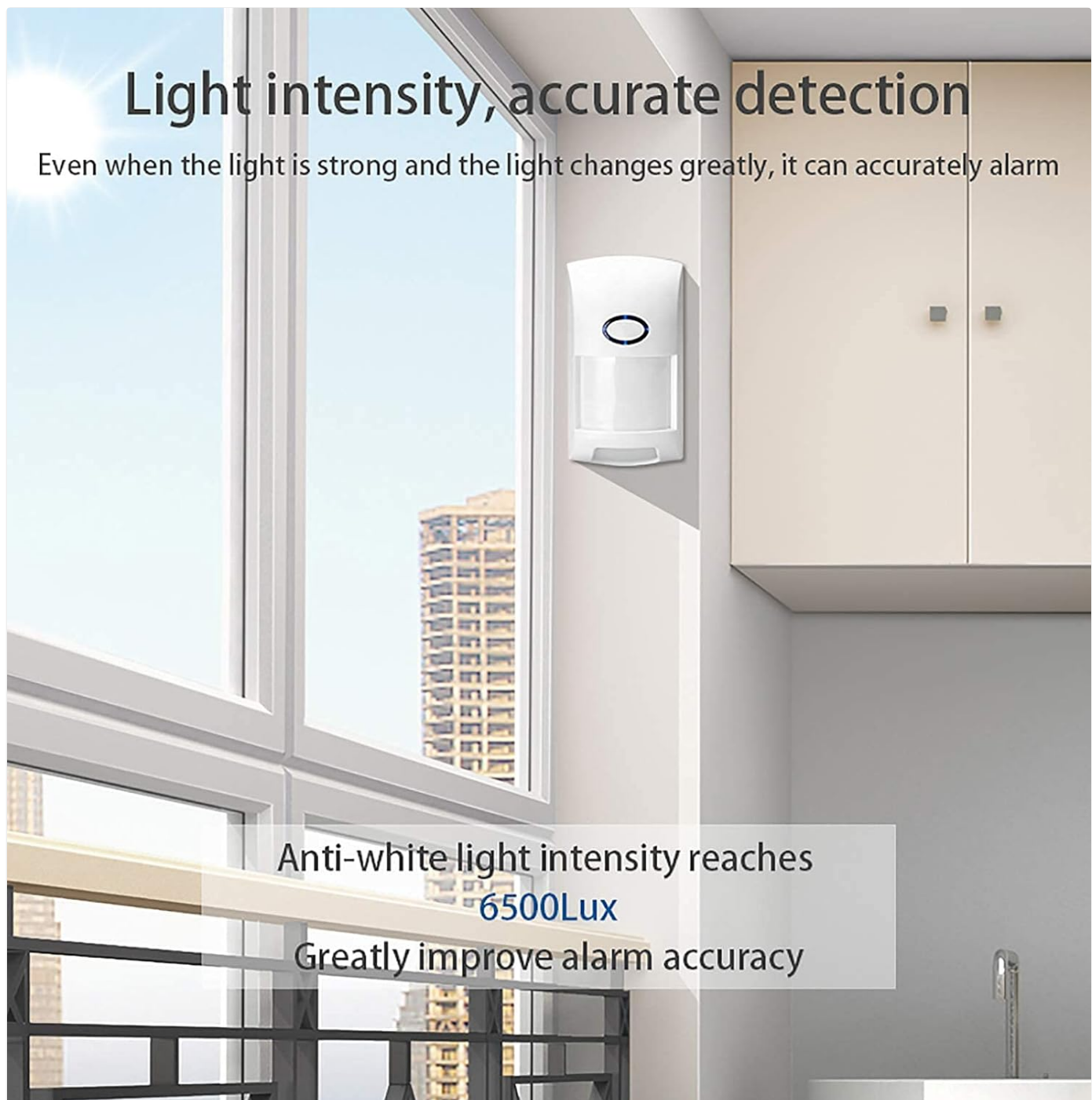

Figure 6: The sensor is designed for accurate detection even in environments with strong light intensity, up to 6500 Lux, reducing false alarms from changing light conditions.

4.2. App Functions

Through the Tuya Smart or Smart Life app, you can:

- **Receive Real-time Notifications:** Get instant alerts on your smartphone when motion is detected.
- **View Alarm History:** Access a log of all detection events for monitoring.
- **Monitor Battery Status:** The app will notify you when the battery level is low.
- **Create Smart Scenarios:** Link the motion sensor with other compatible smart devices. For example, you can configure it to automatically turn on smart lights when motion is detected in a room.

Product Details



Figure 7: The TuYa Smart/Smart Life app allows integration with various smart home devices, enabling automated actions based on motion detection.

5. MAINTENANCE

5.1. Battery Replacement

The sensor is powered by 2 AAA batteries. The estimated battery life is up to 6 months, but actual duration may vary based on usage frequency and environmental factors. The app will send a low battery notification when replacement is needed.

1. Open the battery compartment cover.
2. Remove the old batteries.
3. Insert two new AAA batteries, observing correct polarity.
4. Close the battery compartment cover.

5.2. Cleaning

To ensure optimal performance, periodically clean the sensor's lens and casing. Use a soft, dry cloth. Avoid using abrasive cleaners or solvents, as these can damage the device.

6. TROUBLESHOOTING

Problem	Possible Cause	Solution
Sensor not connecting to Wi-Fi.	Incorrect Wi-Fi band (5GHz not supported), weak Wi-Fi signal, incorrect password, sensor not in pairing mode.	Ensure your router is broadcasting a 2.4GHz Wi-Fi signal. Move the sensor closer to the Wi-Fi router. Verify the Wi-Fi password. Re-enter pairing mode by pressing the connection key.
No motion detection or delayed alerts.	Low battery, sensor obstructed, incorrect mounting height, environmental interference (heat sources, direct sunlight).	Replace batteries. Ensure the sensor's view is unobstructed. Adjust mounting height to approximately 2 meters. Relocate the sensor away from heat sources or direct sunlight.
Frequent false alarms.	Pets, drafts, direct sunlight, rapid temperature changes, sensor placed near windows or vents.	Ensure pets are below 25KG or adjust sensor placement to avoid pet detection zones. Avoid placing near windows, vents, or areas with significant air movement. Verify the sensor is not exposed to direct sunlight.
App not receiving notifications.	App notification settings disabled, phone not connected to internet, sensor offline.	Check your phone's notification settings for the Tuya Smart/Smart Life app. Ensure your phone has an active internet connection. Verify the sensor is online in the app.

7. SPECIFICATIONS



Feature	Detail
Brand	Gaoducash
Model Number	S-M
Connectivity	Wi-Fi (2.4GHz only)
Detection Angle	110°



Feature	Detail
Maximum Detection Range	12 Meters (40 Feet)
Power Source	2 x AAA Batteries (not included)
Estimated Battery Life	Up to 6 months (182.5 days)
Anti-White Light Intensity	6500 Lux
Anti-Pet Immunity	Pets under 25KG
Operating Temperature	14 Degrees Celsius
Product Dimensions (H x W x D)	4.13" x 2.28" x 1.69" (105mm x 58mm x 43mm)
Item Weight	89 Grams (3.14 ounces)
Compatible Apps	Tuya Smart, Smart Life

8. WARRANTY AND SUPPORT

Gaoducash offers an industry-leading **2-year warranty** for this product. If you encounter any issues or have questions regarding your Wireless Smart Motion Sensor, please contact Gaoducash customer support. Refer to your purchase documentation for specific contact details or visit the official Gaoducash website for support information.

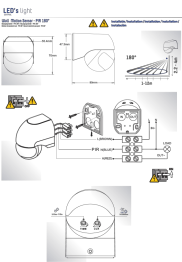
Related Documents - S-M

	<p>Tellur WiFi Motion Sensor TLL331121 User Manual and Setup Guide</p> <p>Comprehensive user manual for the Tellur WiFi Motion Sensor (TLL331121), covering product specifications, diagram, LED states, features, app installation, device setup (EZ/AP modes), troubleshooting, and declaration of conformity.</p>
	<p>Zigbee Motion Sensor User Manual - Specifications and Usage Guide</p> <p>Detailed user manual for the ONENUO Zigbee Motion Sensor. Includes specifications, step-by-step instructions for setup and network connection, and device information for smart home integration.</p>
	<p>SHADA LED's light Wall Motion Sensor PIR 180° Installation Guide</p> <p>Installation and safety guide for the SHADA LED's light Wall Motion Sensor PIR 180°, featuring 180° detection, 1-12m range, adjustable time and lux settings, IP54 rating, and Class II insulation.</p>

	<p>JA-110P PET Bus PIR Извещатель Движения Jablotron: Руководство и Характеристики</p> <p>Подробное руководство по установке и эксплуатации извещателя движения JA-110P PET Bus PIR от Jablotron. Узнайте о его функциях, устойчивости к домашним животным и технических характеристиках для систем безопасности.</p>
	<p>JABLOTRON JA-110P Bus PIR Motion Detector - Installation and Specifications</p> <p>Detailed installation guide and technical specifications for the JABLOTRON JA-110P Bus PIR motion detector. Learn about its features, wiring, and performance.</p>
	<p>Smart Security System User's Guide</p> <p>Comprehensive user guide for the Tuya Smart Security System, covering setup, component descriptions, installation, operation, features, and specifications.</p>