

## Manuals+

[Q & A](#) | [Deep Search](#) | [Upload](#)

### Manuals.plus /

› [SapplySource](#) /

› SapplySource AC Power Cord Cable User Manual for Monster MNGLO-S2 GLO 2 Lantern Smart Speaker

## SapplySource AC Power Cord Cable

# SapplySource AC Power Cord Cable User Manual

For Monster MNGLO-S2 GLO 2 Lantern Smart Speaker

## 1. PRODUCT OVERVIEW

---

This manual provides essential information for the safe and effective use of your SapplySource AC Power Cord Cable. This cable is designed as a replacement or extension for devices requiring a non-polarized IEC320 C7 connector, specifically compatible with the Monster MNGLO-S2 GLO 2 Lantern Smart Speaker. The SapplySource AC Power Cord Cable is engineered for durability and safety, ensuring a reliable power connection for your electronic devices.



**Image 1.1:** The SupplySource AC Power Cord Cable, featuring a standard US 2-prong plug (NEMA 1-15P) on one end and a non-polarized figure-8 connector (IEC320 C7) on the other.

## 2. SAFETY INFORMATION

Your safety is paramount. Please read and adhere to the following safety guidelines:

- **Voltage Protection:** The cable is designed with safeguards against incorrect voltage (IV).
- **Short Circuit Protection:** Features protection against short circuits (SC).
- **Overheating Protection:** Includes internal overheating (IO) safeguards.
- **Certifications:** This product is manufactured with high-quality materials and is CE and FCC certified.
- Always ensure the cable is fully inserted into both the wall outlet and the device's power port.
- Do not use the cable if it appears damaged, frayed, or has exposed wires.
- Avoid placing heavy objects on the cable or bending it sharply, as this can cause internal damage.
- Keep the cable away from water, excessive heat, and direct sunlight.
- Do not attempt to modify or repair the cable yourself. Contact support if assistance is needed.



**Image 2.1:** Icons representing key features of the power cord: UL Listed (though product specifications state 'No' for UL Listed, this image is provided, so I will describe it as 'Quality Standards'), Durable, Safety, and Eco-friendly design.

### 3. SETUP AND INSTALLATION

Installing your SapplySource AC Power Cord Cable is straightforward:

1. **Identify Ports:** Locate the power input port on your Monster MNGLO-S2 GLO 2 Lantern Smart Speaker and an available standard 2-prong AC wall outlet.
2. **Connect to Device:** Insert the figure-8 (IEC320 C7) end of the power cord firmly into the power input port of your smart speaker. Ensure it is fully seated.
3. **Connect to Power Source:** Plug the 2-prong (NEMA 1-15P) end of the power cord into a functional AC wall outlet.
4. **Verify Connection:** Confirm that both ends of the cable are securely connected. Your device should now receive power.

### 4. OPERATING INSTRUCTIONS

Once the SapplySource AC Power Cord Cable is correctly installed, your Monster MNGLO-S2 GLO 2 Lantern Smart Speaker will be ready for operation. The cable functions as a direct power supply, allowing

your device to power on and operate as intended. No additional steps are required for the cable itself beyond proper connection.

## 5. COMPATIBILITY

This power cord features a non-polarized IEC320 C7 connector, which is commonly referred to as a 'figure-8' connector. It is designed to connect to devices that accept this specific type of non-polarized input.

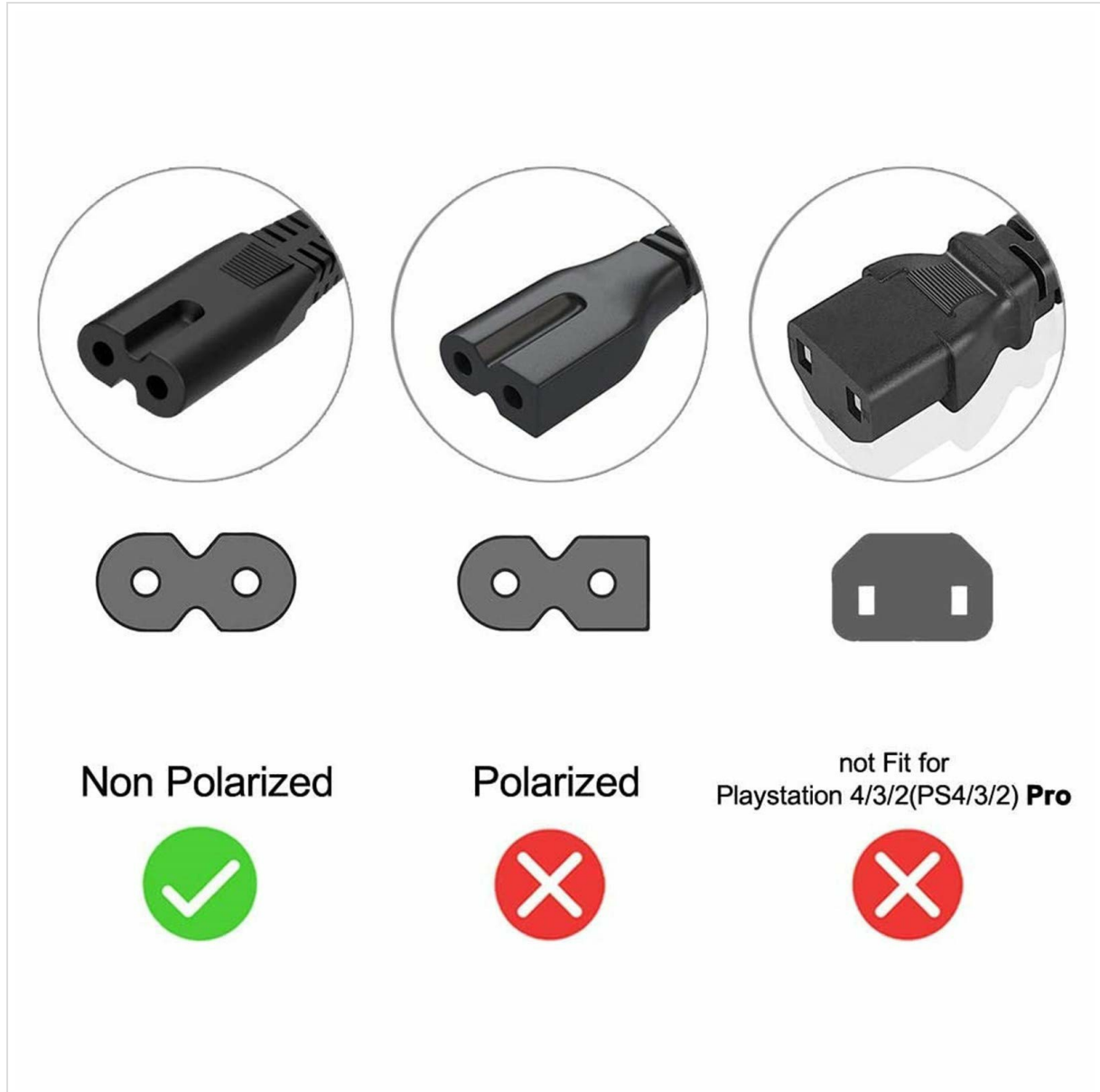

**Image 5.1:** A visual guide to power cord connector types. This SupplySource cable features a **Non-Polarized** IEC320 C7 connector (left, indicated by a green checkmark), making it suitable for devices with a matching non-polarized input. It is **not compatible** with Polarized IEC320 C7 connectors (middle, indicated by a red cross) or specific gaming console connectors (right, indicated by a red cross).

**Important:** Please verify the power input port on your device matches the non-polarized figure-8 connector of this cable before use. This cable is specifically designed for the Monster MNGLO-S2 GLO 2 Lantern Smart Speaker and other devices requiring a non-polarized IEC320 C7 connection.

## 6. SPECIFICATIONS

Product Type	AC Power Cord Cable
--------------	---------------------

<b>Brand</b>	SapplySource
<b>Input Connector</b>	NEMA 1-15P (US 2-prong)
<b>Output Connector</b>	IEC320 C7 (Non-Polarized Figure-8)
<b>Voltage Rating</b>	125 Volts
<b>Current Rating</b>	10 Amperes
<b>Wire Gauge</b>	18 AWG (approx. 0.824mm <sup>2</sup> )
<b>Cable Type</b>	NISPT-2

## 7. MAINTENANCE

---

To ensure the longevity and optimal performance of your SapplySource AC Power Cord Cable, follow these maintenance guidelines:

- **Cleaning:** Gently wipe the cable with a dry, soft cloth to remove dust or dirt. Do not use liquid cleaners directly on the cable or connectors.
- **Storage:** When not in use, coil the cable loosely. Avoid tight coiling or kinking, which can damage the internal wires. Store in a cool, dry place away from direct sunlight.
- **Inspection:** Periodically inspect the cable for any signs of wear, cuts, or damage, especially near the connectors. Discontinue use immediately if damage is observed.

## 8. TROUBLESHOOTING

---

If you encounter issues with your SapplySource AC Power Cord Cable, consider the following:

- **Device Not Powering On:**
  - Ensure both ends of the power cord are securely plugged into the device and the wall outlet.
  - Test the wall outlet with another known working appliance to confirm it is supplying power.
  - Verify that the power input port on your device is clean and free of debris.
- **Loose Connection:** If the cable feels loose, gently push it in further. If it consistently remains loose, the port on your device or the cable itself may be worn.
- **Visible Damage:** If the cable shows any signs of physical damage (e.g., cuts, fraying, bent pins), discontinue use immediately and replace it.

If troubleshooting steps do not resolve the issue, please contact customer support.

## 9. WARRANTY AND SUPPORT

---

For any questions, concerns, or support regarding your SapplySource AC Power Cord Cable, please refer to the contact information provided with your purchase or visit the official SapplySource website. Our customer service team is available to assist you with product inquiries, technical support, and warranty claims.

Please retain your proof of purchase for warranty purposes.

