

[Manuals.plus](#) /

> [Triumph](#) /

> Triumph Smart Digital Body Weight Bathroom Scale (Model TRSC13) Instruction Manual

Triumph TRSC13

Triumph Smart Digital Body Weight Bathroom Scale (Model TRSC13) Instruction Manual

This manual provides detailed instructions for the safe and effective use of your Triumph Smart Digital Body Weight Bathroom Scale, Model TRSC13.

1. PRODUCT OVERVIEW

The Triumph Smart Digital Body Weight Bathroom Scale is designed for accurate weight measurements and body composition analysis. It features step-on technology, an LCD backlit display, and a durable tempered glass platform, ensuring a reliable and user-friendly experience.



Image: Front view of the Triumph Smart Digital Body Weight Bathroom Scale, showcasing its sleek black design and clear LCD display.

2. KEY FEATURES

- **Smart Step-On Technology:** Provides instant, accurate readings upon stepping on the scale.
- **High Precision Sensors:** Equipped with 4 sensors for measurements up to 400 lbs (180 kg).
- **Durable Platform:** Made of 6mm tempered glass, offering exceptional sturdiness and safety.
- **LCD Backlit Display:** Large, round screen with a cool blue backlight for easy reading in any lighting conditions.
- **Multiple Unit Modes:** Switch between kilograms (kg), pounds (lb), and stone-pounds (st:lb).
- **User Profiles:** Stores data for up to 9 users, allowing personalized tracking of body composition metrics.
- **Automatic Functions:** Auto-zero, auto-on, and auto-off for convenience and extended battery life.
- **Indicators:** Includes low battery and overload indications for user awareness.

3. PACKAGE CONTENTS

- Triumph Smart Digital Body Weight Bathroom Scale

- 2 x AAA Batteries (included)
- Instruction Manual (this document)

4. SETUP AND FIRST USE

4.1 Battery Installation

1. Locate the battery compartment on the underside of the scale.
2. Open the battery cover.
3. Insert the 2 AAA batteries, ensuring correct polarity (+/-) as indicated inside the compartment.
4. Close the battery cover securely.

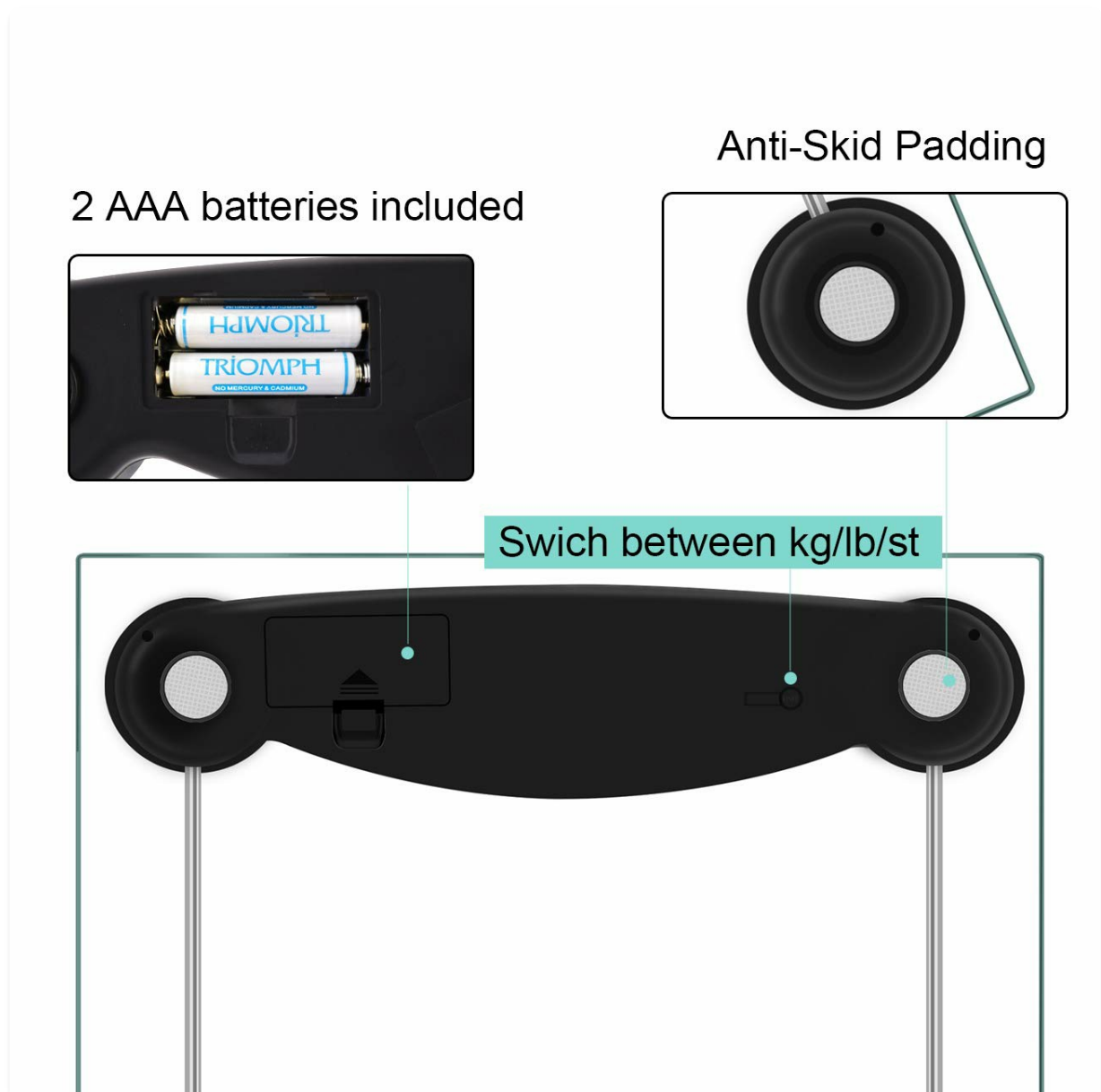

Image: Underside of the scale showing the battery compartment and the unit switch.

4.2 Scale Placement

For accurate and consistent readings, place the scale on a hard, flat, and stable surface. Avoid placing it on carpets, rugs, or uneven flooring, as this can significantly affect measurement precision.

4.3 Initial Calibration

Before first use or after moving the scale, perform an initial calibration to ensure accuracy:

1. Gently step on the scale until the display lights up.
2. Step off the scale. The display will show "0.0" or "0.00" and then turn off.
3. The scale is now calibrated and ready for use.

5. OPERATING INSTRUCTIONS

5.1 Basic Weight Measurement

1. Ensure the scale is on a flat, stable surface.
2. Step onto the scale with bare feet, standing still and centered on the platform.
3. Your weight will be displayed on the LCD screen.
4. The scale will automatically turn off after a few seconds of inactivity.



COMFORTABLE MEASUREMENT EXPERIENCE

Anti-rollover and anti-skid, Smooth edge without injuring feet, safe and comfortable.

Image: A person's feet positioned on the scale, with a weight reading visible on the display.

5.2 Changing Weight Units

To switch between kilograms (kg), pounds (lb), and stone-pounds (st:lb):

- Locate the unit switch button on the underside of the scale, near the battery compartment.
- Press the button to cycle through the available units until your desired unit is displayed on the screen.

5.3 Setting Up User Profiles and Body Composition Analysis

The scale can store up to 9 user profiles, allowing for personalized tracking of body composition metrics such as body fat percentage, BMI, total body water, bone mass, and calories.

1. With the scale off, press the "SET" button. The display will show a user number (e.g., "P1").
2. Use the "▲" or "▼" arrows to select a user number (P1-P9). Press "SET" to confirm your selection.
3. The display will show the gender icon. Use "▲" or "▼" to select male or female. Press "SET" to confirm.
4. The display will show the age. Use "▲" or "▼" to adjust the age (range: 10-80 years). Press "SET" to confirm.
5. The display will show the height. Use "▲" or "▼" to adjust the height (in cm or inches, depending on your selected unit setting). Press "SET" to confirm.
6. Once all settings are confirmed, the display will show "0.0".
7. Step onto the scale with bare feet, ensuring your feet fully cover the silver electrode pads on the platform.
8. The scale will measure your weight and then cycle through various body composition metrics on the display.



*LCD
Display*



*Strong
Bearing
Surface*



Step-On



*Low
Battery*



*Overload
Indication*

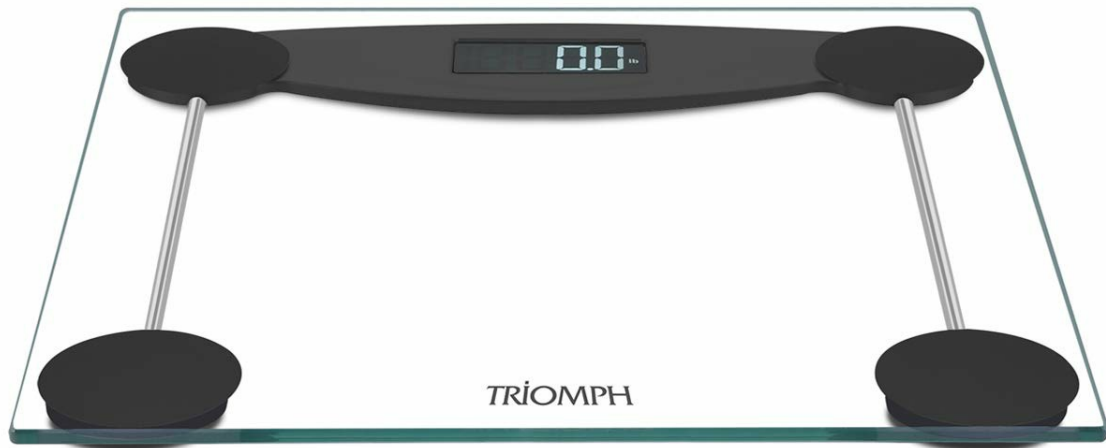

Image: Icons on the scale indicating LCD display, strong bearing surface, step-on function, low battery, and overload indication.



Image: Close-up of the scale's underside, highlighting the four highly-precise sensors and non-toxic ABS anti-skid pads for stability.

6. MAINTENANCE AND CARE

- Clean the scale with a damp cloth and mild detergent. Do not use abrasive cleaners or immerse the scale in water.
- Store the scale in a dry place, away from extreme temperatures and humidity.
- Avoid dropping or subjecting the scale to heavy impacts to prevent damage.
- Remove batteries if the scale will not be used for an extended period to prevent potential leakage and damage.

7. TROUBLESHOOTING

Issue	Possible Cause	Solution
"Lo" displayed	Low battery power.	Replace the 2 AAA batteries with new ones.

Issue	Possible Cause	Solution
"ERR" displayed	Overload. Weight exceeds maximum capacity.	Step off the scale immediately. The maximum weight capacity is 400 lbs (180 kg).
Inaccurate readings	Scale on uneven surface or not calibrated. Feet not properly placed on electrodes for body composition.	Place on a hard, flat surface. Perform initial calibration (Section 4.3). Ensure bare feet are used and cover the silver electrodes for body composition analysis.

8. SPECIFICATIONS

- **Brand:** Triumph
- **Model Number:** TRSC13
- **Weight Capacity:** 400 lbs (180 kg)
- **Measurement Units:** kg, lb, st:lb
- **Display Type:** LCD Backlit
- **Platform Material:** 6mm Tempered Glass
- **Power Source:** 2 x AAA Batteries (included)
- **Product Dimensions:** 12.3 x 11.1 x 0.9 inches
- **Item Weight:** 2.7 Pounds

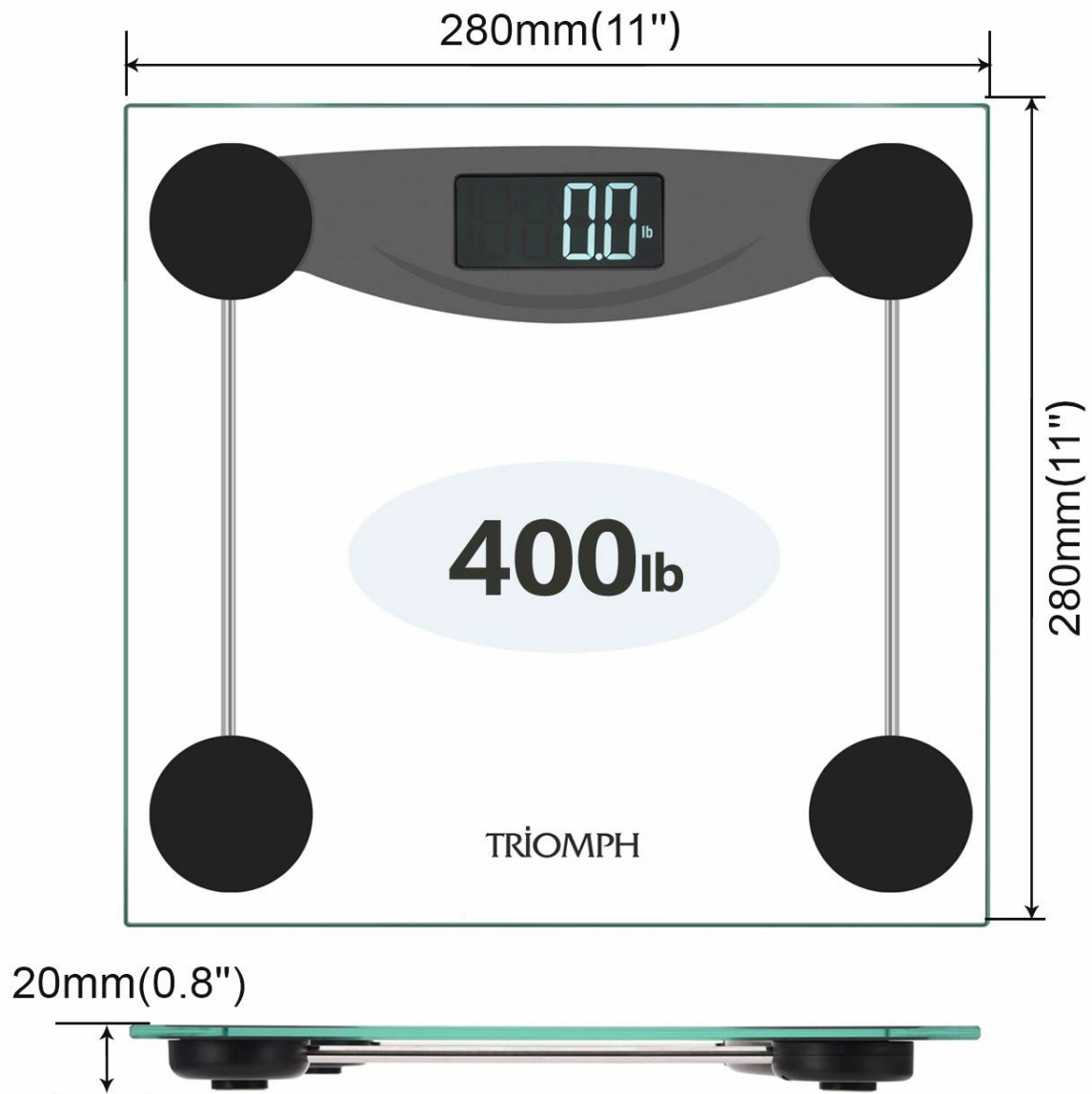

Image: Diagram illustrating the dimensions of the Triumph Smart Digital Body Weight Bathroom Scale.

9. WARRANTY AND SUPPORT

Triumph, a Canadian brand with over 10 years of history, is committed to product quality and customer satisfaction. We stand by our products with comprehensive support:

- **1-Year Guarantee:** Covers manufacturing defects and malfunctions from the date of purchase.
- **30-Day Money-Back Service:** For customer satisfaction, allowing returns within 30 days of purchase.
- **Lifetime Support:** Dedicated assistance for the lifespan of your product, ensuring long-term usability.
- **Local U.S. Customer Service:** Our U.S.-based office provides convenient and responsive support.

For any inquiries, technical assistance, or warranty claims, please contact our customer service team through the contact information provided on our official website or product packaging.