

DYNASTY PROAUDIO WSA-5TR-V2

DYNASTY PROAUDIO WSA-5TR-V2 Wireless Audio Adapter/Subwoofer Kit Instruction Manual

Model: WSA-5TR-V2 | Brand: DYNASTY PROAUDIO

PRODUCT OVERVIEW

The DYNASTY PROAUDIO WSA-5TR-V2 is a wireless audio adapter and subwoofer kit designed to provide high-quality, ultra-low latency audio transmission for powered subwoofers and active speakers. It utilizes dual-band 5.2GHz and 5.8GHz selectable digital wireless technology with 106 RF channel auto-selection to minimize interference from common wireless devices like Wi-Fi routers and cell phones. This system allows for flexible placement of your audio components, eliminating the need for long audio cables.

Key features include:

- **Lossless Audio & Low Interference:** Advanced dual-band technology ensures near-lossless audio quality and stable transmission.
- **Quick and Easy Installation:** Simplifies setup by removing the need for extensive wiring, allowing optimal placement of subwoofers and speakers.
- **High Wireless Transmission Performance:** Delivers fast, stable, and high-quality sound with reduced latency, suitable for audio and video synchronization.
- **Premium Audio Output:** Provides full CD quality (24-bit 48KHz) uncompressed audio for stereo applications.
- **Wide Transmission Range:** Operates up to 100 feet (30 meters) in line of sight, or 50 feet through walls, ceilings, and floors (actual range may vary based on environment).



Image: The DYNASTY PROAUDIO WSA-5TR-V2 Wireless Audio Adapter/Subwoofer Kit, showcasing its compact design.

PACKAGE CONTENTS

Please ensure all items listed below are present in your package:

- 1 x WSA-5TR-V2 Wireless Transmitter (TX)
- 1 x WSA-5TR-V2 Wireless Receiver (RX)
- 2 x 1A/5V USB Plug Power Adaptors
- 2 x USB Charging Cables
- 2 x Stereo RCA Audio Cables
- 1 x 3.5mm to RCA Audio Cable
- 1 x User Manual

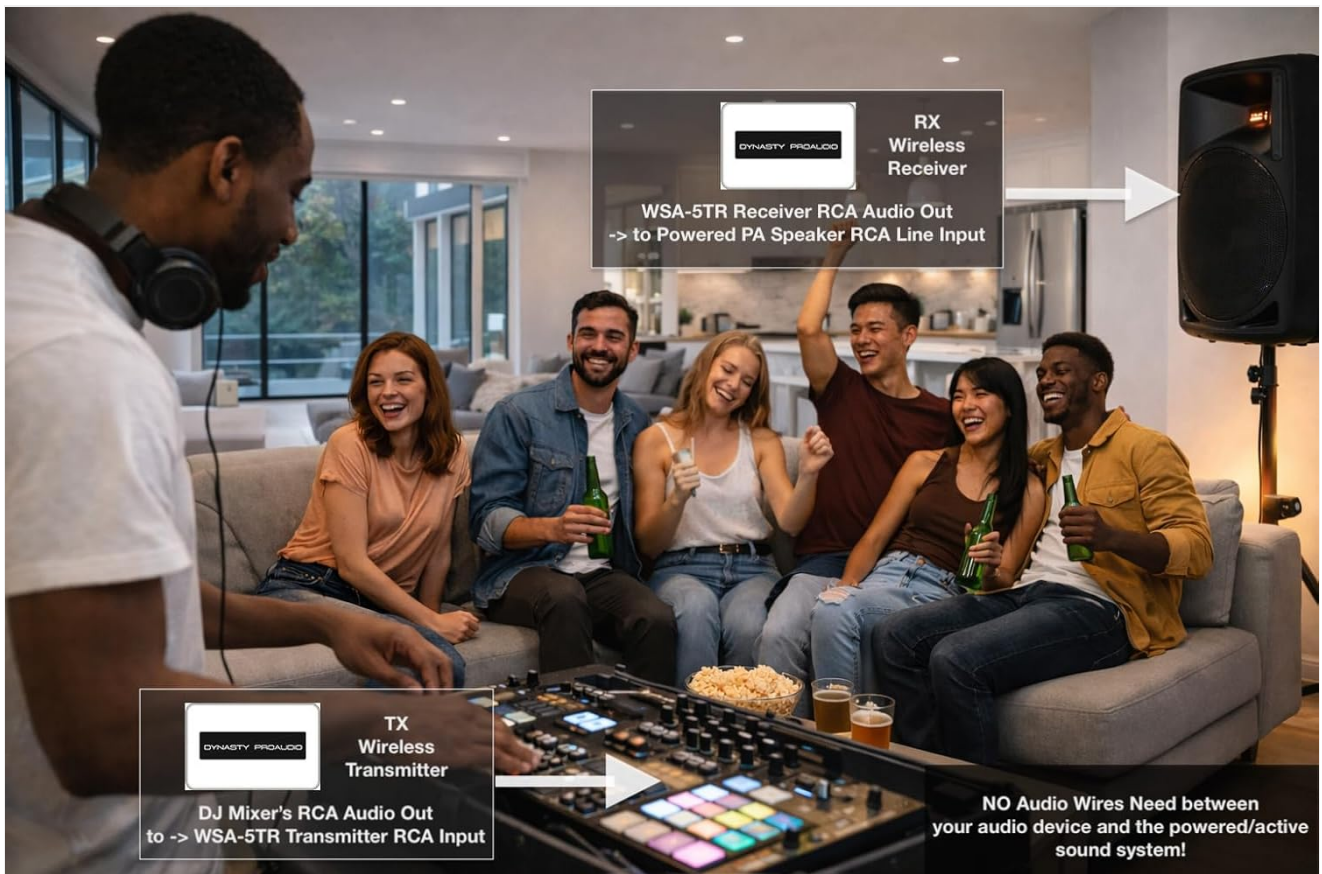

Image: The complete package contents of the DYNASTY PROAUDIO WSA-5TR-V2 kit, including the transmitter, receiver, cables,

and power adapters.

SETUP INSTRUCTIONS

Connecting the Transmitter and Receiver

The WSA-5TR-V2 kit includes a transmitter (TX) and a receiver (RX). The transmitter features an AUDIO INPUT for connecting to your audio source, while the receiver features an AUDIO OUTPUT for connecting to your powered subwoofer or active speakers. Both units require power via the provided USB cables and adapters.

The graphic is split into two horizontal panels. The top panel features a man in a red jacket pointing, a yellow smiley face, and a green checkmark. It lists benefits for 5.8G/5.2GHz. The bottom panel features the same man in a grey jacket with a distressed expression, a red 'X', and a sad face emoji. It lists drawbacks for 2.4GHz.

5.8G / 5.2GHz ✓
Wireless Audio Adapter

- ✓ Much Less Interference
- ✓ Cleaner frequency band & Lower Latency
- ✓ Far less crowded compared to 2.4GHz
- ✓ More Stable Audio Transmission
- ✓ Lower dropouts in professional environments.
- ✓ Better for real-time audio applications (TV audio, wireless speaker kits)
- ✓ More consistent performance under load
- ✓ Better Sound Consistency

✗ 2.4GHz
wireless Audio Adapter

- ✗ Heavy RF Congestion
- ✗ Shares frequency with WiFi routers, Bluetooth devices, smart home devices, baby monitors, microwaves, etc.
- ✗ Higher Latency Risk
In busy networks, delay and instability may increase
- ✗ More Susceptible to Noise
- ✗ High risk of interference and dropouts

Image: Close-up view of the DYNASTY PROAUDIO WSA-5TR-V2 units, showing the audio input and output ports, power input, and 'M' button.

Subwoofer Installation

To connect your powered subwoofer wirelessly:

1. Connect the WSA-5TR-V2 Wireless Transmitter (TX) to the SUB subwoofer output (or preamp out) of your audio device (e.g., A/V receiver, amplifier, audio preamp) using an RCA cable.
2. Connect the WSA-5TR-V2 Wireless Receiver (RX) to the RCA Audio Input (LFE IN or LINE IN) of your powered subwoofer using an RCA cable.
3. Ensure both the TX and RX units are powered using the provided USB cables and 5V power adapters.



Image: A diagram illustrating the connection of the WSA-5TR-V2 transmitter to an A/V receiver's sub out and the receiver to a powered subwoofer.

Active/Powered Speakers Installation

To connect your active/powerd speakers wirelessly:

1. Connect the WSA-5TR-V2 Wireless Transmitter (TX) to the Preamp Line Out (or Zone 2 Out) of your A/V receiver using an RCA cable.
2. Connect the WSA-5TR-V2 Wireless Receiver (RX) to the RCA Line In of your active/powerd speakers using an RCA cable.
3. Ensure both the TX and RX units are powered using the provided USB cables and 5V power adapters.



Image: A diagram illustrating the connection of the WSA-5TR-V2 transmitter to an A/V receiver's preamp out and the receiver to active/powered speakers.

Power Connection

Each WSA-5TR-V2 unit (transmitter and receiver) requires a 5V power supply. Use the included USB charging cables and 1A/5V USB plug power adapters to power the units. Connect the micro-USB end of the cable to the 'POWER' port on each unit and the USB-A end to the power adapter, then plug into a wall outlet.



Image: The DYNASTY PROAUDIO WSA-5TR-V2 units with their power cables connected, ready for operation.

Video: Wireless Rear Active Speakers and Subwoofer Setup

Your browser does not support the video tag.

This video provides a detailed guide on setting up the DYNASTY PROAUDIO WSA-5TR-V2 for wireless rear active speakers and subwoofers, demonstrating the connection process and functionality.

OPERATING YOUR WIRELESS AUDIO ADAPTER

Dual-Band Selection

The WSA-5TR-V2 supports dual-band 5.2GHz and 5.8GHz operation. By default, the units connect on 5.8GHz (indicated by a solid blue LED). To switch to 5.2GHz (indicated by a solid green LED), press and hold the 'M' (Mode) button on the receiver unit until the LED blinks and then turns green. Repeat this process for the transmitter unit to ensure both are operating on the same frequency band. This can help in environments with heavy Wi-Fi traffic.



Image: The LED indicator on the WSA-5TR-V2 unit, which changes color to signify the active frequency band (blue for 5.8GHz, green for 5.2GHz).

Pairing

The transmitter and receiver units are typically pre-paired from the factory. If they do not connect automatically (LED is blinking), you may need to re-pair them. To pair, ensure both units are powered on. Press and hold the 'M' button on the receiver until the LED blinks, then press and hold the 'M' button on the transmitter until its LED also blinks and then becomes solid, indicating a successful connection.

PACKAGE LIST

1 x WSA-5TR-V2 Wireless Transmitter (TX)
1 x WSA-5TR-V2 Wireless Receiver (RX)
2 x 1A/5V USB Plug Power Adaptors
2 x USB Charging Cables

2 x Stereo RCA Audio Cables
1 x 3.5mm to RCA Audio Cable
1 x User Manual



Image: Two DYNASTY PROAUDIO WSA-5TR-V2 units positioned side-by-side, illustrating their compact size and LED indicators for connection status.

Audio Transmission

Once the transmitter and receiver are successfully paired and connected to your audio source and output devices, audio will be transmitted wirelessly. The system is designed for ultra-low latency, ensuring minimal delay between the source and the output, which is crucial for synchronized audio with video content. The effective transmission range is up to 100 feet line-of-sight, or approximately 50 feet through typical household walls.



5.8G / 5.2GHz ✓

Wireless Audio Adapter



- ✓ Much Less Interference
- ✓ Cleaner frequency band & Lower Latency
- ✓ Far less crowded compared to 2.4GHz
- ✓ More Stable Audio Transmission
- ✓ Lower dropouts in professional environments.
- ✓ Better for real-time audio applications (TV audio, wireless speaker kits)
- ✓ More consistent performance under load
- ✓ Better Sound Consistency



✗ 2.4GHz

wireless Audio Adapter



- ✗ Heavy RF Congestion
- ✗ Shares frequency with WiFi routers, Bluetooth devices, smart home devices, baby monitors, microwaves, etc.
- ✗ Higher Latency Risk
- In busy networks, delay and instability may increase
- ✗ More Susceptible to Noise
- ✗ High risk of interference and dropouts

Image: An illustration demonstrating the WSA-5TR-V2 wirelessly transmitting audio from a television to a stereo sound system, highlighting cable-free setup.

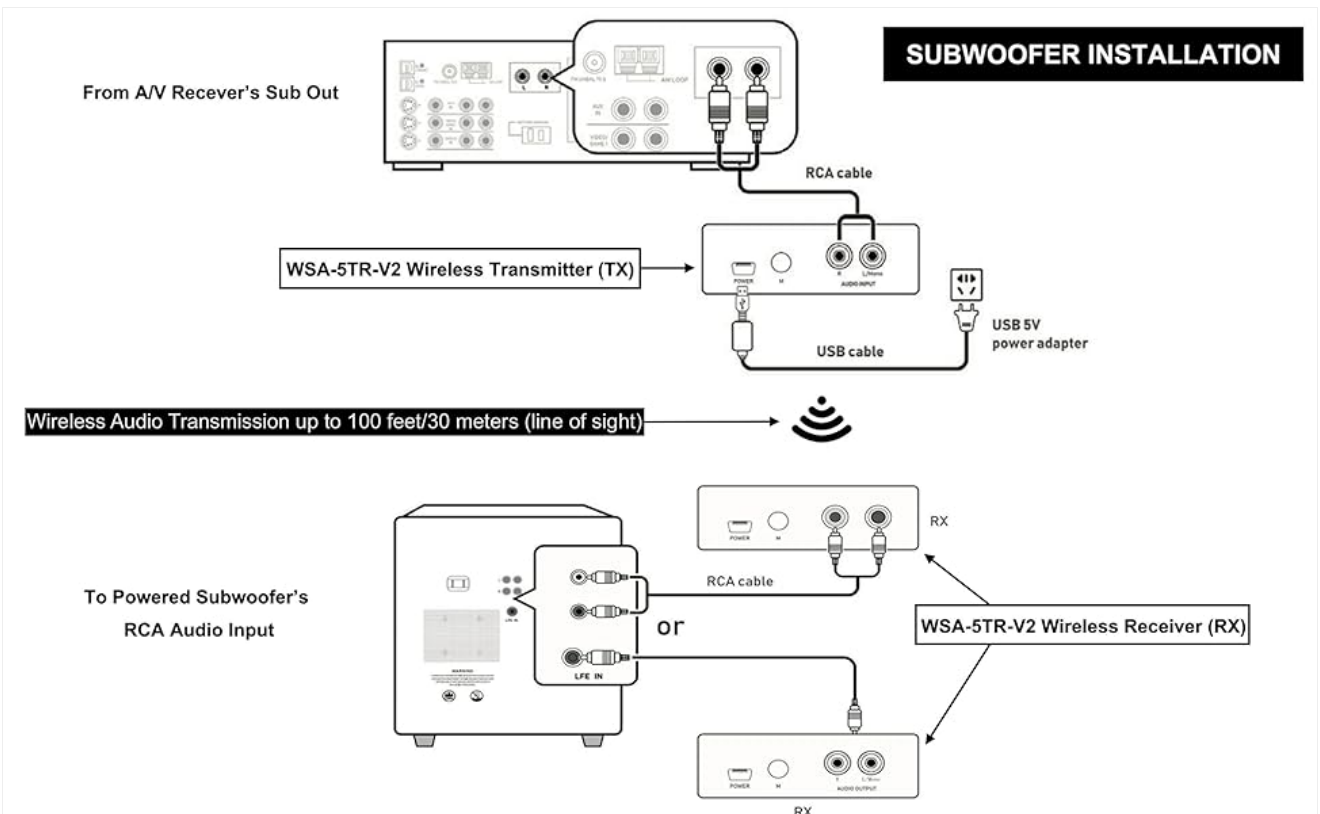

Image: A visual representation of the WSA-5TR-V2 setup, showing the transmitter connected to a TV and the receiver connected to a stereo system for wireless audio streaming.

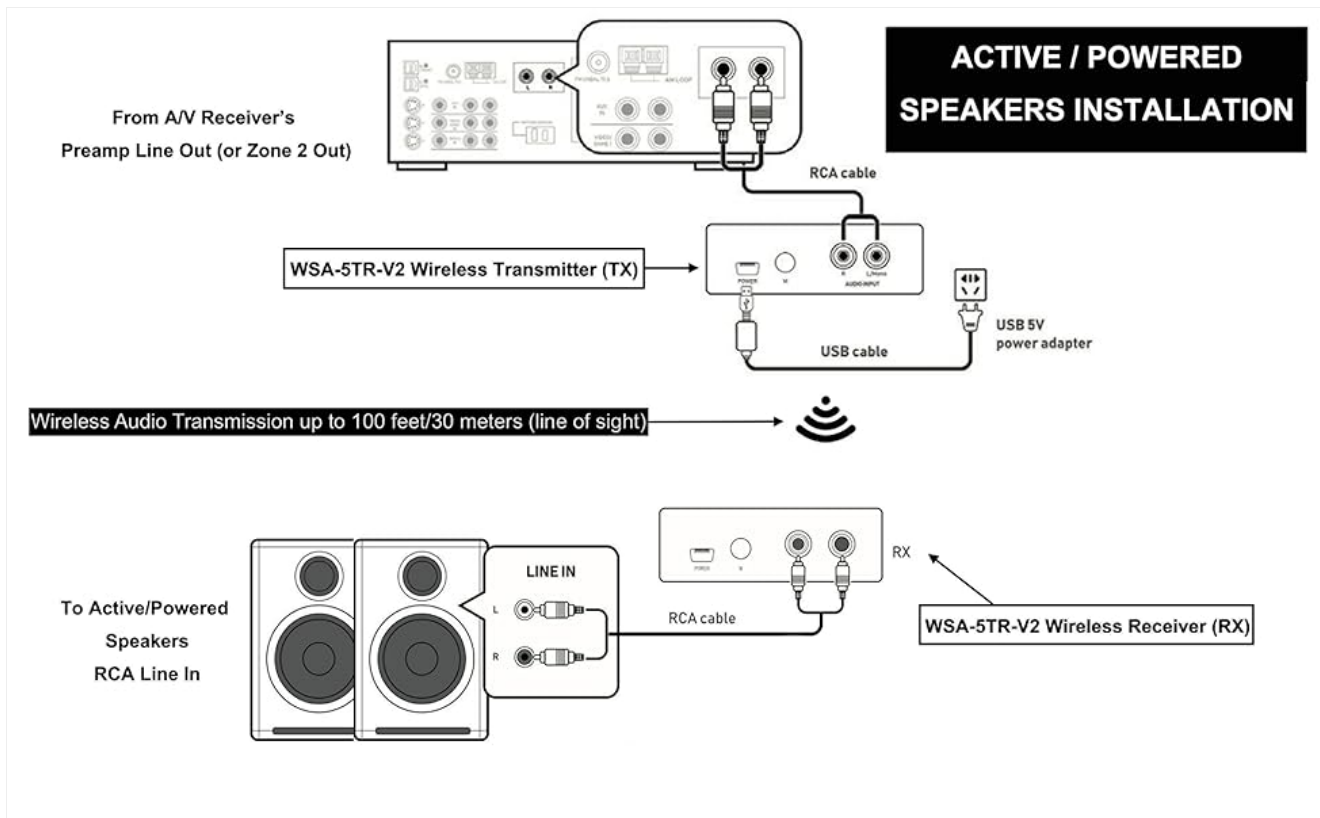

Image: A scenario depicting the WSA-5TR-V2 in use, with the transmitter connected to a DJ mixer and the receiver sending audio to a powered PA speaker, emphasizing wireless flexibility.

CARE AND MAINTENANCE

To ensure the longevity and optimal performance of your DYNASTY PROAUDIO WSA-5TR-V2, follow these care guidelines:

- **Cleaning:** Use a soft, dry cloth to clean the units. Avoid using liquid cleaners, aerosols, or solvents, as these can damage the finish or internal components.
- **Environment:** Keep the units in a dry environment, away from direct sunlight, heat sources, and excessive moisture. Do not expose them to water or other liquids.
- **Handling:** Handle the units with care. Avoid dropping them or subjecting them to strong impacts.
- **Ventilation:** Ensure proper ventilation around the units to prevent overheating. Do not cover the units during operation.
- **Power:** Always use the provided power adapters and cables. Using incompatible power sources may damage the device.

TROUBLESHOOTING GUIDE

If you encounter issues with your WSA-5TR-V2, refer to the table below for common problems and their solutions:

Problem	Solution
---------	----------

Problem	Solution
No Sound	<ul style="list-style-type: none"> • Make sure all cables are connected correctly. • Ensure the audio transmitter (TX) is connected to the SUB subwoofer output (or preamp out) from your device (e.g., A/V receiver, amplifier). • Ensure the audio receiver (RX) is connected to your active/powered subwoofer speaker or powered speakers. • Check if the LEDs illuminate on the front of both units. Solid Blue indicates 5.8G mode, solid Green indicates 5.2G mode. If LEDs are different colors or flashing, re-pair the units. • Make sure the audio amplifier with the transmitter is turned on. • Ensure the correct input is selected on your home theater receiver. • Turn up the volume on the home theater receiver. • If using a 5.1/7.1 A/V receiver, set the correct mode on your A/V receiver to turn on the subwoofer output. • Make sure RCA audio wire connections are correct and secure. • Ensure both wireless transmitter and receiver are connected to a working power outlet with supported 5V power adaptors.

Troubleshoot

Problem	Solution
No Sound	- Make sure that all the cables are connected correctly
	- Make sure that the audio transmitter (TX) is connecting to the SUB subwoofer output (or preamp out) from your device, like AV receiver, amplifier, audio preamp....etc
	- Make sure that the audio receiver (RX) is connecting to your active/powered subwoofer speaker (or powered speakers)
	- Check to see if the LEDs illuminate on the front of both the wireless transmitter and receiver units, if the LEDs are shown in solid Blue (in 5.8G mode) or sold Green (in 5.2G mode), the communication is working correctly. If the LEDs are different color or flashing, refer to the "NO communication" between the transmitter and receiver, then please pairing the receiver and transmitter.
	- Make sure that the audio amplifier with transmitter is turned on.
	- Make sure that the correct input is selected on your home theater receiver.
	- Turn up the volume on the home theater receiver.
	- If you are using the 5.1/7.1 AV receiver with WSA-5TR wireless subwoofer speaker kit, please make sure to set the correct mode on your AV receive to turn on the subwoofer output
	- Make sure that the RCA audio wire connections are correct and secure.
	- Make sure that the wireless transmitter and wireless receiver are both connected to a working power outlet with supported 5V power adaptor

Image: A detailed troubleshooting table providing solutions for common issues encountered with the WSA-5TR-V2, particularly regarding 'No Sound'.

TECHNICAL SPECIFICATIONS

Feature	Specification
Brand	DYNASTY PROAUDIO

Feature	Specification
Model Number	WSA-5TR-V2
Connectivity Technology	5.2 & 5.8GHz dual-band selectable digital wireless
Audio Output Mode	Stereo
Input Voltage	0.7 Volts
Maximum Range	100 Feet (30M) line of sight
Item Dimensions (D x W x H)	2.3"D x 2.6"W x 1.1"H
Power Source	Corded Electric (USB 5V)
Compatible Devices	Smartphone, Tablet, MP3 Player, Desktop, Television, Projector
Enclosure Material	Metal
Audio Driver Type	Dynamic Driver

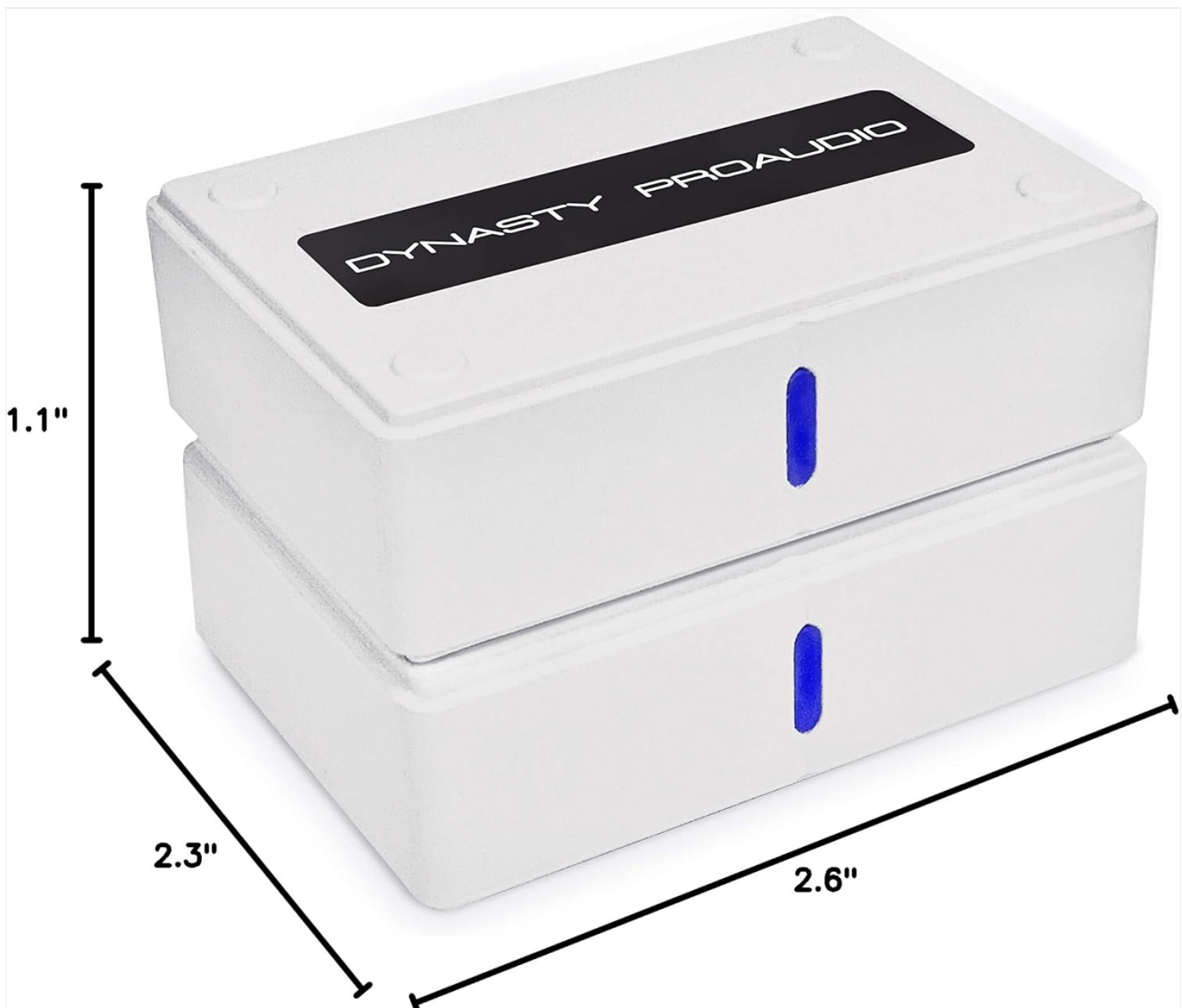

Image: A diagram showing the compact dimensions of the DYNASTY PROAUDIO WSA-5TR-V2 units.

WARRANTY INFORMATION

The DYNASTY PROAUDIO WSA-5TR-V2 Wireless Audio Adapter/Subwoofer Kit comes with a **1 Year Manufacturer Warranty**. For warranty claims or support, please contact DYNASTY PROAUDIO customer service. Additionally, the product is eligible for a 30-day refund/replacement return policy through the retailer.