

MIFA M520

MIFA 100W Portable Wireless PA System User Manual

Model: M520

1. INTRODUCTION

Thank you for purchasing the MIFA 100W Portable Wireless PA System. This powerful and versatile speaker is designed to deliver high-quality audio for various occasions, from family gatherings to outdoor parties. Featuring a wireless microphone, remote control, and multiple connectivity options, it provides an immersive audio experience with rich bass and clear stereo sound. Please read this manual carefully before using the product to ensure proper operation and to maximize its lifespan.



Figure 1.1: MIFA 100W Portable Wireless PA System and Wireless Microphone.

2. SAFETY INFORMATION

To ensure safe and trouble-free operation, please read and follow these safety guidelines:

- Always fully charge the product before first use.
- Use and store the product at room temperature.
- Do not drop the product or subject it to strong impacts to prevent damage.
- Do not expose the product to fire, high temperatures, direct sunlight, or other extreme conditions.
- Do not use organic solvents or other chemical cleaners to clean the product.
- Do not allow small particles to enter the product.
- Maintain a moderate speaker volume to prevent temporary or permanent hearing impairment.
- Do not disassemble the product or make any modifications to its structure or any of its parts.
- Keep the product out of reach of children.

- If the battery is not replaced correctly, there is a risk of explosion. Only replace with the same type of battery.
- Batteries (battery packs) must not be exposed to conditions such as sunlight, fire, or similar conditions of overheating.

3. PACKAGE CONTENTS

Please check the box for the following items:



Figure 3.1: All items included in the product package.

- MIFA M520 Party Speaker
- Wireless Microphone
- Remote Controller
- 3.5mm Audio Cable
- USB Power Cable
- Power Adapter

4. PRODUCT OVERVIEW

Familiarize yourself with the main components and controls of your MIFA M520 speaker.



Figure 4.1: Top panel controls and interfaces.

Control Panel Features:

- **Bass Knob:** Adjusts the low-frequency output.
- **Treble Knob:** Adjusts the high-frequency output.
- **Multi-interfaces:** Includes Micro SD Card slot, USB Player port, AUX Line In, and Line Out.
- **DC 15V Input:** Power input for charging and operation.
- **MIC Input:** Wired microphone input.
- **Echo Knob:** Adjusts the echo effect for the microphone.

- **Power Knob/Music Volume Adjust:** Turns the speaker on/off and controls the main music volume.
- **Display:** Digital screen showing mode, track number, time, etc.
- **Playback Control Buttons:** For play/pause, skip tracks, mode selection.
- **Microphone Volume Knob:** Adjusts the volume of the connected microphone.

5. SETUP

5.1 Charging the Speaker

Before first use, fully charge the speaker. Connect the power adapter to the DC 15V input port on the speaker and plug it into a power outlet. The display will indicate charging status. A full charge provides approximately 7 hours of playtime.



Figure 5.1: Speaker battery life indication.

5.2 Charging the Wireless Microphone

The wireless microphone has a built-in 2200 mAh rechargeable battery. Connect the microphone to a USB power source using the provided USB power cable. The microphone's display will show charging status. It is not recommended to use

the microphone while it is charging.

5.3 Powering On/Off

Rotate the "Power Knob/Music Volume Adjust" clockwise to turn the speaker on. Rotate it counter-clockwise until it clicks to turn the speaker off.

6. OPERATING INSTRUCTIONS

6.1 Bluetooth Pairing

1. Turn on the MIFA M520 speaker. It will automatically enter Bluetooth pairing mode, indicated by a flashing Bluetooth icon on the display.
2. On your smartphone or Bluetooth-enabled device, enable Bluetooth and search for "MIFA M520".
3. Select "MIFA M520" from the list of available devices to connect. Once connected, the Bluetooth icon will stop flashing, and you will hear a confirmation sound.
4. The speaker will automatically re-connect to the last paired device when powered on, if the device is within range.



6.2 True Wireless Stereo (TWS) Function

The TWS function allows you to connect two MIFA M520 speakers together for a true stereo sound experience.

1. Ensure both speakers are powered on and not connected to any Bluetooth device.
2. On one speaker (this will be the primary speaker), press and hold the TWS button (refer to control panel diagram for location, usually integrated with mode button or a dedicated button).
3. The primary speaker will search for the secondary speaker. Once connected, you will hear a confirmation sound, and both speakers will play audio in stereo.

6.3 Using the Wireless Microphone

1. Turn on the wireless microphone by pressing its power button. It will automatically connect to the MIFA M520 speaker.
2. Adjust the microphone volume using the "Microphone Volume Knob" on the speaker's control panel.
3. Use the "Echo Knob" to add or reduce echo effect for vocal performances.
4. The speaker supports features like microphone priority (music volume lowers when speaking into the mic) and elimination of original sound (for karaoke). Refer to the display and playback controls for these functions.



Wireless Microphone

Bluetooth transmission supports that the sound is constantly frequency without distortion

***The microphone has a built-in 2200 mAh rechargeable battery, which can be used after charging. (Not recommended to use when charging)**

Figure 6.2: Wireless microphone in use.

6.4 Adjusting Sound (EQ)

Use the "Bass Knob" and "Treble Knob" on the control panel to customize the audio output to your preference. Rotate clockwise to increase and counter-clockwise to decrease.



Figure 6.3: Speaker's powerful sound output.

6.5 Using USB Drive / Micro SD Card

Insert a USB flash drive or a Micro SD card (with supported audio files) into the respective ports on the control panel. The speaker will automatically switch to USB/SD card mode and begin playing music. Use the playback control buttons to navigate tracks.

6.6 Remote Control Operation

The included remote control allows for convenient operation from a distance. Functions include power on/off, volume adjustment, track navigation, mode selection, and specific karaoke features.

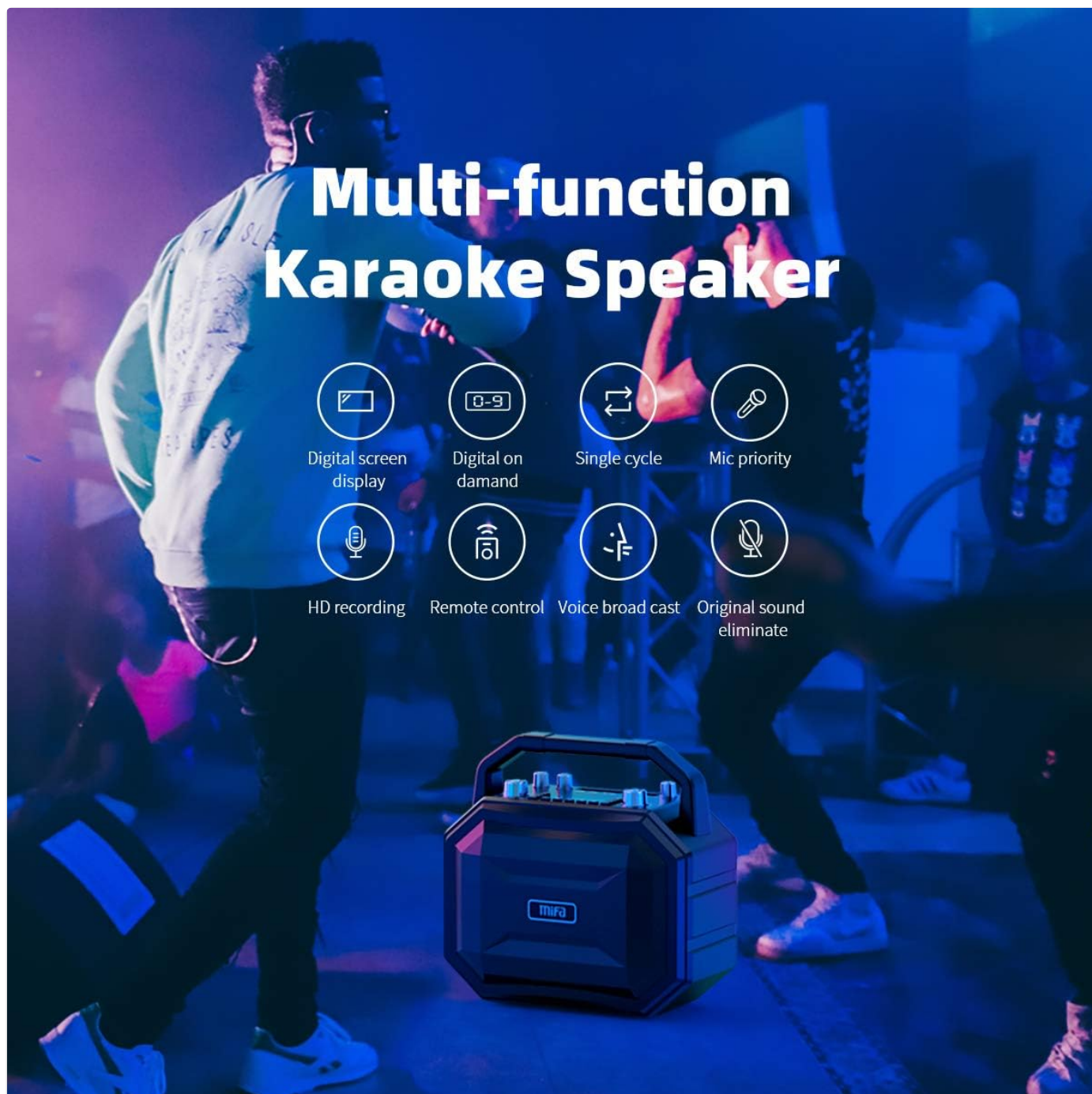

Figure 6.4: Overview of karaoke and other functions.

- **Digital Screen Display:** Provides clear information on current mode, track, and settings.
- **HD Recording:** Record your performances directly to a USB drive or Micro SD card.
- **Remote Control:** Full control over speaker functions from a distance.
- **Voice Broadcast:** Announce modes or functions.
- **Microphone Priority:** Automatically lowers music volume when the microphone is in use.
- **Original Sound Elimination:** Reduces or removes vocals from songs for karaoke.
- **Single Cycle:** Repeats the current track.
- **Digital On Demand:** Allows direct track selection via number input (if supported by media).

7. MAINTENANCE

7.1 Cleaning

Wipe the speaker and microphone with a soft, dry cloth. Do not use abrasive cleaners, alcohol, benzene, or other chemical solvents, as these may damage the surface or internal components.

7.2 Storage

When not in use for extended periods, store the speaker and microphone in a cool, dry place, away from direct sunlight and extreme temperatures. It is recommended to charge the battery every 3 months to maintain its health.

8. TROUBLESHOOTING

| Problem | Possible Cause | Solution |
|--------------------------------|--|--|
| Speaker does not turn on. | Battery is depleted. | Connect the speaker to the power adapter and charge it. |
| No sound from speaker. | Volume is too low; Incorrect input mode; Device not paired. | Increase volume; Press mode button to select correct input; Re-pair Bluetooth device. |
| Microphone not working. | Microphone battery low; Microphone not turned on; Microphone volume too low. | Charge microphone; Turn on microphone; Increase microphone volume knob. |
| Bluetooth connection unstable. | Device too far; Obstructions; Interference. | Move device closer to speaker; Remove obstructions; Avoid strong electromagnetic interference. |
| Remote control not working. | Battery depleted; Obstruction between remote and speaker. | Replace remote control battery; Ensure clear line of sight to speaker's IR receiver. |

9. SPECIFICATIONS

| Feature | Detail |
|-----------------------------|---|
| Model Number | M520 |
| Output Wattage | 100 Watts |
| Power Source | Battery Powered |
| Battery Type | 2 Lithium Ion batteries (included) |
| Speaker Battery Capacity | 4000 mAh (approx. 7 hours playtime) |
| Microphone Battery Capacity | 2200 mAh |
| Connectivity Technology | Bluetooth 5.0 |
| Number of Channels | 2 (Stereo) |
| Audio Input | Bluetooth, USB, Micro SD Card, AUX (3.5mm), Wireless Microphone, Wired Microphone |
| Item Weight | 6 Kilograms (13.2 pounds) |
| Package Dimensions | 16.3 x 16.1 x 9.29 inches |

| Feature | Detail |
|-----------------|----------------------|
| Color | Metallic |
| Manufacturer | MIFA INNOVATIONS LLC |
| First Available | December 30, 2020 |

10. WARRANTY AND SUPPORT

MIFA products are designed and manufactured to the highest quality standards. For information regarding warranty coverage, technical support, or service inquiries, please refer to the warranty card included in your package or visit the official MIFA website. Please retain your proof of purchase for warranty claims.

© 2023 MIFA INNOVATIONS LLC. All rights reserved.

Related Documents - M520

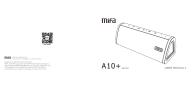
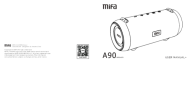
| | |
|---|---|
|  | <p>Mifa A90 راهنمای کاربر بلندگوی بلوتوثی قابل حمل</p> <p>شامل هشدارهای ایمنی، محتویات جعبه، عملکرد دکمه‌ها، Mifa A90 راهنمای جامع برای بلندگوی بلوتوثی مشخصات فنی و راهنمای عیب‌یابی. این دفترچه راهنما به شما کمک می‌کند تا از TWS نحوه اتصال بلوتوث و اسپیکر خود به بهترین نحو استفاده کنید.</p> |
|  | <p>Mifa A10+ Bluetooth Speaker User Manual</p> <p>Comprehensive user manual for the Mifa A10+ Bluetooth Speaker, covering setup, functions, specifications, and troubleshooting.</p> |
|  | <p>Mifa A90 Portable Bluetooth Speaker User Manual</p> <p>Explore the Mifa A90 Portable Bluetooth Speaker user manual. Learn about its features, including True Wireless Stereo (TWS), versatile connectivity via Bluetooth, Micro SD, USB, and Aux-in, and an 8000mAh battery. This guide covers setup, key functions, port details, and troubleshooting for optimal audio experience.</p> |

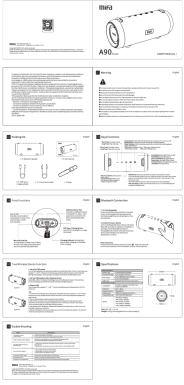

[Mifa A90 Portable Bluetooth Speaker User Manual](#)

Explore the Mifa A90 Portable Bluetooth Speaker user manual for detailed instructions on setup, key functions, port usage, Bluetooth connection, True Wireless Stereo (TWS) pairing, specifications, and troubleshooting. Learn how to optimize your audio experience with this high-quality portable speaker.



[Mifa WildBox Quick Start Guide](#)

A quick start guide for the Mifa WildBox speaker, covering power on, Bluetooth connection, mode switching, playback control, lighting modes, PARTYADD and TWS pairing, battery information, and technical specifications.



[MIFA A60 Bluetooth Speaker User Manual](#)

Comprehensive user manual for the MIFA A60 Bluetooth Speaker, covering setup, features, specifications, and troubleshooting. Learn how to connect, use TWS, and manage your speaker.

