

PXN PXN-V9

PXN V9 Gaming Racing Wheel User Manual

Model: PXN-V9

1. INTRODUCTION

The PXN V9 Gaming Racing Wheel is a versatile and immersive peripheral designed for an enhanced racing simulation experience across multiple platforms. This manual provides detailed instructions for setting up, operating, maintaining, and troubleshooting your racing wheel system.



Figure 1: PXN V9 Gaming Racing Wheel, including the steering wheel, pedals, and shifter.

2. PRODUCT COMPONENTS

Your PXN V9 Gaming Racing Wheel package includes the following components:

- **Steering Wheel:** The main control unit with integrated buttons and paddle shifters.
- **Foot Pedals:** A three-pedal unit (throttle, brake, clutch) for realistic driving input.
- **Manual Shifter:** A six-speed "H" gearbox shifter for precise gear changes.
- **Fixed Clamps (x2):** For securely mounting the steering wheel to a desk or table.
- **User Manual:** This instruction guide.

In the Box



Steering Wheel



Foot Pedals



User Manual



Fixed Clamp x 2



Manual Shifter

Figure 2: All components included in the PXN V9 Gaming Racing Wheel package.

3. SETUP GUIDE

3.1. PC Setup and Testing (D-Input Mode)

To ensure proper functionality on PC, follow these steps to switch to D-Input mode and test the wheel:

1. Plug the PXN V9 wheel into your PC.
2. Long press the "MODE" button on the wheel for 3 seconds to change to D-Input mode.

3. On your PC, go to "Settings" and search for "Game Controllers".
4. Click on "PXN-V9 Wheel" and then "Properties" to open the test page.
5. Test the functions of the PXN V9 (steering, buttons, pedals) on the "Properties" page to confirm proper operation.

Your browser does not support the video tag.

Video 1: PXN V9 Racing Wheel Switching Mode (D-Input) and Testing on PC. This video demonstrates how to switch the wheel to D-Input mode and verify its functions through the PC's game controller settings.

3.2. Xbox Console Setup

To connect your PXN V9 Racing Wheel to an Xbox console, follow these steps:

1. Ensure the original Xbox controller is turned off and its indicator light is not on.
2. Connect the original Xbox controller to the wheel's boot connector using a data cable.
3. Connect the USB interface of the steering wheel to the Xbox console.
4. Press the power button on the Xbox console to start it.
5. After the console starts, press the "MODE" button on the steering wheel. The wheel should now be recognized by the console.
6. Note: If the steering wheel is not equipped with a shifter, it will be recognized as the standard controller mode. For technical reasons, only this mode currently supports vibration feedback.



Figure 3: Connection diagram for Xbox and PlayStation consoles, showing the original controller connected to the wheel, and the wheel connected to the console.

Your browser does not support the video tag.

Video 2: PXN V9 connects Xbox console to play Forza Horizon 5. This video illustrates the connection process and in-game usage on an Xbox console.

3.3. ETS 2 (Euro Truck Simulator 2) Setup for PC

For optimal experience in Euro Truck Simulator 2, configure your PXN V9 wheel as follows:

1. After plugging the PXN V9 wheel into the PC, it defaults to X-input mode. Long press the "MODE" button for 3 seconds to switch to D-input mode, or switch it manually via the PXN Wheel app.
2. Enter the game (ETS 2) and navigate to "Options" then "Controls".
3. Click "Keyboard + PXN - V9" on the "Controls" page.

4. Click "Input wizard" -> "Controllers" -> "Steering Wheel".
5. Click "H-Shifter" (If you want to use automatic shifter, please click "Simple Automatic").
6. Click "Range - Splitter".
7. Click "Steering axis" and turn the PXN V9 wheel to bind the steering of it to in-game steering.
8. Click "Acceleration" and "Brake" and then step on the accelerator and brake pedal respectively.
9. Click "Clutch" and then step on the clutch pedal to bind to the clutch function.
10. Select "Normal" as the mode of the accelerator and brake pedals, and "Centred" as the mode of clutch pedal.
11. Click "Next" to bind to the H-shifter function.
12. Click "Shifter Position", then shift the corresponding gear on the shifter.
13. Click "Shifter Toggle:1" and then press the button on the left of the shifter to bind to the low/high gear function.
14. Please set up other game functions on "Options - KEYS & BUTTONS" page if necessary.

Your browser does not support the video tag.

Video 3: PXN V9 & ETS 2 for PC Setup Tutorial Video. This comprehensive video guides you through setting up the PXN V9 wheel for Euro Truck Simulator 2 on PC, including H-shifter configuration.

3.4. Wheel Calibration

To calibrate your PXN V9 Racing Wheel, follow these steps:

1. Switch the steering wheel to 270 degrees.
2. Press the four buttons L1, L2, R1, and R2 at the same time.
3. The red indicator light will flash quickly and then release.
4. Turn the steering wheel fully left to the end, then fully right to the end.
5. From right to left, step the accelerator pedal, brake pedal, and clutch pedal to the end in turn.
6. Finally, press the option button. The red indicator will be always on, and the calibration is completed.

Your browser does not support the video tag.

Video 4: PXN V9 Calibration Tutorial. This video provides a step-by-step guide on how to calibrate your PXN V9 Racing Wheel for accurate performance.

4. OPERATING INSTRUCTIONS

4.1. Steering Angle Adjustment (270/900 Degree)

The PXN V9 allows for quick switching between 270-degree and 900-degree steering angles to adapt to different racing and driving simulation games. A quick switch is designed under the dial surface for easy access.

One-Touch Steering Angle Switching

Physically switch between 270° and 900° steering.



Figure 4: One-touch steering angle switching mechanism on the PXN V9 wheel.

4.2. Dual Motor Vibration

The racing wheel features built-in dual motors that simulate real driving scenes through different levels of vibration. This enhances immersion by providing tactile feedback for road conditions and impacts. (NOTE: This is NOT force feedback).

Dual-Motor Vibrations

Built-in dual vibration motor, simulating real road conditions, more realistic.

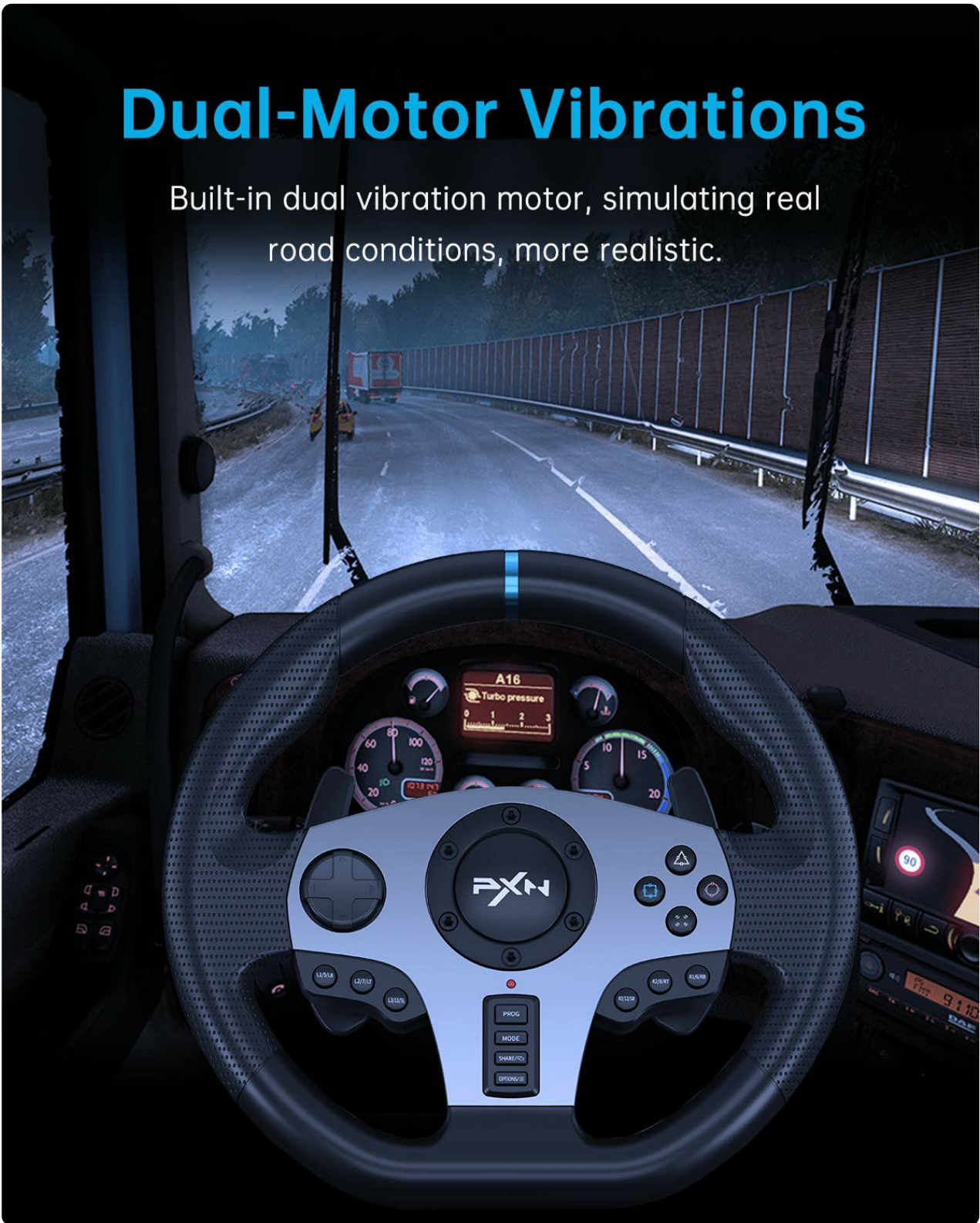

Figure 5: Illustration of the dual-motor vibration feature providing realistic feedback during gameplay.

4.3. Pedals and Shifter Usage

The responsive floor pedals (throttle, brake, clutch) and the six-speed manual shifter provide a realistic driving experience. The "H" gearbox allows for quick and smooth shifting.

- **Pedals:** Use the throttle for acceleration, brake for deceleration, and clutch for manual gear changes. The pedals are retractable for easy storage and feature rubber feet for stability.
- **Shifter:** To use the shifter on PC, you need to press and hold the MODE button for 3 seconds to switch to "D-Input" mode, and then set the gear function in the game. The shifter also includes high/low gear switching and a handbrake switch. To engage reverse gear, press down the gear lever vertically and move it to the 6th gear position.

Responsive Floor Pedals

with Throttle, Brake and Clutch



Retractable pedals for easy storage and rubber feet.

Figure 6: Responsive floor pedals with labeled throttle, brake, and clutch pedals.

6-Speed Manual Shifter

6-Speed shifter and reverse pushrod
"H" shifter for fast and smooth shifting.

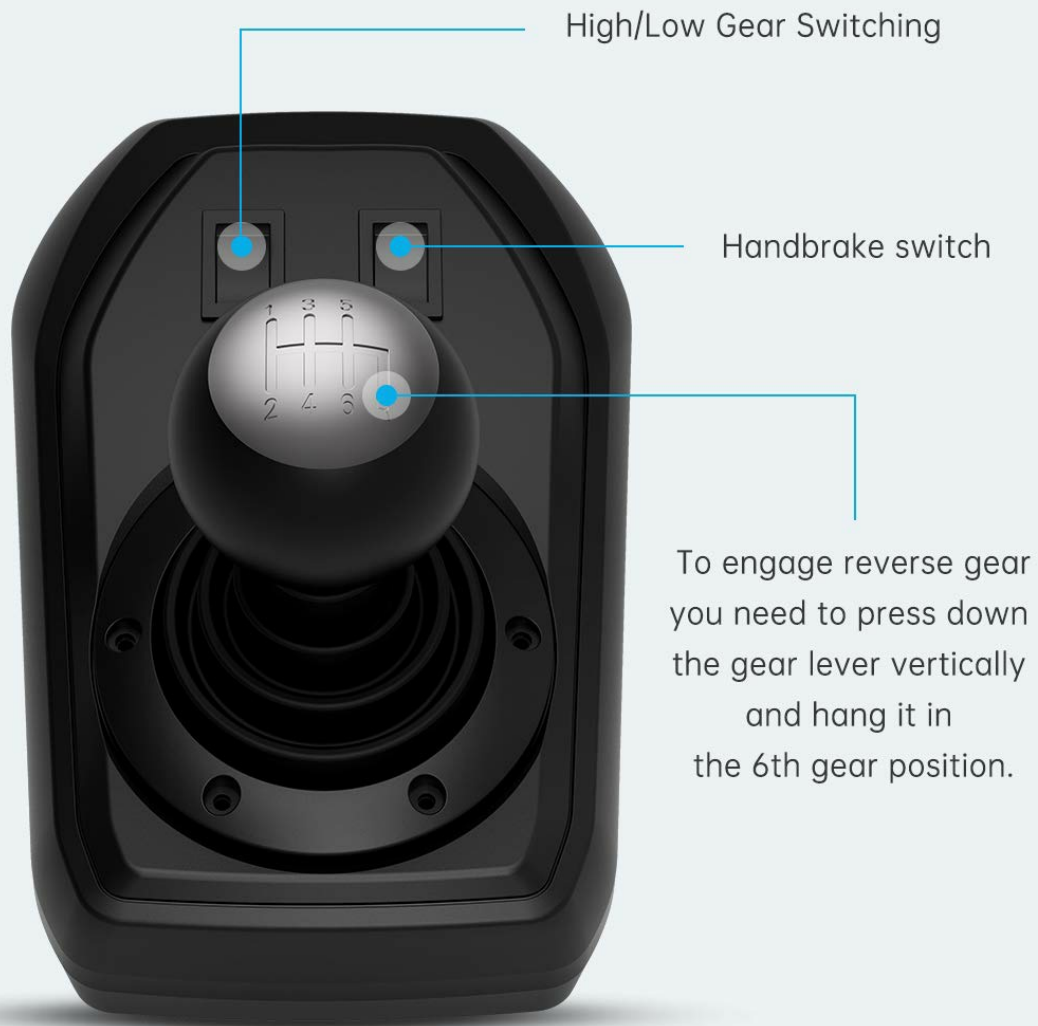

Figure 7: Detailed view of the 6-speed manual shifter, highlighting its features.

4.4. PXN Wheel App

For a better user experience, it is highly recommended to download the exclusive application "PXN Wheel" for the racing steering wheel. This app allows you to:

- View instructions for the steering wheel.
- Adjust the steering angle.
- Adjust sensitivity.
- Adjust vibration intensity.
- Apply game preset keys.

- Test functions.

V9 Tools Application

Support adjusting steering sensitivity
steering angle, and vibration level.
Apply game preset keys and test function.

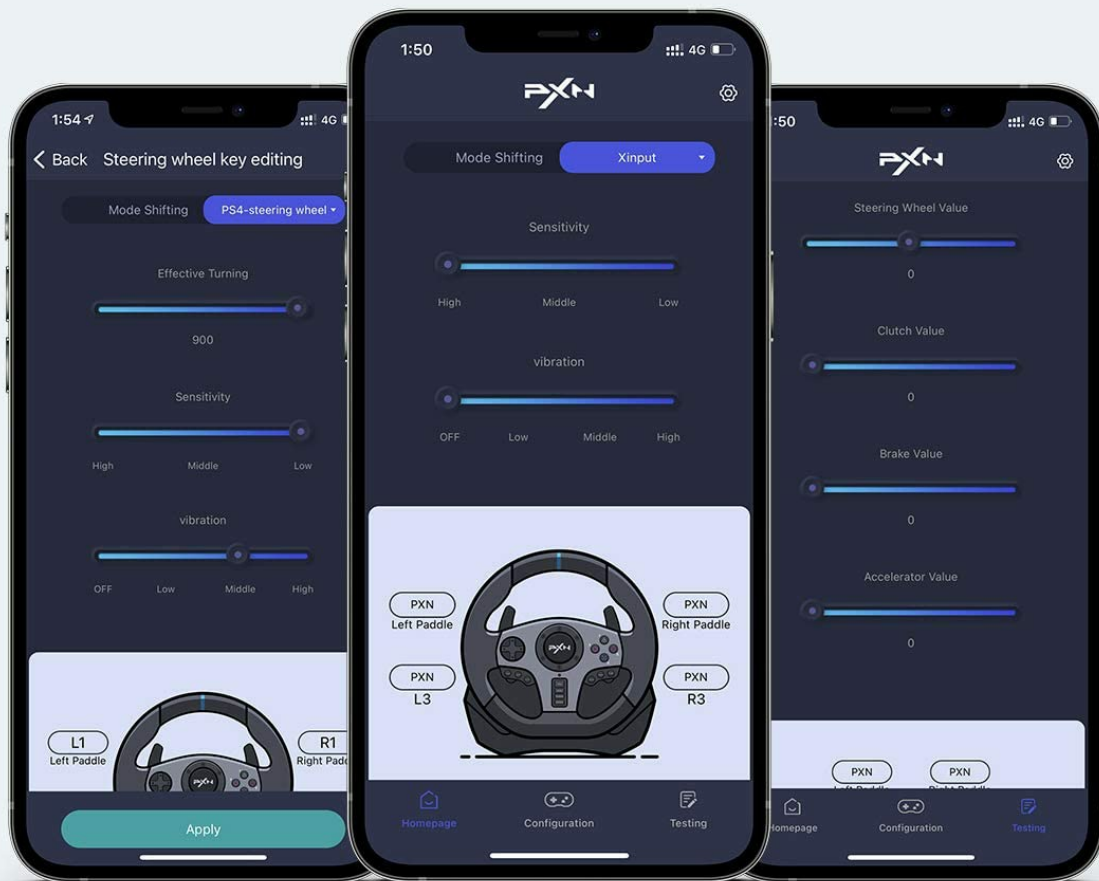

Figure 8: The PXN Wheel App provides comprehensive control and customization options for your racing wheel.

5. MAINTENANCE

To ensure the longevity and optimal performance of your PXN V9 Gaming Racing Wheel, follow these maintenance guidelines:

- **Cleaning:** Use a soft, dry cloth to wipe down the steering wheel, pedals, and shifter. Avoid using abrasive cleaners

or solvents that could damage the surfaces.

- **Storage:** When not in use, store the racing wheel system in a cool, dry place away from direct sunlight and extreme temperatures.
- **Cable Management:** Avoid sharp bends or kinks in the cables to prevent damage. Use cable ties to keep them organized.
- **Handle with Care:** While durable, avoid dropping or subjecting the components to excessive force.

6. TROUBLESHOOTING

If you encounter issues with your PXN V9 Gaming Racing Wheel, refer to the common problems and solutions below:

Problem	Solution
Q: Why can't PXN V9 wheel turn in sync with the steering wheel in the game?	A: Please check if the steering wheel mode is D-input mode, then set up the sensitivity to the minimum and the gear switch to 900°.
Q: Why can the mouse be controlled by turning the steering wheel?	A: Click "Options" → "Controls" → "Controller" → "Reset".
Q: Why does the steering wheel have no vibration in the game?	A: Please download the V9 driver from PXN official website and install it on the PC, then the vibration function will be available after entering the game.

7. SPECIFICATIONS

Feature	Detail
Model Number	PXN-V9
Brand	PXN
Compatibility	Windows 7/8/10, Xbox One, Xbox Series X/S, PlayStation 4, PlayStation 4 Slim, PlayStation 4 Pro, PlayStation 3, Nintendo Switch
Steering Angle	270/900 Degree (One-Touch Switch)
Vibration	Double Motor Vibration (Not Force Feedback)
Shifter	6-Speed Manual Shifter ("H" gearbox)
Pedals	Responsive Floor Pedals (Throttle, Brake, Clutch)
Companion App	PXN Wheel App (for sensitivity, vibration, key mapping)

Feature	Detail
Item Weight	13.22 pounds
Product Dimensions	11.02 x 13.39 x 11.22 inches
Country of Origin	China
Date First Available	November 5, 2020

8. WARRANTY AND SUPPORT

For warranty information, technical support, or service inquiries, please refer to the official PXN website or contact their customer support directly. Keep your purchase receipt as proof of purchase for warranty claims.

Official User Manual (PDF): [Download PDF](#)