

Manuals+

[Q & A](#) | [Deep Search](#) | [Upload](#)

[manuals.plus](#) /

› [FLAMMA](#) /

› [FLAMMA FC01 Looper Pedal Drum Machine User Manual](#)

FLAMMA FC01

FLAMMA FC01 Looper Pedal Drum Machine User Manual

Model: FC01

Brand: FLAMMA

1. INTRODUCTION AND OVERVIEW

The FLAMMA FC01 is a compact and versatile 2-in-1 guitar pedal, combining a looper and a drum machine. Designed for musicians seeking to enhance their practice, recording, and live performance, it offers extensive looping capabilities and a variety of rhythmic accompaniments. This manual provides detailed instructions for setup, operation, and maintenance of your FC01 pedal.



Figure 1.1: Front view of the FLAMMA FC01 Looper Pedal Drum Machine.

2. KEY FEATURES

- **3 Modes in One:** Seamlessly switch between Drum, Looper, and combined Drum Looper modes to suit your musical needs.
- **Extended Loop Time:** Offers up to 20 minutes of loop recording time with unlimited overdub recordings, providing ample space for creative expression.
- **Diverse Drum Grooves:** Features 8 distinct drum groove styles with 16 variations, covering a wide range of musical genres.
- **Tap Tempo Function:** Easily adjust the tempo of the drum machine by tapping the footswitch.
- **True Bypass:** Ensures your guitar's original tone remains unaffected when the pedal is disengaged.
- **Compact Mini Design:** Space-saving design fits easily on any pedalboard.

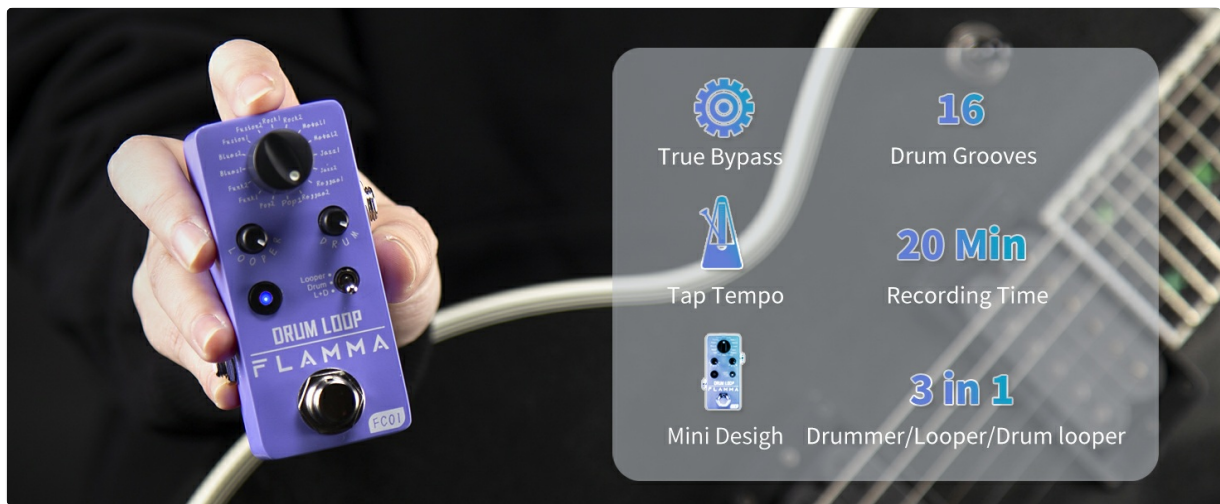

Figure 2.1: Overview of FC01's main features including True Bypass, Tap Tempo, 20 Min Recording Time, 16 Drum Grooves, and 3-in-1 functionality.

3. CONTROLS AND FUNCTIONS

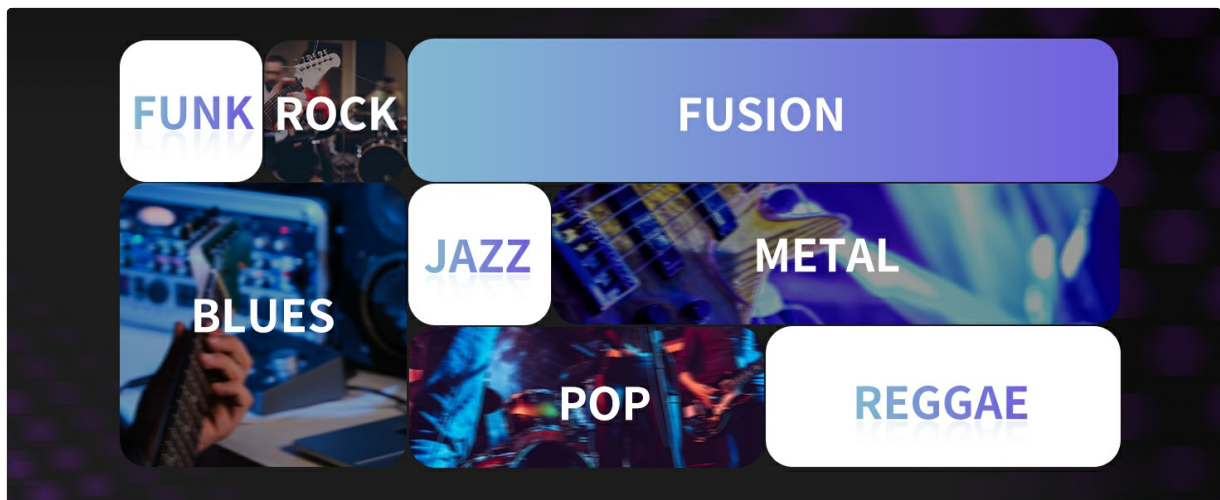

Figure 3.1: Detailed diagram of the FC01's controls and connections.

1. Rhythm Style Selector: This rotary knob allows you to choose from 8 distinct drum groove styles, each with 2 variations, totaling 16 different rhythms. Turn the knob to select your desired rhythm.

2. Looper Level: Adjusts the playback volume of your recorded loops. Turn clockwise to increase volume, counter-clockwise to decrease.

3. Drum Level: Controls the master volume of the drum machine. Turn clockwise to increase volume, counter-clockwise to decrease.

4. Tap Tempo: This button/function allows you to set the tempo of the drum machine. Repeatedly press the footswitch in time with your desired tempo.

5. Mode Switch: A three-position toggle switch to select the operational mode of the FC01:

- **Looper:** Activates only the looper function.
- **Drum:** Activates only the drum machine function.
- **L+D (Looper + Drum):** Activates both the looper and drum machine simultaneously.

6. Footswitch: The primary control for recording, playback, overdubbing, and stopping. Its function changes based on the selected mode and the duration/number of presses.

7. DC IN: Power input jack. Connect a 9V DC power supply with a minimum of 210mA and a center-negative polarity. (Power supply not included).

8. Input: Audio input jack. Connect your instrument (e.g., guitar) or other pedals to this input using a 6.35mm mono

jack cable.

9. Output: Audio output jack. Connect this output to your amplifier or the next pedal in your signal chain using a 6.35mm mono jack cable.

4. SETUP GUIDE

1. **Power Connection:** Connect a 9V DC, center-negative power supply (minimum 210mA) to the DC IN jack on the pedal. Ensure the power supply meets these specifications to prevent operational issues.
2. **Instrument Connection:** Connect your guitar or other audio source to the INPUT jack of the FC01 using a standard 1/4-inch (6.35mm) mono instrument cable.
3. **Amplifier Connection:** Connect the OUTPUT jack of the FC01 to your amplifier's input or to the next pedal in your signal chain using another 1/4-inch (6.35mm) mono instrument cable.
4. **Initial Power-Up:** Once all connections are secure, power on your amplifier and then the FC01 pedal. The LED indicator will illuminate.



Figure 4.1: Physical dimensions of the FC01 pedal (83mm x 47mm x 52mm).

5. OPERATING INSTRUCTIONS

5.1. Drum Mode Operation

In Drum mode, the FC01 functions solely as a drum machine, providing rhythmic accompaniment without looping capabilities.

- **Selecting Drum Mode:** Set the Mode Switch to the "Drum" position.
- **Choosing Rhythms:** Use the Rhythm Style Selector knob to cycle through the 8 drum groove styles and their 16 variations.
- **Adjusting Drum Volume:** Use the Drum Level knob to set the desired volume for the drum track.
- **Starting/Stopping Drums:** Single press the footswitch to start or stop the drum playback.
- **Setting Tempo (Tap Tempo):** While the drums are playing, repeatedly tap the footswitch at your desired tempo. The pedal will adjust the drum speed accordingly.



Figure 5.1.1: Table of available drum styles, rhythms, and their default tempos.

5.2. Looper Mode Operation

In Looper mode, the FC01 functions as a dedicated looper pedal, allowing you to record, playback, and overdub guitar phrases.

- **Selecting Looper Mode:** Set the Mode Switch to the "Looper" position.
- **Adjusting Looper Volume:** Use the Looper Level knob to set the desired playback volume for your loops.
- **Recording:** Single press the footswitch to start recording. The LED will turn red.
- **Playback:** Single press the footswitch again to stop recording and begin playback. The LED will turn blue.
- **Overdubbing:** While a loop is playing, single press the footswitch to start overdubbing. The LED will flash red. Single press again to stop overdubbing and return to playback (LED blue).
- **Undo/Redo:** Press and hold the footswitch for 1.5 seconds to undo the last overdub. Press and hold again for 1.5 seconds to redo.
- **Stop Playback:** Double-tap the footswitch to stop playback. The LED will turn off.
- **Clear Loop:** While playback is stopped, press and hold the footswitch for 1.5 seconds to clear the current loop.

5.3. Drum Looper Mode (L+D) Operation

In L+D mode, both the looper and drum machine functions are active, allowing you to record loops over a drum beat.

- **Starting Drums and Recording:** Single press the footswitch to start the drum machine and simultaneously begin recording your first loop. The LED will turn red.
- **Stopping Recording and Playback:** Single press the footswitch again to stop recording and begin

playback of your loop with the drum track. The LED will turn blue.

- **Overdubbing:** While the loop and drums are playing, single press the footswitch to start overdubbing. The LED will flash red. Single press again to stop overdubbing and return to playback (LED blue).
- **Undo/Redo:** Press and hold the footswitch for 1.5 seconds to undo the last overdub. Press and hold again for 1.5 seconds to redo.
- **Stop Playback:** Double-tap the footswitch to stop both loop and drum playback. The LED will turn off.
- **Clear Loop:** While playback is stopped, press and hold the footswitch for 1.5 seconds to clear the current loop and stop the drum machine.
- **Adjusting Volumes:** Use the Looper Level and Drum Level knobs independently to balance the volumes of your loop and the drum track.
- **Setting Tempo (Tap Tempo):** While the drums are playing, repeatedly tap the footswitch at your desired tempo. The pedal will adjust the drum speed accordingly.



Figure 5.3.1: The footswitch is used for various control functions.

6. MAINTENANCE

- **Cleaning:** Use a soft, dry cloth to clean the pedal's exterior. Avoid using abrasive cleaners or solvents, which may damage the finish or internal components.
- **Power Supply:** Always use a regulated 9V DC, center-negative power supply with a minimum current output

of 210mA. Using an incorrect power supply can damage the unit and void the warranty.

- **Storage:** When not in use for extended periods, disconnect the power supply and store the pedal in a dry, cool environment away from direct sunlight and extreme temperatures.
- **Connections:** Periodically check all cable connections for wear and tear. Ensure cables are securely plugged in during operation.

7. TROUBLESHOOTING

Problem	Possible Cause	Solution
Pedal does not power on.	Incorrect power supply voltage or polarity; insufficient current; faulty power cable.	Ensure a 9V DC, center-negative power supply with at least 210mA is used. Check power cable connection.
No sound output.	Incorrect cable connections; Looper/Drum Level knobs set to minimum; amplifier off or volume low.	Verify all audio cables are correctly connected (Input/Output). Increase Looper Level and Drum Level. Check amplifier power and volume.
Loop recording or playback issues.	Loop memory full (unlikely with unlimited recordings, but possible if unit is faulty); incorrect footswitch timing.	Ensure proper footswitch timing for record/playback/overdub. Try clearing the loop and re-recording.
Drum machine not playing or incorrect tempo.	Drum Level set to minimum; incorrect mode selected; tempo not set correctly.	Increase Drum Level. Ensure Mode Switch is set to "Drum" or "L+D". Use Tap Tempo to set desired rhythm.

8. SPECIFICATIONS

- **Model:** FC01
- **Dimensions (L x W x H):** 3.27 x 1.85 x 2.05 inches (83mm x 47mm x 52mm)
- **Weight:** 5.4 ounces (153 Grams)
- **Power Requirement:** 9V DC, center-negative, minimum 210mA (Power supply not included)
- **Loop Recording Time:** Up to 20 minutes
- **Drum Grooves:** 8 styles, 16 variations
- **Sampling Rate:** 44.1kHz/16Bit
- **Material:** Metal casing
- **Bypass:** True Bypass

9. WARRANTY AND SUPPORT

For detailed warranty information, product registration, and technical support, please visit the official FLAMMA website or contact their customer service department. Keep your purchase receipt as proof of purchase for any warranty claims.

Official FLAMMA Website: [Visit the FLAMMA Store on Amazon](#)

