

Manuals+

[Q & A](#) | [Deep Search](#) | [Upload](#)

manuals.plus /

- › [Tieasy](#) /
- › [Tieasy Range Hood Replacement Charcoal Filter \(USGDCF-G\) User Manual](#)

Tieasy CF-G

Tieasy Range Hood Replacement Charcoal Filter (USGDCF-G) User Manual

PRODUCT OVERVIEW

This manual provides instructions for the installation, operation, and maintenance of the Tieasy USGDCF-G Replacement Charcoal Filter. This filter is designed to assist in ventilating and purifying air in your kitchen by absorbing odors and grease particles when your range hood is set to recirculating mode. Regular replacement ensures optimal performance of your range hood.

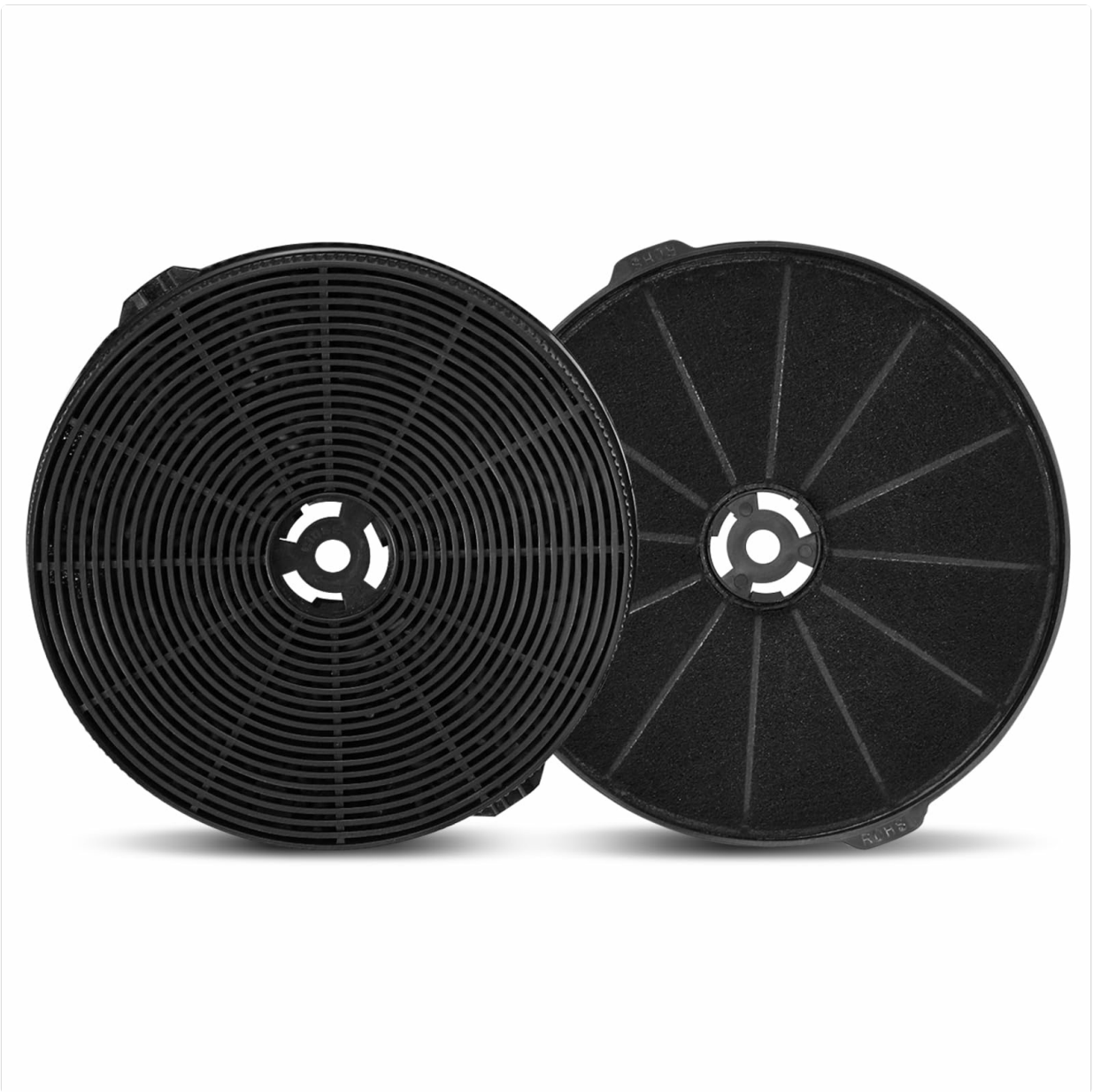

Image: Tieasy USGDCF-G Replacement Charcoal Filter, showing its circular design.

PRODUCT DIMENSIONS

The Tieasy USGDCF-G charcoal filter has specific dimensions to ensure proper fit within compatible range hood models. Please verify these dimensions against your existing filter or range hood specifications before installation.

size

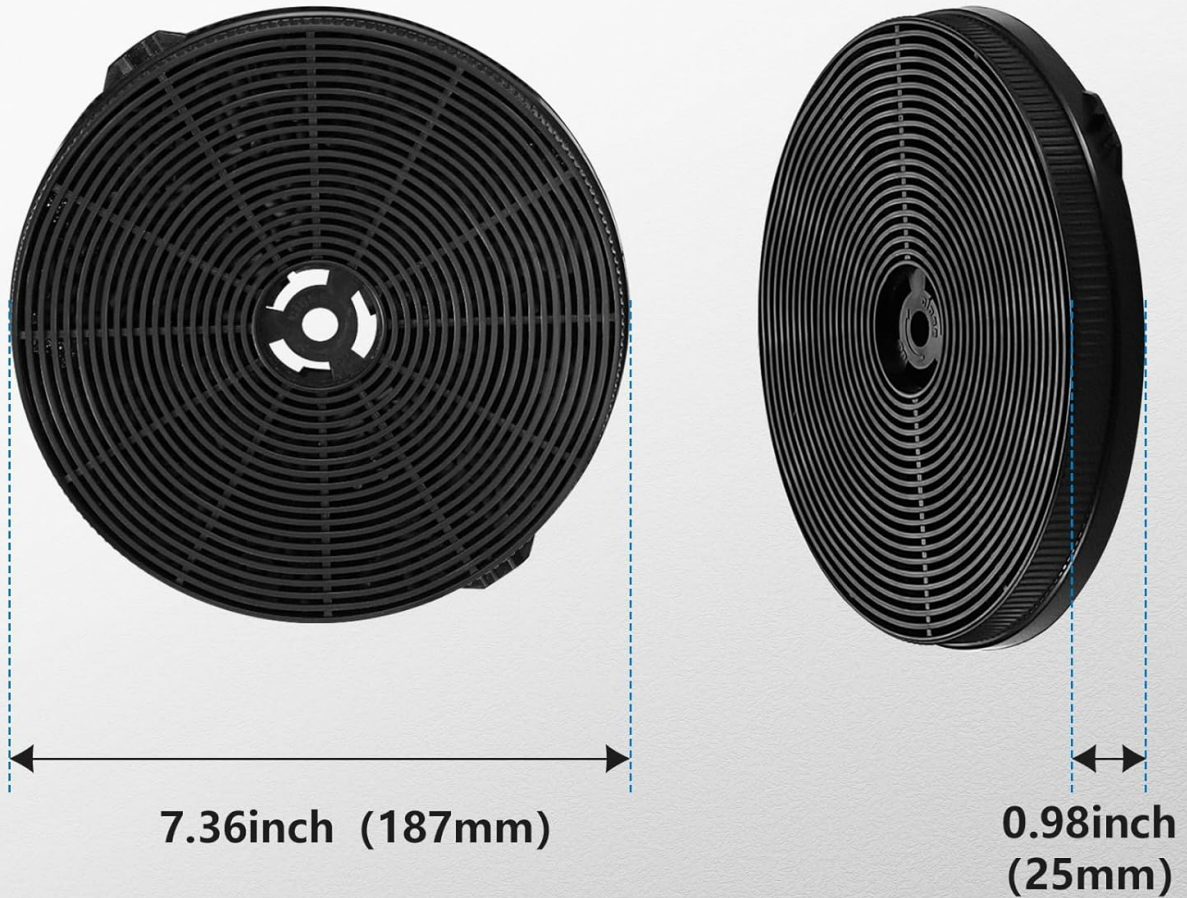

Image: Diagram illustrating the dimensions of the charcoal filter. The filter has a diameter of 7.36 inches (187mm) and a thickness of 0.98 inches (25mm).

COMPATIBLE RANGE HOOD MODELS

This replacement charcoal filter (model CF-G) is specifically designed for use with the following Tieasy range hood models:

- Tieasy GD10
- Tieasy TD10
- Tieasy GI02
- Tieasy TI02
- Tieasy USGD1090
- Tieasy USGD1075
- Tieasy USGD1875B
- Tieasy USGD0775
- Tieasy USGI0290A
- Tieasy USGI1775B
- Tieasy USGI0275BCP

- Tieasy USGI1690
- Tieasy USGI0290B
- Tieasy USGD2875

Compatible Models



Image: Visual representation of compatible Tieasy range hood models including USGD1090, USGD1075, USGD1875B, and USGD0775.

Compatible Models



Image: Visual representation of additional compatible Tieasy range hood models including USGI0290A, USGI1775B, USGI0275BCP, USGI1690, USGI0290B, and USGD2875.

INSTALLATION INSTRUCTIONS

Follow these steps to install the Tieasy Replacement Charcoal Filter. No special tools are required for installation.

Installation Instructions



Step 1

Remove the Baffle Filters

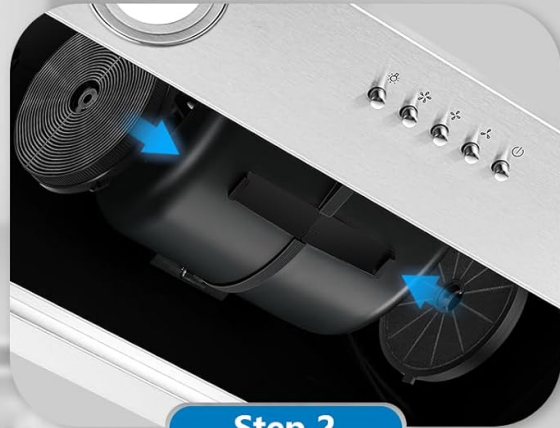

Step 2

Align one of the filters with the right side of the motor.



Step 3

Twist and lock the filter into place.

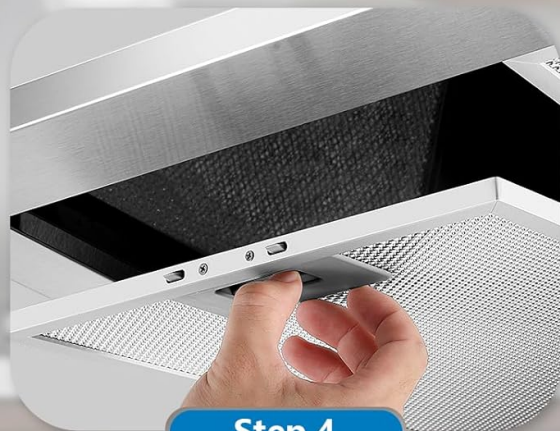

Step 4

Repeat on the left side of the motor. Reinstall the baffle filters.

Image: Four-step visual guide for installing the charcoal filter into a range hood.

1. **Step 1: Remove the Baffle Filters.** Carefully detach and remove the existing baffle filters from your range hood to access the motor area.
2. **Step 2: Align the Filter.** Take one charcoal filter and align it with the right side of the range hood motor. Ensure the filter's central opening matches the motor's shaft.
3. **Step 3: Twist and Lock.** Gently twist the filter clockwise until it locks securely into place on the motor.
4. **Step 4: Repeat and Reinstall.** Repeat Steps 2 and 3 for the left side of the motor with the second charcoal filter. Once both filters are installed, reinstall the baffle filters into their original positions.

OPERATION

Once installed, the charcoal filters work automatically when the range hood is operating in recirculating (ductless) mode. Air drawn into the hood passes through the charcoal filters, which absorb cooking odors and grease before the air is recirculated back into the kitchen. The effectiveness of the filter depends on the fan speed and the duration of use.

MAINTENANCE AND REPLACEMENT

Charcoal filters are not washable and must be replaced periodically to maintain effective odor and grease absorption. The lifespan of the carbon filter varies depending on cooking frequency, type of cooking, and kitchen conditions. It is generally recommended to replace the charcoal filters every 3 to 6 months. If you notice a decrease in odor absorption or increased noise from the range hood, it may be time for a replacement.

TROUBLESHOOTING

- **Filter does not fit:** Double-check the model number of your range hood against the list of compatible models. Ensure the filter is aligned correctly with the motor shaft before twisting to lock. Refer to the dimensions section to confirm the filter size.
- **Poor odor absorption:** If the filter is new and odors persist, ensure the range hood is operating in recirculating mode (if applicable) and that the fan speed is appropriate for the cooking task. If the filter has been in use for several months, it likely needs replacement.
- **Increased noise from range hood:** An improperly installed or clogged filter can sometimes cause increased noise. Ensure the filters are securely locked in place and consider replacing them if they are old.

PRODUCT SPECIFICATIONS

Brand Name	Tieasy
Model Info	CF-G
Item Weight	11.9 ounces (0.34 Kilograms)
Package Dimensions	8.35 x 7.24 x 1.85 inches
Compatible Device	Range Hood
Material Type	Carbon
Air Filter Construction	Panel
Number of Items	1
UPC	754141188140

WARRANTY AND SUPPORT

For warranty information or technical support regarding your Tieasy Range Hood Replacement Charcoal Filter, please refer to the documentation provided with your Tieasy range hood or visit the official Tieasy website. You may also contact Tieasy customer service directly for assistance.

Tieasy Official Store: [Visit the Tieasy Store on Amazon](#)