

[Manuals.plus](#) /

> [gotonovo](#) /

> gotonovo Exposed Bathroom Shower Faucet Wall Mounted Shower System Instruction Manual

gotonovo B08PBQJBS8

Instruction Manual

Product: gotonovo Exposed Bathroom Shower Faucet Wall Mounted Shower System

Model: B08PBQJBS8

Brand: gotonovo

PRODUCT OVERVIEW

The gotonovo Exposed Bathroom Shower Faucet Wall Mounted Shower System is designed to provide a comprehensive showering experience with its multi-function capabilities. This system features a durable solid brass construction with a matte black finish, offering both aesthetic appeal and long-lasting performance. It includes an overhead rainfall shower, a handheld spray, and a tub spout, providing versatile options for your bathing needs.



Image: Complete gotonovo shower system with overhead shower, handheld sprayer, and tub spout.

Key Features:

- **Matte Black Finish:** Durable and stylish finish.
- **3 Functions:** Overhead Rainfall Shower, Handheld Spray, and Tub Tap for versatile use.
- **Material:** Solid brass construction ensures durability. Maximum Flow Rate: 1.4 gpm (5.29 L/min).
- **Control:** Double cross handles for easy control of water temperature and flow. Diverter switches between top shower and hand spray.
- **Adjustable Height:** 8-inch shower head with shower height (slide bar) adjustable from 39 inches - 55 inches (100cm-140cm).
- **Installation:** Wall-mounted with 2-hole installation. Center hole distance is 6 inches (150mm), adjustable from

5 inches - 6.6 inches (13cm-17cm) with included brass adapter.

- **Pressure Balance:** Features a pressure balance cartridge, ensuring consistent water temperature. A separate pressure reducing valve is typically installed on the main water line for the whole house, not individual faucets.

Your browser does not support the video tag.

Video: A brief overview of the gotonovo Exposed Bathtub Shower Set, showcasing its design and functions.

INSTALLATION GUIDE

Proper installation is crucial for the optimal performance and longevity of your shower system. Please follow these instructions carefully. It is recommended to consult a local plumber for professional installation or if you have any doubts.

1. Wall Mounted Installation

The shower system is designed for wall-mounted installation with a 2-hole setup. The standard center hole distance is 6 inches (150mm). An adjustable brass adapter is included to accommodate installation hole distances between 5 inches and 6.6 inches (13cm-17cm).

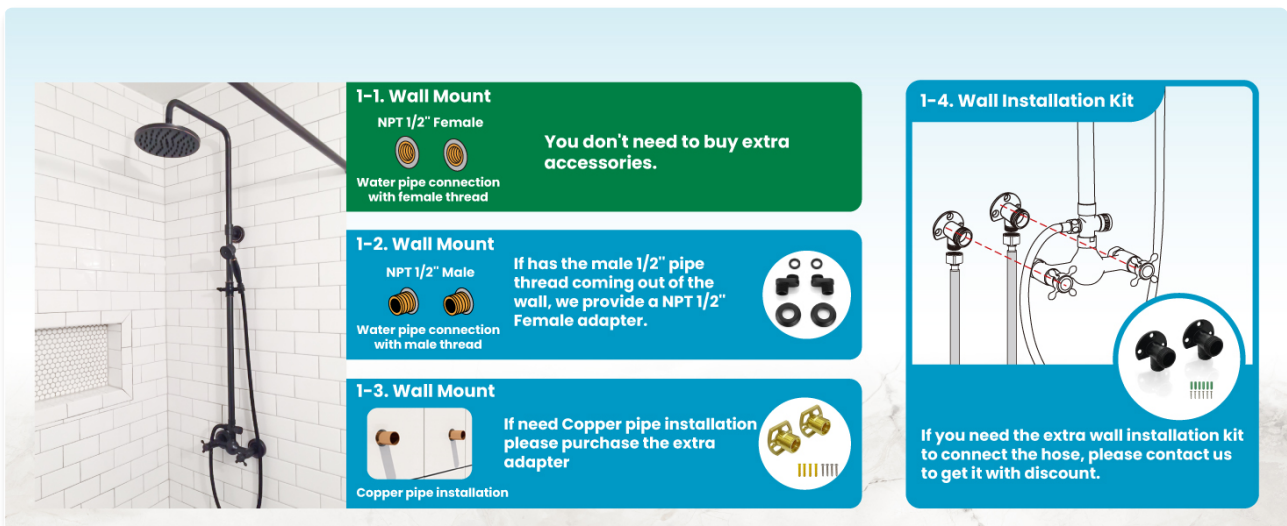

Image: Diagram illustrating various wall mount connection types (NPT 1/2" Female, NPT 1/2" Male with adapter, Copper pipe installation) and the wall installation kit.

- **NPT 1/2" Female Connection:** If your water pipe connection has a female thread, no extra accessories are needed.
- **NPT 1/2" Male Connection:** If your water pipe has a male 1/2" pipe thread coming out of the wall, use the provided NPT 1/2" Female adapter.
- **Copper Pipe Installation:** For copper pipe installations, additional adapters may be required (purchase separately).
- **Wall Installation Kit:** The system comes with all necessary mounting hardware. If an extra wall installation kit is needed to connect the hose, contact customer support for assistance.

2. Tub Mounted Installation (Optional)

For tub mount installations, specific clawfoot bathtub feet and lock nuts are required. These components are not included and must be purchased separately.

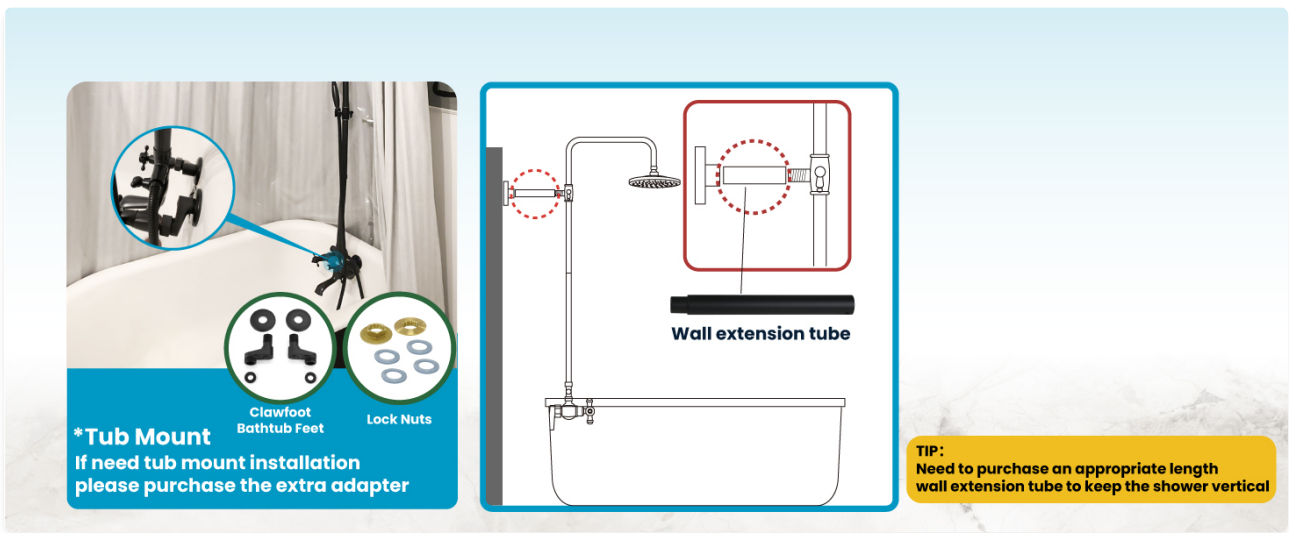

Image: Diagram showing the components required for tub mount installation, including clawfoot bathtub feet and lock nuts. A wall extension tube may be needed to keep the shower vertical.

Important Note: For tub mount installations, you may need to purchase an appropriate length wall extension tube to ensure the shower remains vertical and stable.

3. Height Adjustment and Extension

The shower system features a humanized design allowing for height adjustment to suit individual needs and bathroom dimensions. The shower height (slide bar) is adjustable from 39 inches to 55 inches (100cm-140cm) from the faucet body to the ground.

Adjust the height according to your needs

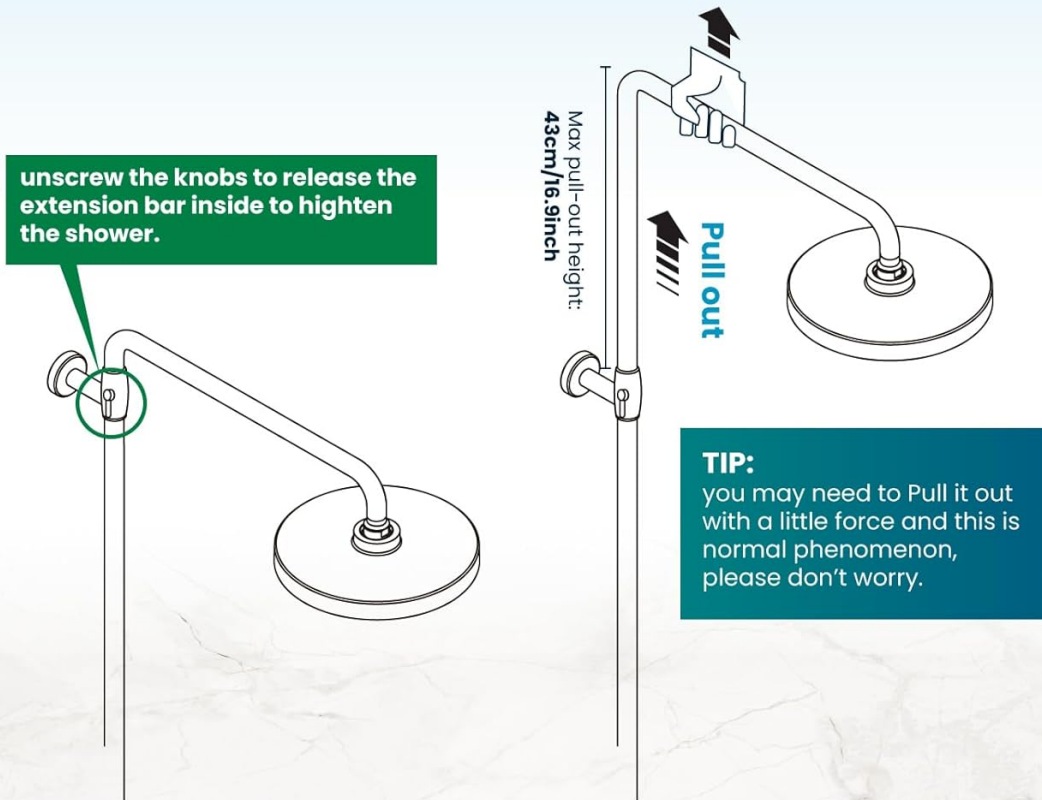

Humanized design

The purpose of this design is to allow our consumer to freely adjust the height of the product according to their needs (bathroom height, height, personal preference).

GOTONOVO

Image: Instructions for adjusting the shower height by unscrewing knobs to release the extension bar. A tip is provided that pulling out the bar may require a little force.

If the shower is too tall, the straight bar can be removed. The height adjustment range without the straight bar is 21 inches to 37 inches. If the shower is still too short after full extension, optional extension tubes (12-inch and 16-inch) can be purchased to add extra height. These can be superimposed for a total of 24 inches (12+12 or 12+16, etc.).

The height adjustment range of the shower is the distance from the faucet body to the ground **+39 inch-55 inch**

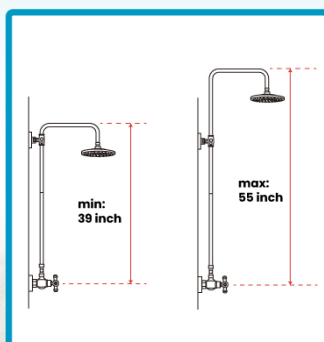

If the shower is too tall, suggest to remove the straight bar
The height adjustment range of the shower is the distance from the faucet body to the ground **+21 inch-37 inch**
Min:21 inch Max:37 inch

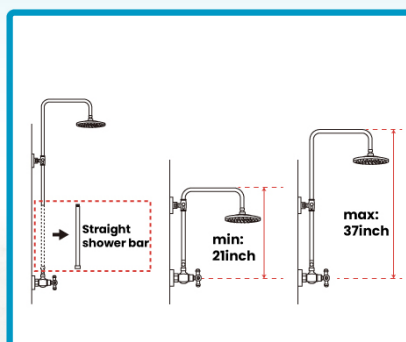

If full extended the shower, it's still short, we provide the extension tube to add the shower height

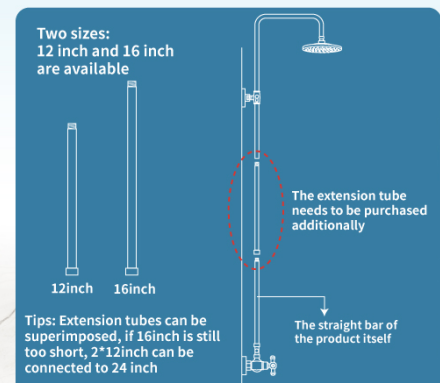

Image: Visual representation of the shower's height adjustment capabilities, including options for removing the straight bar and adding extension tubes for increased height.

OPERATION

Your gotonovo shower system offers three distinct functions for a customized bathing experience.

1. Function Selection

The system features an 8-inch overhead rainfall shower head, a versatile handheld shower spray, and a convenient tub spout. A diverter allows you to easily switch between the overhead shower and the handheld spray. Only one function can be active at a time.

The graphic compares two shower faucet models. On the left, the '3-way shower faucet' (labeled 'This item') is shown against a blue background. It includes an 8-inch rain shower head (A), a handheld shower spray (B), and a bathtub spout (C). On the right, the '2-way shower faucet' is shown against a marble background. It includes an 8-inch rain shower head (A) and a handheld shower spray (B), but lacks a bathtub spout (marked with an 'X'). A central 'VS' graphic is at the top, with a green 'SAME' bar between the two lists of features and a dark grey 'DIFFERENCE' bar below. The ASIN for the 2-way model is B08NP7YDSL.

3-way shower faucet	VS	2-way shower faucet
A 8-inch Rain Shower Head	SAME	A 8-inch Rain Shower Head
B Handheld Shower Spray		B Handheld Shower Spray
C Bathtub Spout	DIFFERENCE	X No Bathtub Spout

This item

ASIN: B08NP7YDSL

Image: Visual comparison of a 3-way shower faucet (this item) with an 8-inch rain shower head, handheld shower spray, and bathtub spout, versus a 2-way shower faucet without a bathtub spout.

2. Water Temperature and Flow Control

The double cross handles provide precise control over both hot and cold water, allowing you to achieve your

desired temperature and flow rate.



HOT

COLD

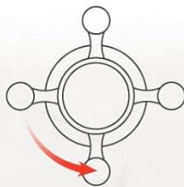

Easy to Operate

2 handle design more precise witch of hot & cold water.

GOTONOVO

Image: Illustration of the hot and cold water controls with the two cross handles, indicating the direction for increasing hot (red arrow) and cold (blue arrow) water.

3. Handheld Shower Spray Usage

The handheld shower spray offers flexibility and convenience. Its shower bar bracket allows for free height adjustment, and the spray head itself can rotate 360 degrees for optimal positioning.

Handheld Shower Spray

NEW
UPGRADE

More Comfortable &
More Elegant

360° rotation

Shower bar bracket
Adjust the height freely

GOTONOVO

Image: Detail of the handheld shower spray, showing its adjustable shower bar bracket and 360-degree rotation capability for user comfort.

CARE AND MAINTENANCE

To maintain the pristine appearance and functionality of your gotonovo shower system, regular cleaning and proper care are recommended.

- **Cleaning:** Clean the matte black finish with a soft, damp cloth. Avoid abrasive cleaners, harsh chemicals, or scouring pads, as these can damage the finish.
- **Water Spots:** The matte black finish is designed to resist water spots and fingerprints, making it easier to keep clean. Wipe down surfaces after each use to prevent mineral buildup.
- **Shower Head Nozzles:** Periodically check and clean the rubber nozzles on the shower head to remove any mineral deposits that may affect water flow. Gently rub the nozzles to dislodge any buildup.



Image: The matte black finish of the shower system, highlighting its resistance to water spots and fingerprints for easier maintenance.

TROUBLESHOOTING

This section addresses common questions and issues you might encounter with your shower system.

Pressure Balance System:

The cartridge inside this shower system provides pressure balance. This means the system requires both hot and cold water supply to function correctly. It does not require an additional pressure valve installed directly on the faucet.

The cartridge inside it makes it pressure balance because it will not work if it doesn't have hot and cold water going to it. That's what it means pressure balanced . **It doesn't need a pressure valve installed on it .**

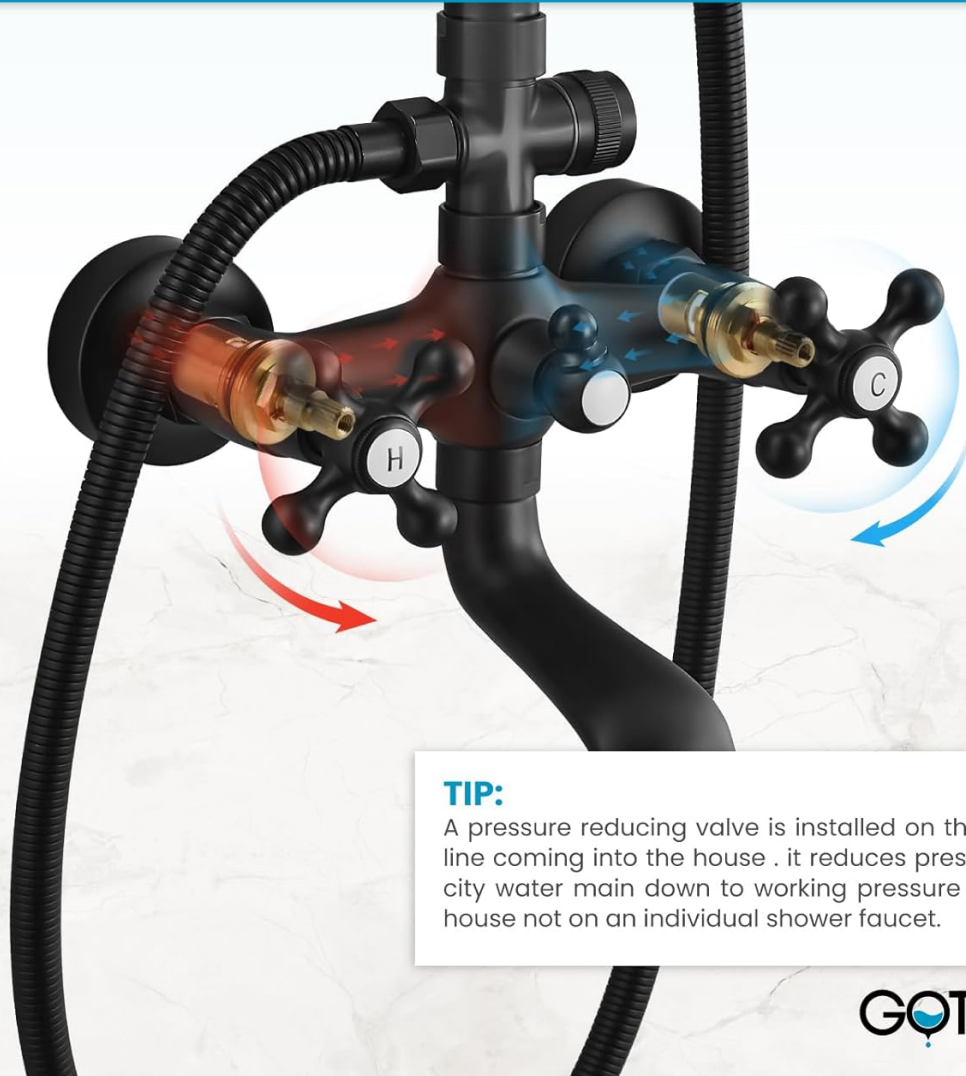

TIP:

A pressure reducing valve is installed on the main water line coming into the house . it reduces pressure from the city water main down to working pressure on the whole house not on an individual shower faucet.

GOTO NOVO

Image: Illustration explaining that the internal cartridge provides pressure balance, meaning the system will not work without both hot and cold water supply. It also clarifies that a separate pressure reducing valve is typically installed on the main house water line, not on an individual faucet.

A pressure reducing valve is typically installed on the main water line entering the house to reduce overall water pressure for the entire household, not for individual faucets. If you experience issues with water pressure or temperature consistency, it is advisable to consult a qualified plumber.

General Issues:

- **Low Water Flow:** Check for mineral buildup in the shower head nozzles or ensure water supply valves are fully open.
- **Leaks:** Ensure all connections are tightened properly. If leaks persist, check the rubber washers and seals for damage.
- **Difficulty Adjusting Height:** As noted in the installation section, pulling out the extension bar may require a little force. Ensure the knobs are sufficiently loosened.

PRODUCT SPECIFICATIONS

Detailed specifications for the gotonovo Exposed Bathroom Shower Faucet Wall Mounted Shower System.

Product Size

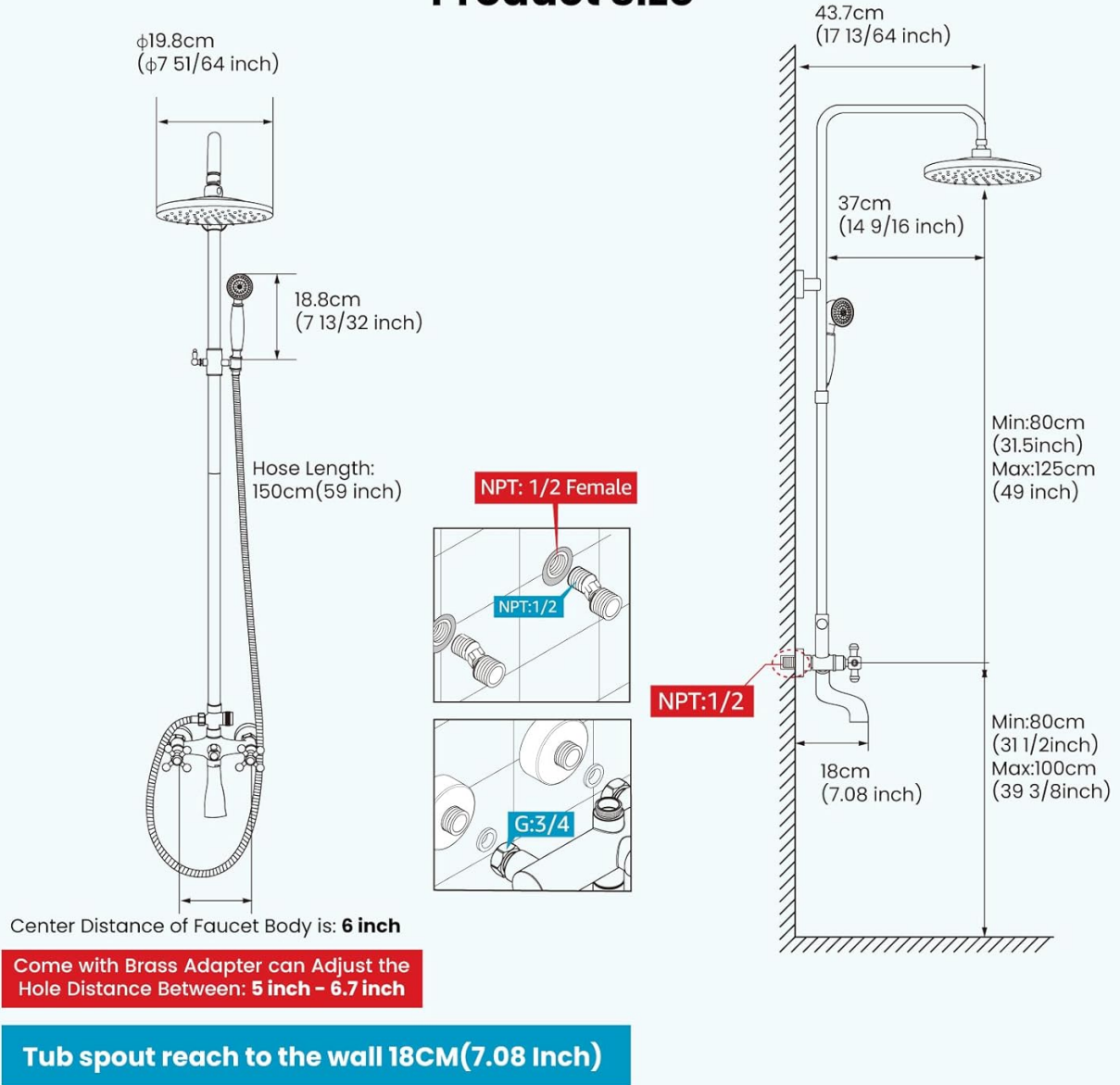

Image: Technical drawing showing detailed dimensions of the shower system, including shower head diameter, hose length, faucet body center distance, and overall height adjustments.

Attribute	Value
Brand	gotonovo
Model Number	B08PBQJBS8
Color	Matte Black
Material	Brass
Finish Type	Matte Black
Number of Handles	2

Attribute	Value
Mounting Type	Wall Mount
Flow Rate	1.4 Gallons Per Minute (5.29 L/min)
Shower Head Size	8 inches
Adjustable Shower Height	39 - 55 inches (100cm - 140cm)
Hose Length	59 Inches
Item Weight	9 Pounds
Package Dimensions	29.13 x 16.93 x 3.94 inches

WARRANTY AND SUPPORT

For warranty information, technical support, or any inquiries regarding your gotonovo shower system, please refer to the product packaging or contact gotonovo customer service directly through their official website or the platform where the product was purchased.

Thank you for choosing gotonovo.