

XP-Pen Deco mini7W

XPPen Deco mini7W Wireless Graphic Tablet User Manual

Model: Deco mini7W

1. INTRODUCTION

The XPPen Deco mini7W is a versatile wireless graphic tablet designed for digital art, online teaching, e-learning, and light office work. It offers both wired and wireless connectivity options, a battery-free stylus with high pressure sensitivity, and customizable shortcut keys to enhance your workflow.

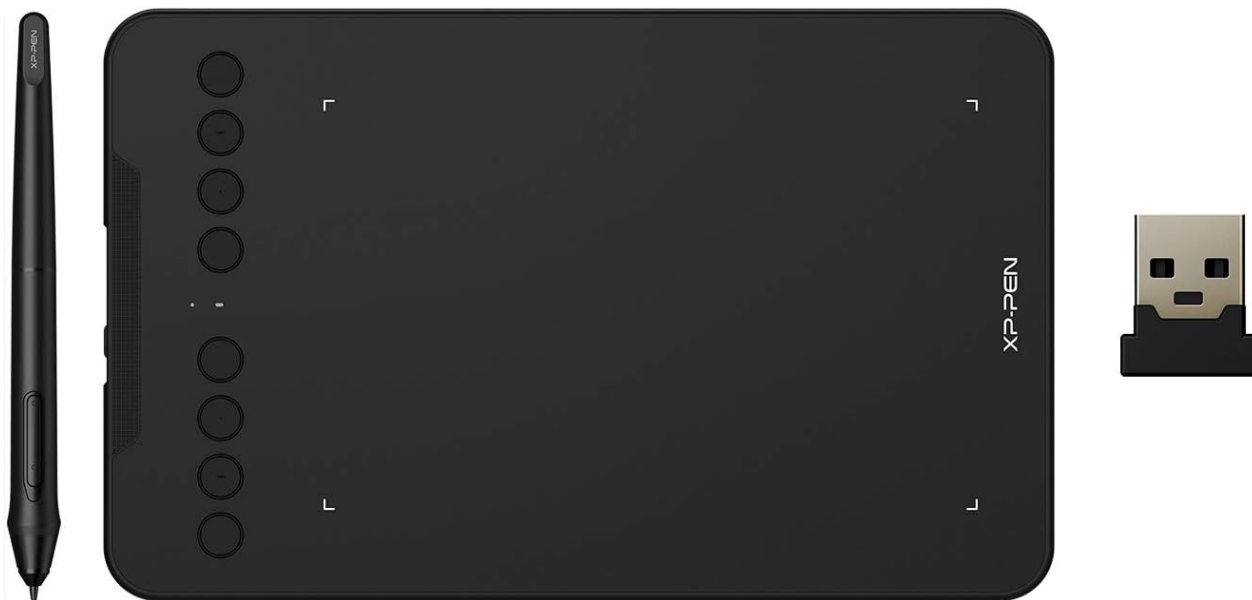

Image 1.1: XPPen Deco mini7W Graphic Tablet, battery-free stylus, and 2.4 GHz wireless receiver.

2. WHAT'S IN THE BOX

Upon unboxing your XPPen Deco mini7W, please ensure all the following items are present:

- 1x Pen Tablet
- 1x Stylus

- 1x Wireless Receiver
- 1x Pen-Clipper
- 10x Pen Nibs
- 1x USB to USB-C Cable
- 1x USB to USB-C Adapter
- 1x USB to Micro USB Adapter



Image 2.1: Contents of the XPPen Deco mini7W package, including the tablet, pen, cables, adapters, and accessories.

3. SETUP

3.1. Driver Installation

Before connecting your tablet, it is recommended to download and install the latest drivers from the official XPPen website. This ensures optimal performance and access to all features, including customizable keys and pressure sensitivity settings.

3.2. Wired Connection

To connect the Deco mini7W via a wired connection:

1. Connect one end of the provided USB to USB-C cable to the USB-C port on the tablet.
2. Connect the other end of the cable to an available USB port on your computer.

3. If your computer only has USB-C ports, use the included USB to USB-C adapter.



The Deco mini7W comes equipped with a USB-C port, meaning that can directly connect your iMac, MacBook Pro, or Windows computer to your tablet.

Image 3.1: The Deco mini7W supports USB-C to USB-C connections with the included adapter, allowing connection to various computing devices.

3.3. Wireless Connection

To connect the Deco mini7W wirelessly:

1. Plug the included USB wireless receiver into an available USB port on your computer.
2. Ensure the tablet is powered on. The 2.4 GHz wireless technology will establish a connection, allowing you to use the tablet without cables.

Embrace wireless technology

Creativity shouldn't be limited by wires. The Deco mini 7W's 2.4 GHz wireless technology allows you to create with both speed and freedom. (wireless version only)



Image 3.2: The Deco mini7W connects wirelessly to your PC or laptop by plugging the USB dongle into your computer.

Your browser does not support the video tag.

Video 3.1: An overview of the XP-PEN Deco mini7W Wireless Drawing Graphics Tablet, demonstrating its features and connectivity.

4. OPERATING INSTRUCTIONS

4.1. Stylus Usage

The Deco mini7W comes with a battery-free stylus that offers 8192 levels of pressure sensitivity and tilt-response capabilities. This allows for precise and natural drawing or writing experience. Simply hold the stylus like a regular pen and interact with the tablet's active area.

4.2. Customizable Press Keys

The tablet features 8 customizable press keys located on the side. These keys can be programmed through the driver software to perform various functions, such as undo, redo, zoom in/out, or switch between tools, streamlining your creative process.

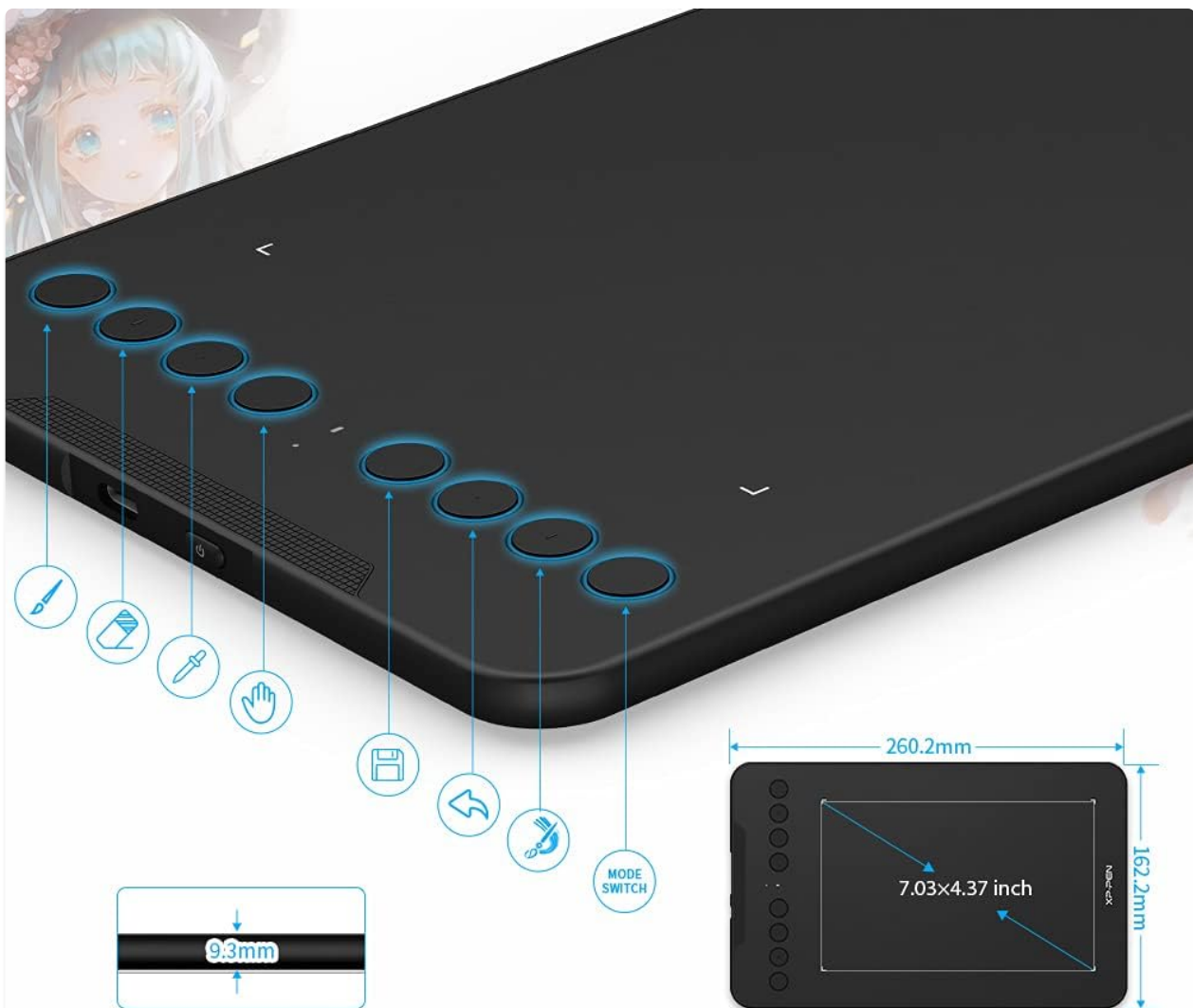

Enjoy powerful performance from a portable tablet.
The easy-to-use Deco mini7W allows ideas to flow freely.
Customize your shortcut keys to tailor your own unique experience.

Image 4.1: The Deco mini7W features 8 customizable press keys and a compact design for portable use.

4.3. Usage Scenarios

The Deco mini7W is suitable for various applications:

- **Digital Art:** Create illustrations, paintings, and graphic designs with precision.
- **Online Teaching/E-Learning:** Write, annotate, and illustrate directly on virtual whiteboards or shared documents.
- **Light Office Work:** Sign documents digitally, take handwritten notes, or use it for presentations.



Image 4.2: The Deco mini7W is ideal for online teaching and e-learning, allowing for interactive annotation and drawing.

Light Office Work



Image 4.3: The tablet can be used for light office work, including digital signatures and note-taking.

5. COMPATIBILITY

The XPPen Deco mini7W Wireless Graphic Tablet offers broad compatibility with various operating systems and creative software:

- **Operating Systems:** Windows 7 and above, Mac OS X 10.10 (and higher), Android 6.0 (and higher), Chrome OS 88.0.4324.109 or above.
- **Supported Software:** Compatible with major creative applications such as Photoshop, SAI, Painter, Illustrator, Clip Studio, GIMP, Medibang, Krita, Fire Alpaca, and Blender 3D.



The XP-Pen Deco mini7W is compatible with Windows® 10/8/7, Mac OS X® 10.10 (and higher), Android 6.0 (and higher).

The tablet also works with major software, including Photoshop®, SAI®, Painter®, Illustrator®, Clip Studio®, GIMP®, Medibang®, Krita®, Fire Alpaca®, and Blender® 3D.

Image 5.1: The Deco mini7W is compatible with Windows, Mac OS, Android, and Chrome OS, supporting a wide range of creative software.

Your browser does not support the video tag.

Video 5.1: This video demonstrates how to use the XP-PEN Tablet with a Chromebook, highlighting its ease of use and compatibility.

6. MAINTENANCE

To ensure the longevity and optimal performance of your Deco mini7W tablet:

- **Cleaning:** Use a soft, dry cloth to gently wipe the tablet surface and stylus. Avoid abrasive materials or harsh chemicals.
- **Storage:** Store the tablet and stylus in a cool, dry place away from direct sunlight and extreme temperatures.
- **Nib Replacement:** Replace the stylus nibs when they show signs of wear to maintain drawing accuracy. Use the included pen-clipper for easy replacement.

7. TROUBLESHOOTING

If you encounter issues with your Deco mini7W tablet, consider the following:

- **No Pen Response:** Ensure the tablet is properly connected (wired or wireless) and powered on. Verify that the drivers are correctly installed and updated.
- **Inaccurate Cursor:** Recalibrate the tablet through the driver settings. Check for any interference if using a wireless connection.
- **Custom Keys Not Working:** Confirm that the custom keys are correctly configured in the driver software. Ensure the driver application is running in the background.
- **Connectivity Issues:** For wireless, try reconnecting the USB dongle or restarting your computer. For wired, try a different USB port or cable.

8. SPECIFICATIONS

Feature	Specification
Product Dimensions	122.88 x 76.56 x 4.32 inches
Item Weight	1.23 pounds
Item Model Number	Deco mini7W
Batteries	1 Lithium Polymer battery required (included)
Connectivity Technology	Bluetooth, USB
Pressure Sensitivity	8192 Levels
Operating System	Windows 7+, Mac OS X 10.10+, Android 6.0+, Chrome OS 88+, Linux
Special Feature	60° Tilt Support, Extra-Slim, Shortcut Key

9. WARRANTY AND SUPPORT

The XPPen Deco mini7W comes with a **1-Year Protection Plan**. XPPen also offers lifetime service for all its products. For detailed terms and conditions regarding support, returns, and refunds, please refer to the official XPPen website or contact customer service.

If you have any questions about the product or require assistance, you can get in touch with XPPen via Amazon Message.