

SONGMICS LDB001W01

SONGMICS Electric Desk Tabletop LDB001W01 Instruction Manual

Model: LDB001W01 | Brand: SONGMICS

1. IMPORTANT SAFETY INFORMATION

Please read all instructions carefully before assembly and use. Keep this manual for future reference.

- Ensure the product is installed on a stable and solid surface.
- Do not place excessively heavy or unstable objects on the tabletop.
- Use the product only as intended and in accordance with the manufacturer's instructions to prevent accidents or damage.
- Keep children and pets away from the assembly area.
- Inspect all components for damage before assembly. Do not use if any parts are damaged.

2. PRODUCT OVERVIEW

The SONGMICS LDB001W01 tabletop is designed to complement electric standing desk frames, offering a spacious and durable work surface with thoughtful features for a modern office setup.



Image: The SONGMICS electric desk tabletop integrated into a modern office environment, showcasing its clean white surface, cable management grommets, and ample space for a monitor, keyboard, and other accessories.

Key Features:

- **Modern Style:** The white surface provides a contemporary aesthetic.
- **Durable Construction:** Made from robust MDF panel for long-lasting use.
- **Pre-drilled Holes:** Integrated screws and perfectly adapted holes for easy mounting with compatible SONGMICS electric desk supports.
- **Safety Edges:** PVC-covered, smooth, and comfortable rounded edges to prevent injuries.
- **Cable Management:** Two cable holes are provided on the sides for organized cable routing.

3. ASSEMBLY AND SETUP

This tabletop is designed for easy integration with compatible electric desk frames, particularly SONGMICS models. Ensure you have the necessary tools (e.g., screwdriver) for attachment.

3.1 Unpacking and Inspection

- Carefully remove all components from the packaging.
- Verify that all parts are present and undamaged. Refer to the packing list (if provided with your desk frame).

3.2 Attaching the Tabletop to the Desk Frame

The tabletop features pre-drilled holes and integrated screws for straightforward attachment to a compatible electric desk frame. The desk frame should have an adjustable width to accommodate the tabletop.

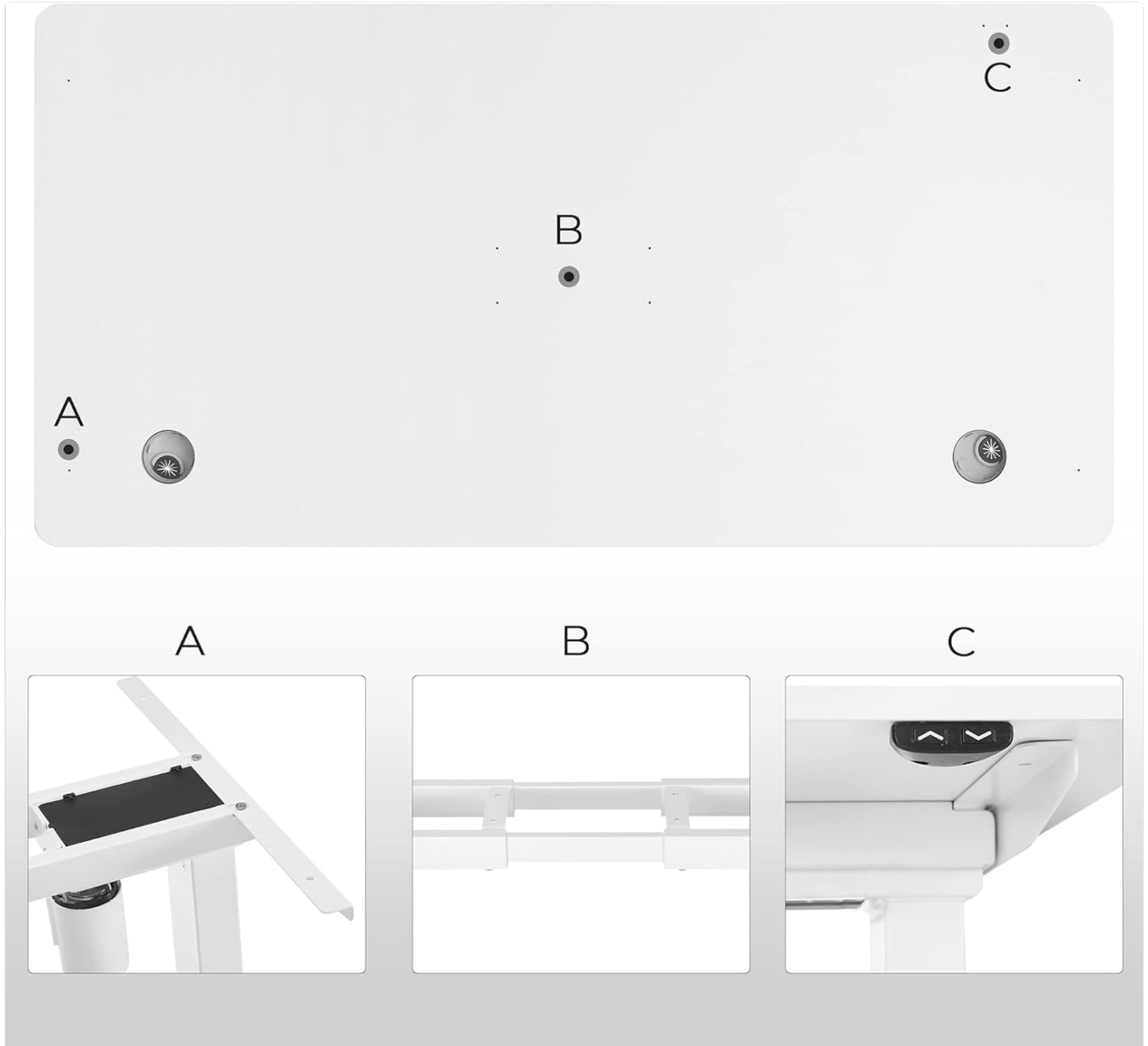

Image: The underside of the tabletop, illustrating the pre-drilled holes and integrated screws (labeled A, B, C) designed for easy and secure attachment to an electric desk frame. Section A shows the mounting points for the frame's support arms, B for a central beam, and C for the control panel.

1. Place the tabletop upside down on a soft, clean surface to prevent scratches.
2. Position your electric desk frame (sold separately) on top of the inverted tabletop, aligning the frame's mounting plates with the pre-drilled holes on the tabletop.
3. Adjust the width of your desk frame if necessary to match the tabletop's dimensions and pre-drilled holes.
4. Secure the desk frame to the tabletop using the provided screws and a screwdriver. Ensure all screws are tightened firmly but do not overtighten.
5. Carefully flip the assembled desk upright. It is recommended to have assistance for this step due to the weight and

size.



Image: An electric desk frame with its tabletop detached, highlighting the adjustable width mechanism (indicated by arrows) that allows it to fit various tabletop sizes, including the SONGMICS LDB001W01.

4. OPERATING INSTRUCTIONS

This manual covers the tabletop component. For specific operating instructions related to the electric height adjustment features, please refer to the manual provided with your electric desk frame.

4.1 Cable Management

The tabletop includes two cable grommets to help organize and route your power and data cables, keeping your workspace tidy.



Image: A close-up view of one of the tabletop's integrated cable grommets, showing a power cable neatly routed through its opening, designed to keep desk cables organized and out of sight.

- Route monitor, computer, and other peripheral cables through the grommet holes.
- Utilize cable ties or clips (not included) to further secure and bundle cables under the desk.

5. MAINTENANCE AND CARE

Proper care will ensure the longevity and appearance of your tabletop.

- **Cleaning:** Wipe the surface regularly with a soft, damp cloth. For stubborn stains, use a mild, non-abrasive cleaner. Avoid harsh chemicals or abrasive materials that could damage the melamine finish.
- **Spills:** Immediately wipe up any spills to prevent liquid absorption and potential damage to the MDF core.
- **Heat Protection:** Use coasters or heat-resistant pads under hot items to prevent discoloration or damage to the surface.
- **Weight Distribution:** Distribute weight evenly across the tabletop. Avoid concentrating heavy items in one small area.

- **Edge Care:** The PVC edges are designed for durability, but avoid sharp impacts that could chip or peel them.

6. TROUBLESHOOTING

This section addresses common issues related to the tabletop itself. For issues concerning the electric desk frame's functionality, please consult its specific manual.

Problem	Possible Cause	Solution
Tabletop feels wobbly after assembly.	Screws not fully tightened; uneven floor.	Ensure all screws attaching the tabletop to the frame are securely tightened. Check if the desk frame's feet are level on the floor.
Surface scratches or marks.	Sharp objects; abrasive cleaning.	Use soft cloths for cleaning. Avoid dragging sharp objects across the surface. Minor marks may be reduced with furniture polish, but deep scratches are permanent.
Cable grommet is loose.	Improper seating.	Press the grommet firmly into its hole until it clicks into place.

7. SPECIFICATIONS

Detailed specifications for the SONGMICS LDB001W01 Electric Desk Tabletop.



Image: A technical diagram illustrating the main dimensions of the tabletop: 120 cm in length and 60 cm in width.

Attribute	Value
Brand	SONGMICS
Model Number	LDB001W01
Color	White
Product Dimensions (L x W x H)	120 x 60 x 1.8 cm
Material	MDF Panel, Melamine Veneer, PVC Edges
Item Weight	9.5 Kilograms
Shape	Rectangular with Rounded Corners
Special Feature	Designed for Electric Desk Frames



Image: A detailed view of the tabletop's rounded edge, clearly showing its thickness of 1.8 cm, which contributes to both aesthetics and user safety.