

## FlinQ 1

# FlinQ Smart Electric Heater User Manual - Model 1, 2000W

Your guide to safe and efficient operation

## 1. IMPORTANT SAFETY INFORMATION

---

Please read all safety warnings and instructions carefully before using this appliance. Failure to follow these instructions may result in electric shock, fire, or serious injury. Keep this manual for future reference.

- **Overheat Protection:** The heater is equipped with an automatic shut-off mechanism that activates if the unit overheats.
- **Tip-Over Protection:** For enhanced safety, the heater will automatically turn off if it is accidentally knocked over.
- **Child Lock:** Activate the child lock feature to prevent unintended operation by children.
- Do not cover the heater. Covering the heater can cause overheating and fire.
- Do not use this heater in the immediate surroundings of a bath, a shower, or a swimming pool.
- Ensure the power cord is not damaged and is placed away from heated surfaces.
- Always unplug the heater when not in use or before cleaning.

# Sûr pour toute la famille

Convient aux enfants et aux animaux.



*Équipé d'une protection contre la surchauffe et d'un verrouillage enfant.*

**FLINQ**

Image 1.1: The FlinQ Smart Electric Heater is designed with safety in mind, featuring overheat and tip-over protection, making it suitable for households with children and pets.

## 2. PRODUCT OVERVIEW

---

The FlinQ Smart Electric Heater is a versatile and efficient heating solution, offering both mobile and wall-mounted installation options. With 2000W of power, it can effectively heat rooms up to 28 m<sup>2</sup> (60 m<sup>3</sup>). Its smart features allow control via a touchscreen, smartphone app, or voice commands through Google Assistant and Amazon Alexa.



Image 2.1: The FlinQ Smart Electric Heater, showcasing its sleek design and smart control capabilities via a mobile application.

### Key Features:

- **Smart Control:** Wi-Fi enabled for control via smartphone/tablet app, Google Assistant, and Amazon Alexa.
- **Dual Placement:** Can be used as a mobile unit with feet or permanently mounted on a wall.
- **Powerful Heating:** 2000W output suitable for spaces up to 28 m<sup>2</sup> / 60 m<sup>3</sup>.
- **Elegant Design:** Features a glass surface and modern aesthetic.
- **Integrated Touchscreen:** For direct control on the device.
- **Secure Protection Grille:** Ensures safe operation.



Image 2.2: Detailed view of the heater's essential features, including wall mount support, touchscreen interface, and the protective grille.

### 3. PACKAGE CONTENTS

---

Please check that all components are present and undamaged:

- FlinQ Smart Electric Heater (Model 1)
- Feet for mobile use
- Wall mounting kit
- User Manual

### 4. SETUP AND INSTALLATION

---

#### 4.1 Floor Standing Installation

1. Carefully remove the heater from its packaging.
2. Attach the provided feet to the bottom of the heater using the screws. Ensure they are securely fastened.
3. Place the heater on a flat, stable surface, away from flammable materials and at least 1 meter (3 feet) from walls or furniture.

## 4.2 Wall Mounting Installation

The wall mounting kit is included for a permanent and space-saving installation.

1. Identify a suitable wall location, ensuring it is clear of electrical wiring or plumbing.
2. Using the wall mounting kit, mark the drilling points on the wall.
3. Drill holes and insert wall plugs.
4. Secure the mounting brackets to the wall.
5. Carefully hang the heater onto the mounted brackets, ensuring it is stable and level.

# Support mural intégré

Pour une finition élégante ou en  
cas de manque d'espace au sol.



Image 4.1: The FlinQ Smart Electric Heater installed on a wall, demonstrating its integrated wall support for an elegant finish or to save floor space.

## 4.3 Power Connection

1. Ensure the heater is switched off before plugging it in.
2. Insert the power plug into a suitable 230V electrical outlet.



Image 4.2: The power plug for the FlinQ Smart Electric Heater, designed for 230V outlets.

#### 4.4 Smart App and Voice Assistant Setup

1. Download the FlinQ Smart app (or a compatible smart home app like TuyaSmart) from your device's app store.
2. Register or log in to your account.
3. Follow the in-app instructions to add a new device. Ensure your heater is powered on and your smartphone is connected to a 2.4GHz Wi-Fi network.
4. Once connected, you can link the app to Google Assistant or Amazon Alexa for voice control. Refer to the app's help section for specific instructions on linking to voice assistants.

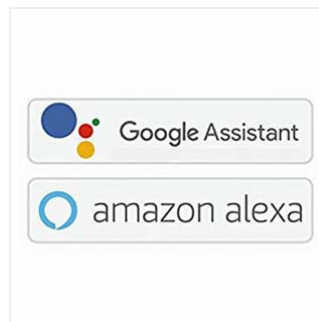

Image 4.3: The FlinQ Smart Electric Heater is compatible with Google Assistant and Amazon Alexa for convenient voice control.

### 5. OPERATING INSTRUCTIONS

---

#### 5.1 Using the Touchscreen Controls

The heater features an intuitive touchscreen display for direct control.

- **Power Button:** Press to turn the heater on or off.
- **Temperature Adjustment:** Use the '+' and '-' buttons to set your desired temperature.
- **Mode Selection:** Cycle through heating modes (if available) using the mode button.
- **Timer:** Set a timer for automatic shut-off.
- **Child Lock:** Press and hold the child lock icon to activate or deactivate.

#### 5.2 Using the Smartphone App

Once connected to the FlinQ Smart app, you can control all functions remotely.

- **Remote On/Off:** Turn the heater on or off from anywhere.
- **Temperature Control:** Precisely adjust the temperature.



- **Scheduling:** Create custom heating schedules for different days and times.
- **Mode Settings:** Select heating modes and fan speeds.
- **Child Lock:** Activate or deactivate the child lock feature.



Image 5.1: The FlinQ Smart Electric Heater can be controlled directly via its integrated touchscreen or remotely using the dedicated smartphone application.

### 5.3 Voice Control

After linking your FlinQ Smart app to Google Assistant or Amazon Alexa, use voice commands to control your heater.

- Example commands: "Hey Google, turn on the heater," "Alexa, set heater temperature to 22 degrees."

## 6. MAINTENANCE

Regular maintenance ensures optimal performance and longevity of your heater.

### 6.1 Cleaning

1. Always unplug the heater and allow it to cool completely before cleaning.
2. Wipe the exterior surfaces with a soft, damp cloth. Do not use abrasive cleaners or solvents.

- 3. Ensure no water enters the internal components.
- 4. Periodically vacuum the air intake and outlet grilles to remove dust and debris.

6.2 Storage

If storing the heater for an extended period, clean it thoroughly and store it in a cool, dry place, preferably in its original packaging.

7. TROUBLESHOOTING

If you encounter issues with your FlinQ Smart Electric Heater, refer to the following common problems and solutions:

| Problem                        | Possible Cause  | Solution  |
|--------------------------------|---|---|
| Heater does not turn on.       | No power, tip-over switch activated, overheat protection activated. | Check power connection. Ensure heater is upright. Unplug and allow to cool for 30 minutes, then plug back in.       |
| No heat output.                | Temperature setting too low, heating mode not active.               | Increase desired temperature. Ensure heater is in an active heating mode.   |
| Wi-Fi connection fails.        | Incorrect Wi-Fi password, 5GHz network, router too far.             | Verify Wi-Fi password. Ensure connection to a 2.4GHz network. Move heater closer to router or use a Wi-Fi extender. |
| Unusual odor during first use. | Normal burning off of manufacturing residues.                       | This is normal for the first few uses and will dissipate. Ensure good ventilation.                                  |

If the problem persists after trying these solutions, please contact customer support.

8. SPECIFICATIONS

Detailed technical specifications for the FlinQ Smart Electric Heater, Model 1.

| Feature                | Specification   |
|------------------------|---|
| Brand                  | FlinQ   |
| Model Number           | 1   |
| Power Output           | 2000W   |
| Voltage                | 230 Volts   |
| Dimensions (L x W x H) | 96 x 46 x 13 cm (Product); 13 x 46 x 48 cm (Packaged) |
| Weight                 | 7.4 Kilograms   |
| Material               | Glass   |
| Color                  | Black   |



| Feature          | Specification   |
|------------------|---|
| Heating Method   | Radiant   |
| Room Type        | Multiple rooms (Indoor use)   |
| Heat Coverage    | Up to 28 m <sup>2</sup> / 60 m <sup>3</sup>   |
| Special Features | Low oxygen safety shut-off, Rapid heating, Wi-Fi compatible, Adjustable temperature, Overheat protection, Tip-over protection |
| Compatibility    | Google Assistant, Amazon Alexa  |

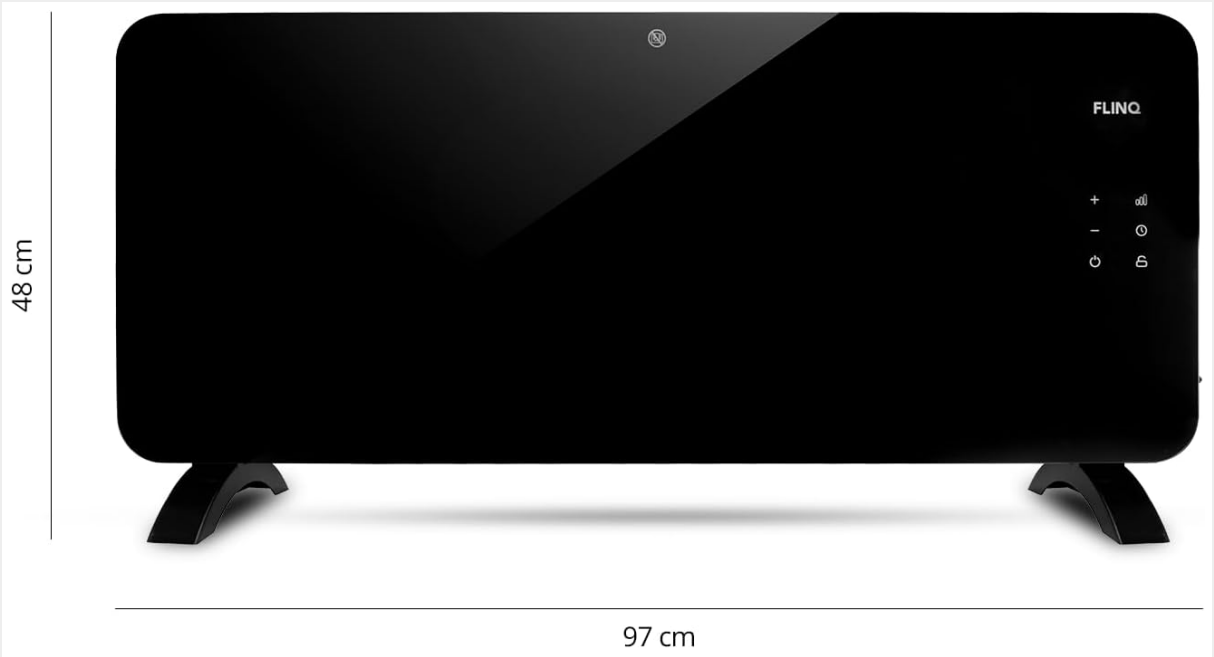

Image 8.1: Dimensions of the FlinQ Smart Electric Heater, illustrating its compact size for various placements.





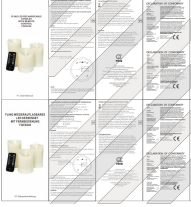

Image 8.2: The FlinQ Smart Electric Heater's heating capacity, capable of warming spaces up to 28 square meters or 60 cubic meters.

## 9. WARRANTY AND SUPPORT

The FlinQ Smart Electric Heater comes with a standard warranty. Please refer to the warranty card included in your package for specific terms and conditions.

For technical support, troubleshooting assistance, or warranty claims, please contact FlinQ customer service. Contact details can typically be found on the FlinQ website or on the product packaging.

Related Documents - 1

|   |   |
|---|---|
|    | <p><a href="#">FLINQ FQC8176/8177 Handleiding: Slimme Paneel Verwarmer Gebruiksaanwijzing</a></p> <p>Gedetailleerde handleiding voor de FLINQ FQC8176/8177 Slimme Paneel Verwarmer. Leer over installatie, bediening, veiligheid, Wi-Fi-connectiviteit en onderhoud.</p>  |
|    | <p><a href="#">FlinQ Outdoor LED Candles Instruction Manual - FQC8416, FQC8417</a></p> <p>Comprehensive instruction manual for FlinQ Outdoor LED Candles (FQC8416, FQC8417), covering safety, specifications, usage, charging, remote control, disposal, and warranty information. Includes setup and operational guidance.</p> |
|   | <p><a href="#">FlinQ Smart Starry Sky Projector User Manual - Create Ambiance</a></p> <p>Explore the FlinQ Smart Starry Sky Projector user manual. Learn how to set up and use this smart projector to create a magical starry night atmosphere in your home, with control via Alexa and Google Assistant.</p>                  |
|  | <p><a href="#">FLINQ FQC8240 Rechargeable LED Candles with Remote Control - User Manual</a></p> <p>User manual for the FLINQ FQC8240 rechargeable LED candles set with remote control. Learn about features, operation, charging, safety, and disposal.</p>   |
|  | <p><a href="#">FlinQ Smart Starry Sky Projector User Manual - Setup, Alexa &amp; Google Home Integration</a></p> <p>Comprehensive user guide for the FlinQ Smart Starry Sky Projector. Learn how to set up, connect to Wi-Fi, integrate with Amazon Alexa and Google Home, and find answers to frequently asked questions.</p>  |

## Code inwisselen voor FlinQ Cloud Storage

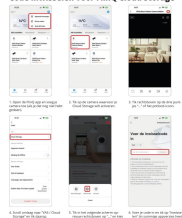
[FlinQ Cloud Storage Activeren met Inwisselcode](#)

Stapsgewijze instructies voor het activeren van FlinQ Cloud Storage voor uw FlinQ camera's met een inwisselcode via de FlinQ mobiele app.