

Manuals+

[Q & A](#) | [Deep Search](#) | [Upload](#)

manuals.plus /

- > [Ipuro](#) /
- > [Ipuro Air Pearls Big Cube Aroma Diffuser User Manual](#)

Ipuro IPU1008

Ipuro Air Pearls Big Cube Aroma Diffuser User Manual

Model: IPU1008

1. PRODUCT OVERVIEW

The Ipuro Air Pearls Big Cube is an electronic aroma diffuser designed to create a pleasant atmosphere in your home, office, or wellness spaces. It features quiet operation, multiple diffusion modes, and a convenient wireless charging function for Qi-compatible smartphones.

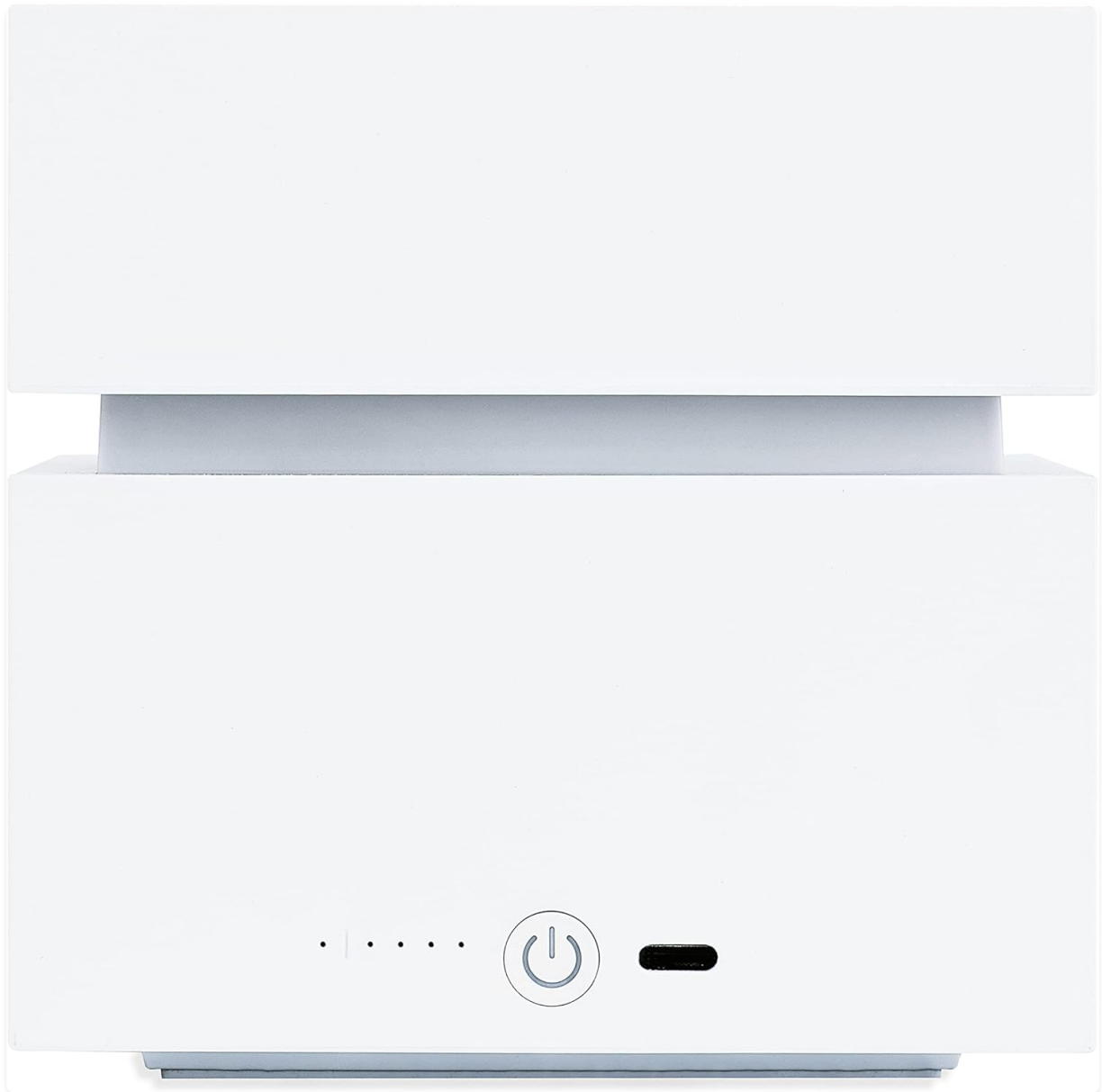

Front view of the Ipuro Air Pearls Big Cube, showing the power button and battery indicator lights.

2. PACKAGE CONTENTS

- Ipuro Air Pearls Big Cube Aroma Diffuser
- Power Cable (wired power source)
- User Manual

3. SETUP INSTRUCTIONS

1. **Placement:** Place the Big Cube on a suitable, stable surface.
2. **Power Connection:** Connect the device to a power source using the provided cable.
3. **Power On:** To switch on the device, press the ON/OFF button located on the back. The device will enter standby mode. The ON/OFF symbol will light up white for 30 seconds, and the power indicator LEDs will show the battery charge level for 30 seconds before turning off.
4. **Insert Scent Capsules:**
 - a. Remove the top cover of the diffuser.
 - b. Place one or two Ipuro Air Pearls scent capsules (depending on desired scent intensity) into the

designated compartment(s). Ensure the capsules are inserted with the bottom side facing down.

- c. Replace the top cover. Ensure the cover is correctly closed by aligning the symbols on the gray bottom part and the black cover.

VERWENDUNG IHRES AIR PEARLS GERÄTS

Verwendung/Betrieb

1. Auf der Geräterückseite: Zum Einschalten des Geräts die EIN/AUS-Taste drücken. Das Gerät bleibt im Standby-Modus, das EIN/AUS-Symbol leuchtet für 30 Sekunden weiß (und erlischt dann) und die LEDs der Stromanzeige zeigen ebenfalls für 30 Sekunden den Ladezustand der Batterie an (und erlöschen dann).
2. Den oberen Deckel abnehmen.
3. Eine oder zwei Kapseln (je nach gewünschter Duftintensität) in das Fach/die Fächer legen. Achten Sie darauf, die Kapseln mit der Unterseite nach unten einzulegen.
4. Den Deckel wieder anbringen. Der Deckel ist richtig geschlossen, wenn die Symbole am grauen Unterteil und auf dem schwarzen Deckel übereinander liegen.
5. Das MODUS-Logo auf der Vorderseite des Geräts drücken, um eine der beiden Betriebsarten zu wählen.

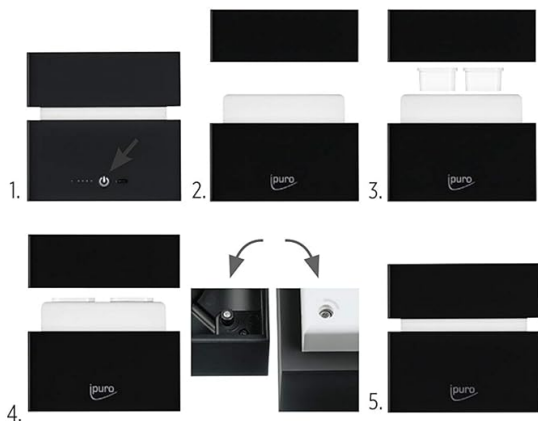

Visual guide for opening the device, inserting scent capsules, and selecting modes.

Sie können zwischen den folgenden Betriebsarten wählen:

1) Intervallbetrieb

Berühren Sie das MODUS-LOGO (A) einmal. Die LED-Leuchte wird WEISS. In diesem Modus arbeitet das Gerät wie folgt: 20 Minuten EIN, 5 Minuten AUS. Nach 7 Stunden wechselt das Gerät automatisch in den Standby-Modus.

2) Dauerbetrieb

Berühren Sie das MODUS-LOGO (B) zweimal. Die LED-Leuchte wird GRÜN. In diesem Modus arbeitet das Gerät durchgehend für 5 Stunden. Danach wechselt das Gerät automatisch in den Standby-Modus.

Berühren Sie das MODUS-LOGO (C) dreimal, um das Gerät in den Standby-Modus zu versetzen.



A) weißes Licht

B) grünes Licht

C) ohne Licht

Wenn sich das Gerät im Standby-Modus befindet und 30 Minuten lang nicht verwendet wird, schaltet es sich automatisch ab.

4. OPERATING INSTRUCTIONS

The Big Cube offers two operating modes and a wireless charging function.

1. Interval Operation:

Touch the mode logo once. The LED light will turn white. In this mode, the device operates for 20 minutes, followed by a 5-minute pause. After 7 hours, the device automatically switches to standby mode.

2. Continuous Operation:

Touch the mode logo twice. The LED light will turn green. In this mode, the device operates continuously for 5 hours. After this period, the device automatically switches to standby mode.

3. Standby Mode:

Touch the mode logo three times to put the device into standby mode. When the device is in standby mode and not used for 30 minutes, it automatically turns off.

4. Wireless Charging Function:

Place your Qi-compatible smartphone on the top surface of the Big Cube to charge it wirelessly. This function can only be used with Qi-compatible smartphones. The device offers a maximum of 54 hours runtime without using the Qi charger.

DUFTERLEBNISSE
AUF KNOPFDRUCK

SICHERE ANWENDUNG
OHNE FLÜSSIGKEIT

GENIEßEN SIE
IHREN AUTODUFT
AUF JEDER AUTOFAHRT

MINIMALISTISCHE OPTIK

QI-WIRELESS CHARGING
FUNKTION FÜR IHR
SMARTPHONE



The top surface of the Big Cube features a Qi wireless charging pad for compatible smartphones.

5. MAINTENANCE AND CARE

- Turn off the device when not in use.
- Regularly clean the capsule compartment and the device exterior with a soft, dry cloth.
- Ensure no liquid enters the electronic components of the device.
- Do not use abrasive cleaners or solvents.

6. TROUBLESHOOTING

- **Device not turning on:** Ensure the power cable is securely connected and the power outlet is functional. Check if the battery is charged.
- **No scent diffusion:** Ensure scent capsules are correctly inserted and not expired. Check if the device is in an active operating mode (interval or continuous).
- **Wireless charging not working:** Verify that your smartphone is Qi-compatible and correctly placed on the charging surface. Remove any thick phone cases that might interfere with charging.
- **Unusual noise:** Turn off the device and check for any obstructions in the capsule compartment. If the noise persists, contact customer support.

7. SAFETY WARNINGS

WARNING: The following warnings are provided by the manufacturer. Please read carefully.

- Highly flammable liquid and vapor (if using liquid fragrance products).
- May cause an allergic skin reaction.
- Causes severe eye irritation.
- Harmful to aquatic life with long lasting effects.
- Keep out of reach of children.
- Read and follow all instructions carefully.
- Keep away from heat, hot surfaces, sparks, open flames, and other ignition sources. No smoking.
- **IF ON SKIN:** Wash with plenty of water. If skin irritation or rash occurs: Get medical advice/attention.
- **IF IN EYES:** Rinse cautiously with water for several minutes. Remove contact lenses, if present and easy to do. Continue rinsing. If eye irritation persists: Get medical advice/attention.
- Do not dispose of contents/container with household waste; dispose of in accordance with regional/national regulations.

8. SPECIFICATIONS

Product Name	Ipuro Electric Air Pearls Big Cube White
Model Number	IPU1008
Brand	Ipuro
Dimensions (L x W x H)	15.5 x 15.5 x 15.8 cm
Net Product Weight	1.1 Kilograms
Power Source	Wired
Special Features	Long lifespan, wireless mobile phone charging
Recommended Uses	Home, office, yoga, wellness
Automatic Shut-off	Yes
Light Source Type	LED
Battery	1 AA - included

9. WARRANTY AND SUPPORT

Information regarding product warranty and customer support is not available in the provided product data. Please refer to the product packaging or the manufacturer's official website for details on warranty coverage and how to contact support.