

## Kiano Elegance Robot

# Kiano Elegance Robot Vacuum Cleaner User Manual

Model: Elegance Robot

## 1. INTRODUCTION

Thank you for choosing the Kiano Elegance Robot Vacuum Cleaner. This manual provides essential information for the safe operation, maintenance, and troubleshooting of your device. Please read it thoroughly before use and retain it for future reference.



Image 1.1: The Kiano Elegance Robot Vacuum Cleaner in a home environment.

## 2. SAFETY INSTRUCTIONS

---

To ensure safe operation, please observe the following precautions:

- This appliance can be used by children aged 8 years and above and persons with reduced physical, sensory or mental capabilities or lack of experience and knowledge if they have been given supervision or instruction concerning use of the appliance in a safe way and understand the hazards involved.
- Children shall not play with the appliance. Cleaning and user maintenance shall not be made by children without supervision.
- Only use the original power adapter provided with the device.
- Do not operate the robot in wet environments or near water.
- Keep hair, loose clothing, fingers, and all parts of the body away from openings and moving parts.
- Do not pick up large or sharp objects, liquids, or burning/smoking materials.
- Ensure the charging dock is placed against a wall on a level surface, with adequate clear space around it.
- Before cleaning, remove power cords, small objects, and fragile items from the floor.

## 3. PACKAGE CONTENTS

---

Carefully unpack the box and ensure all items are present:

- Kiano Elegance Robot Vacuum Cleaner
- Charging Dock
- Power Adapter
- 2 x Mopping Cloths
- 2 x Sets of Side Brushes (4 brushes total)
- Water Tank
- Dustbin (pre-installed)
- HEPA Filter (pre-installed)
- Cleaning Tool
- User Manual



Image 3.1: Overview of the Kiano Elegance Robot Vacuum Cleaner and its accessories.

## 4. PRODUCT DIAGRAM

---

### 4.1 Top View

The top of the robot features the laser navigation sensor, power button, and Wi-Fi indicator.



Image 4.1: Side profile of the Kiano Elegance Robot, highlighting its compact design.

## 4.2 Bottom View

The underside includes the main brush, side brushes, driving wheels, and cliff sensors.



Image 4.2: The bottom of the robot, displaying the main brush, side brushes, and wheels.

## 5. SETUP

### 5.1 Charging Dock Placement

Place the charging dock against a wall on a hard, level surface. Ensure there is at least 0.5 meters of clear space on both sides and 1.5 meters in front of the dock for the robot to navigate effectively.

### 5.2 Initial Charging

Connect the power adapter to the charging dock and plug it into a wall outlet. Place the robot onto the charging dock. The robot will automatically begin charging. For first-time use, charge the robot for at least 6 hours or until the battery indicator shows a full charge.



Image 5.1: The robot vacuum automatically returning to its charging station.

### 5.3 App Installation and Pairing

Download the "Laser Robot" app from the App Store (iOS) or Google Play Store (Android). Follow the in-app instructions to connect your Kiano Elegance Robot to your home Wi-Fi network. This will enable remote control and advanced features.

## 6. OPERATING INSTRUCTIONS

---

### 6.1 Starting a Cleaning Cycle

Press the power button on the robot or use the mobile app to start a cleaning cycle. The robot will use its laser navigation system to map your home and plan an efficient cleaning path.



Image 6.1: The robot navigating and cleaning under furniture.

## 6.2 Laser Navigation and Mapping

The Kiano Elegance Robot utilizes advanced laser navigation to create a precise map of your environment. This allows for systematic cleaning and efficient route planning. You can view the real-time map and cleaning progress in the app.



Image 6.2: The mobile app interface showing the robot's mapping and cleaning status.



Image 6.3: Visual representation of the robot's laser navigation and route planning capabilities.

### 6.3 Wet Cleaning (Mopping Function)

Attach the water tank and a mopping cloth to the robot. Fill the water tank with clean water. The robot will then vacuum and mop simultaneously, providing a thorough clean for hard floors. Two mopping cloths are included for convenience.



Image 6.4: The robot with the mopping attachment for wet cleaning.



Image 6.5: Detail of the mopping cloth and its attachment mechanism.

## 6.4 Pet Hair Cleaning

The Kiano Elegance Robot is designed to effectively remove pet hair, dirt, and dust from various surfaces, making it ideal for homes with pets.

---

Image 6.6: The robot effectively cleaning pet hair from flooring.

## 6.5 Remote Control and App Features

The "Laser Robot" app provides full control over your vacuum. You can:

- Start/Stop cleaning.
- Send the robot to specific rooms or areas.
- Monitor cleaning progress in real-time.
- Set cleaning schedules.
- Define virtual no-go zones.



Image 6.7: The mobile app for remote control and advanced settings.

## 6.6 No-Go Zones

Use the app to define virtual boundaries or no-go zones where you do not want the robot to clean. This is useful for protecting fragile items or preventing access to certain areas.



Image 6.8: Defining no-go zones through the mobile application.

## 6.7 Automatic Return to Charging Station

After completing its cleaning task or when the battery is low, the robot will automatically return to its charging dock to recharge.

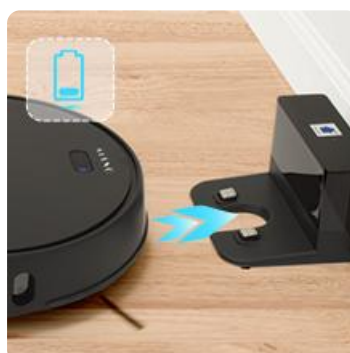

## 7. MAINTENANCE

---

Regular maintenance ensures optimal performance and extends the lifespan of your Kiano Elegance Robot.

### 7.1 Emptying the Dustbin and Water Tank

After each cleaning cycle, or when indicated by the app, remove and empty the dustbin. If using the mopping function, empty and clean the water tank as well.



Image 7.1: The robot with its dustbin and water tank compartments open.

### 7.2 Cleaning the HEPA Filter

Tap the HEPA filter to remove loose dirt. For a deeper clean, rinse the filter under running water. Ensure it is completely dry before reinserting it into the dustbin. Replace the HEPA filter every 3-6 months, depending on usage.

### 7.3 Cleaning Side Brushes and Main Brush

Regularly check the side brushes and main brush for tangled hair or debris. Use the provided cleaning tool to cut and remove any tangled hair. Replace worn-out brushes as needed.

### 7.4 Cleaning Sensors

Wipe the cliff sensors and charging contacts on the robot and charging dock with a clean, dry cloth to ensure proper function.

## 8. TROUBLESHOOTING

---

If you encounter issues with your Kiano Elegance Robot, refer to the following common problems and

solutions:

| Problem                     | Possible Cause                                     | Solution   |
|-----------------------------|--|--|
| Robot does not turn on      | Low battery; Power button not pressed              | Charge the robot; Press and hold the power button for 3 seconds      |
| Robot cannot charge         | Charging contacts dirty; Charging dock not powered | Clean charging contacts; Ensure power adapter is connected           |
| Robot gets stuck frequently | Obstacles on floor; Cliff sensors dirty            | Clear floor of cables/small items; Clean cliff sensors               |
| Poor cleaning performance   | Dustbin full; Brushes tangled; Filter clogged      | Empty dustbin; Clean brushes; Clean/replace filter                   |
| App connection issues       | Incorrect Wi-Fi password; Router too far           | Re-enter Wi-Fi password; Move robot closer to router; Restart router |

## 9. TECHNICAL SPECIFICATIONS

| Feature                        | Specification  |
|--------------------------------|--|
| Brand                          | Kiano  |
| Model                          | Elegance Robot                                       |
| Navigation Type                | Laser Navigation                                     |
| Suction Power                  | 2100Pa   |
| Special Features               | Carpet Boost, Wet Cleaning, HEPA Filter, App Control |
| Control Type                   | Remote Control, App (Android/iOS)                    |
| Battery Life                   | Up to 2 Hours  |
| Battery Composition            | Lithium Ion  |
| Product Dimensions (L x W x H) | 35.6 x 8.2 x 35.1 cm                                 |
| Item Weight                    | 3.1 Kilograms  |
| Noise Level                    | 65 Decibels  |
| Obstacle Climbing Ability      | Up to 1.8 cm   |



Image 9.1: The robot's ability to climb obstacles up to 1.8 cm.

## 10. WARRANTY INFORMATION

---

The Kiano Elegance Robot Vacuum Cleaner comes with a standard manufacturer's warranty. Please refer to the warranty card included in your package for specific terms, conditions, and duration. Keep your proof of purchase for warranty claims.

## 11. CUSTOMER SUPPORT

---

For further assistance, technical support, or service inquiries, please contact Kiano customer support through the contact information provided on the official Kiano website or your purchase documentation.