

Aivituvin Rabbit Hutch Outdoor Large

Aivituvin Large Rabbit Hutch Instruction Manual

Model: Rabbit Hutch Outdoor Large

1. INTRODUCTION AND SAFETY INFORMATION

Thank you for choosing the Aivituvin Large Rabbit Hutch. This manual provides essential instructions for assembly, operation, maintenance, and safety to ensure the well-being of your pet and the longevity of the product. Please read all instructions carefully before assembly and use.

Important Safety Warnings:

- **Adult Assembly Required:** This product contains small parts and requires adult assembly. Keep children away during assembly.
- **Proper Placement:** Ensure the hutch is placed on a flat, stable surface. If used outdoors, place it in a sheltered area to protect against extreme weather.
- **Pet Safety:** Regularly inspect the hutch for any damage, loose parts, or sharp edges that could harm your pet. Address any issues immediately.
- **Chewing Hazard:** The hutch is constructed from fir wood. While durable, some pets may chew on the wood. Monitor your pet's chewing habits and provide appropriate chew toys to redirect this behavior.
- **Ventilation:** Ensure adequate ventilation within the hutch.
- **Cleaning:** Maintain a clean environment to prevent health issues for your pet. Follow the cleaning instructions provided.
- **Weight Limit:** Do not overload the hutch. It is designed for one to two rabbits or similar small animals.

2. PACKAGE CONTENTS

Before beginning assembly, verify that all components listed below are present and undamaged. If any parts are missing or damaged, please contact Aivituvin customer support.

Ideal Indoor & Outdoor Small Animal Cage

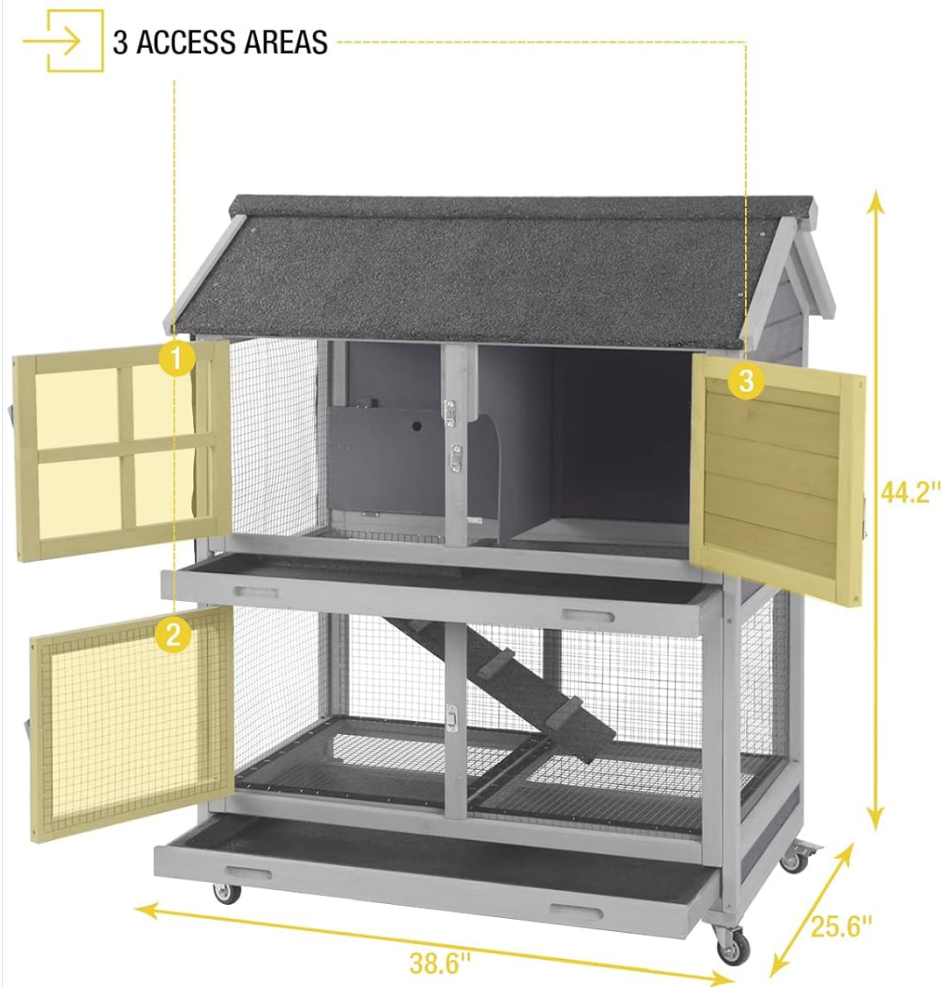

Includes



1 x Removable Wire Mesh



2 x Slide Out Trays



1 x Chewing Toy

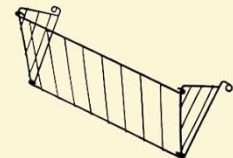

1 x Metal Feeder



4 x Wheels

Image: An exploded diagram illustrating the various parts and accessories included with the rabbit hutch, such as panels, roof, trays, wheels, and small accessories.

- Hutch Panels (various sizes for walls, floor, roof)
- 1 x Removable Wire Mesh
- 2 x Slide Out Trays
- 1 x Chewing Toy
- 1 x Metal Feeder
- 4 x Wheels (2 with locks)
- Assembly Hardware (screws, bolts, hinges, latches)
- Assembly Tools (e.g., screwdriver - may not be included)

3. ASSEMBLY INSTRUCTIONS

Follow these steps carefully to assemble your Aivituvn Rabbit Hutch. It is recommended to have two people for assembly.

1. **Prepare the Area:** Clear a spacious, flat area for assembly. Unpack all components and lay them out,

comparing them with the package contents list.

2. **Assemble the Base Frame:** Connect the side panels and front/back panels of the lower level using the provided hardware. Ensure all connections are secure.
3. **Install Wheels:** Attach the four wheels to the bottom of the assembled base frame. Ensure the two lockable wheels are positioned at the front for easy access.

Stronger Casters + Stronger Structure



Image: Close-up of the hutch's base showing the 360-degree rotating wheels, including brake casters, and emphasizing the overall strong structure.

4. **Insert Lower Level Trays and Wire Mesh:** Slide the bottom pull-out tray into the lower level. Place the removable metal wire netting on top of the tray supports. This prevents your pet from standing directly in waste.

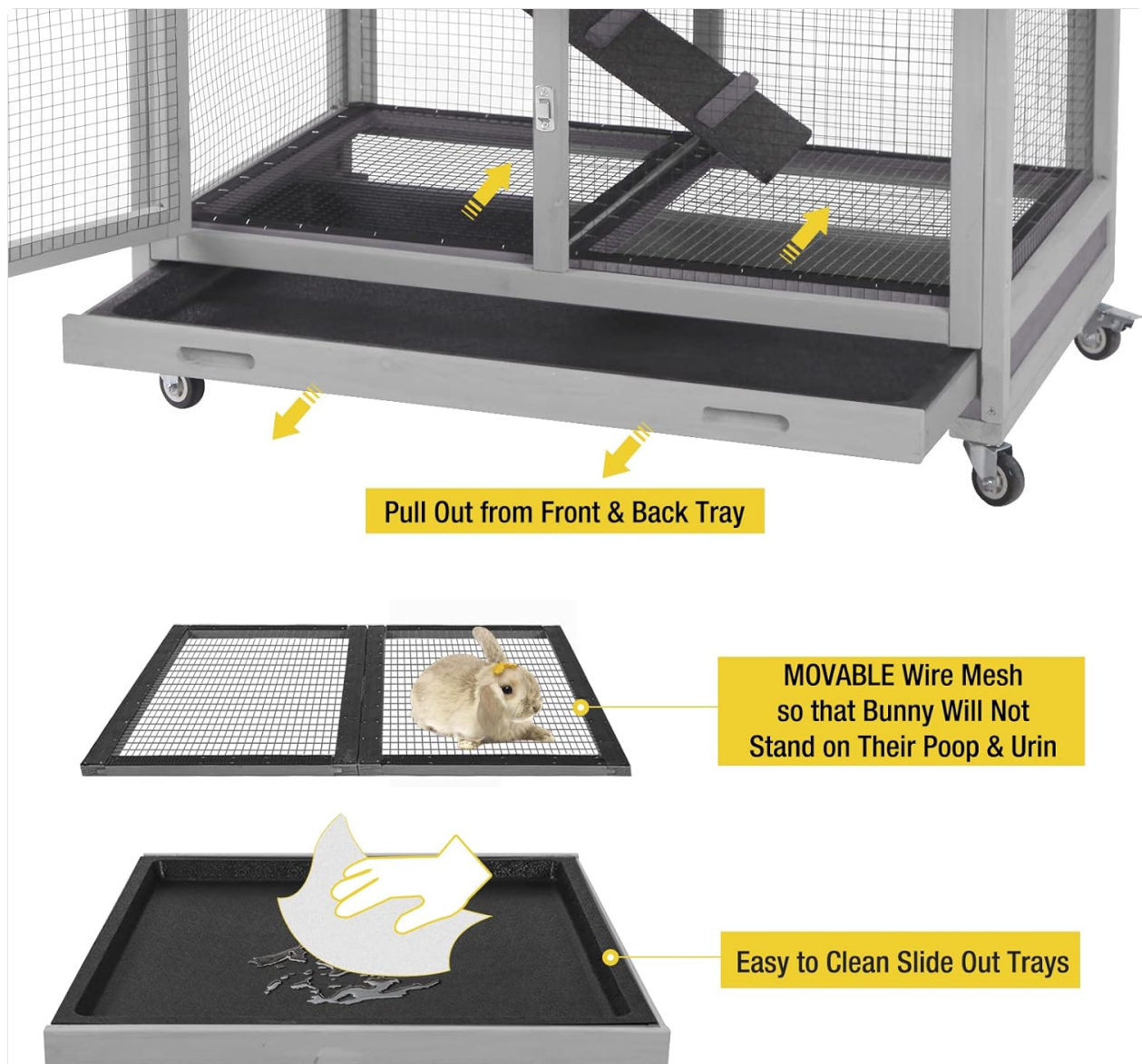

Image: A detailed view of the hutch's interior, illustrating how the pull-out trays and the removable wire mesh function for waste collection and hygiene.

5. **Assemble the Upper Level:** Construct the upper level panels, ensuring the internal ramp access point is correctly aligned.
6. **Attach Roof:** Securely attach the weatherproof roof to the top of the upper level.
7. **Install Doors and Latches:** Attach all access doors using the provided hinges and secure them with the latches. Ensure all doors open and close smoothly and latch securely.
8. **Final Check:** Double-check all screws and connections to ensure the hutch is stable and safe for your pet.

4. OPERATING INSTRUCTIONS

This section details how to use the features of your Aivituvin Rabbit Hutch.

4.1 Accessing the Hutch

- The hutch features **three access areas** for easy interaction with your pet and cleaning. Locate the latches on each door and open them as needed.
- An internal ramp connects the upper and lower levels, allowing your pet to move freely between them.

4.2 Using the Pull-Out Trays

- The hutch is equipped with **two deep pull-out trays** located at the bottom of each level. These trays are designed to catch waste and debris.
- To clean, simply pull the trays out from the front or back. The removable wire mesh above the trays ensures your pet does not stand directly in their waste.

4.3 Mobility and Stability

- The hutch includes **four wheels** for easy movement. To move the hutch, unlock the two brake casters.
- Once the hutch is in the desired position, engage the locks on the brake casters to secure it in place.

4.4 Indoor and Outdoor Use

- The hutch features a **weatherproof roof**, making it suitable for both indoor and outdoor use.
- When used outdoors, ensure it is placed in a location that offers additional protection from direct sun, heavy rain, or strong winds.





Images: The Aivituv Rabbit Hutch shown in both an indoor setting with a rabbit, and an outdoor garden environment, demonstrating its versatility.

5. MAINTENANCE

Regular maintenance is crucial for your pet's health and the longevity of the hutch.

5.1 Daily Cleaning

- **Waste Removal:** Daily remove solid waste from the trays and bedding.
- **Tray Cleaning:** Pull out the trays and empty them. Wipe them clean with a pet-safe disinfectant or mild soap and water. Rinse thoroughly and dry before returning.
- **Water and Food Bowls:** Clean and refill water and food bowls daily.

5.2 Weekly Cleaning

- **Full Bedding Change:** Remove all old bedding and replace with fresh, clean bedding.
- **Hutch Wipe Down:** Wipe down all interior surfaces of the hutch with a pet-safe cleaner. Pay attention to

corners and crevices.

- **Wire Mesh Cleaning:** Remove and clean the wire mesh thoroughly.

5.3 General Care

- **Inspect for Damage:** Periodically check the wood for signs of chewing, splintering, or damage. Repair or replace damaged parts as necessary.
- **Hardware Check:** Ensure all screws, latches, and hinges remain tight and secure. Tighten any loose hardware.
- **Weather Protection:** If used outdoors, consider applying a pet-safe, non-toxic wood sealant annually to enhance weather resistance and prolong the hutch's life.

6. TROUBLESHOOTING

This section addresses common issues you might encounter with your rabbit hutch.

- **Issue: Trays are difficult to pull out or push in.**
Solution: Ensure the hutch is on a level surface. Check for any debris or bedding obstructing the tray runners. Clean the runners if necessary. Inspect the trays for warping; if warped, contact customer support.
- **Issue: Pet is chewing on the wood.**
Solution: This is a natural behavior for rabbits. Provide plenty of appropriate chew toys (like the included chewing toy) to redirect their chewing. Ensure your pet has enough hay, which is essential for their dental health and can reduce chewing on the hutch structure.
- **Issue: Hutch feels unstable or wobbly.**
Solution: Verify that all assembly screws are tightened securely. Ensure the hutch is placed on a completely flat and stable surface. If on wheels, ensure the brake casters are locked when stationary.
- **Issue: Doors do not latch securely.**
Solution: Check if the hinges are properly aligned and tightened. Ensure no wood swelling or debris is preventing the latch from engaging. Adjust or tighten hardware as needed.
- **Issue: Water leakage (if used outdoors).**
Solution: While the roof is weatherproof, extreme weather can still cause issues. Ensure the hutch is placed under additional shelter (e.g., porch, awning). Check the roof for any damage or gaps. Consider applying a pet-safe wood sealant for added protection.

7. SPECIFICATIONS

Feature	Detail
Brand	Aivituvin
Model	Rabbit Hutch Outdoor Large
Material	Fir Wood
Dimensions (L x W x H)	38.6" x 25.6" x 44.2"
Item Weight	52 Pounds
Color	Grey

Special Features	Lockable Caster Wheels, Removable Wire Mesh, Two Pull-Out Trays, Weather Resistant Roof, 3 Access Doors
Recommended Breeds	Large Breeds (Rabbits, Guinea Pigs, etc.)
Intended Use	Indoor & Outdoor Small Animal Housing

8. WARRANTY AND CUSTOMER SUPPORT

Aivituvin stands behind the quality of its products. For specific warranty details, please refer to the warranty card included with your purchase or visit the official Aivituvin website. If you encounter any issues or have questions regarding your Aivituvin Rabbit Hutch, please contact our customer support team.

Aivituvin Customer Support:

Website: [Visit the Aivituvin Store on Amazon](#) (for general inquiries and product information)

Contact Information: Please refer to the contact details provided in your product packaging or on the official Aivituvin website for direct support.

When contacting support, please have your product model (Rabbit Hutch Outdoor Large) and purchase date available.