

SMALLRIG 2918

SMALLRIG Light Weight Camera Cage 2918 Instruction Manual

For Sony A7 III, A7R III, and A9 Cameras

1. INTRODUCTION

The SMALLRIG Light Weight Camera Cage 2918 is designed to provide protection and versatile accessory mounting options for your Sony A7 III, A7R III, and A9 cameras. Constructed from durable aluminum alloy, this formfitting cage ensures full access to all camera controls and ports while enhancing your camera's functionality.



Figure 1: The SMALLRIG Light Weight Camera Cage 2918, shown mounted on a compatible Sony A7R series camera.

2. SETUP AND INSTALLATION

Follow these steps to securely attach the camera cage to your Sony A7 III, A7R III, or A9 camera.

2.1 Attaching the Camera

1. **Prepare the Camera:** Ensure your camera's lens is removed before installation to prevent accidental damage.
2. **Position the Camera:** Gently slide your camera into the cage, aligning the camera's 1/4"-20 tripod socket with the cage's mounting screw.
3. **Secure the Main Screw:** Use the integrated flathead screwdriver, conveniently stored at the bottom of the cage, to tighten the 1/4"-20 screw into your camera's tripod socket. Turn clockwise until snug.
4. **Engage Anti-Twist Pin:** Locate the M2.5 screw on the side of the cage. This screw engages with the camera's strap hole, providing a secondary locking point to prevent twisting. Tighten this M2.5 screw using the appropriate tool (not the

flathead screwdriver).

5. **Verify Security:** Ensure both screws are tightened and the camera is firmly seated within the cage without any play. The rubber padding on the base further enhances stability and prevents scratching.

Product Details

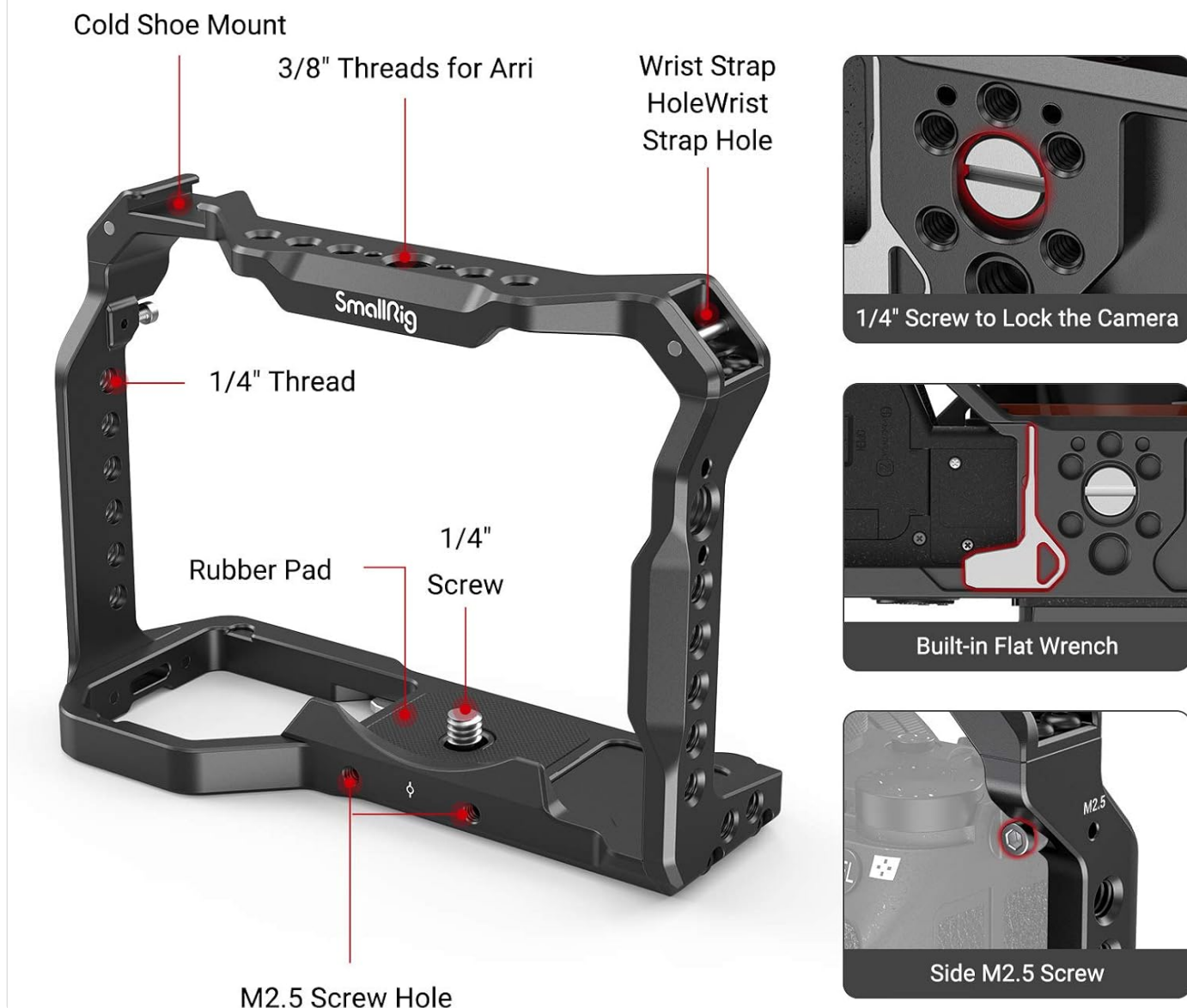

Figure 2: Key attachment points and features of the cage, including the 1/4" screw, M2.5 screw hole, and rubber padding.

Anti-Twisting Design

Locks Camera via the bottom 1/4"-20 screw and a M2.5 screw



Figure 3: Illustration of the anti-twisting mechanism, utilizing both the 1/4"-20 and M2.5 screws for enhanced stability.

2.2 Access to Camera Functions

The cage is precisely designed to maintain full access to all camera buttons, dials, battery compartment, and memory card slot. The hot shoe mount on the camera remains unobstructed, allowing for direct attachment of accessories if preferred.

Designed for Sony A7III A7RIII A9 Camera

Maintains all access to screen, battery, cold shoe & card



Figure 4: The cage design ensures complete access to the camera's screen, battery, cold shoe, and card slots.

2.3 Video Guide: Installation and Features

Your browser does not support the video tag.

Video 1: A detailed overview of the SmallRig camera cage, including installation and various features. This video demonstrates how to mount the camera and highlights key design elements.

3. OPERATING AND ACCESSORY MOUNTING

The cage offers numerous mounting points for expanding your camera rig with various accessories.

3.1 Available Mounting Points

- **1/4"-20 Threaded Holes:** Multiple 1/4"-20 threads are distributed across the cage for attaching accessories such as articulating arms, monitors, or microphones.
- **3/8"-16 Threaded Holes:** Several 3/8"-16 threads are available for heavier accessories or specific mounting plates.
- **ARRI-style Mounts:** Dedicated ARRI-style locating holes prevent accessories from twisting when mounted, ensuring a secure connection.

- **Cold Shoe Mount:** An integrated cold shoe mount on the top of the cage allows for quick attachment of lights, microphones, or other cold shoe compatible accessories.
- **Strap Slot:** A dedicated slot is provided for attaching a wrist or shoulder strap for added security and portability.

Mounting Points

Featuring multiple 1/4"-20, 3/8"-16 holes that allow to mount accessories such as a tripod, etc

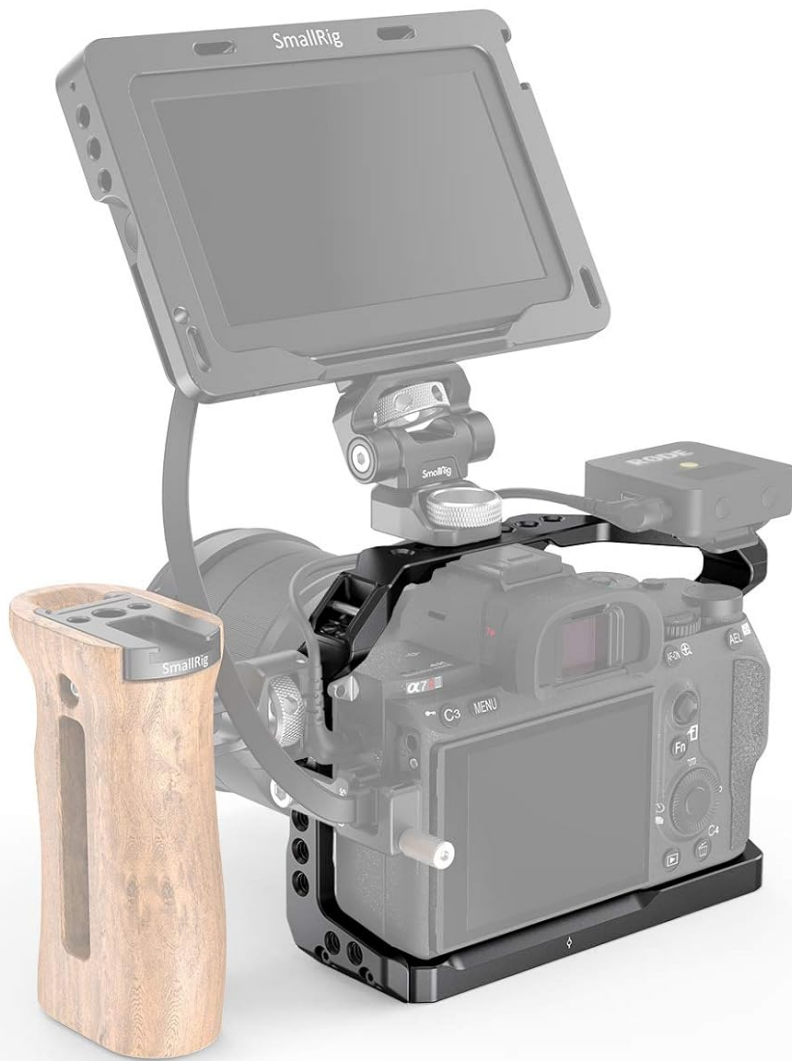

Cold Shoe



Wrist Strap Slot



3/8" Screw
Hole for Arri



1/4"
Screw Hole



Built-in Flat
Wrench

Figure 5: Examples of accessories mounted using the various threaded holes and cold shoe mount on the cage.

3.2 Recommended Accessories

Consider the following SMALLRIG accessories to enhance your setup:

- **Wooden Side Handle 2093:** For comfortable handheld shooting.
- **Cable Clamp 3104:** To protect HDMI and other cables from accidental disconnections.
- **Locating Handle 2165 or Ball Head Magic Arm 2115:** For additional mounting flexibility using ARRI-style mounts.

Your browser does not support the video tag.

Video 2: This video demonstrates the durable protection and various accessory mounting options provided by the camera cage, showcasing its versatility in different shooting scenarios.

4. MAINTENANCE

To ensure the longevity and optimal performance of your SMALLRIG camera cage, follow these simple maintenance guidelines:

- **Cleaning:** Wipe the cage regularly with a soft, dry cloth to remove dust and fingerprints. For stubborn dirt, use a slightly damp cloth and dry thoroughly. Avoid abrasive cleaners or solvents.
- **Inspection:** Periodically check all screws and mounting points for tightness. Re-tighten any loose connections to maintain camera security.
- **Storage:** Store the cage in a dry, clean environment when not in use. If storing with the camera, ensure the camera is properly secured within the cage.

5. TROUBLESHOOTING

If you encounter any issues with your camera cage, refer to the following common solutions:

- **Camera feels loose within the cage:**
Ensure both the 1/4"-20 main mounting screw and the M2.5 anti-twist screw are fully tightened. The M2.5 screw is crucial for preventing rotational play.
- **Difficulty attaching accessories:**
Verify that you are using the correct screw size (1/4"-20 or 3/8"-16) for the accessory. For ARRI-style mounts, ensure the accessory has the corresponding locating pins.
- **Ports or buttons are obstructed:**
The cage is designed for precise fit. Double-check that the camera is correctly seated and aligned within the cage. If issues persist, re-install the camera, ensuring proper alignment before tightening screws.





6. SPECIFICATIONS

| Feature | Detail |
|----------------------|--|
| Model Number | 2918 |
| Compatibility | Sony A7 III, Sony A7R III, Sony A9 |
| Material | Aluminum Alloy |
| Product Dimensions | 143.5 x 106 x 58.5 mm (5.65 x 4.17 x 2.3 inches) |
| Item Weight | 167 g (5.9 ounces) |
| Mounting Points | 1/4"-20 threads, 3/8"-16 threads, ARRI-style mounts, Cold Shoe, Strap Slot |
| Anti-Twist Mechanism | 1/4"-20 camera screw and M2.5 screw for strap hole |
| Included Tool | Integrated Flathead Screwdriver |

7. WARRANTY AND SUPPORT

For warranty information, technical support, or further inquiries, please visit the official SMALLRIG website or contact their customer service directly.
You can also visit the [SMALLRIG Store on Amazon](#) for product details and additional accessories.

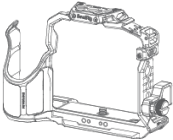
Related Documents - 2918

| | |
|---|---|
| <div><div>SmallRig</div><div><div>Universal Tripod Dolly</div></div></div> | <p>SmallRig Camera Cage for Sony Alpha 7S III (2999) - Operating Instructions</p> <p>Detailed operating instructions and specifications for the SmallRig Camera Cage (Model 2999) designed for the Sony Alpha 7S III camera. Learn about mounting points, safety guidelines, and product details.</p> |
| <div><div>SmallRig</div><div><div>HawkLock Quick Release Cage & Cage Kit For Sony Alpha 7 Series Cameras User Manual</div></div></div> | <p>SmallRig HawkLock Quick Release Cage & Cage Kits for Sony Alpha 7 Series Cameras - User Manual</p> <p>User manual for SmallRig HawkLock Quick Release Cage and Cage Kits (Models 4481, 4538, 4539) for Sony Alpha 7 series cameras. Features specifications, product details, and step-by-step installation guides.</p> |
| <div><div>SmallRig</div><div><div>Full Cage (for Sony Alpha 7R V / Alpha 7 IV / Alpha 7S III / Alpha 1 / Alpha 7R IV)</div></div></div> | <p>SmallRig Full Cage 3667B for Sony Alpha 7R V/IV, 7 IV, 7S III, 1 - Operating Instructions</p> <p>Detailed operating instructions and specifications for the SmallRig 3667B Full Cage, designed for Sony Alpha 7R V, Alpha 7 IV, Alpha 7S III, Alpha 1, and Alpha 7R IV cameras. Learn about features, safety, compatibility, and mounting options.</p> |
| <div><div>SmallRig</div><div><div>Cage for Sony Alpha 9 III User Manual</div></div></div> | <p>SmallRig Cage for Sony Alpha 9 III (Model 4533) User Manual</p> <p>User manual for the SmallRig Cage (Model 4533) designed for the Sony Alpha 9 III camera. Provides detailed installation instructions, product features, and specifications.</p> |
| <div><div><div>NP-FW50 Camera Battery and Charger Kit User Manual</div></div></div> | <p>SmallRig NP-FW50 Camera Battery and Charger Kit User Manual</p> <p>User manual for the SmallRig NP-FW50 Camera Battery and Charger Kit, detailing specifications, charging instructions, battery care, and warranty information for Sony NP-FW50 compatible cameras.</p> |

SmallRig

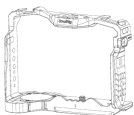

Cage with AirTag Slot
for Sony Alpha 7R V / 7 IV / 7S III / 1 / 7R IV
笼框带（内置AirTag安装槽）
（适用于索尼 Alpha 7R V / 7 IV / 7S III / 1 / 7R IV）
Operating Instruction | 操作指南

[SmallRig Cage with AirTag Slot for Sony Alpha 7R V/7 IV/7S III](#)

Operating instructions and product details for the SmallRig Cage with AirTag Slot, designed for Sony Alpha 7R V, 7 IV, 7S III, and 1/7R IV cameras. Includes specifications, installation steps, and product components.