

Weber Genesis II E/ES 310/610 Series

Weber 66047 Control Knob Kit Instruction Manual

For 2019 and Newer Genesis II E/ES 310/610 Series Grills

1. INTRODUCTION

This manual provides essential information for the proper installation, operation, and maintenance of your Weber 66047 3-Piece Control Knob Kit. Please read these instructions thoroughly before proceeding to ensure correct usage and to maintain the longevity of your grill components.

2. PRODUCT OVERVIEW

The Weber 66047 Control Knob Kit consists of three genuine replacement control knobs designed for specific Weber Genesis II grill models. These knobs allow for precise control over the gas flow to your grill's burners, ensuring optimal cooking performance.



Image 1: Front view of the Weber 66047 control knobs.

3. COMPATIBILITY

This control knob kit is specifically designed for the following Weber grill models:

- 2019 and Newer Weber Genesis II E/ES 310 Series Grills
- 2019 and Newer Weber Genesis II E/ES 610 Series Grills

Each knob has a diameter of 2-3/4 inches and features a 3/8-inch D-shaped hole for shaft connection. Please verify your grill model and existing knob specifications before installation to ensure proper fit.

4. WHAT'S IN THE BOX

Your Weber 66047 Control Knob Kit includes:

- 3 x Weber Control Knobs (Part #66047)

5. SETUP AND INSTALLATION

Follow these steps to install your new control knobs:

1. **Ensure Safety:** Before beginning, ensure your grill is completely off and the gas supply is turned off at the propane tank or natural gas line. Allow the grill to cool down if it has been in use.
2. **Remove Old Knobs:** Gently pull the existing control knobs straight off the valve stems. They are typically held in place by friction.
3. **Inspect Valve Stems:** Check the valve stems for any debris or damage. Clean them if necessary. The valve stems should be D-shaped to match the opening in the new knobs.
4. **Install New Knobs:** Align the D-shaped opening on the back of the new Weber control knob with the D-shaped valve stem on your grill. Push the knob firmly onto the stem until it is seated securely. Ensure the red indicator line on the knob points to the 'OFF' position when the valve is closed.
5. **Test Functionality:** Once all knobs are installed, turn on the gas supply. Carefully test each knob by pushing it in and turning it to the 'IGNITE' position to ensure it engages correctly and the burner ignites. Then turn it back to 'OFF'.



Image 2: Back view of the control knobs, illustrating the D-shaped shaft opening for installation.

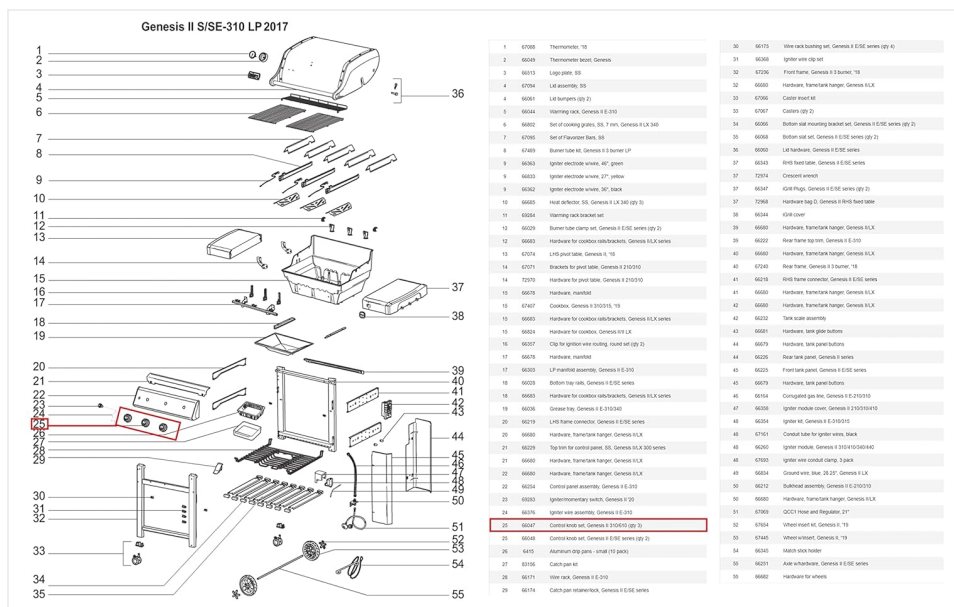

Image 3: Grill schematic showing the location of the control knob set (item 27).

6. OPERATING INSTRUCTIONS

The control knobs regulate the gas flow to the grill burners. To operate:

- **Ignition:** Push the knob in and turn it to the 'IGNITE' position (usually indicated by a lightning bolt or flame symbol) to light the corresponding burner.
- **Adjust Flame:** Once lit, adjust the flame intensity by turning the knob between the 'HIGH' and 'LOW' settings.
- **Turn Off:** To turn off a burner, push the knob in and rotate it to the 'OFF' position.

7. MAINTENANCE

To keep your control knobs in good condition:

- **Cleaning:** Clean the knobs regularly with a soft cloth and mild soap and water. Avoid abrasive cleaners or harsh chemicals, as these can damage the finish.
- **Inspection:** Periodically check the knobs for any signs of wear, cracking, or looseness. Replace them if they are damaged or no longer fit securely.

8. TROUBLESHOOTING

If you encounter issues with your control knobs:

- **Knob is Loose:** Ensure the knob is fully pushed onto the D-shaped valve stem. If it continues to be loose, the internal mechanism may be worn, and replacement is recommended.
- **Knob Does Not Turn:** Do not force the knob. Ensure it is pushed in completely before attempting to turn. If the issue persists, the valve stem or internal valve mechanism may be obstructed or damaged. Consult a qualified technician or Weber support.

9. SPECIFICATIONS

Part Number

66047

Product Type	Control Knobs
Quantity	3 per kit
Compatibility	Weber Genesis II E/ES 310/610 Series Grills (2019 and Newer)
Knob Diameter	2.75 inches (2-3/4")
Shaft Hole Diameter	0.375 inches (3/8") D-hole
Color	Silver/Gray
Material	Plastic with Chrome Trim

10. WARRANTY AND SUPPORT

Weber products are manufactured to high-quality standards and come with a manufacturer's warranty. For specific warranty details, claims, or technical support, please refer to the official Weber website or contact Weber customer service directly. Keep your proof of purchase for warranty purposes.

Weber Customer Support: [Visit Weber Support](#)