

## Manuals+

[Q & A](#) | [Deep Search](#) | [Upload](#)

[manuals.plus](#) /

› [ASHATA](#) /

› [ASHATA 2-in-1 Bluetooth Audio Adapter User Manual](#)

## ASHATA ASHATAw79qp1yore

# ASHATA 2-in-1 Bluetooth Audio Adapter User Manual

Model: ASHATAw79qp1yore

## PRODUCT OVERVIEW

The ASHATA 2-in-1 Bluetooth Audio Adapter is a versatile device designed to seamlessly integrate wireless audio capabilities into your existing sound systems. It functions as both a Bluetooth transmitter and a Bluetooth receiver, allowing you to either send audio wirelessly from non-Bluetooth devices to Bluetooth headphones/speakers or receive audio from Bluetooth-enabled devices to non-Bluetooth speakers/amplifiers. This adapter supports various Bluetooth profiles including A2DP, AVRCP, HFP, SPP, and HID, ensuring broad compatibility.

Equipped with a built-in 600mAh lithium battery, it offers extended playtime and features automatic device search and connection for ease of use. Its compact design and multiple connectivity options (3.5mm audio port, RCA audio cable) make it an ideal solution for home entertainment, car audio, and personal listening.



Figure 1: Top view of the ASHATA 2-in-1 Bluetooth Audio Adapter, highlighting its main controls and mode indicators.

## PACKAGE CONTENTS

---

Please check the package carefully to ensure all items are present and in good condition.

- 1 x ASHATA 2-in-1 Bluetooth Transmitter Receiver Adapter
- 1 x 3.5mm to RCA Audio Cable
- 1 x 3.5mm to 3.5mm Audio Cable
- 1 x Micro USB DC Power Cable
- 1 x User Manual (this document)



Figure 2: All components included in the ASHATA 2-in-1 Bluetooth Audio Adapter package.

## SETUP

Before using the adapter, ensure it is fully charged. Connect the Micro USB DC Power Cable to the adapter's charging port and the other end to a 5V/0.5A USB power source (e.g., computer USB port, USB wall adapter). The charging indicator will show the charging status.

### Charging the Device

1. Locate the Micro USB charging port on the adapter.
2. Connect the supplied Micro USB cable to the adapter and a USB power source.
3. Allow the device to charge until the charging indicator light changes, typically indicating a full charge.

## OPERATING MODES

The ASHATA adapter supports two primary operating modes: Transmitter (TX) and Receiver (RX).

## 1. Receiver Mode (RX)

In Receiver mode, the adapter receives audio wirelessly from a Bluetooth-enabled device (e.g., smartphone, tablet, laptop) and outputs it to a non-Bluetooth audio system (e.g., wired headphones, home stereo, car audio system).

1. **Switch to RX Mode:** Ensure the adapter is in Receiver mode. The device typically has a switch or button to toggle between TX and RX.
2. **Connect to Audio Output:** Use the supplied 3.5mm to 3.5mm audio cable or 3.5mm to RCA audio cable to connect the adapter's 3.5mm output port to the audio input of your non-Bluetooth device (e.g., AUX-in on a speaker, headphone jack on an amplifier).
3. **Pair with Bluetooth Device:** Turn on the adapter. It will automatically enter pairing mode (indicated by a flashing LED). On your Bluetooth-enabled device (e.g., phone), search for Bluetooth devices and select "ASHATA Adapter" (or similar name) to pair.
4. **Play Audio:** Once paired, play audio on your Bluetooth device, and the sound will be transmitted wirelessly to your connected audio system.

# Support AUX OUT, earphone



Figure 3: Illustration of the adapter functioning in Receiver mode, connecting to headphones via AUX OUT.

## 2. Transmitter Mode (TX)

In Transmitter mode, the adapter takes audio from a non-Bluetooth device (e.g., TV, CD player, PC) and transmits it wirelessly to a Bluetooth-enabled audio device (e.g., Bluetooth headphones, Bluetooth speaker).

1. **Switch to TX Mode:** Ensure the adapter is in Transmitter mode.
2. **Connect to Audio Source:** Use the supplied 3.5mm to 3.5mm audio cable or 3.5mm to RCA audio cable to connect the adapter's 3.5mm input port to the audio output of your non-Bluetooth device (e.g., headphone jack on a

TV, audio out on a CD player).

3. **Pair with Bluetooth Receiver:** Turn on the adapter. It will automatically enter pairing mode. Put your Bluetooth headphones or speaker into pairing mode. The adapter will automatically search for and connect to nearby Bluetooth receiving devices.
4. **Play Audio:** Once connected, play audio from your non-Bluetooth source, and the sound will be transmitted wirelessly to your Bluetooth headphones/speaker.

## Support stereo encoder and decoder

Supports HFP, HSP, A2DP, AVRCP and SPP configuration files



Figure 4: Illustration of the adapter functioning in Transmitter mode, connecting a TV to Bluetooth speakers.

# Automatic memory connected function

Operation easier, more convenient

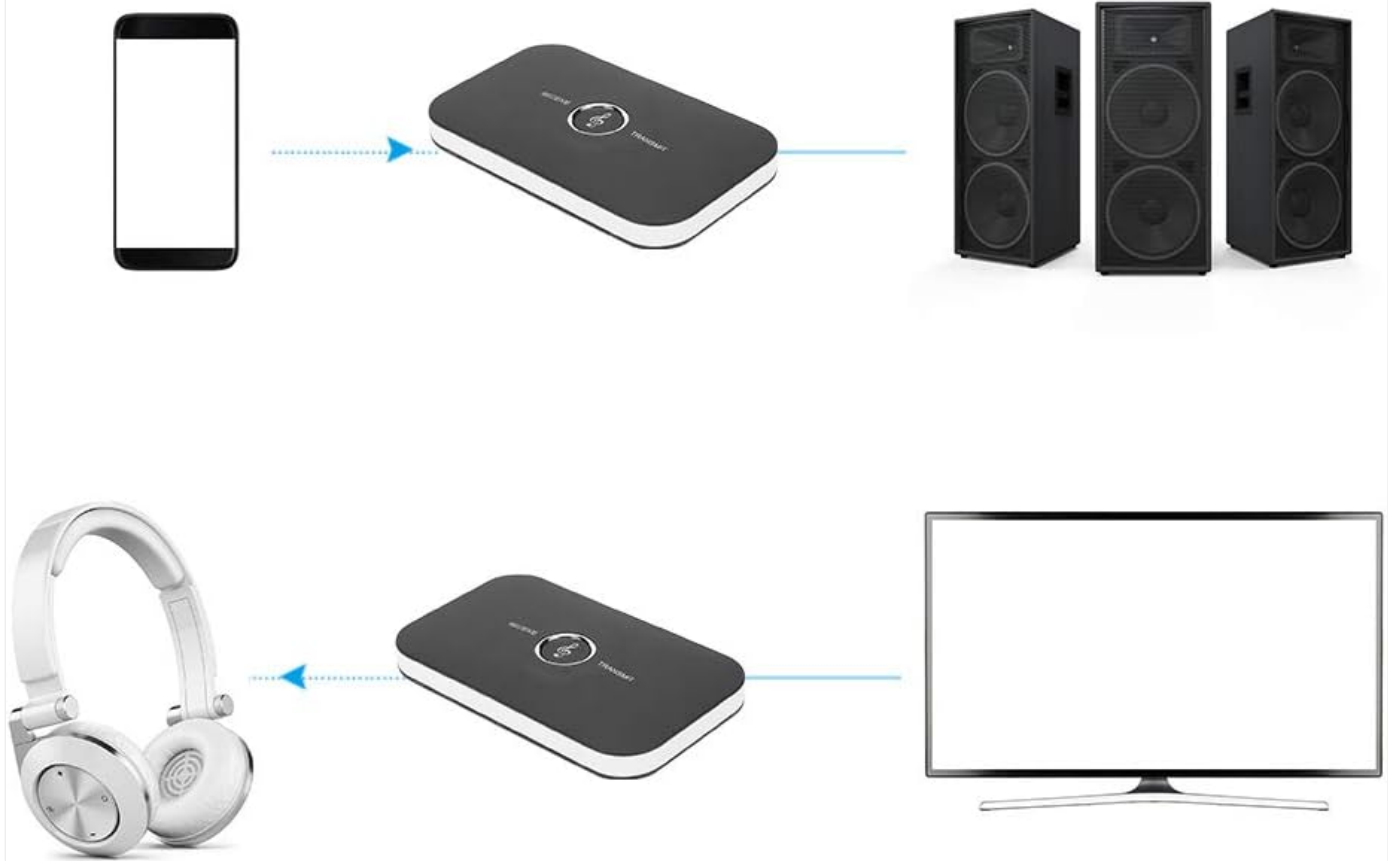

Figure 5: The adapter's automatic memory function for previously connected devices, simplifying operation.

## MAINTENANCE

To ensure the longevity and optimal performance of your ASHATA Bluetooth Audio Adapter, follow these maintenance guidelines:

- **Cleaning:** Use a soft, dry cloth to clean the surface of the device. Do not use liquid cleaners or aerosols, as they may damage the electronics.
- **Storage:** Store the adapter in a cool, dry place away from direct sunlight and extreme temperatures.
- **Battery Care:** For optimal battery life, avoid fully discharging the battery frequently. If storing for a long period, charge the device to about 50% every few months.
- **Avoid Impacts:** Protect the device from drops and impacts, which can damage internal components.
- **Moisture:** Keep the device away from water and high humidity.

## TROUBLESHOOTING

If you encounter issues with your ASHATA Bluetooth Audio Adapter, please refer to the following common problems and solutions:

| Problem                                | Possible Cause   | Solution   |
|--|--|--|
| Device does not power on.              | Low battery or no charge.  | Charge the device fully using the supplied Micro USB cable.  |
| Cannot pair with a Bluetooth device.   | Device not in pairing mode; too far from the source; interference; previously paired device connected. | Ensure the adapter is in the correct TX/RX mode and pairing mode (flashing LED). Move devices closer. Turn off other Bluetooth devices. Clear previous pairings if necessary.                                      |
| No audio output/input.                 | Incorrect cable connection; wrong mode (TX/RX); volume too low; source device not playing.             | Verify all cables are securely connected to the correct ports. Confirm the adapter is in the correct TX or RX mode. Increase volume on both the adapter and connected devices. Ensure the audio source is playing. |
| Audio quality is poor or intermittent. | Distance too far; obstacles; interference from other wireless devices.                                 | Reduce the distance between the adapter and the connected Bluetooth device. Remove obstacles. Minimize interference from Wi-Fi routers or other Bluetooth devices.   |

## SPECIFICATIONS

| Feature                      | Detail  |
|------------------------------|---|
| Product Type                 | 2-in-1 Bluetooth Transmitter Receiver Adapter |
| Material                     | ABS   |
| Color                        | Black   |
| Bluetooth Protocols          | A2DP, AVRCP, HFP, SPP, HID                    |
| Bluetooth Version (TX)       | V2.1  |
| Bluetooth Version (RX)       | V4.0  |
| Receiving Working Current    | ≤43mA   |
| Transmitting Working Current | ≤60mA   |
| Standby Current              | <18mA   |
| Battery Type                 | Polymer Lithium Battery                       |
| Battery Capacity             | 600mAh  |
| Charging Current             | 300mA   |
| Play Time                    | > 8 hours                                     |
| Bluetooth Distance           | > 10 meters                                   |
| Charging Mode                | Micro USB 5V/0.5A                             |
| Output Connection            | 3.5mm Stereo Audio Port                       |

| Feature          | Detail  |
|------------------|---|
| Input Connection | 3.5mm Stereo Audio Port                                     |
| Compatibility    | Android/iOS phones, Tablet PCs, all Bluetooth audio devices |
| Weight           | Approx. 105g  |
| Model Number     | ASHATAw79qp1yore  |
| ASIN             | B08MLHN6FS  |

## WARRANTY AND SUPPORT

Information regarding specific warranty terms and customer support for ASHATA products may vary by region and retailer. Please refer to the documentation provided with your purchase or visit the official ASHATA website for detailed warranty information and support contacts.

For technical assistance or inquiries, please contact your point of purchase or the manufacturer directly. Keep your purchase receipt as proof of purchase for warranty claims.