

[manuals.plus](#) /

› [Yaheetech](#) /
› [Yaheetech Home Office Wood Computer Desk with Keyboard Tray and Drawers, Students Writing Table with Storage Drawers & Hutch, Modern PC Laptop Desk, Multifunctional Workstation, White](#)

Yaheetech YT-00099536

Yaheetech Home Office Wood Computer Desk User Manual

Model: YT-00099536

1. PRODUCT OVERVIEW

The Yaheetech Home Office Wood Computer Desk is a versatile and compact workstation designed for various uses, including studying, writing, and general office tasks. It features a spacious desktop, a convenient pull-out keyboard tray, a storage drawer, and integrated shelving with a hutch for organization.



Image 1.1: Overview of the Yaheetech Home Office Wood Computer Desk in white, showcasing its compact design with a hutch, keyboard tray, and side storage.

Its durable construction and thoughtful design make it an ideal solution for optimizing space in home offices, student rooms, or apartments.

2. SAFETY INFORMATION

Important Safety Notice:

- For your safety, please do not stand or sit on the desktop.
- Ensure all screws and fasteners are securely tightened during assembly to prevent instability.

- Keep small parts away from children during assembly to avoid choking hazards.
- Regularly check all connections to ensure they remain tight and secure.

A detailed Safety Information PDF is available for download from the product's Amazon page for further guidance.

3. SETUP AND ASSEMBLY

Your Yaheetech Computer Desk is designed for straightforward assembly. All necessary tools are included. It is recommended that one person assembles the desk.

3.1. Assembly Video Guide

Your browser does not support the video tag.

Video 3.1: Official installation guide for the Yaheetech Computer Desk. This video provides step-by-step visual instructions for assembling the desk components, including attaching drawer slides, assembling the drawer, and securing the hutch.

3.2. General Assembly Tips

- Unpack all components and verify against the parts list provided in the physical manual. All parts are typically numbered for easy identification.
- Lay out all hardware and tools.
- Follow the numbered steps in the instruction manual carefully.
- Avoid overtightening screws, especially when working with MDF, to prevent cracking the wood.
- Ensure all connections are flush and stable before proceeding to the next step.

For detailed written instructions and diagrams, please refer to the Installation Manual (PDF) available on the product's Amazon page.

4. OPERATING INSTRUCTIONS

The Yaheetech Computer Desk is designed for ease of use and efficient organization.

4.1. Keyboard Tray

The pull-out keyboard tray provides a convenient space for your keyboard and mouse, keeping your main desktop clear. It operates on high-quality, smooth-sliding rails for effortless extension and retraction.



Image 4.1: The pull-out keyboard tray fully extended, showing its smooth operation.

4.2. Storage Drawer

The integrated storage drawer offers a discreet space for small office supplies, documents, or personal items. The drawer features smooth-sliding mechanisms and an oblate line-shaped handle for comfortable and safe use.



Image 4.2: The desk's single storage drawer, partially open, revealing its interior space.

4.3. Shelving and Hutch

The desk includes open shelving and a hutch design, providing ample space for books, decorative items, or a small printer. The lower shelf can be adjusted or removed to accommodate a PC tower, offering flexible storage solutions.

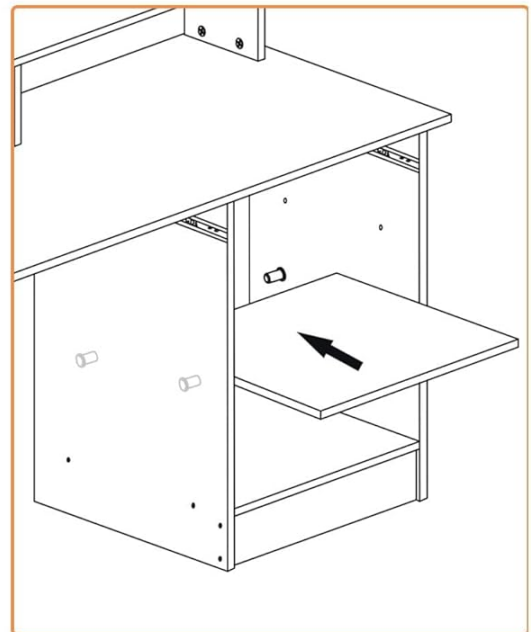
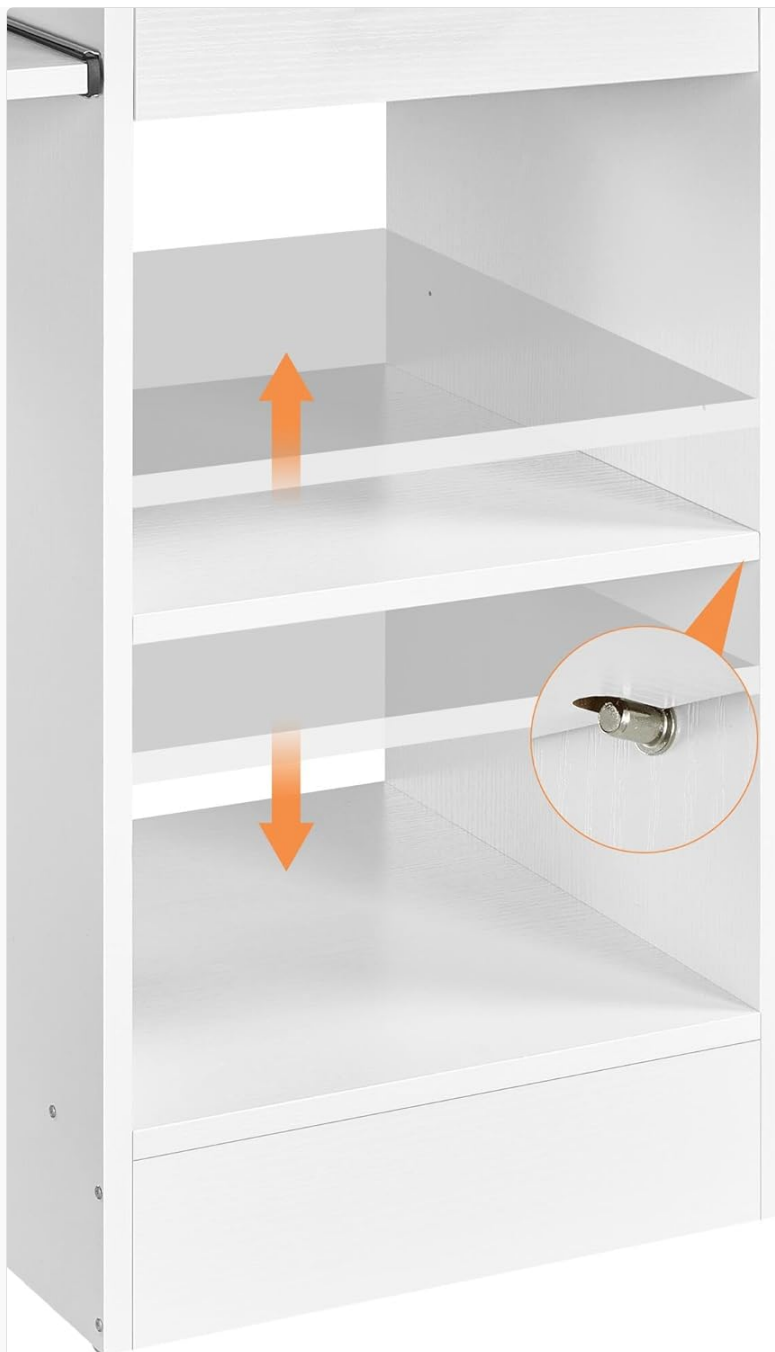

Height adjustable as needed



Removable for storing PC tower

Image 4.3: The adjustable shelf on the side of the desk, designed to accommodate a PC tower or other items.

5. MAINTENANCE

To ensure the longevity and appearance of your Yaheetech Computer Desk, follow these simple maintenance guidelines:

- **Cleaning:** Wipe the veneered laminated desktop and other surfaces with a damp cloth. Avoid using harsh chemicals or abrasive cleaners, which can damage the finish.
- **Spills:** The veneered surface is water-resistant. In case of spills, wipe them immediately with a dry cloth to prevent water damage.
- **Protection:** While the surface is scratch-resistant, using coasters for drinks and protective pads under heavy or sharp objects is recommended to maintain its pristine condition.
- **Hardware:** Periodically check all screws and fasteners to ensure they are tight. Retighten if necessary to maintain stability.



Image 5.1: Close-up of the desk surface showing its water-resistant properties, making it easy to clean spills.

6. TROUBLESHOOTING

If you encounter any issues with your Yaheotech Computer Desk, consider the following common troubleshooting steps:

Problem	Possible Cause	Solution
Desk is wobbly or unstable.	Loose fasteners or uneven assembly.	Check and tighten all screws and bolts. Ensure the desk is on a level surface.
Drawer or keyboard tray sticks.	Misaligned slides or debris in the tracks.	Ensure slides are correctly installed and aligned. Clean tracks of any dust or debris.
Missing parts during assembly.	Packaging error.	Contact Yaheotech customer support with your product model and a description of the missing parts.

7. SPECIFICATIONS

Detailed specifications for the Yaheotech Home Office Wood Computer Desk:

- **Brand:** Yaheotech
- **Model Number:** YT-00099536
- **Color:** White
- **Material:** Engineered Wood (CARB P2-compliant MDF) with Veneered Surface
- **Product Dimensions (D x W x H):** 20" x 42" x 37"
- **Item Weight:** 58.2 Pounds
- **Maximum Weight Recommendation (Tabletop):** 110.2 Pounds (50 kg)
- **Maximum Weight Recommendation (Drawer):** 11 Pounds
- **Maximum Weight Recommendation (Compartment Board):** 22 Pounds
- **Maximum Weight Recommendation (Keyboard Tray):** 11 Pounds
- **Number of Drawers:** 1
- **Number of Shelves:** 1 (adjustable)
- **Assembly Required:** Yes (Includes All Assembly Tools)

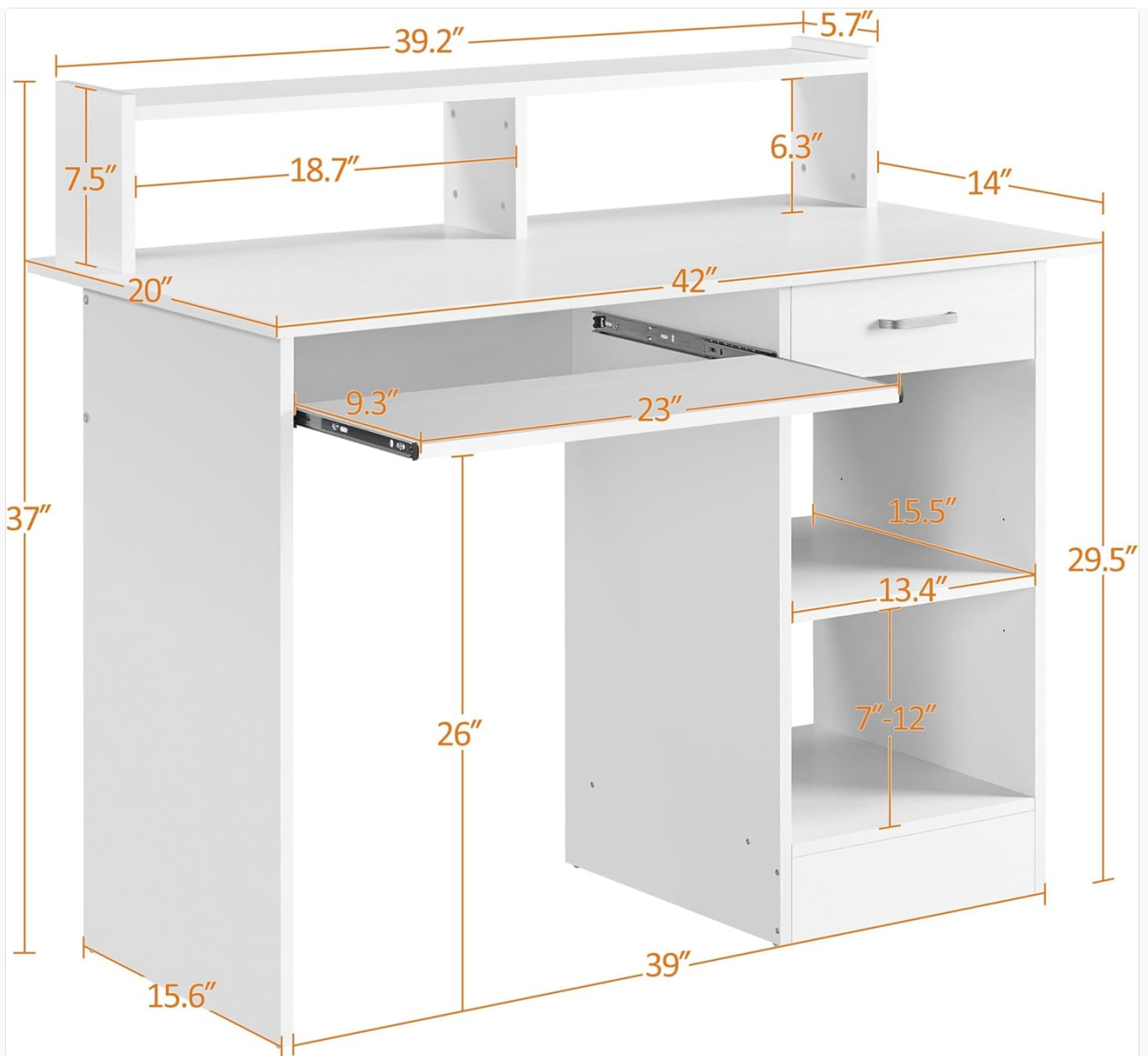

Image 7.1: Dimensional diagram of the Yaheetech Computer Desk, providing detailed measurements.

8. WARRANTY AND SUPPORT

Yaheetech is committed to providing quality products and customer satisfaction.





8.1. Returns and Protection Plans

- This product is eligible for 30-day easy returns.
- Optional protection plans are available for purchase, including 2-Year and 3-Year Protection Plans, and a monthly Complete Protect plan. Please refer to the product's purchase page for details on coverage and pricing.

8.2. Customer Support

For any inquiries, assistance with assembly, or to report missing/damaged parts, please contact Yaheetech Customer Support. Contact information can typically be found on the product's packaging or the official Yaheetech store page on Amazon.

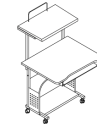
Related Documents - YT-00099536

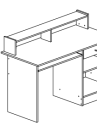
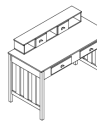
<p>Yaheetech</p> <p>Laptop Desk Table Model #510977 Assembly Instructions</p>  <p>Read Instructions Read these instructions carefully before using the product. Please read the entire manual thoroughly before assembly. Follow the instructions in the order they are given. Do not skip any steps. If you have any questions, please contact our customer service.</p>	<p>Yaheetech Laptop Desk Table Assembly Instructions (Model #510977)</p> <p>This guide provides comprehensive assembly instructions for the Yaheetech Laptop Desk Table, model #510977. It includes a detailed parts list, fitting details, and step-by-step directions for safe and correct assembly of the workstation.</p>
<p>Yaheetech</p> <p>614333</p>  <p>Read Instructions Read these instructions carefully before using the product. Please read the entire manual thoroughly before assembly. Follow the instructions in the order they are given. Do not skip any steps. If you have any questions, please contact our customer service.</p>	<p>Yaheetech 614333 Computer Desk Assembly Instructions</p> <p>Step-by-step assembly guide for the Yaheetech 614333 computer desk. Includes a detailed parts list, safety warnings, and clear instructions for building your workstation.</p>
<p>Yaheetech</p> <p>611942</p>  <p>Read Instructions Read these instructions carefully before using the product. Please read the entire manual thoroughly before assembly. Follow the instructions in the order they are given. Do not skip any steps. If you have any questions, please contact our customer service.</p>	<p>Yaheetech 611942 Computer Desk Assembly Instructions</p> <p>Detailed assembly instructions for the Yaheetech 611942 computer desk, including parts list, step-by-step guidance, safety precautions, and product care information.</p>
<p>Yaheetech</p> <p>611097</p>  <p>Read Instructions Read these instructions carefully before using the product. Please read the entire manual thoroughly before assembly. Follow the instructions in the order they are given. Do not skip any steps. If you have any questions, please contact our customer service.</p>	<p>Yaheetech Drafting Table Assembly Instructions</p> <p>Comprehensive assembly instructions for the Yaheetech Drafting Table (Model # 611097), including parts list, safety warnings, and step-by-step guidance for building the desk and stool.</p>
<p>Yaheetech</p> <p>614325</p>  <p>Read Instructions Read these instructions carefully before using the product. Please read the entire manual thoroughly before assembly. Follow the instructions in the order they are given. Do not skip any steps. If you have any questions, please contact our customer service.</p>	<p>Yaheetech 614325 Desk Assembly Instructions</p> <p>Comprehensive assembly guide for the Yaheetech 614325 desk, detailing parts, hardware, and step-by-step instructions with textual descriptions of diagrams. Includes safety warnings and contact information.</p>
<p>Yaheetech</p> <p>614082</p>  <p>Read Instructions Read these instructions carefully before using the product. Please read the entire manual thoroughly before assembly. Follow the instructions in the order they are given. Do not skip any steps. If you have any questions, please contact our customer service.</p>	<p>Yaheetech 614082 Desk Assembly Instructions</p> <p>Comprehensive assembly instructions for the Yaheetech 614082 desk, including parts list, safety information, and step-by-step guidance for assembly.</p>