

Lexon MINO T (LA124K9)

Lexon MINO T Portable Bluetooth Speaker User Manual

Model: LA124K9 | Brand: Lexon

1. INTRODUCTION

Thank you for choosing the Lexon MINO T Portable Bluetooth Speaker. This manual provides essential information for the proper setup, operation, and maintenance of your device. The MINO T is designed for portability and durability, featuring a carabiner for easy attachment and IPX4 water resistance, making it suitable for both indoor and outdoor use.

2. WHAT'S IN THE BOX

- Lexon MINO T Portable Bluetooth Speaker
- USB-C Charging Cable
- Charging Dock
- User Manual

3. SETUP

3.1 Powering On/Off

- To power on: Press and hold the power button located on the bottom of the speaker until the LED indicator lights up.
- To power off: Press and hold the power button again until the LED indicator turns off.

3.2 Bluetooth Pairing

1. Ensure the speaker is powered on and the LED indicator is blinking, indicating it is in pairing mode.
2. On your device (smartphone, tablet, laptop), enable Bluetooth and search for available devices.
3. Select 'MINO T' from the list of devices.
4. Once connected, the LED indicator will stop blinking and remain solid.

3.3 Initial Charging

Before first use, fully charge your MINO T speaker. Refer to the 'Charging' section for detailed instructions.

4. OPERATING INSTRUCTIONS

4.1 Music Playback

- After successful Bluetooth pairing, open your music application on your connected device.
- Control playback (play/pause, skip tracks, volume) directly from your device.

4.2 Hands-Free Calls

- When a call comes in, the speaker will ring.
- Press the power button once to answer an incoming call.
- Press the power button once again to end a call.

4.3 Carabiner Functionality

The integrated carabiner allows for versatile attachment. Press the small lever on the carabiner to open it and clip the speaker to your bag, belt loop, or other items. The carabiner can also be folded flat against the speaker for compact storage.

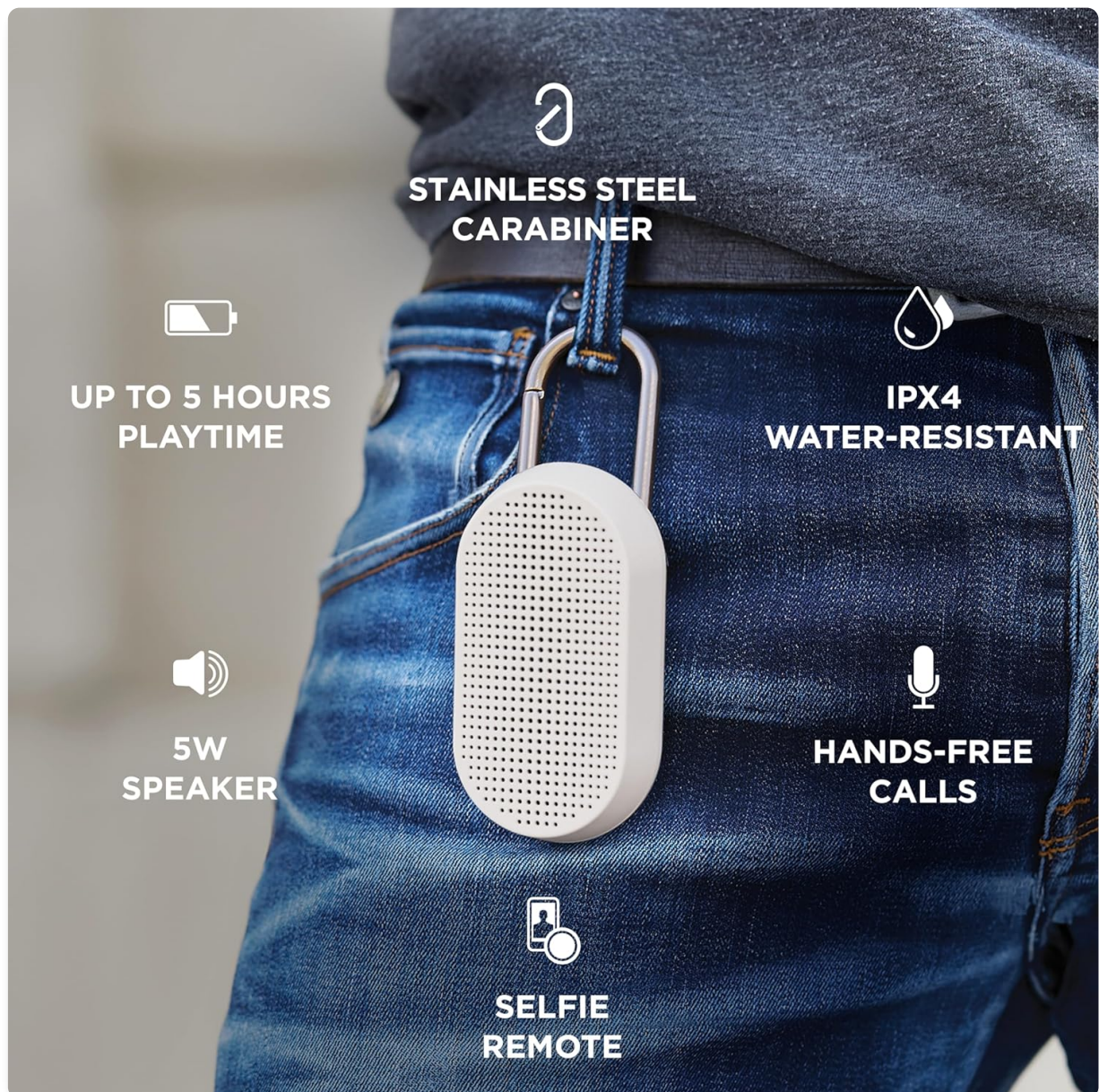

Image: Lexon MINO T speaker with key features highlighted, including the carabiner.

4.4 Selfie Remote Function

The MINO T speaker can also function as a remote shutter for your smartphone camera. Consult your device's camera settings or the speaker's detailed manual for specific activation steps.

5. CHARGING

The MINO T speaker is rechargeable via the included USB-C cable and docking station. It offers up to 5 hours of continuous playtime on a full charge.

1. Connect the USB-C cable to the charging port on the speaker or directly to the charging dock.
2. Plug the other end of the USB-C cable into a compatible USB power source (e.g., computer, wall adapter).
3. The LED indicator will show charging status (e.g., solid red for charging, off or solid green for fully charged).
4. For convenient charging and display, place the speaker into its dedicated docking station.

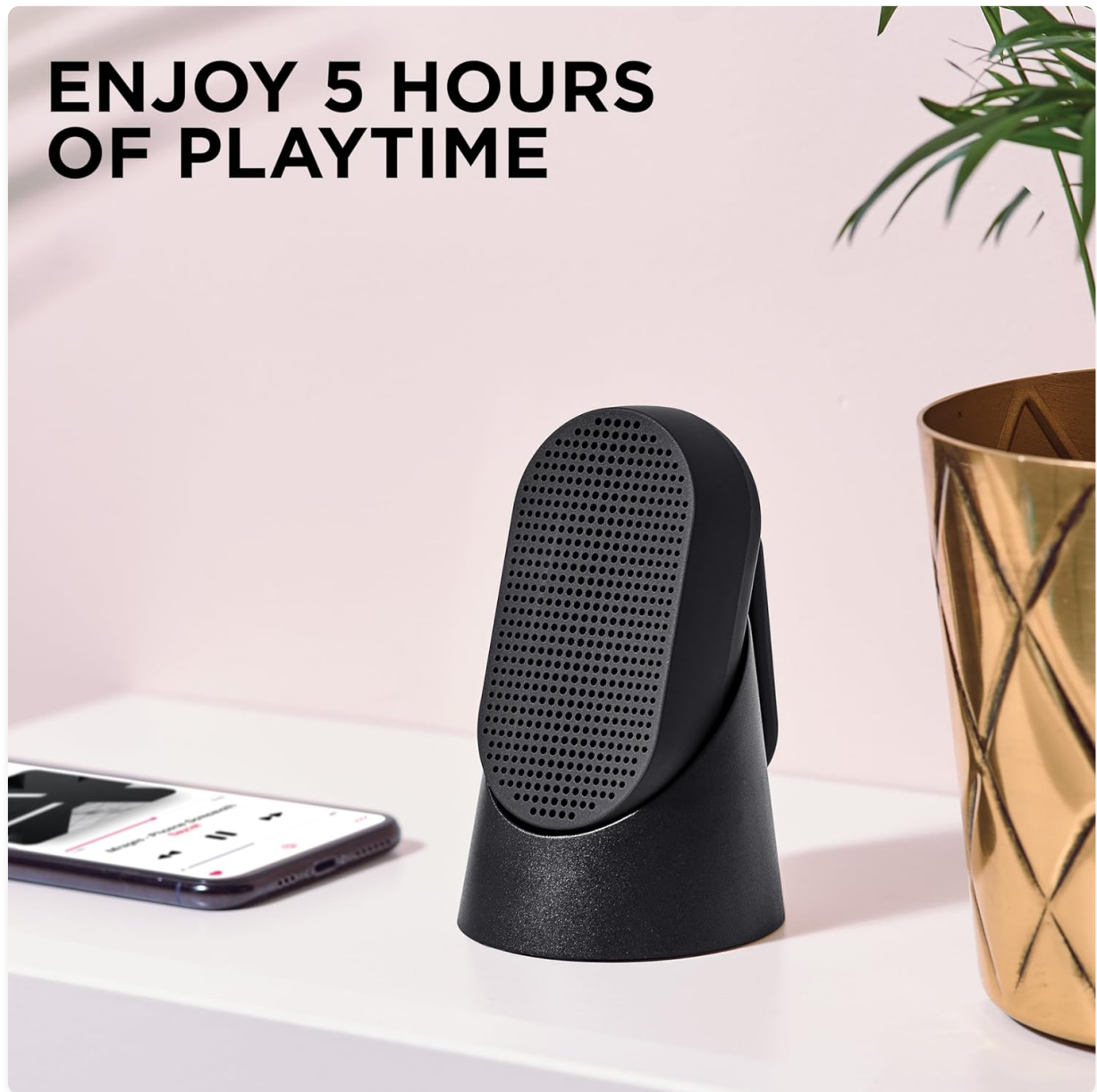

Image: Lexon MINO T speaker charging on its dock, ready for extended use.

6. WATER RESISTANCE (IPX4)

The Lexon MINO T speaker features an IPX4 water-resistant rating. This means it is protected against

splashing water from any direction. It is suitable for outdoor use and can withstand light rain or splashes, but it should not be submerged in water.



Image: A red MINO T speaker with water droplets, illustrating its splash-resistant design.

7. MAINTENANCE

- **Cleaning:** Use a soft, dry cloth to clean the speaker. Do not use abrasive cleaners or solvents.
- **Storage:** Store the speaker in a cool, dry place away from direct sunlight and extreme temperatures.
- **Water Exposure:** After exposure to water, ensure the speaker is dry before charging to prevent damage.

8. TROUBLESHOOTING

8.1 Speaker Not Powering On

- Ensure the speaker is fully charged. Connect it to a power source and allow it to charge for at least 30 minutes before attempting to power on again.

8.2 Unable to Pair via Bluetooth

- Make sure the speaker is in pairing mode (LED indicator blinking).
- Ensure Bluetooth is enabled on your device and it is within the 10-meter range.
- Try forgetting the device from your phone's Bluetooth settings and re-pairing.
- Restart both the speaker and your device.

8.3 No Sound or Low Volume

- Check the volume levels on both the speaker and your connected device.
- Ensure the speaker is properly paired and connected to your device.
- Move the speaker closer to your device to avoid interference.

8.4 Charging Issues

- Verify that the USB-C cable is securely connected to both the speaker/dock and the power source.
- Try using a different USB-C cable or power adapter.
- Ensure the charging port on the speaker is clean and free of debris.

9. SPECIFICATIONS

Model Name	LA124K9
Speaker Type	Outdoor
Special Feature	Portable
Recommended Uses	Outdoor, Indoors
Compatible Devices	Laptop, MP3 Player, Smartphone, Tablet
Product Dimensions	2.08"D x 1.14"W x 3.81"H
Item Weight	0.27 Pounds (4.3 ounces)
Water Resistance Level	Water Resistant (IPX4)
Power Source	Battery Powered
Wireless Communication Technology	Bluetooth
Battery Capacity	Up to 5 Hours
Speaker Maximum Output Power	5 Watts
Connectivity Technology	Bluetooth, USB
Audio Output Mode	Stereo
Mounting Type	Clip On, Freestanding
Control Method	Touch

10. WARRANTY AND SUPPORT

The Lexon MINO T Portable Bluetooth Speaker comes with a limited warranty. For detailed warranty information, please refer to the warranty card included in your product packaging or visit the official Lexon

website.

For technical support, troubleshooting assistance, or any product-related inquiries, please contact Lexon customer support through their official channels. Keep your purchase receipt and product model number (LA124K9) handy when contacting support.