

HENEX HC-3208R

HENEX HC-3208R 2D Bluetooth Barcode Scanner User Manual

Model: HC-3208R | Brand: HENEX

1. INTRODUCTION

The HENEX HC-3208R is a versatile 2D Bluetooth Barcode Scanner designed for various applications, including retail and inventory management. It offers 3-in-1 connectivity options: USB wired, 2.4G wireless, and Bluetooth, ensuring compatibility with a wide range of devices and operating systems such as Windows, Android, iOS, and Mac. This manual provides detailed instructions for setting up and operating your scanner.



Figure 1: HENEX HC-3208R 2D Bluetooth Barcode Scanner

2. PACKAGE CONTENTS

Please check the package for the following items:

- HENEX HC-3208R Barcode Scanner
- USB Charging Cable
- 2.4G Wireless USB Receiver (Dongle)
- Instruction Manual

3. SETUP AND CONNECTIVITY

3.1 Charging the Scanner

Before initial use, fully charge the scanner using the provided USB cable and a 5V/1A power adapter. The indicator light will show blue and red while charging, and will turn off or change color when fully charged.

Two Upload Modes

Built-in Flash Memory, supports 2 upload modes

1. Instant Upload Mode



Synchronously upload barcodes to your computer.

2.Storage Mode



Store up 2000 barcodes and you can upload it whenever you need it.

Figure 2: Battery and Charging Details (9h scanning, 60 days standby, 5h charging for 2200mAh battery)

3.2 Connectivity Modes

The HC-3208R scanner supports three connectivity modes: 2.4G Wireless, Bluetooth, and USB Wired. The default factory setting is 2.4G wireless mode.

3-IN-1 Connection |



Figure 3: Overview of 3-in-1 Connectivity Options

3.2.1 2.4G Wireless Connection (Default)

The scanner is pre-configured for 2.4G wireless mode. Simply plug the 2.4G USB receiver (dongle) into your computer's USB port. The scanner will automatically connect. No software or drivers are required for this mode (Plug and Play).

To re-pair the 2.4G wireless connection, scan the "Receiver mode(*)" barcode from the instruction manual, then plug in the USB receiver. The indicator light will flash green, then turn solid green upon successful pairing.

3.2.2 Bluetooth Connection

To use Bluetooth mode:

1. Scan the "Bluetooth HID mode" barcode from the instruction manual. The scanner's indicator light will flash blue and green, indicating it's waiting for pairing.
2. On your device (phone, tablet, or computer), open Bluetooth settings and search for "Barcode Scanner HID".
3. Select "Barcode Scanner HID" to connect. The scanner will beep, and the indicator light will stop flashing, turning solid blue or green to confirm successful pairing.
4. To pair with a different device, scan the "Pair setting" barcode from the instruction manual to enter pairing mode again.

3.2.3 USB Wired Connection

Connect the scanner directly to your computer using the provided USB cable. The scanner will function as a wired scanner and will also charge simultaneously. No additional setup is required.

4. OPERATING MODES

The scanner offers various scanning modes to suit different operational needs.

4.1 Trigger Modes

- **Manual Scan Mode:** Press the trigger button to scan each barcode.
- **Auto Sensing Mode:** The scanner automatically detects and scans barcodes when they are presented within its scanning range, without needing to press the trigger.
- **Continuous Scan Mode:** The scanner continuously emits a scan beam, scanning any barcode it detects.

Manual scan mode



Manual scan mode
setting code



Figure 4: Manual Scan Mode

Auto sensing mode



Auto sensing mode
setting code



Figure 5: Auto Sensing Mode

Continuous scan mode



Continuous scan mode
setting code



Figure 6: Continuous Scan Mode

4.2 Inventory (Offline Storage) Mode

The scanner features an offline storage function, allowing it to store up to 512,000 barcode entries. This is useful for inventory tasks where real-time data transmission is not always possible.

- **Entering Inventory Mode:** Scan the "Inventory Mode" barcode from the instruction manual.

- **Storing Barcodes:** Once in Inventory Mode, scanned barcodes are stored directly in the scanner's memory.
- **Uploading Data:** To upload stored data to your connected device, scan the "Upload data" barcode from the instruction manual.
- **Deleting Data:** To clear all stored barcode information from the scanner, scan the "Delete all data" barcode from the instruction manual. This prevents exceeding storage capacity.
- **Exiting Inventory Mode:** To return to normal scanning operation, scan the "Immediate Mode" barcode from the instruction manual.

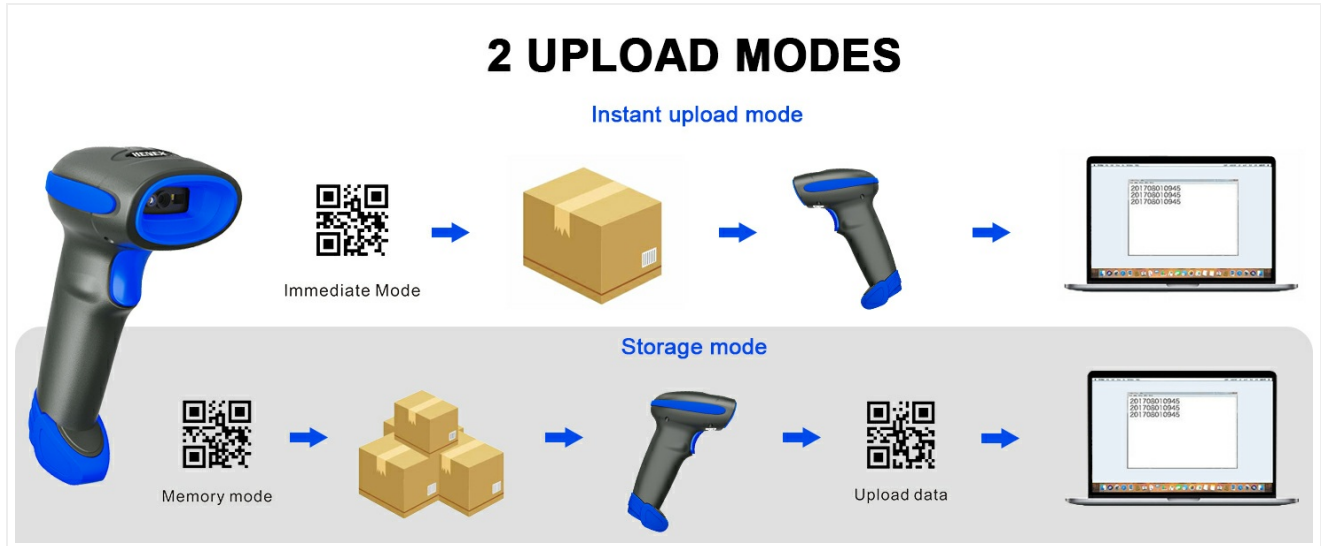

Figure 7: Instant Upload Mode and Storage Mode

5. DECODING CAPABILITIES

The HC-3208R scanner is capable of accurately reading a wide variety of 1D and 2D barcodes, including those that are faded, damaged, or displayed on screens.

- **1D Barcodes:** Code 128, UPC/EAN (including plugins 2 or 5), Code 39, Codabar, GS1 RSS, MSI, ISBN/ISSN.
- **2D Barcodes:** PDF417, DataMatrix, QR Code, Micro QR, Maxicode.
- **Special Conditions:** Reads barcodes from paper, screens (mobile phones, computers), color codes, special barcodes, and anti-white QR codes.



Figure 8: Supported Barcode Types and Scanning Capabilities

6. ADVANCED FEATURES

- **Long-Distance Transmission:**
 - Bluetooth: Up to 15 meters (49 feet) in environments with obstacles.
 - 2.4G Wireless: Up to 30 meters (98 feet) in environments with obstacles.
- **Multilingual Support:** Defaults to English keyboard mode and supports settings for Italian, German, French, Spanish, and other languages.
- **Data Customization:** Supports adding prefixes/suffixes, date & time as prefix or suffix, interception customization, and adding special characters to scanned data.

Barcode Scanner Supports the Identification and Scanning of the following Barcodes



Figure 9: Wireless Transmission Ranges



Figure 10: Barcode Data Customization Options

7. SPECIFICATIONS

Feature	Detail
Brand	HENEX
Model	HC-3208R
Product Dimensions	10 x 6.9 x 17.4 cm
Item Weight	190 g
Battery	1 Lithium Ion (2200mAh)

Operating System Compatibility	Android, Windows, iOS, Mac OS, Linux
Scan Rate	1500 fps
Connectivity Technology	Bluetooth, 2.4G Wireless, USB Cable
Special Features	Built-in offline storage (512,000 notes), Plug and Play, Manual/Automatic/Continuous scan modes

Built-in 2200 mAh battery



9h

Scanning Time



60days

Standby Time



5h

Charging Time

2200mAh



Figure 11: Physical Dimensions of the Scanner

8. TROUBLESHOOTING

- **Scanner not connecting:** Ensure the scanner is charged. For 2.4G wireless, ensure the USB receiver is properly plugged in and re-pair if necessary by scanning the "Receiver mode(*)" barcode. For Bluetooth, ensure Bluetooth is enabled on your device and re-pair by scanning the "Bluetooth HID mode" and "Pair setting" barcodes.
- **Scanning issues:** Ensure the barcode is clean and not excessively damaged. Try different scanning modes

(manual, auto, continuous). Check if the scanner is in the correct communication mode.

- **Data not uploading in Inventory Mode:** Ensure you have scanned the "Upload data" barcode. Check the connection to your device.
- **Battery low:** Connect the scanner to a power source using the USB cable. The indicator light will show charging status.
- **Factory Reset:** If experiencing persistent issues, you can perform a factory reset by scanning the "Factory default" barcode in the instruction manual. This will revert all settings to their original state.

9. WARRANTY AND SUPPORT

For technical assistance, warranty claims, or further inquiries, please contact HENEX customer support.

- **Email Support:** support@lenvii.net
- **Manufacturer:** HENEX



Figure 12: Support Contact Details