

Manuals+

[Q & A](#) | [Deep Search](#) | [Upload](#)

manuals.plus /

- › [Ticova](#) /
- › [Ticova Ergonomic Office Chair User Manual](#)

Ticova C9

Ticova Ergonomic Office Chair User Manual

Model: C9 | Brand: Ticova

INTRODUCTION

Welcome to the user manual for your new Ticova Ergonomic Office Chair. This chair is designed to provide optimal comfort and support for long hours of sitting, featuring multiple adjustable components to suit individual preferences. Please read this manual carefully to ensure proper assembly, operation, and maintenance of your chair.

KEY FEATURES

- **Adjustable Mesh Chair:** Lumbar support height and depth, headrest height and angle, armrest height, angle, forward & backward, seat cushion height, tilting angle up to 130° and rocking resilience.
- **Ergonomic Backrest & Seat:** Adjustable backrest designed to fit your spine, reducing fatigue and pain. Seat made of 3.5 inches high-density foam with W-shaped and waterfall-edge design for pressure dispersion.
- **3D Adjustable Armrest:** Features bigger, thicker & softer PU paddings for durability and comfort, adjustable in 3 dimensions.
- **Unique Headrest & Quality Mesh:** Large curved foam headrest for comfortable neck and head support. Breathable mesh provides strong tensile strength for cool and comfortable back support.

SETUP AND ASSEMBLY

Your Ticova Ergonomic Office Chair comes with comprehensive packaging and clear instructions for easy assembly. All necessary components and tools are included. For a visual guide, please refer to the official installation video below.

Your browser does not support the video tag.

Video Description: Official installation guide for the Ticova Ergonomic Office Chair. This video demonstrates step-by-step assembly, including attaching the chair legs, wheels, gas lift, armrests, seat, backrest, and headrest. It provides clear visual instructions for each part of the assembly process.

Assembly Components Overview

Revolutionizing Ergonomics



Image Description: An overhead view of all the individual parts of the Ticova Ergonomic Office Chair, neatly laid out on a white surface, ready for assembly. This includes the chair base, wheels, gas lift, seat cushion, backrest, armrests, headrest, and various screws and tools.

Follow the detailed instructions provided in the user manual and the installation video for a smooth assembly process. Ensure all screws are tightened securely before use.

OPERATING INSTRUCTIONS

Your Ticova chair offers various adjustments to customize your seating experience:

1. Headrest Adjustment

Comfortable Sitting

W-shaped & Waterfall-edge Design

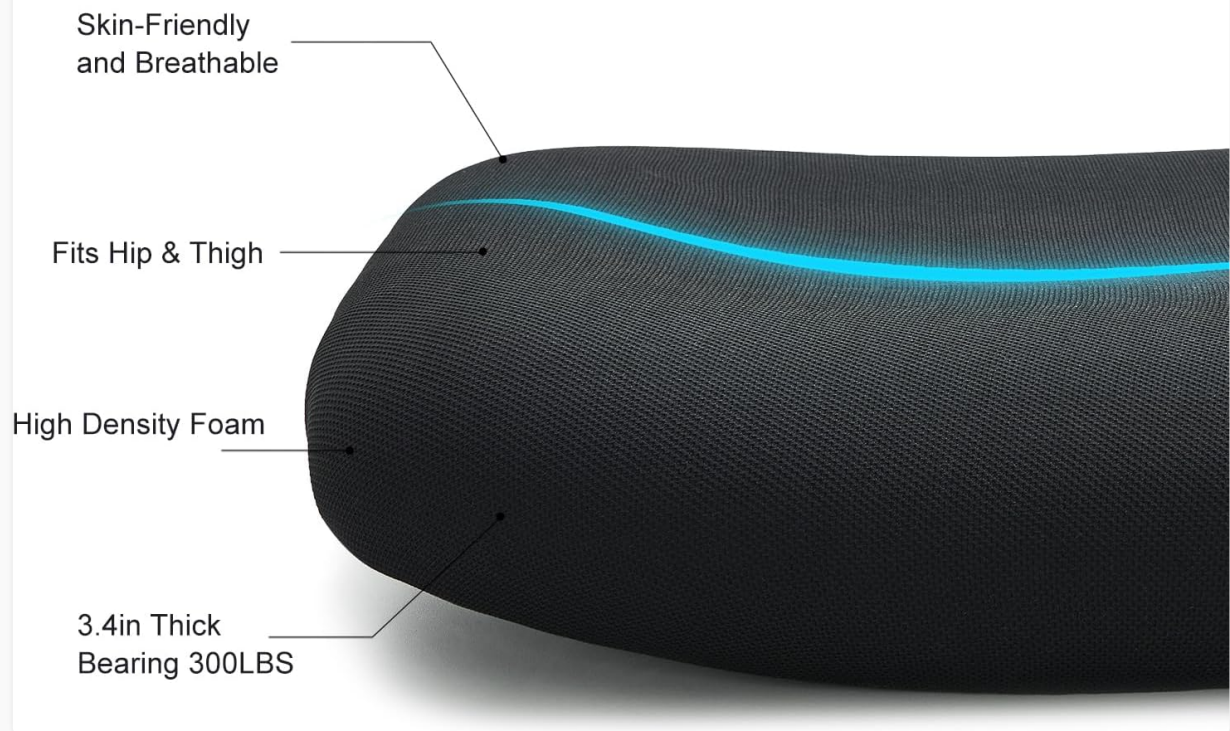

Image Description: A side view of the Ticova chair highlighting the adjustable headrest. Arrows indicate that the headrest can be moved up and down by 5.1 inches and rotated by 135 degrees to provide multi-dimensional head and neck support.

The headrest can be adjusted for both height (up to 5.1 inches) and angle (up to 135° rotation) to provide optimal neck and head support. Simply push or pull the headrest to your desired position.

2. Lumbar Support Adjustment

Ergonomic Design Perfectly Fit Your Spine

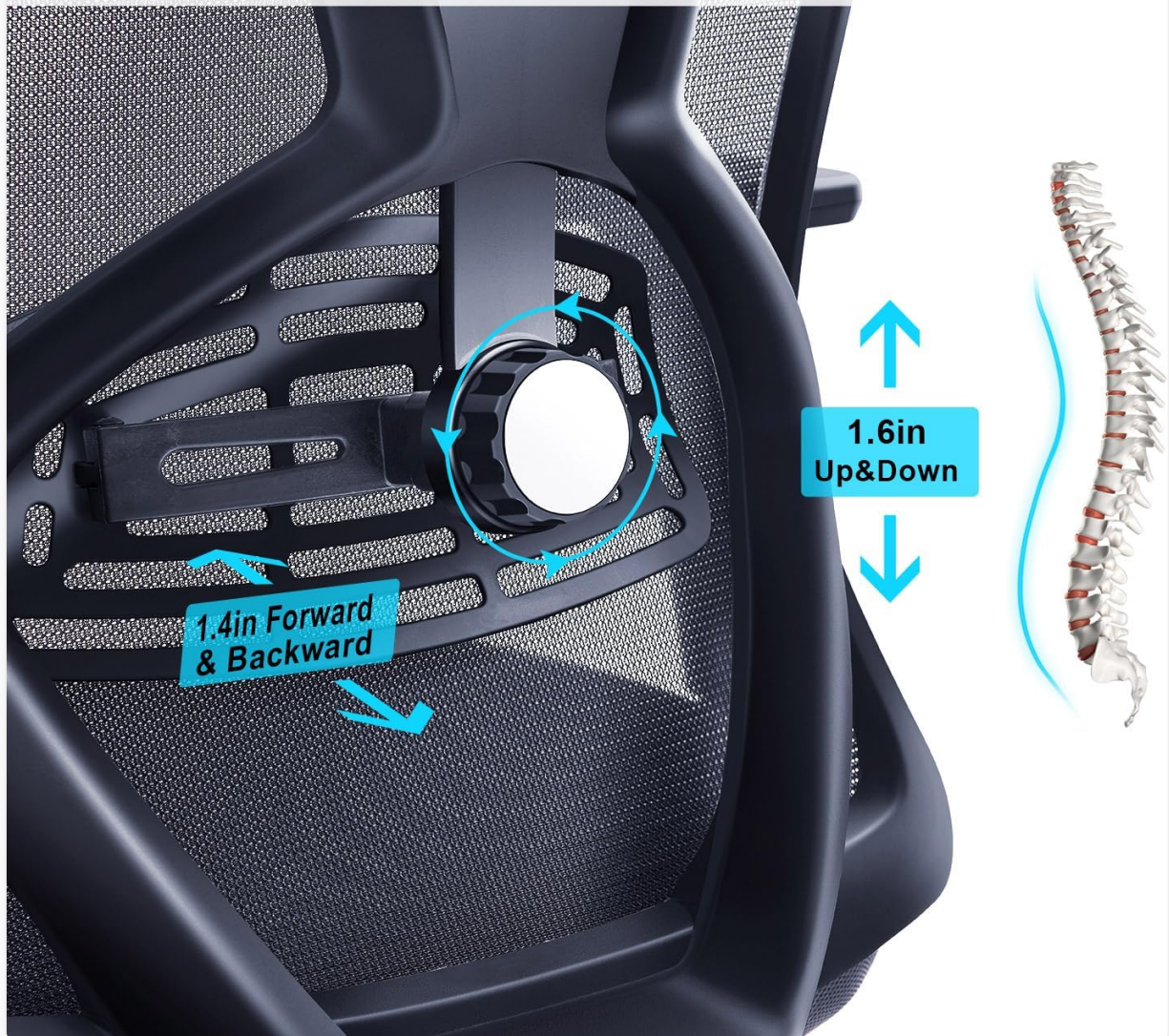

Image Description: A detailed view of the chair's backrest showing the lumbar support adjustment knob. Arrows indicate that the lumbar support can be adjusted 1.6 inches up and down, and 1.4 inches forward and backward to perfectly fit the user's spine.

Adjust the lumbar support height (up to 1.6 inches) and depth (up to 1.4 inches) using the knob located on the backrest. This allows the backrest to perfectly fit the curve of your spine.

3. Armrest Adjustment

Lockable & Rocking Back and Forth

TIPS: *No Warranty for Second-hand



Image Description: A close-up of the chair's 3D adjustable armrest. Arrows illustrate that the armrest can be adjusted 2.8 inches in height, rotated 40 degrees, and moved 2.4 inches forward and backward, providing versatile positioning options.

The 3D armrests offer extensive adjustability: height (up to 2.8 inches), angle (40° rotation), and forward/backward movement (2.4 inches). Use the buttons or levers on the armrests to unlock and set your preferred position.

4. Seat Cushion and Tilting Adjustment

Adjustable Big Curved Headrest

Comprehensive Head & Neck Support



Lying on the front



Lying on the side

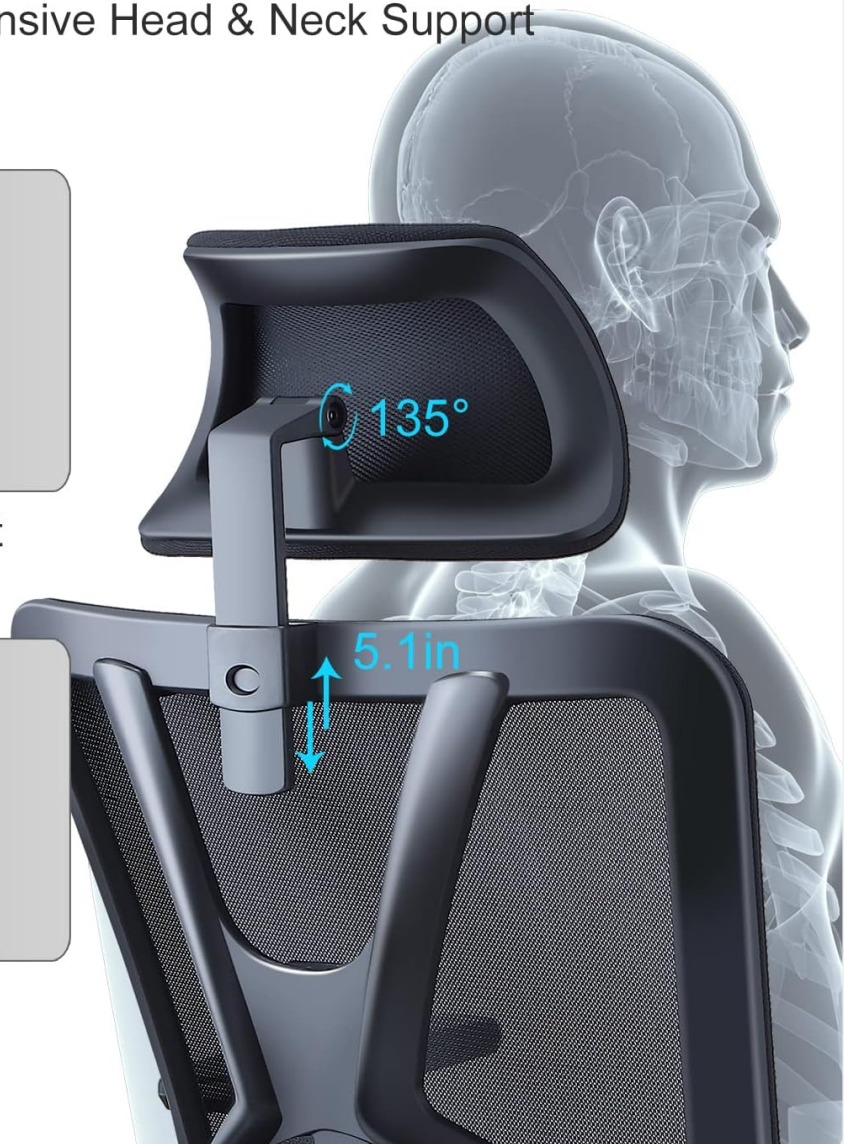

Image Description: A detailed view of the chair's seat cushion, highlighting its W-shaped and waterfall-edge design. Text labels indicate it is skin-friendly, breathable, fits hip & thigh contours, and is 3.4 inches thick high-density foam, supporting up to 300 lbs.

Adjust the seat cushion height using the lever located under the seat. The chair also features a tilting mechanism allowing recline up to 130° and adjustable rocking resilience. Use the appropriate levers under the seat to engage or disengage the tilt lock and adjust rocking tension.

MAINTENANCE

To maintain the longevity and appearance of your Ticova Ergonomic Office Chair, simply wipe it clean with a damp cloth. Avoid using harsh chemicals or abrasive cleaners that may damage the mesh or fabric.

TROUBLESHOOTING

- **Chair Squeaks:** Check all screws and bolts to ensure they are tightened. Apply a small amount of silicone lubricant to moving parts if necessary.
- **Gas Lift Not Functioning:** Ensure the height adjustment lever is fully engaged. If the issue persists, the gas lift may need replacement.
- **Chair Feels Unstable:** Verify that the chair base and all legs are securely attached and that the wheels are properly inserted.

SPECIFICATIONS

Feature	Detail
Brand	Ticova
Model Name	C9
Color	Black
Product Dimensions	27"D x 9.8"W x 20.8"H
Item Weight	37.4 pounds
Material	Sponge (Seat Fill)
Back Style	Solid Back (Mesh)
Special Features	Reclining, Ergonomic, Arm Rest, Adjustable Headrest, Head Support
Recommended Uses	Office

WARRANTY & SUPPORT

Ticova provides professional after-sales service for our ergonomic office chair. If there is any quality problem, please contact us and we will provide you with a satisfied solution.