

## TOWODE door stop alarm stoppers

# TOWODE 120 dB Door Stop Alarm Instruction Manual

Model: door stop alarm stoppers

## INTRODUCTION

This instruction manual provides comprehensive guidance for the TOWODE 120 dB Door Stop Alarm. This portable security device offers dual functionality as both a door stop and an alarm, enhancing safety for various environments including homes, hotels, apartments, and dorm rooms. Its compact design makes it ideal for travel, providing an extra layer of security wherever you go.

## PRODUCT FEATURES

- **Dual Functionality:** Operates as a door stop to prevent entry or as a loud alarm to alert occupants and deter intruders.
- **Adjustable Sensitivity:** Features a switch with Low (L), Medium (M), and High (H) sensitivity settings to suit different door types and environments. The 'H' setting is highly sensitive to vibration.
- **Loud Alarm Siren:** Emits an extremely loud 120 dB alarm when triggered, designed to startle intruders and notify nearby individuals.
- **Non-Skid Base:** Equipped with a synthetic rubber bottom to prevent slipping and ensure the device remains firmly in place under the door.
- **Portable Design:** Lightweight (approximately 95 grams without battery) and compact, making it easy to carry for travel or move between rooms.
- **Durable Construction:** Designed to be anti-rust, durable, and suitable for various floor surfaces.



Figure 1: Key features of the TOWODE Door Stop Alarm.

## SETUP AND INSTALLATION

Follow these steps to set up your TOWODE Door Stop Alarm:

1. **Insert Battery:** Open the battery compartment on the underside of the device. Insert one 9V battery (not included), ensuring correct polarity. Close the compartment securely.
2. **Select Sensitivity:** Locate the sensitivity switch on the side of the alarm. Choose your desired sensitivity level:
  - **L (Low):** Requires more pressure to trigger the alarm.
  - **M (Medium):** Standard sensitivity.
  - **H (High):** Most sensitive, triggers with minimal vibration or pressure.
3. **Activate Alarm:** Slide the ON/OFF switch on the side to the "ON" position. The device is now armed.
4. **Position Device:** Place the door stop alarm firmly under the door you wish to secure. Ensure the wedge is snug against the bottom of the door. The ideal gap between the door and the floor should be between 0.32 inches (10mm) and 1.35 inches (35mm) for effective operation.

## 3 Sensitivities are Adjustable for Different Doors



Figure 2: Step-by-step guide for installing and positioning the door stop alarm.

### OPERATING INSTRUCTIONS

- When the alarm is armed (ON position) and placed under a door, any attempt to open the door will cause the door to press down on the metal plate of the alarm.
- This pressure activates the internal sensor, triggering the loud 120 dB siren.
- The wedge design simultaneously prevents the door from opening further, physically blocking entry while the alarm sounds.
- To deactivate the alarm, simply slide the ON/OFF switch to the "OFF" position. When off, the device functions as a standard non-skid door wedge.



Figure 3: The door stop alarm actively deterring an intruder.



# Fit for Multi Surface

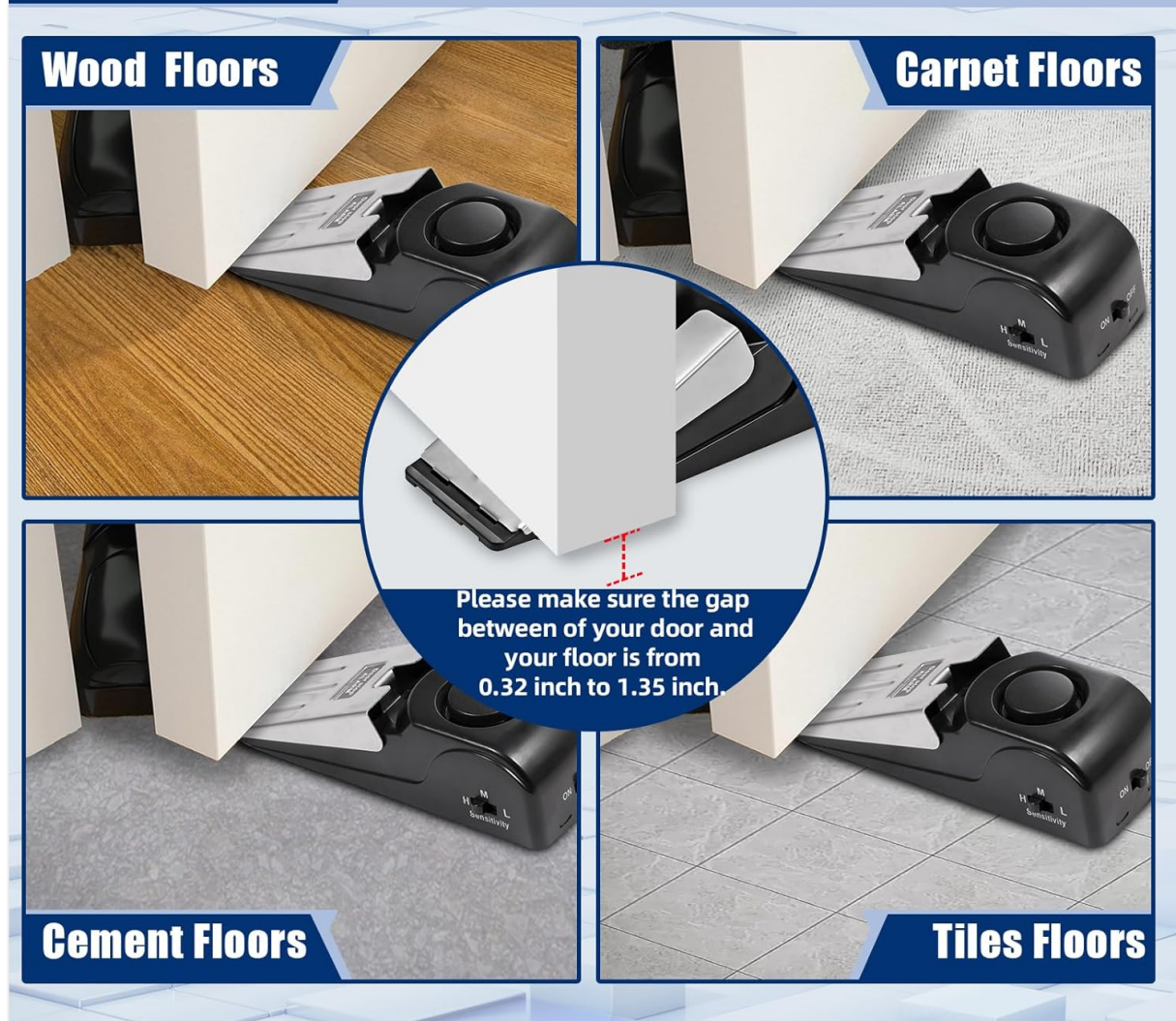

Figure 4: Compatibility with multiple floor surfaces and recommended door gap.

## MAINTENANCE

To ensure optimal performance and longevity of your TOWODE Door Stop Alarm, follow these maintenance guidelines:

- **Cleaning:** Wipe the device with a soft, dry cloth to remove dust and debris. Do not use abrasive cleaners or immerse the device in water.
- **Battery Replacement:** Replace the 9V battery when the alarm sound becomes weak or fails to activate. Always use a fresh, high-quality 9V battery.
- **Storage:** When not in use for extended periods, remove the battery to prevent leakage and store the alarm in a cool, dry place.

## TROUBLESHOOTING

Problem	Possible Cause	Solution
---------	----------------	----------

Problem	Possible Cause	Solution
Alarm not sounding.	Dead or improperly installed 9V battery. ON/OFF switch is in "OFF" position. Insufficient pressure on the wedge.	Replace with a fresh 9V battery, ensuring correct polarity. Slide the ON/OFF switch to "ON". Adjust the alarm's position under the door or increase sensitivity to "H".
Alarm sounding too easily or falsely.	Sensitivity set too high. Device is on an unstable surface or subject to external vibrations.	Adjust the sensitivity switch to a lower setting ("L" or "M"). Ensure the device is placed on a stable, flat surface.

## SPECIFICATIONS

Brand	TOWODE
Model Number	door stop alarm stoppers
Product Dimensions	5.5"L x 1.7"W x 1.57"Th
Item Weight	8.1 ounces (without battery)
Material	Rubber, Metal
Color	Black
Alarm Volume	120 dB
Battery Type	1 x 9V Battery (not included)
Door Gap Compatibility	0.32 inches (10mm) to 1.35 inches (35mm)

## WARRANTY AND SUPPORT

Information regarding product warranty and customer support is not available in this manual. Please refer to the product packaging or the manufacturer's official website for details on warranty coverage and how to contact customer support.