

AILEO 2.5 inch Bi-xenon Projector lens

AILEO 2.5 Inch Bi-Xenon HID Projector Lens with White Angel Eyes

Installation and Operation Manual

1. PRODUCT OVERVIEW

The AILEO 2.5 inch Bi-Xenon HID Projector Lens is designed to enhance vehicle headlight performance by providing a focused light beam with a clear cut-off line. This model includes a black shroud with white angel eyes, which function as daytime running lights (DRL).

Key features include:

- **Bi-Xenon Functionality:** Provides both low beam and high beam from a single projector lens. The powerful solenoid activates the high beam, offering an extended range of light.
- **Optimized Light Distribution:** Engineered to produce a uniformly lit low beam with a sharp cut-off line, preventing glare for oncoming traffic.
- **Integrated LED Angel Eyes:** White angel eyes serve as DRLs, increasing vehicle visibility and aesthetic appeal.
- **Durable Construction:** Made with a durable projector lens and metal housing for longevity.

2.5 PROJECTOR LENS

Crafted to ensure the greatest light projection without any dark spots. The Arc-Beam lens casts light more focused than any other headlights.



Image 1.1: AILEO 2.5 inch Bi-Xenon Projector Lens. This image displays the projector lens, highlighting its compact design and clear lens for optimal light projection.



Image 1.2: Internal components of the AILEO Bi-Xenon Projector Lens. This diagram illustrates the optically clear lens, reflecting bowl, quality anti-lock motor, and high-temperature resistant PC material, all contributing to its performance and durability.

2. PACKAGE CONTENTS

The following items are included in your package:

- 2x 2.5 inch Bi-xenon projector lenses
- 2x Projector shrouds (Black with White Angel Eyes)
- 2x H4 adapters
- 2x H7 adapters
- 2x Rubber spacers
- 2x Universal installation fasteners

Your browser does not support the video tag.

Video 2.1: Gzminjie 2.5 Inch Projector Lens Car Headlight Retrofit Kit. This video provides an unboxing and overview of the projector lens kit, demonstrating the included components and their initial appearance.

3. SPECIFICATIONS

Attribute	Value
Brand	AILEO
Model	2.5 inch Bi-xenon Projector lens
Color	Black Shroud with White Angel Eyes
Specific Uses For Product	Head Lights
Vehicle Service Type	Car
Special Feature	High Beam
Light Source Type	HID
Voltage	12 Volts
Lens Color	Clear
Lens Material	Polycarbonate
Item Weight	1.86 pounds
Automotive Fit Type	Universal Fit

PRODUCT SIZE



low beam

high beam

Image 3.1: This image illustrates the dimensions of the 2.5 inch projector lens and demonstrates the distinct low beam and high beam patterns it produces.

4. INSTALLATION GUIDE

Installation of the AILEO 2.5 inch Bi-Xenon Projector Lens requires opening the vehicle's headlamp assembly. Professional installation is recommended due to the complexity involved. This guide provides general steps; specific procedures may vary based on your vehicle model.

4.1. Required Bulbs

This projector lens is designed for H1 bulbs. It is compatible with standard H1 Xenon bulbs (H1 Xenon Kit recommended) and AILEO 360° H1 LED bulbs. H1 Halogen bulbs and other socket bulbs are not compatible.

4.2. Compatibility

This projector lens can fit H4, H7, H11, H8, H9, 9005 (HB3), and 9006 (HB4) headlight housings. It comes with H4 and H7 adapters, as well as universal adapters for other compatible housings. Some modifications to the headlight housing may be necessary.

4.3. General Installation Steps

1. **Preparation:** Ensure your vehicle's battery is disconnected. Gather necessary tools, including heat gun/oven, screwdrivers, sealant, and protective gloves.
2. **Headlight Removal:** Carefully remove the headlight assemblies from your vehicle.
3. **Headlight Disassembly:** Heat the headlight assembly to soften the sealant, then carefully pry open the lens from the housing.
4. **Original Reflector Removal:** Remove the existing reflector cup from the headlight housing.
5. **Projector Lens Mounting:** Insert the AILEO projector lens into the headlight housing. Use the appropriate adapters (H4, H7, or universal fasteners) and rubber spacers to secure the projector. Ensure it is seated firmly and aligned correctly.
6. **Bulb Installation:** Install the compatible H1 Xenon or AILEO 360° H1 LED bulb into the projector lens.
7. **Wiring:** Connect the bi-xenon solenoid wires (red and black) to your vehicle's high beam circuit. Connect the angel eye wires to a 12V power source (e.g., parking lights or a dedicated DRL circuit).
8. **Testing:** Before sealing, temporarily connect the headlights and test the low beam, high beam, and angel eye functions to ensure proper operation and alignment.
9. **Sealing and Reassembly:** Apply new sealant to the headlight housing and reattach the lens. Ensure a watertight seal to prevent moisture ingress. Reinstall the headlight assemblies into your vehicle.

PROJECTOR USE H1 BULB

Easy replacement.



PLUG & PLAY

Special wiring plugs for control high and low beam.

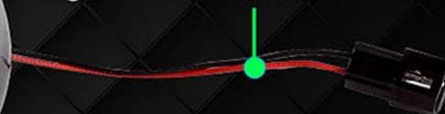

BI-XENON PROJECTOR LENS DESIGN

Can change high and low beam itself.



Image 4.1: This image highlights the H1 bulb compatibility, plug-and-play wiring for high/low beam control, and the bi-xenon projector lens design.

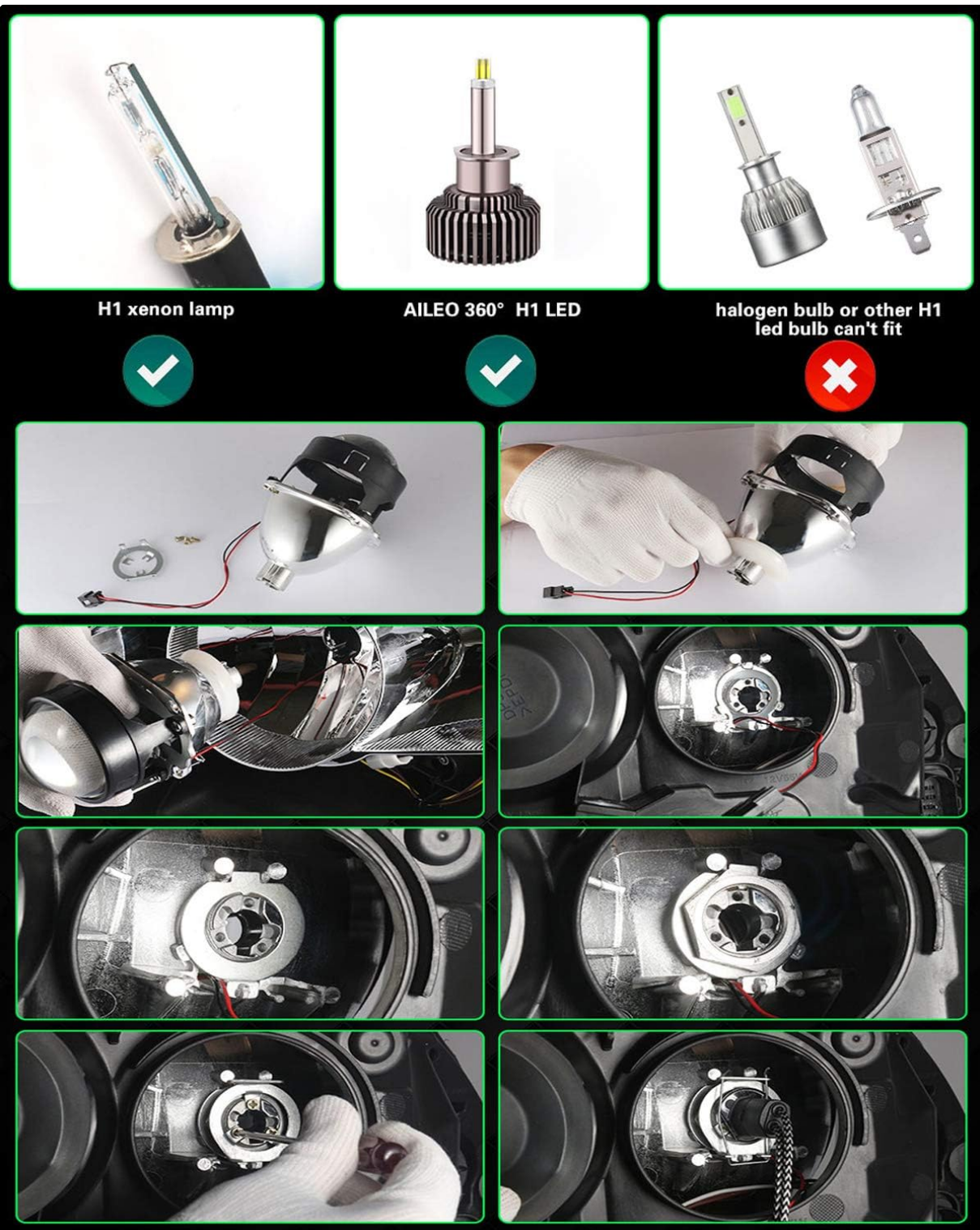

Image 4.2: A visual guide demonstrating the installation process of an H1 bulb into the projector lens, including the different types of H1 bulbs and their compatibility.

5. OPERATING INSTRUCTIONS

Once installed, the AILEO Bi-Xenon Projector Lens operates in conjunction with your vehicle's existing headlight controls.

5.1. Low Beam Operation

When your vehicle's low beams are activated, the projector lens will provide a uniformly lit, focused beam with a sharp cut-off line. This ensures clear visibility for the driver without blinding oncoming traffic.

5.2. High Beam Operation

Activating your vehicle's high beams will energize the projector's solenoid, moving the internal shield to allow the full light output to project. This provides a powerful, extended range of light for maximum visibility on dark roads.

5.3. Angel Eyes (DRL)

The white LED angel eyes will illuminate when connected to a constant 12V power source, typically the parking light circuit or a dedicated DRL circuit, providing enhanced daytime visibility and a distinctive appearance.

Your browser does not support the video tag.

Video 5.1: iJDMTOY 3.0-Inch H1 Bi-Xenon Projector Lens Light Pattern. This video demonstrates the low beam and high beam light patterns produced by a bi-xenon projector lens, illustrating the clear cut-off and increased light output.

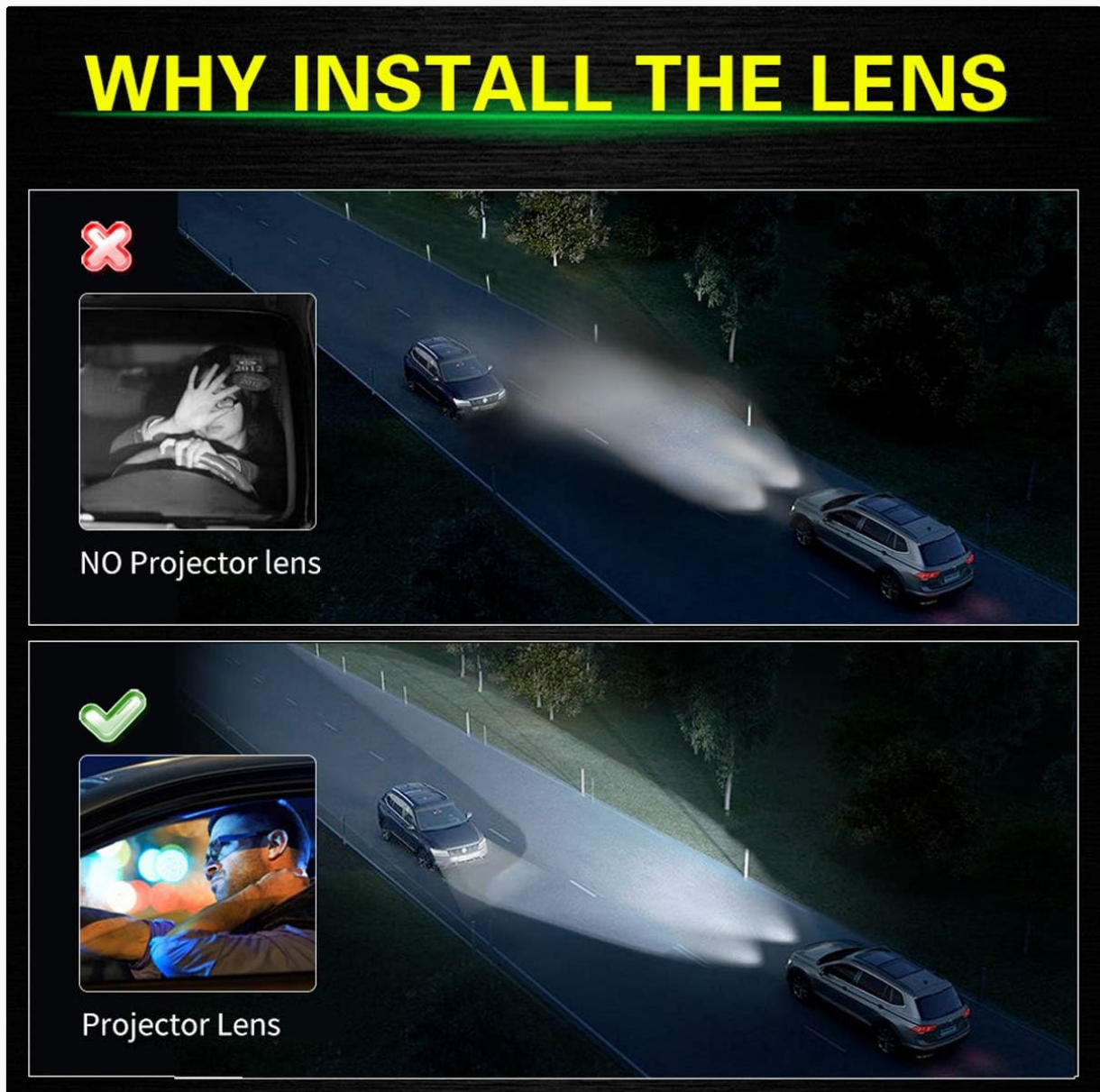

Image 5.1: A visual comparison showing the difference in light output and beam pattern between a standard headlight and one equipped with a projector lens, highlighting improved focus and reduced glare.

6. MAINTENANCE

To ensure the longevity and optimal performance of your AILEO Bi-Xenon Projector Lenses, follow these maintenance guidelines:

- **Regular Cleaning:** Periodically clean the exterior of the headlight lens to remove dirt, dust, and debris that can obstruct light output. Use a soft cloth and a mild cleaning solution.
- **Inspect Wiring:** Check all wiring connections for any signs of wear, corrosion, or loose connections. Secure any loose wires.
- **Bulb Replacement:** If using HID bulbs, replace them as a pair when one begins to dim or change color to maintain consistent light output. Follow the bulb manufacturer's instructions for replacement.
- **Seal Integrity:** Regularly inspect the headlight housing seal for any cracks or gaps that could allow moisture to enter. Address any issues promptly to prevent damage to the projector and electrical components.

7. TROUBLESHOOTING

Refer to the following common issues and their solutions:

7.1. Lights Not Turning On

- **Check Connections:** Ensure all wiring connections are secure and correctly installed.
- **Power Source:** Verify that the power source for the headlights and angel eyes is functioning correctly. Check fuses.
- **Bulb Functionality:** Test the H1 bulbs in another compatible setup if possible, or replace them to rule out a faulty bulb.

7.2. Incorrect Beam Pattern or Glare

- **Projector Alignment:** Ensure the projector lens is securely mounted and correctly aligned within the headlight housing. Minor adjustments may be needed.
- **Bulb Seating:** Verify that the H1 bulb is properly seated in the projector lens. An improperly seated bulb can distort the beam pattern.
- **Vehicle Leveling:** Ensure your vehicle is on a level surface when checking beam patterns.

7.3. High Beam Not Activating

- **Solenoid Wiring:** Check the wiring to the bi-xenon solenoid. Ensure it is correctly connected to the high beam circuit and receiving 12V when high beams are activated.
- **Solenoid Functionality:** If wiring is correct, the solenoid itself might be faulty.

7.4. Angel Eyes Not Illuminating

- **Wiring:** Check the power and ground connections for the angel eyes.
- **Power Source:** Ensure the connected power source (e.g., parking lights) is active.

8. WARRANTY AND SUPPORT

For any issues or questions regarding your AILEO 2.5 inch Bi-Xenon HID Projector Lens, please contact us via Amazon. We are committed to assisting you with product-related concerns.