

Master Lock 5415D

Master Lock 5415D Heavy Duty Wall Mount Key Lock Box Instruction Manual

1. PRODUCT OVERVIEW

The Master Lock 5415D Heavy Duty Key Lock Box is designed for secure storage of up to five standard house keys and access cards. Its wall-mount design allows for permanent installation, providing a reliable solution for key access. The unit features a 4-digit resettable combination for keyless convenience and enhanced security. A protective cover shields the combination dials from environmental elements such as weather, dirt, and grime.



Image 1.1: Master Lock 5415D Key Lock Box, closed view.

2. KEY FEATURES

- **Heavy Duty Construction:** Features a 105mm wide metal body for durability and a solid zinc body for high security.
- **Wall Mount Design:** Engineered for permanent installation on a wall or fixed object.
- **4-Digit Combination:** User-settable and resettable 4-digit combination for keyless access.
- **Weather Protection:** Includes a full weather cover to protect combination dials from outdoor elements.
- **Capacity:** Stores up to five standard house keys or key fobs.



Image 2.1: Diagram highlighting the wall mount design, 4-digit combination, heavy-duty construction, storage compartment, and weather protection cover.

3. SETUP AND INSTALLATION

3.1 Mounting the Lock Box

The Master Lock 5415D is designed for permanent wall mounting. Mounting hardware is included for installation.

1. Select a suitable location on a wall or fixed object for installation.
2. Open the lock box to access the mounting holes on the back panel.
3. Mark the positions for drilling using the lock box as a template.
4. Drill pilot holes appropriate for the mounting hardware.
5. Secure the lock box to the wall using the provided screws.

Wall Mount Design for Permanent Installation



Image 3.1: The key lock box securely mounted on a wall.

3.2 Setting Your Combination

The lock box comes with a default combination (usually 0-0-0-0). Follow these steps to set your personalized 4-digit combination:

1. Open the lock box using the current combination.
2. Locate the reset lever inside the lock box (often on the inside of the door or side panel). Push the reset lever into position A (as indicated in the diagram).
3. Rotate the dials to your desired 4-digit combination. Ensure the numbers are clearly aligned.
4. Push the reset lever back into position B. This locks in your new combination.
5. Scramble the dials to secure the lock box.

Setting Your Combination



1

Open lock box (default code 0-0-0-0).



2

Push reset lever into position **A**.



3

Rotate dials to desired combination.

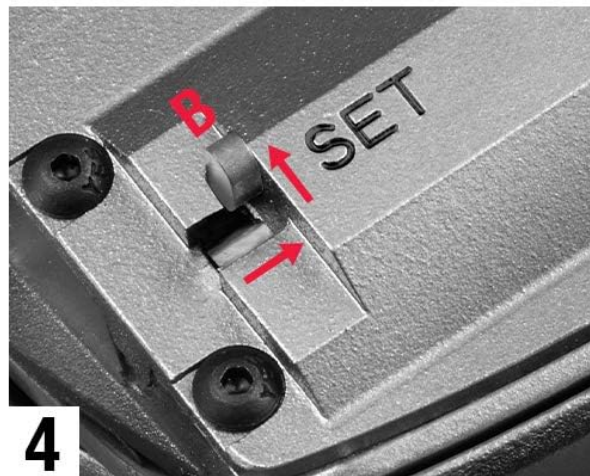

4

Push reset lever to position **B**. Close lock box and scramble combination.

Image 3.2: Visual guide for setting the 4-digit combination.

4. OPERATING INSTRUCTIONS

4.1 Opening the Lock Box

1. Slide open the protective weather cover to reveal the combination dials.
2. Rotate the dials to your set 4-digit combination.
3. Press the release button(s) on the side of the lock box to open the door.

4.2 Storing and Retrieving Keys

The interior compartment is designed to hold multiple keys or key fobs.

1. Place keys or fobs inside the open compartment.
2. To close, push the door firmly until it latches shut.
3. Scramble the combination dials to secure the contents.
4. Close the protective weather cover.

Secure Storage for House Keys & Key Fobs



Image 4.1: Demonstrates secure key storage within the lock box, contrasting it with less secure methods.

5. MAINTENANCE

To ensure optimal performance and longevity of your Master Lock 5415D Key Lock Box:

- Regularly clean the exterior and combination dials to prevent dirt and grime buildup.
- Ensure the protective weather cover is closed when not in use to shield the dials from harsh weather conditions.
- Periodically check the mounting screws to ensure the unit remains securely attached to the wall.

6. TROUBLESHOOTING

6.1 Difficulty Opening the Lock Box

- **Incorrect Combination:** Double-check that the correct 4-digit combination is entered and that each number is precisely aligned in the center of the dial window.
- **Stuck Dials:** If dials are stiff, gently wiggle them while attempting to enter the combination. Ensure no debris is obstructing the dials.
- **Reset Lever Position:** Verify that the internal reset lever is fully in the 'B' (locked) position after

setting the combination. If it was accidentally left in the 'A' (reset) position, the combination may have been inadvertently changed.

6.2 Combination Not Changing

- Ensure the reset lever is fully engaged in position 'A' before rotating the dials to the new combination.
- Confirm the new combination is set clearly before returning the lever to position 'B'.

7. SPECIFICATIONS

Feature	Detail
Model Number	5415D
Brand	Master Lock
Lock Type	Combination Lock
Material	Zinc
Exterior Dimensions (H x W x D)	5.5 in (13.2 cm) x 4.1 in (10.5 cm) x 1.7 in (4.3 cm)
Interior Dimensions (H x W x D)	4.4 in (11.3 cm) x 2.5 in (6.4 cm) x 1.2 in (3.1 cm)
Item Weight	3 Pounds
Mounting Type	Wall Mount
Special Feature	Durability, Weather Cover

Dimensions

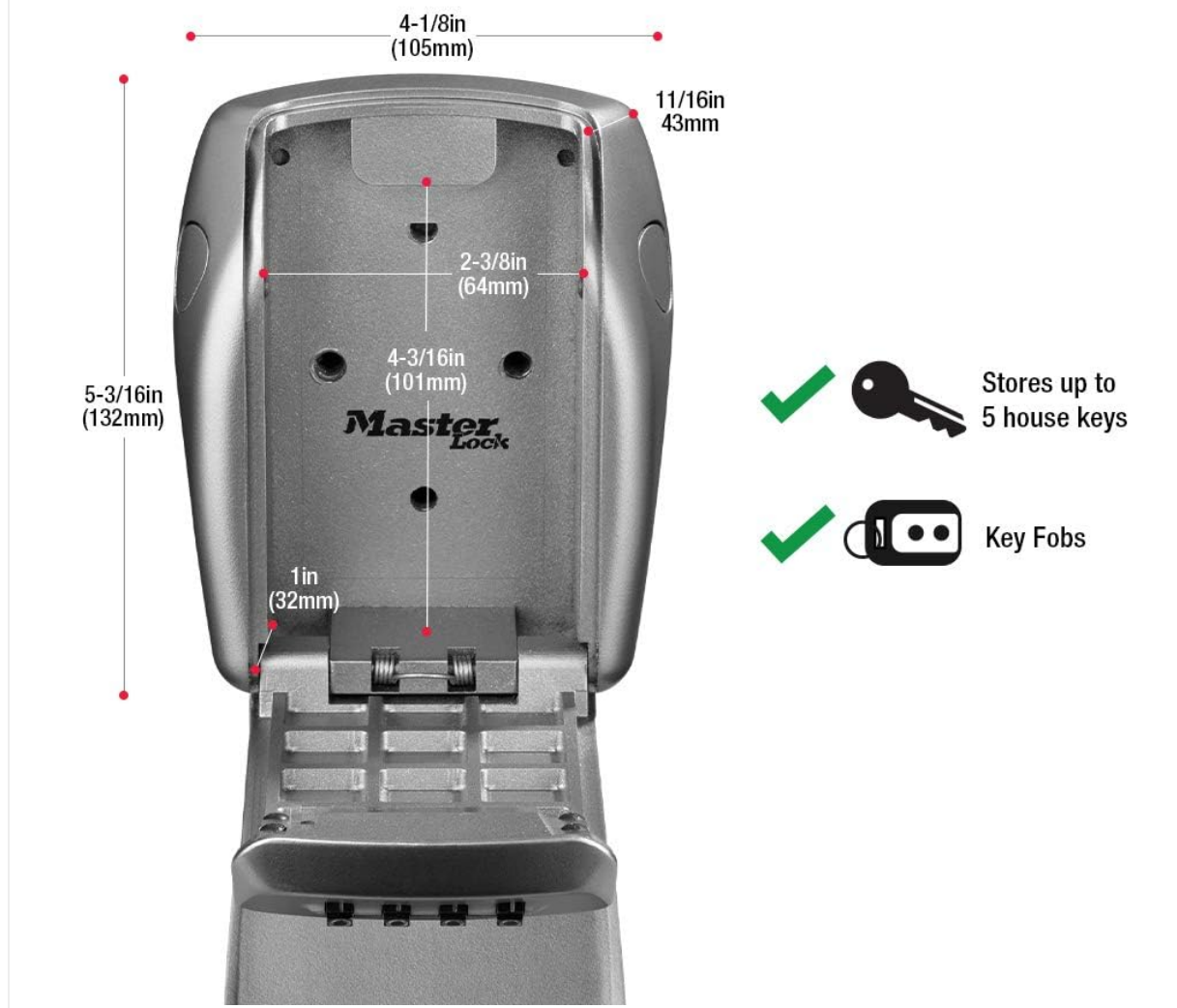

Image 7.1: Detailed dimensions of the Master Lock 5415D Key Lock Box.

8. PRODUCT OVERVIEW VIDEO



Video 8.1: An official product overview demonstrating the features and functionality of the Master Lock 5415D Key Lock Box.

9. WARRANTY INFORMATION

The Master Lock 5415D Heavy Duty Wall Mount Key Lock Box is backed by a **Limited Lifetime Warranty**. This warranty provides peace of mind regarding the product's quality and durability. For specific terms and conditions, please refer to the official Master Lock warranty documentation or contact customer support.

10. SUPPORT

For further assistance, technical support, or warranty claims, please visit the official Master Lock website or contact their customer service department. Contact details can typically be found on the product packaging or the manufacturer's website.

