

Manuals+

[Q & A](#) | [Deep Search](#) | [Upload](#)

[manuals.plus](#) /

- › [ZIYOU LANG](#) /
- › [ZIYOU LANG Pink Gaming Keyboard and Mouse Combo User Manual](#)

ZIYOU LANG B09DFS8Z7P

ZIYOU LANG Pink Gaming Keyboard and Mouse Combo User Manual

Model: B09DFS8Z7P

1. INTRODUCTION

Thank you for choosing the ZIYOU LANG Pink Gaming Keyboard and Mouse Combo. This manual provides detailed instructions for setting up, operating, maintaining, and troubleshooting your new gaming peripherals. Please read this manual thoroughly before use to ensure optimal performance and longevity of your product.



Image 1.1: ZIYOU LANG Pink Gaming Keyboard, Mouse, and Bungee Combo

What's in the Box?

- 1 x Compact Rainbow Backlit Mechanical Keyboard
- 1 x 65g Ultralight Gaming Mouse
- 1 x Flexible Mouse Cord Holder (Mouse Bungee)
- 1 x User Manual

2. SETUP GUIDE

The ZIYOU LANG Gaming Combo is designed for plug-and-play functionality. Follow these steps to connect your devices.

2.1 Keyboard Setup

1. Locate an available USB port on your computer.
2. Connect the USB cable from the keyboard to the USB port on your computer.
3. The keyboard will automatically install necessary drivers. Wait for the installation to complete.



Image 2.1: Keyboard featuring Type-C wired connection and Blue Switch mechanism

2.2 Mouse Setup

1. Locate an available USB port on your computer.
2. Connect the USB cable from the mouse to a separate USB port on your computer.
3. The mouse will automatically install necessary drivers. Wait for the installation to complete.

LIGHTWEIGHT BACKLIT GAMING MOUSE



Honeycomb Shell



6 RGB Backlit



Ultra-light Shape



7 Programmable Buttons



800-6400 DPI



Custizable Driver

Image 2.2: Lightweight gaming mouse with honeycomb shell and RGB backlighting

2.3 Mouse Bungee Setup

1. Place the mouse bungee on a stable, flat surface near your mousepad.
2. Insert your mouse cable into the flexible clip arm of the bungee.
3. Adjust the cable length to allow comfortable mouse movement without tangling or drag.

MOUSE CORD HOLDER

The fixed line anti-winding is no longer worrying about the line collection

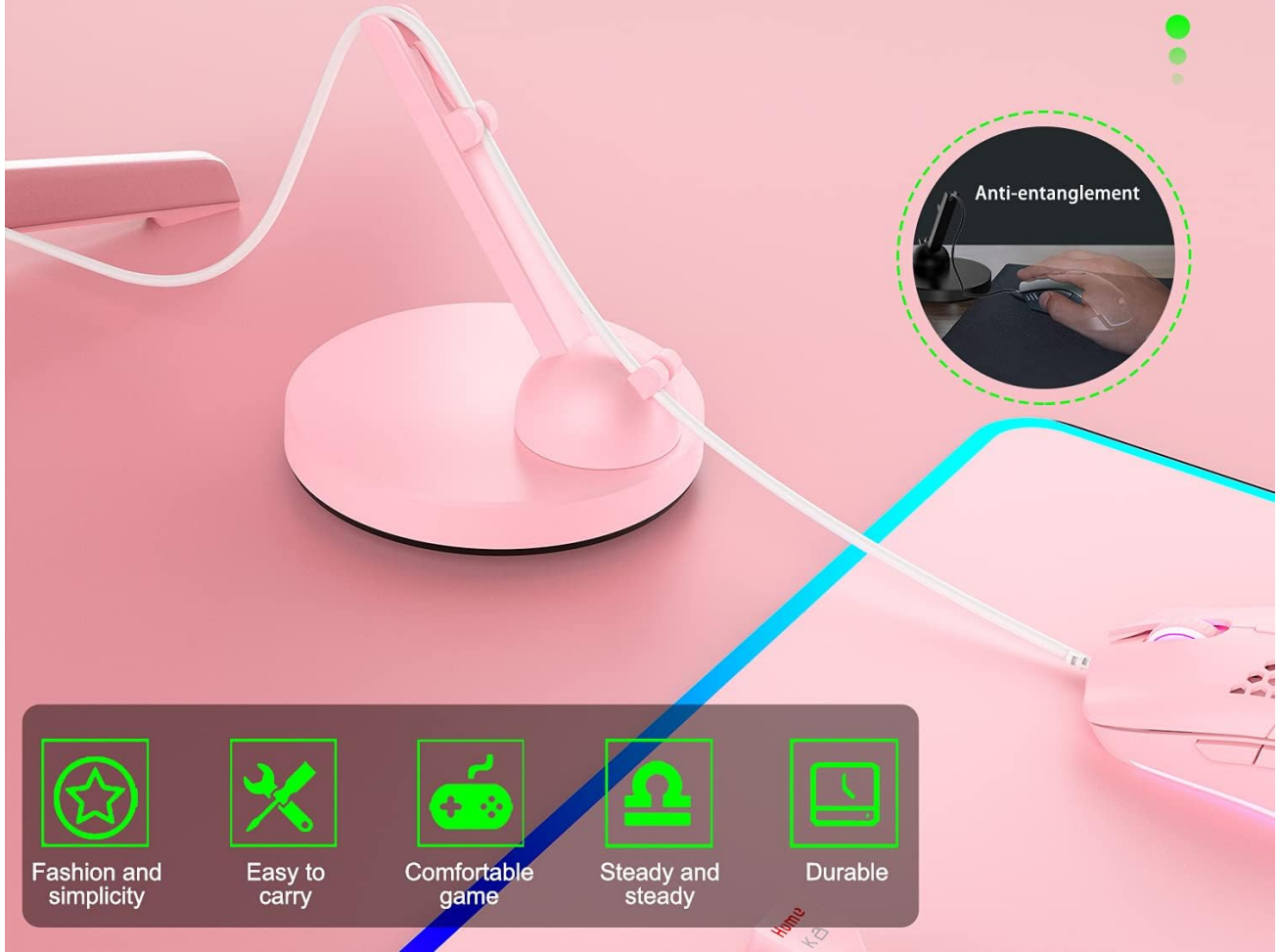

Image 2.3: Mouse cord holder designed for anti-entanglement and cable management

3. OPERATING INSTRUCTIONS

3.1 Keyboard Functions

Minimalist 82-key Structure

The compact 82-key mechanical keyboard keyboard design maximizes the use of desk space while preserving common keys.

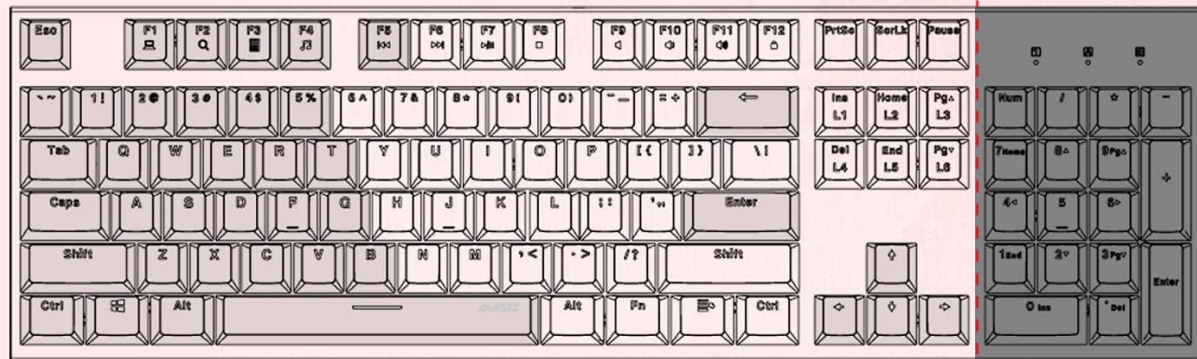

104 → 87 → 82key



Image 3.1: Minimalist 82-key keyboard layout for efficient desk space usage

- **Backlight Modes:** Press **FN + F8** to switch between 3 backlight modes: Normal, Breathing Light, and Off.
- **Brightness Adjustment:** Use specific key combinations (refer to keyboard legends if available, typically **FN + Arrow Up/Down**) to adjust backlight brightness.
- **Multimedia Buttons:** The keyboard features 12 multimedia buttons (F1-F12) accessible via the **FN** key. For example, **FN + F1** for Media Player, **FN + F2** for Volume Down, etc.
- **Game/Office Mode:** The keyboard supports switching between game mode and office mode. Consult the keyboard's specific key combination for this function (often **FN + Win** key or a dedicated switch).
- **Anti-Ghosting:** The keyboard is designed with anti-ghosting for simultaneous key presses, ensuring accuracy during intense gaming.

3.2 Mouse Functions

LIGHTWEIGHT DESIGN

This mouse uses an ultra-light honeycomb shell design, make you feel light and long term use without fatigue.



Image 3.2: Ergonomic and lightweight design of the gaming mouse

- **DPI Adjustment:** The mouse features a 6400 DPI sensor. Use the dedicated DPI button (usually located behind the scroll wheel) to cycle through different DPI settings (e.g., 800-6400 DPI).
- **Backlight Options:** The mouse has 26 kinds of RGB backlight options. These can typically be cycled through using a button on the mouse (often on the bottom or a dedicated button near the DPI switch).
- **Programmable Buttons:** The mouse has 7 editable buttons. Customization may require specific software, which is not included in the package description. For basic functionality, buttons operate as standard.

4. MAINTENANCE

Proper maintenance ensures the longevity and performance of your ZIYOU LANG Gaming Combo.

- **Cleaning the Keyboard:** Use a soft, dry cloth to wipe the surface of the keyboard. For dust between keycaps, use a can of compressed air or the included keycap puller and brush to clean thoroughly. Avoid using harsh chemicals or abrasive materials.
- **Cleaning the Mouse:** Wipe the mouse surface with a soft, slightly damp cloth. Ensure no liquid enters the mouse. Clean the optical sensor area gently with a cotton swab if dust affects tracking.

- **General Care:** Keep the devices away from excessive moisture, direct sunlight, and extreme temperatures. Avoid dropping or subjecting the devices to strong impacts.

5. TROUBLESHOOTING

If you encounter issues with your ZIYOU LANG Gaming Combo, refer to the following table for common solutions.

Problem	Possible Cause	Solution
Keyboard/Mouse not responding	Loose USB connection, faulty USB port, driver issue.	Ensure USB cables are securely plugged in. Try a different USB port. Restart your computer. Check Device Manager for driver status.
Keyboard backlight not working	Backlight turned off, brightness set to minimum.	Press FN + F8 to cycle through backlight modes. Adjust brightness using FN + Arrow keys (if applicable).
Mouse tracking is erratic	Dirty optical sensor, unsuitable mousepad surface.	Clean the mouse's optical sensor. Use a clean, uniform-surface mousepad.
Mouse DPI not changing	DPI button not pressed correctly.	Ensure you are pressing the dedicated DPI button. Cycle through all DPI settings.

6. SPECIFICATIONS

6.1 Keyboard Specifications

- **Layout:** 82-key Compact
- **Switch Type:** Blue Mechanical Switches
- **Backlight:** Rainbow LED (12 modes)
- **Keycaps:** Laser-engraved ABS, removable
- **Multimedia Keys:** 12 (FN + F1-F12)
- **Connectivity:** Wired USB (Plug and Play)
- **Compatibility:** Windows 2000 / XP / VISTA / 7 / 8 / 10, MAC systems
- **Dimensions:** Approximately 12.2 x 4.72 inches

6.2 Mouse Specifications

- **Weight:** 65g (Ultralight)
- **Sensor:** 6400 DPI (Adjustable)
- **Acceleration:** 20g
- **Buttons:** 7 editable buttons
- **Backlight:** RGB (26 options)
- **Key Life:** 50 million clicks
- **Connectivity:** Wired USB

6.3 Mouse Bungee Specifications

- **Design:** Flexible cord holder, 360° no dead angle

- **Base:** Anti-slip weighted base
- **Material:** Silicone clip arm
- **Function:** Prevents cable entanglement and drag

7. WARRANTY AND SUPPORT

ZIYOU LANG provides a limited warranty for this product. Please refer to the specific warranty terms provided with your purchase documentation for details on refund, replacement, and warranty duration for quality problems. For technical support or warranty claims, please contact your retailer or the ZIYOU LANG customer service department through the contact information provided on the product packaging or official website.