

[Manuals.plus](#) /

› [REPTI ZOO](#) /

› REPTI ZOO 3-in-1 Reptile Tall Terrarium User Manual

## REPTI ZOO 16"x16"x30"

# REPTI ZOO 3-in-1 Reptile Tall Terrarium User Manual

Model: 16"x16"x30" Rainforest Habitat

[Overview](#)

[Setup](#)

[Operation](#)

[Maintenance](#)

[Troubleshooting](#)

[Specifications](#)

[Support](#)

## 1. PRODUCT OVERVIEW

The REPTI ZOO 3-in-1 Reptile Tall Terrarium is designed to provide a versatile and secure habitat for various reptiles and amphibians. Its unique design allows for easy switching between mesh and glass panels, offering flexible ventilation options suitable for different environmental needs, from rainforest to desert setups. The terrarium features a double hinge front door for convenient access and a secure screen top for ventilation and lighting.





Figure 1: Fully assembled REPTI ZOO 3-in-1 Reptile Tall Terrarium, showcasing its design suitable for a rainforest habitat with integrated decor.

# 3 IN 1

Meshes and Glasses Switched Easily

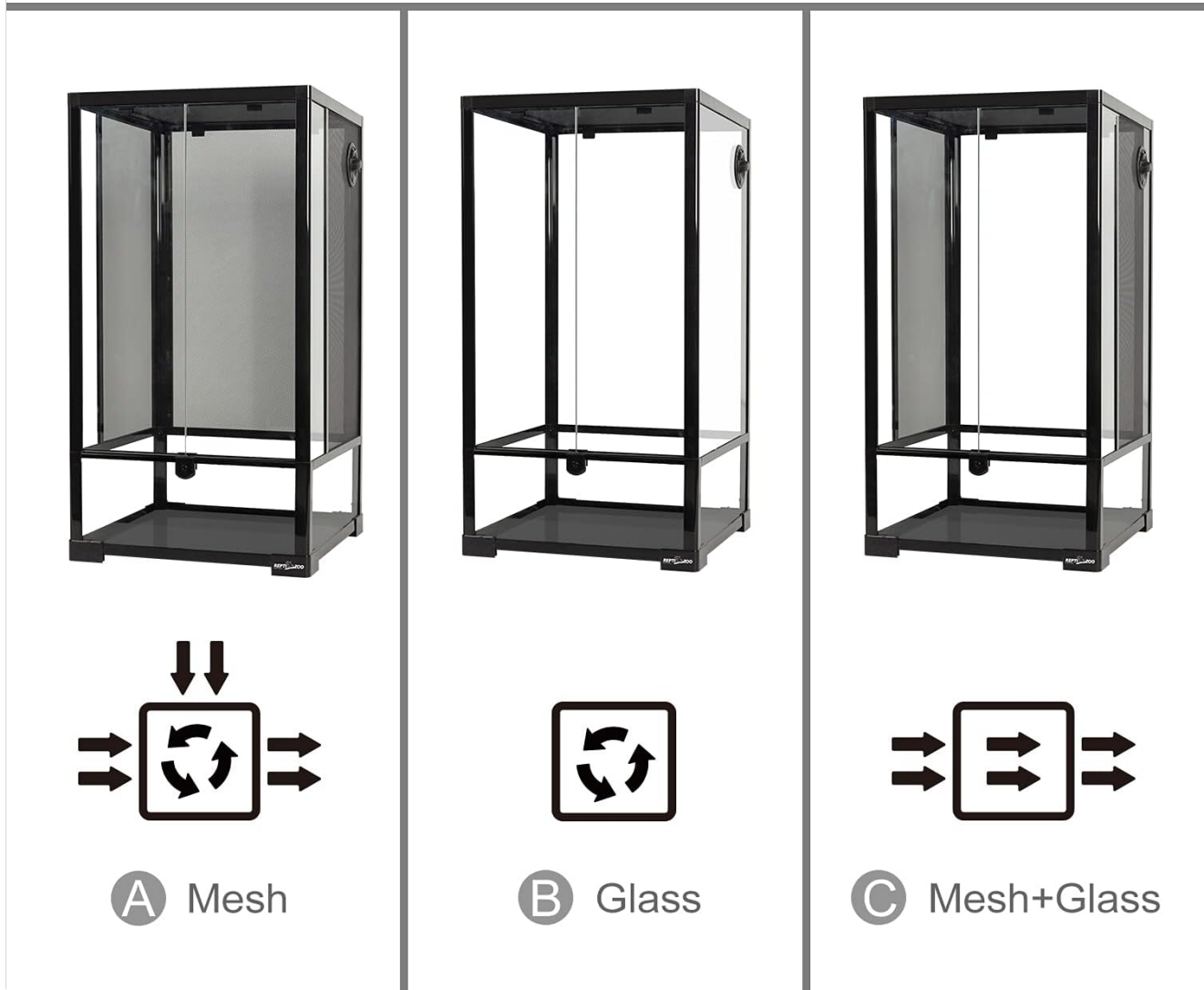

Figure 2: Illustration of the terrarium's 3-in-1 design, demonstrating the ability to configure side panels with mesh for maximum ventilation (A), glass for humidity retention (B), or a combination of both (C).

## 2. SETUP AND ASSEMBLY

Carefully unpack all components and verify against the included parts list. Assembly typically involves connecting the frame sections, inserting the chosen side panels (mesh or glass), attaching the front doors, and securing the top screen.

### 2.1. Component Identification

- Base and Top Frame Sections
- Vertical Support Poles
- Glass Side Panels
- Mesh Side Panels
- Front Double Hinge Doors
- Screen Top with Latch
- Locking Mechanism (Keyed)

- Ventilation Rotators

## 2.2. Assembly Steps

1. **Prepare the Base:** Place the base frame on a flat, stable surface.
2. **Attach Vertical Supports:** Connect the vertical support poles to the corners of the base frame. Ensure they are securely seated. Some users may find it helpful to apply gentle, even pressure when screwing in poles to ensure full seating.
3. **Install Side Panels:** Slide your chosen side panels (glass or mesh) into the designated grooves along the vertical supports. The 3-in-1 design allows for customization of ventilation.
4. **Secure Top Frame:** Carefully place the top frame onto the vertical supports, ensuring all connections are aligned and secure.
5. **Install Front Doors:** Attach the double hinge front doors to the designated hinges on the front frame. Ensure they swing freely and close properly.
6. **Place Screen Top:** Position the screen top onto the terrarium. Secure it using the integrated latches.
7. **Install Locking Mechanism:** Attach the keyed locking mechanism to the front doors as per instructions to ensure secure closure.
8. **Verify Ventilation:** Ensure the rotatable ventilation ports on the side are correctly installed and can be adjusted.



Figure 3: Detailed view of key terrarium features, including the secure top latch, keyed door lock, adjustable side ventilation, and the method for attaching mesh panels.



Figure 4: The removable screen top, demonstrating how it can be lifted for access, feeding, or maintenance.

### 3. OPERATION

#### 3.1. Accessing the Terrarium

- **Front Doors:** The terrarium features double hinge front doors. To open, unlock the keyed mechanism and gently swing the doors outwards. This provides a wide, non-intrusive access point for feeding, cleaning, and interacting with your pet.
- **Top Screen:** The top screen is removable for full access. Unlatch the clips securing the screen and lift it off. This is useful for larger maintenance tasks or installing overhead lighting/heating fixtures.

#### 3.2. Adjusting Ventilation

- **Side Panels:** The terrarium allows for interchangeable glass and mesh side panels. For high ventilation environments (e.g., arid habitats), use mesh panels. For high humidity environments (e.g., rainforest habitats), use glass panels. Panels can be swapped by disassembling the frame sections.
- **Ventilation Ports:** Rotate the circular ventilation ports located on the side of the terrarium to adjust airflow.

## 4. MAINTENANCE

### 4.1. Cleaning

- Regularly clean the glass panels with a reptile-safe glass cleaner or a solution of water and white vinegar. Avoid abrasive cleaners.
- Wipe down the frame and mesh panels with a damp cloth.
- For deep cleaning, remove all substrate and decor. The terrarium can be rinsed with water, but ensure all components are thoroughly dried before reassembly and reintroduction of animals.

### 4.2. Water Management

The terrarium is designed to hold water at the bottom for rainforest setups. However, it is crucial to monitor water levels and ensure seals remain intact. If using a significant amount of water, periodically check for any signs of leakage around the base. While the design allows for water, it is not intended as a permanent aquatic environment without additional sealing measures if leaks are observed.

## 5. TROUBLESHOOTING

Issue	Possible Cause	Solution
Difficulty assembling vertical poles.	Poles not aligned correctly or minor manufacturing variations.	Apply firm, even pressure. Ensure all components are aligned before attempting to fully seat the poles. Do not force components if they do not fit; re-check alignment.
Water leakage from the base.	Seals around the base may be compromised or not fully intact.	For setups requiring significant water, consider applying an aquarium-safe silicone sealant to all internal seams of the base before adding water. Regularly inspect seals for wear or damage.
Mesh side panels seem too flexible.	Mesh panels are designed for ventilation and may not withstand significant outward pressure.	Ensure the terrarium is suitable for the specific animal's behavior. For animals that may push against sides, consider using glass panels or reinforcing the mesh externally if necessary.
No obvious place to clamp a heating lamp.	The design primarily supports overhead heating/lighting placed on the screen top.	Utilize lamp stands or hanging fixtures designed for terrariums that position the lamp above the screen top. Avoid placing heating elements directly on the plastic base.

## 6. PRODUCT SPECIFICATIONS

Feature	Detail
Model	REPTI ZOO 3-in-1 Tall Terrarium
Dimensions (L x W x H)	16 inches x 16 inches x 30 inches
Item Weight	Approximately 43.1 pounds

<b>Feature</b>	<b>Detail</b>
Material	Glass, Metal Frame, Mesh
Color	Black frame, Clear glass
Included Components	Terrarium components, instruction manual, keyed lock
Specific Uses	Rainforest Reptile Habitat, adaptable for other reptile/amphibian environments
Manufacturer	REPTI ZOO

30in



16in

16in

Figure 5: Diagram illustrating the dimensions of the REPTI ZOO 16"x16"x30" Tall Terrarium.

## 7. WARRANTY AND SUPPORT

For specific warranty information regarding your REPTI ZOO terrarium, please refer to the documentation included with your purchase or contact REPTI ZOO directly. Warranty terms and conditions may vary.

For further assistance, product inquiries, or to explore other REPTI ZOO products, please visit the official REPTI

ZOO store:

[Visit the REPTI ZOO Store on Amazon](#)

© 2023 REPTI ZOO. All rights reserved.

This manual is for informational purposes only. Specifications are subject to change without notice.