

Manuals.plus /

› Sharper Image /

› SHARPER IMAGE 2.4GHz RC Glow Up Stunt Drone User Manual

Sharper Image 1012414

SHARPER IMAGE 2.4GHz RC Glow Up Stunt Drone User Manual

Model: 1012414

Brand: Sharper Image

INTRODUCTION

The Sharper Image Glow Up Mini Stunt Drone is designed for easy and enjoyable flight, suitable for both kids and beginners. This remote-controlled quadcopter features vibrant LED lights for enhanced visibility, especially in low-light conditions, and is capable of performing impressive 360-degree flips and stunts. Equipped with gyro stabilization and auto orientation flight control, it ensures stable and intuitive operation. The drone includes a rechargeable battery for convenient power management and assisted landing for smooth touchdowns.

WHAT'S IN THE BOX

- Glow Drone
- Remote Control
- USB Charging Cable
- 4 Replacement Propellers
- 4 Blade Guards and 4 Screws
- Built-in 3.7V 350mAh Rechargeable Lithium Battery

What You Need: The remote control requires 6 AA 1.5V batteries (not included).



WHAT YOU GET



Glow Drone



Remote control



4 replacement propellers



USB charging cable



4 blade guards + 4 screws



Drone requires a rechargeable 3.7V 550mAh lithium battery (included)

WHAT YOU NEED



Remote requires 6 AA 1.5V batteries (not included)

This image illustrates the components included in the drone package and the additional batteries required for the remote control.

SETUP

1. Charging the Drone Battery

Locate the USB charging cable. Connect the small end of the USB cable to the drone's charging port. Plug the larger end of the USB cable into a standard USB power source (e.g., computer USB port, USB wall adapter). The charging indicator light on the cable will illuminate during charging and turn off when fully charged. A full charge typically takes approximately 60-90 minutes.

2. Installing Controller Batteries

Open the battery compartment on the back of the remote control. Insert 6 AA 1.5V batteries, ensuring correct polarity (+/-). Close the battery compartment securely.

3. Pairing the Drone and Controller

Ensure both the drone and controller are powered off. Place the drone on a flat, level surface. Turn on the drone's power switch. The drone's LED lights will flash. Next, turn on the remote control. Push the left joystick (throttle) all the way up, then all the way down. The drone's LED lights will stop flashing and remain solid, indicating successful pairing. The drone is now

ready for flight.

OPERATING INSTRUCTIONS

Basic Flight Controls

- **Left Joystick (Throttle):** Push up to ascend, pull down to descend.
- **Right Joystick (Direction):** Push forward/backward to move the drone forward/backward. Push left/right to move the drone left/right.
- **Trim Buttons:** Use the trim buttons to fine-tune the drone's stability if it drifts in any direction.



This image provides a detailed view of the remote control, highlighting various buttons and their functions for controlling the drone.

Auto Orientation Flight Control

This feature simplifies navigation by allowing the drone to move relative to the controller, regardless of the drone's actual orientation. Press the 'Auto Orientation' button on the remote to activate this mode.

Gyro Stabilization

The built-in gyro stabilization system helps maintain the drone's balance and stability during flight, providing a smoother and more controlled flying experience.

Assisted Landing

For easier and softer landings, utilize the assisted landing feature. Press the 'Land' button on the remote, and the drone will automatically descend and land gently.

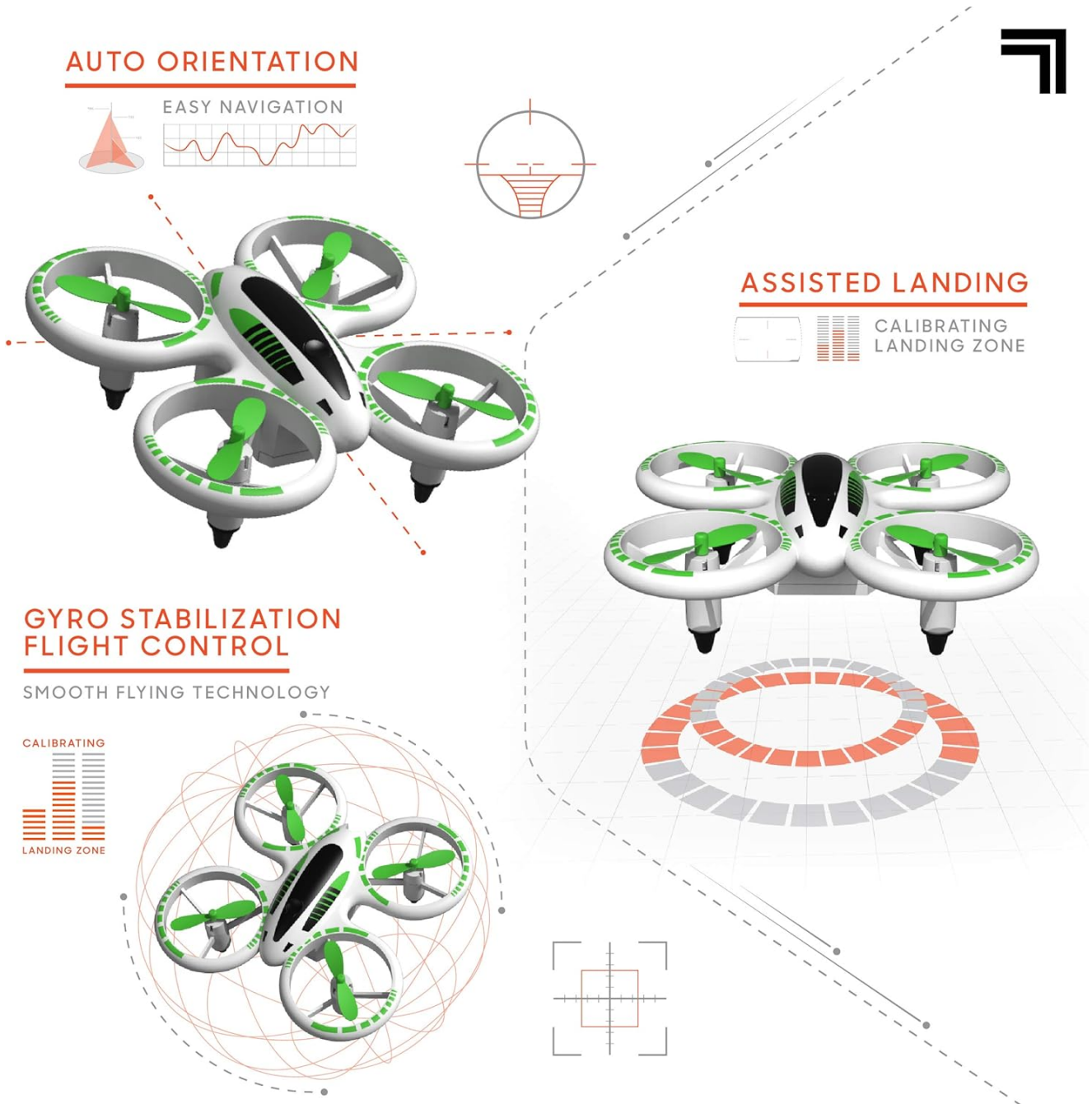

This image visually explains the functionalities of auto orientation, gyro stabilization, and assisted landing for improved flight control.

Performing Stunts (360-degree Flips)

To perform a 360-degree flip, press the 'Stunt' button on the remote control. Then, quickly push the right joystick in the desired direction (forward, backward, left, or right) to execute the flip. Ensure sufficient altitude before attempting stunts.

LED Lights

The drone is equipped with bright LED lights that glow in the dark, making it ideal for flying in low-light conditions or at night. The lights also add a visual element to stunts.



This image shows the drone's LED lights illuminated during flight in a dark environment, enhancing visibility and visual appeal.

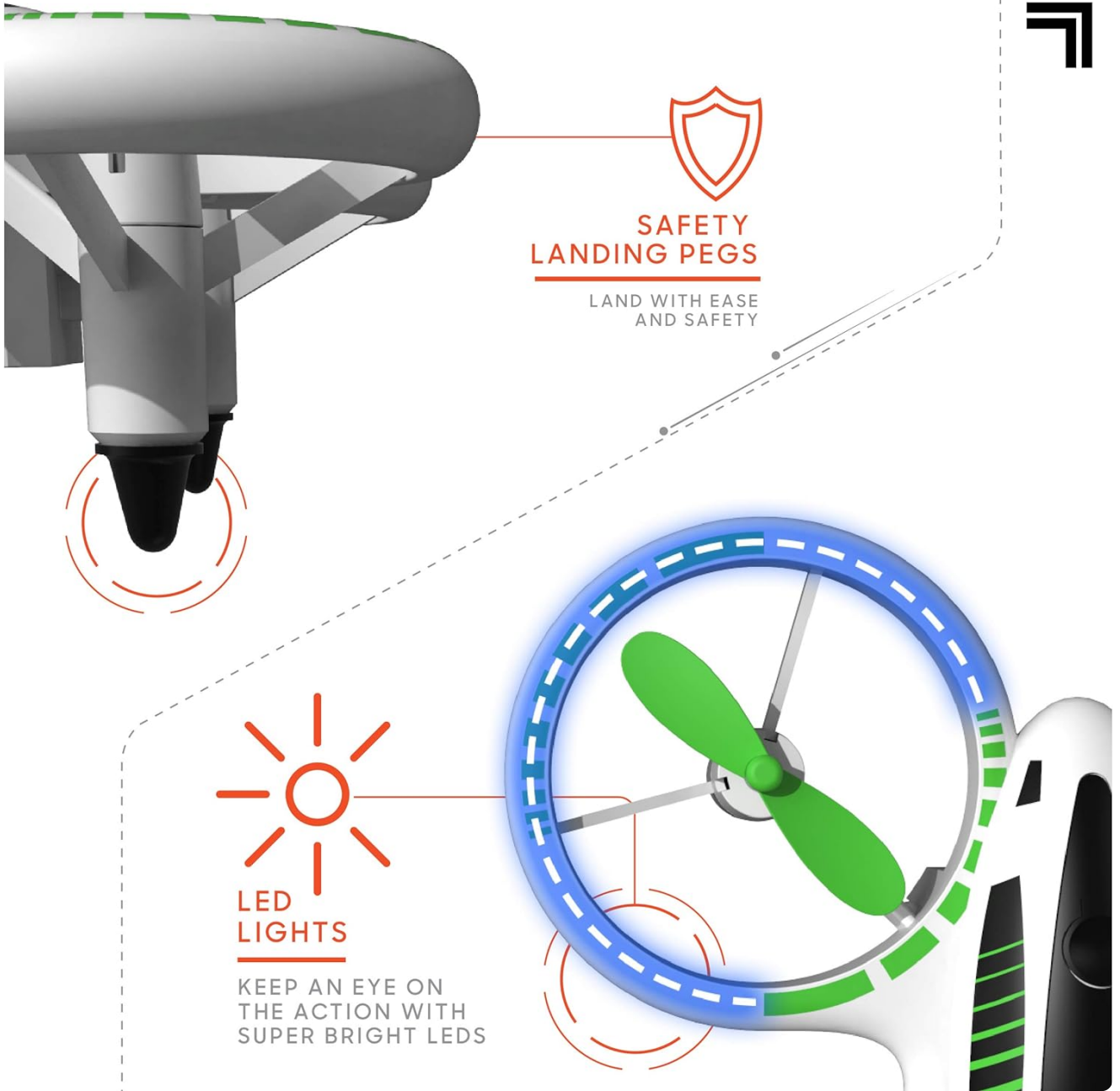

This diagram highlights the drone's safety landing pegs and the placement of its bright LED lights.

Flight Range

The drone operates with a 2.4GHz long-range control, providing a flight range of up to 164 feet radius.

AGES
14+



**FLIGHT RANGE OF
164 FEET RADIUS**

**2.4 GHz
LONG RANGE
CONTROL**

This image displays the drone and remote, emphasizing its flight range and control frequency.

Product Video Demonstration

Your browser does not support the video tag.

This video demonstrates the Sharper Image Glow Up Stunt Drone in action, showcasing its auto-orientation for easy flight control, gyro stabilization for smooth flying, assisted landing for soft touchdowns, and 360-degree stunting capabilities. It also highlights the vibrant LED lights for night flying.

MAINTENANCE

Cleaning

To clean the drone, gently wipe its surface with a soft, dry cloth. Avoid using harsh chemicals or abrasive materials, as these can damage the drone's components or finish.

Propeller Replacement

If a propeller becomes damaged, it can be replaced using the included spare propellers. Carefully remove the damaged

propeller and install a new one, ensuring it is securely fastened. Refer to the drone's specific propeller markings (e.g., A or B) to match them correctly to the motor arms.

Storage

When not in use, store the drone and remote control in a cool, dry place away from direct sunlight and extreme temperatures. Remove batteries from the remote control if storing for extended periods to prevent leakage.

TROUBLESHOOTING

Problem	Possible Cause	Solution
Drone does not respond to remote.	Not paired; low drone battery; low remote battery.	Re-pair drone and remote; charge drone battery; replace remote batteries.
Unstable flight or drifting.	Needs trim adjustment; damaged propeller; uneven surface for takeoff.	Adjust trim settings; replace damaged propellers; ensure drone is on a flat surface for takeoff.
Short flight time.	Battery not fully charged; aging battery.	Ensure battery is fully charged before use; consider battery replacement if performance degrades significantly over time.
LED lights not glowing.	LED light function off; drone battery low.	Press the 'Light ON/OFF' button on the remote; charge drone battery.

SPECIFICATIONS

Brand: Sharper Image

Model Name: Drone Stunt Glow LED 5inch

Model Number: 1012414

Color: White

Product Dimensions: 5"L x 5"W x 2"H (12.4 cm x 12.4 cm)

Item Weight: 1.6 ounces

Material: Plastic

Connectivity Technology: USB (for charging)

Remote Control Technology: 2.4GHz Radio Frequency

Control Type: Remote controlled

Battery Capacity: 350 Milliamp Hours (3.7V Lithium)

Battery Cell Composition: Lithium

Rechargeable Battery Included: Yes (for drone)

Remote Control Included?: Yes

Manufacturer Recommended Age: 8 years and up

Country of Origin: China



This image provides a visual reference for the drone's compact dimensions.

WARRANTY AND SUPPORT

This product comes with a 30-day limited warranty. For assistance with issues related to the drone or controller, please contact the manufacturer within 30 days of receiving the item.

An official User Manual (PDF) is also available for download: [Download User Manual \(PDF\)](#)